





# Wheel changing

 Remove the spare wheel prior to jacking the vehicle, to avoid destabilising the vehicle when raised.

 Take care when loosening the wheel nuts. The wheel brace may slip off if not properly attached and the wheel nuts may give way suddenly. Either unexpected movement, may cause an injury.

 **WARNING - THAT NO PERSON SHOULD PLACE ANY PORTION OF THEIR BODY UNDER A VEHICLE THAT IS SUPPORTED BY A JACK.**

## IMPORTANT – USE OF SPARE TYRE

 Adhere to the instructions on the temporary spare warning label, affixed to the wheel.

 Where fitted the temporary use spare wheel is **FOR TEMPORARY USE ONLY**. Drive with caution while the temporary spare wheel is fitted. Ensure that an original size wheel and tyre are fitted as soon as possible.

 Do not fit more than one temporary spare wheel on the vehicle at any one time.

 Do not exceed 50 mph (80 km/h) while the temporary spare wheel is fitted.

 The tyre pressure in the temporary spare wheel should be 60 psi (4.2 Bar, 420 kPa).

 DSC must be switched on while the temporary spare wheel is in use.

 Traction devices such as snow chains cannot be used with a temporary spare wheel.

## LOCKING WHEEL NUTS

Locking wheel nuts can only be removed using the special adapter provided in the tool kit.

**Note:** When the vehicle is first supplied, the adapter may be stored in the glove compartment. It should be removed and stored in the tool kit as soon as possible.

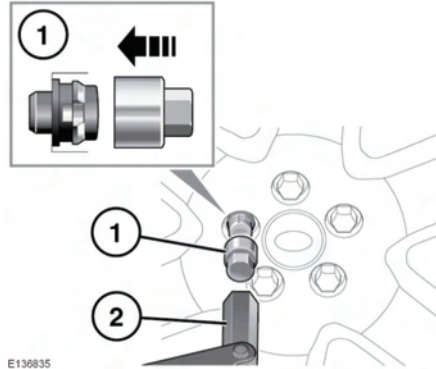

1. Insert the adapter into the locking wheel nut, ensuring that it is fully engaged.
2. Using the wheel brace, unscrew the wheel nut and adapter.

**Note:** A code number is stamped onto the underside of the adapter. This number must be recorded on the security card supplied with the literature pack. If a replacement adapter is required, you will be asked to quote this number. The security card must be kept safe, but should not be kept with the vehicle.