









WHEEL CHANGING SAFETY

Before raising the vehicle or changing a wheel, ensure that you read and comply with the following warnings.

-  **Always find a safe place to stop, off the highway and away from traffic.**
-  **Ensure that the vehicle and jack are both on firm level ground.**
-  **Apply the parking brake and engage Park (P).**
-  **Ensure the air suspension is set to off road height.**
-  **Switch on the hazard warning lamps.**
-  **Ensure that the front wheels are in the straight ahead position.**
-  **Disconnect trailer/caravan from vehicle.**
-  **Ensure that all passengers and animals, are out of the vehicle and in a safe place away from the highway.**
-  **Place a warning triangle at a suitable distance behind the vehicle, facing towards oncoming traffic.**

TOOL KIT

Note: Tool types and positions may vary from the illustrations.

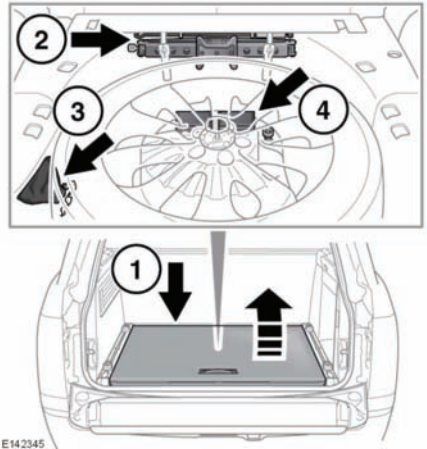

The jack (2) and the spare wheel lift assist tool (3) are located under the loadspace floor panel (1) adjacent to the spare wheel.

Note: *Examine the jack occasionally, clean and grease the moving parts, particularly the screw thread, to prevent corrosion.*

The tool kit (4) is located under the spare wheel. See **238, REMOVING THE SPARE WHEEL**

Note: *Take careful note of the stowage position for each tool, as it is important to return them to their correct position after use.*