

THE NAVIGATION SYSTEM

Navigation instruction is by map and turn information displayed on the touch screen and can be complemented by voice guidance if required. The system uses signals from Global Positioning System (GPS) satellites combined with information from vehicle sensors and from data stored on the hard drive, to establish the true vehicle position.

Note: Mapping data loaded on the hard drive is relevant to the market in which the vehicle is first sold and will provide guidance and information only for that area. Your Land Rover Dealer/Authorised Repairer will have details of software updates.

Using this combination of data sources the vehicle navigation computer enables you to plan and follow a route map to your desired destination.

The touch screen is used to control navigation via menus, text screens and map displays.



Operate the system only when it is safe to do so.

The requirements of national Road Traffic Regulations always apply.

Observation of traffic signs and local traffic regulations always take priority.

The navigation system serves solely as an aid to navigation. In particular, the navigation system cannot be used as an aid to orientation when visibility is poor.

GPS signals may occasionally be interrupted due to physical barriers such as tunnels and roads under raised highways.

However, direction and speed sensors on the vehicle will minimise any adverse effect on the navigation system. Normal operation will resume once the obstruction has been passed.

Under certain conditions it is possible for the vehicle position shown on screen to be incorrect. This may happen when:

- Driving on a spiral ramp in a building.
- Driving on or beneath elevated roads.
- Two roads are close and parallel.
- The vehicle is transported to another destination.
- After the vehicle is rotated on a turntable.
- After vehicle battery disconnection.

USING THE NAVIGATION SYSTEM

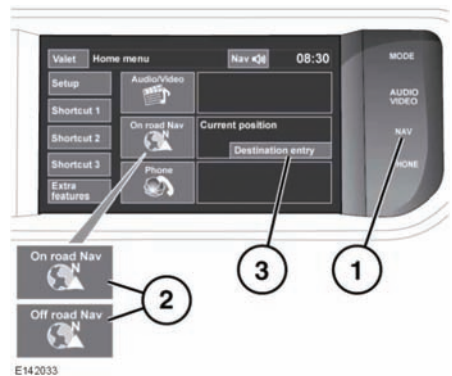

E142033

1. **NAV** shortcut button, press for navigation.
2. **Navigation** soft key, touch for navigation.
3. **Destination entry**. Touch for destination entry menu.

Note: On vehicles with off-road navigation, the soft key includes **On road** or **Off road**, to show the current Navigation mode.

If the navigation screen language has not been set, select **Language**, and touch **OK** to confirm. The **CAUTION** screen will return.

After touching **Agree**, the touch screen will display the previously displayed map view. This will show the current vehicle position. Touch the **Nav menu** soft key to display the main menu screen.