

EMERGENCY LOCKING

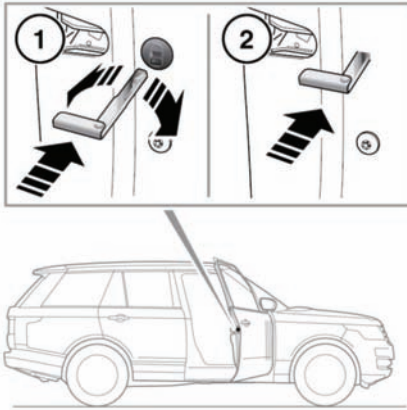

E145208

In the event of the battery discharging or a fault with the keyless locking system, the doors must be locked manually.

Note: Do not leave the emergency key blade in the vehicle at any point during the emergency locking procedure.

1. Open the door and locate the emergency lock access cover. Using the emergency key blade (see 4, **UNLOCKING THE VEHICLE**) rotate the cover to release it from the door.
Remove the cover and store it safely.
2. Insert the emergency key blade firmly into the emergency lock.
The emergency key blade can now be removed.
3. Refit the emergency lock access cover and rotate it clockwise to secure it firmly.
4. Close the door and check to ensure the door is locked.
Repeat the procedure for all other unlocked doors.