



## REMOTE OPERATION

-  **The Smart Key can be operated from inside or outside the vehicle. It is therefore important that it is kept out of the reach of children at all times.**
-  **Ensure that the vehicle is clear of people and obstacles before lowering the suspension. The difference between Off-road height and Access height can be 125 mm (4.9 in).**
-  Care should be taken with all height changes when a trailer is attached to the vehicle.

The buttons on the Smart Key may be used to operate the air suspension system, allowing the vehicle to be raised or lowered remotely. This may be useful in attaching a trailer or loading the vehicle.

To change the suspension height using the Smart Key, the vehicle must be stationary, all the doors closed and the hazard warning lamps switched on.

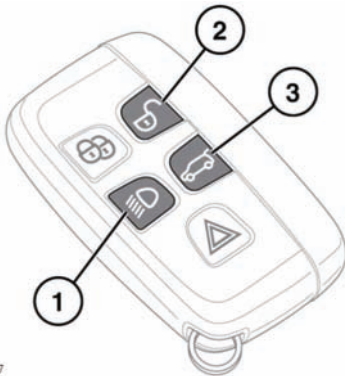

E134947

To raise the vehicle press and hold button (1) and button (2) together.

To lower the vehicle press and hold button (1) and button (3) together.

**Note:** If the starting height is above or below normal height, movement will cease when normal height is reached. Release the Smart Key buttons and press again to continue.

## ADAPTIVE DYNAMICS

If a fault is detected the Instrument panel will illuminate either the Critical or General warning lamp. See 57, **CRITICAL WARNING MESSAGE (RED)** or 57, **GENERAL WARNING/INFORMATION MESSAGE (AMBER)**. The warning messages **ADAPTIVE DYNAMICS FAULT** or **SUSPENSION FAULT VEHICLE LEAN WHEN CORNERING** will also be displayed in the message centre. Some reduction in ride comfort may be experienced. If the fault persists, consult a Land Rover Dealer/Authorised Repairer.