

CLIMATE CONTROL

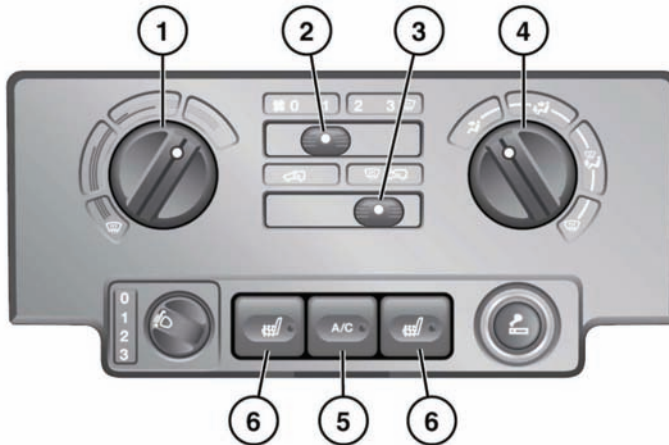

E135680

1. Temperature control; rotate to adjust.
2. Blower speed; slide to adjust air flow speed through the vents.
3. Recirculation; slide for recirculated or fresh air. Recirculation helps to maintain a high or low temperature and is useful for preventing fumes from entering the vehicle.
4. Air distribution; rotate to direct air flow.
5. Press to switch A/C on/off. The switch indicator will illuminate when switched on.

Note: The blower will switch on automatically if A/C is selected when the blower is set to 0.

Note: If interior temperature is higher than exterior temperature, before operating A/C, fully ventilate the vehicle by using the blower control, windows and sunroof.

Note: During A/C operation, puddles may form under the vehicle. This is normal and does not indicate a fault with the system.

6. Seat heaters; press to switch on/off.



To prevent battery discharge, seat heaters should be operated only while the engine is running.

HEATED SEATS

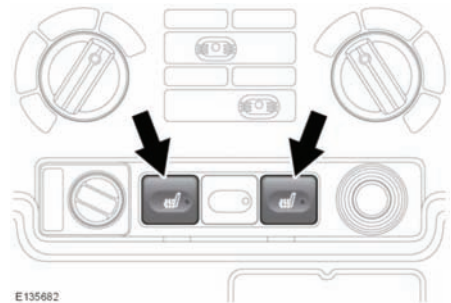

E135682

Note: To prevent the battery from becoming discharged the seat heaters should be operated only when the engine is running.

With the starter switch at position II, press the appropriate switch to activate a seat heater. The seat heaters will maintain a factory set temperature. There are indicators in each switch.

Press again to turn off.