

3. Release the bonnet support stay.
4. Fit the support stay into the slotted hole in the underside of the bonnet.

## CLOSING THE BONNET

1. Take hold of the support stay and lift the bonnet slightly.

2. Fix the support stay into its retaining clip on the bonnet locking platform.
3. Lower the bonnet, allowing it to drop the last 30cm (12 inches). Check that the catch is fully engaged. The front edge of the bonnet should be free of movement.

## ENGINE COMPARTMENT OVERVIEW

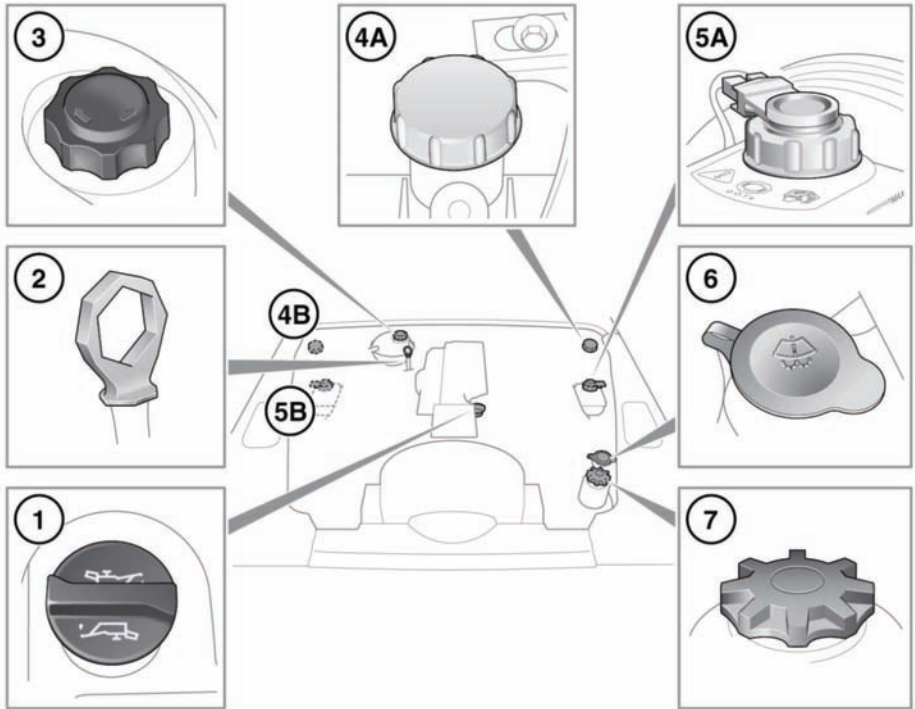

E135728

1. Engine oil filler cap - Black
2. Engine oil dipstick - Yellow
3. Engine coolant reservoir cap - Black
4. Clutch fluid reservoir cap - Grey.
5. Brake fluid reservoir cap - White/Clear
6. Screen washer fluid reservoir cap - Blue

7. Power steering fluid reservoir cap - Black

**Note:** A and B are designations for left and right hand drive vehicles.

For fluid and lubricant specifications, see **101, LUBRICANTS AND FLUIDS.**