

Front seats

1. Firmly pull up the front of the seat base. This will release the front retaining clips.
2. If necessary, disconnect the seat heater electrical connection.
3. Pull the seat base forwards and remove.
4. Release the catch at the front of the compartment.
5. Slide the lid forwards and remove.

FRONT SEAT BASE REFIT



Ensure that the seat base is securely fitted in place before driving.

Refit a seat base as follows:

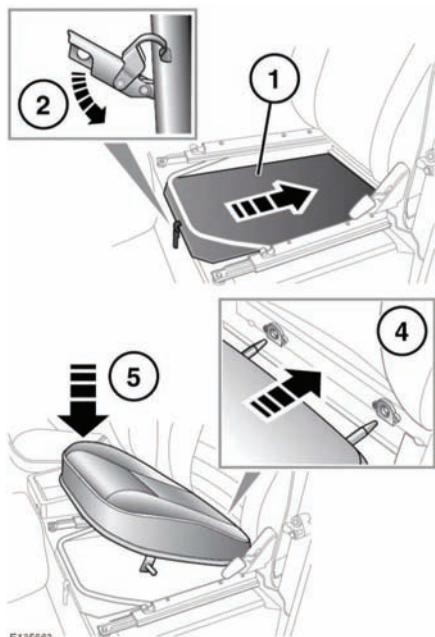

1. Slide the lid back into position and close it.
2. Secure the catch at the front of the compartment.
3. If applicable, reconnect the electrical connection.