

WIPER OPERATION

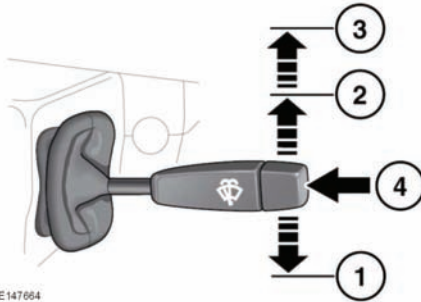

E147664

1. Intermittent wipe - pull down.

- ❗ Before operating in freezing or very hot conditions, ensure that the wipers have not stuck to the glass. The drag on the wiper mechanism may cause damage.
- ❗ Do not operate the windscreen wipers on a dry screen. The drag on the wiper mechanism may cause damage.
- ❗ Remove any snow, ice, or frost, from the screen, around the wiper arms, and wiper blades and the screen scuttle before operating the wipers. Snow and ice can cause damage to the wiper mechanism if left uncleared.

Note: If the wiper blades become stuck or jammed, a safety cut-out may halt operation of the wipers. Switch off the wipers and the ignition. Clear any obstructions and free the wiper blades before switching on the ignition.

- 2. Low speed wipe - push up to first position. For a single wipe, push up against spring pressure then release.
- 3. High speed wipe - push up to second position.
- 4. Press in for screen wash.

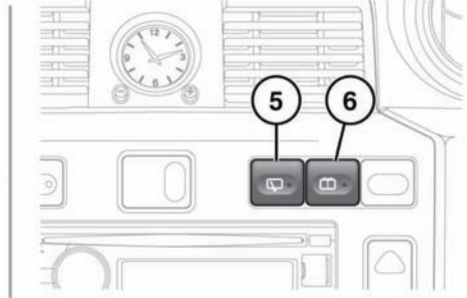

- ❗ Use only screenwash products approved for automotive use. Follow the manufacturers instructions.
- ⚠ **Some screenwash products are flammable. Do not allow screenwash products to come into contact with sources of ignition.**
- 5. Press to operate rear windscreen wiper continuously. Press again to switch off.
- 6. Press and hold for rear windscreen washing.