

## LIGHTING CONTROL

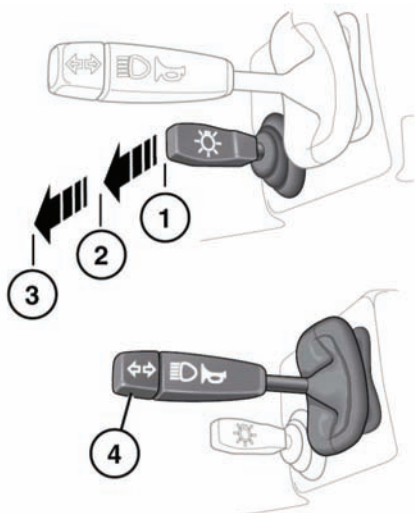

E147663

1. Headlamps/side lamps off.
2. Side, tail and instrument panel lamps on.
3. Headlamp low beam on.
4. Push forward for high beam. Pull back for high beam flash. Move up or down to operate direction indicators.

When the headlamp high beam is on, the main beam warning indicator will illuminate. See **30, HIGH BEAM (BLUE)**.

5. Rear fog lamps switch. The fog lamps operate only when the headlamp low beam is on.

The rear fog lamp warning indicator will illuminate in the instrument pack (See **30, REAR FOG LAMP (AMBER)**). Press again to switch off.

6. Hazard warning lamps switch. Press to operate all indicator lamps.

7. Headlamp levelling control.

Use the control to account for vehicle loading changes. This will avoid dazzling

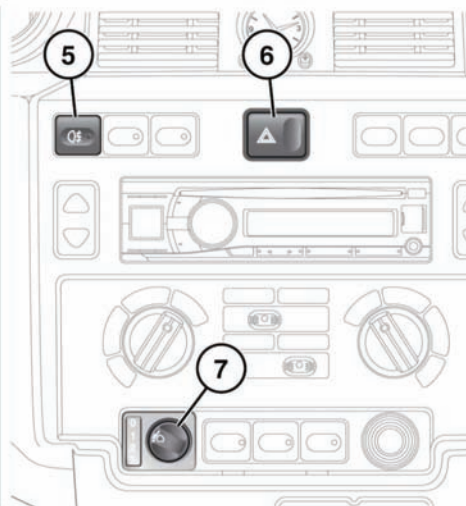

other road users.

| Vehicle load  | Switch position |
|---|-----------------|
| Driver only (loadspace empty)                                       | 0               |
| Driver and front seat passenger (loadspace empty)                   | 0               |
| Driver and passengers in all seats (loadspace empty)                | 1               |
| All seats occupied and loadspace loaded to maximum rear axle weight | 2               |
| Driver only with loadspace loaded to maximum rear axle weight       | 3               |

## HEADLAMPS - CONDENSATION

Misting of lamp lenses can occur under some atmospheric conditions. This will not affect the performance of the lamps, and will clear during normal operation.