

PARK ASSIST

Park assist is an aid to parallel parking in tight parking slots. The space required is only 1.2 times the length of your vehicle. For the system to operate correctly, your vehicle must be parallel to a line of parked vehicles along which you intend to search for a parking space. Your front wheels must be in the straight ahead position. Parking on a bend may cause the system to miscalculate distances.

When the sensors detect a space sufficient to park in you will be instructed via the message centre of the next move.

The actual parking manoeuvre is controlled by the vehicle, without your hands on the steering wheel. The message centre will advise when the steering wheel must be released.



Park assist is a driving aid only. It remains the driver's responsibility to drive with due care and attention during parking manoeuvres.



Park assist may not detect moving objects such as children and animals, until they are dangerously close. Always use extreme caution when manoeuvring.



Park assist sensors may not detect some obstructions, e.g. narrow posts, small objects close to the ground and some objects with dark non-reflective surfaces, and in some circumstances bicycles/motor cycles parked alongside the kerb.



All sensors must be kept clean and free from debris or obstructions, e.g., leaves, mud or snow. Failure to keep the sensors clean may result in miscalculation.



Park assist must not be used if any of the following are apparent;
A temporary spare wheel is in use.
A sensor is damaged or the bumper is damaged sufficiently to affect a sensor mounting point.

A sensor is obstructed by items attached to the vehicle, e.g., bumper covers, a bicycle rack, a trailer, stickers, etc.

The vehicle is being used to transport a load that extends beyond the vehicle perimeter.



When Park assist searches for an appropriate parking space, there must be an acceptable distinction between the road surface and the kerb height. Damaged or very low kerbs or kerbs covered with debris or snow may cause a miscalculation.

Note: All doors, except the driver's door, must be securely closed.

Note: During any Park assist manoeuvre, the parking aids remain active and will sound when objects are detected near the vehicle.

Note: A parking manoeuvre can be cancelled at any point by holding / turning the steering wheel or by pressing the Park assist button.

Note: In a situation where the rows of parked vehicles on either side of the road are close enough for Park assist to sense them and Park assist determines that there is not enough manoeuvring space for reverse parking, the space will be rejected, even if the driver believes the space is large enough to park the vehicle. The driver retains the option to switch off Park assist and to attempt the parking manoeuvre manually.

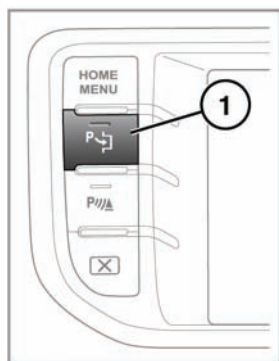

SL1692

2

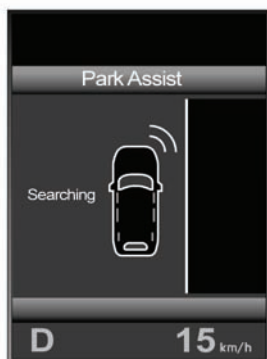

3

1. To activate, press the Park assist button while driving forwards at less than 30 km/h (19 mph). The indicator lamp in the button illuminates.

Note: If vehicle speed exceeds 30km/h (19mph), **SLOW DOWN!** is displayed until speed decreases to less than 30 km/h (19 mph) again. If vehicle speed is not reduced, Park assist is de-activated and the indicator light in the button is extinguished.

Note: Park assist sensors can be affected by sudden temperature differentials. For example, if the vehicle is moved from a warm interior into a cold exterior temperature, the sensors will require time to adjust. The same applies if the move is from a cold situation into a significantly warmer ambient temperature.

2. The **Park Assist** display appears in the message centre and shows the **Searching** message and graphic. All messages and instructions are displayed here. Take action when the text is an instruction.

Note: For Park assist to operate effectively, maintain a distance of 0.5 to 1.5 m (1.5 to 5 ft) between your vehicle and the line of parked vehicles / obstacles in which you want to park.

3. When first activated Park assist searches for a space on the front passenger side of the vehicle. To search for a space on the driver's side, signal a turn in that direction.

Note: If vehicle speed exceeds 6 km/h (4 mph) during the parking manoeuvre, Park assist will display a **SLOW DOWN!** message until speed decreases to less than 6 km/h (4 mph). If vehicle speed is not reduced, Park assist will de-activate and the indicator lamp in the Park assist button will extinguish.

- As you drive forward, the size of potential parking spaces is assessed and displayed graphically.



SL1693

- A short confirmation tone is given when a suitable space is found and a message to stop or to drive forward to a starting point will be given, depending on the vehicle's current position.



Make a visual check before starting the reversing manoeuvre to ensure that the space has not changed in any way, e.g., a pedestrian has stepped into the space.

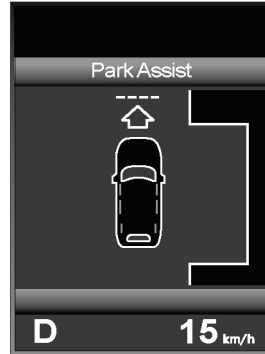

SL1694

- An instruction to select reverse gear will follow. Park assist will then take control of the vehicle's steering system so you must release the steering wheel. Apply the accelerator carefully to move the vehicle slowly into the parking space. Use the foot brake when instructed to do so.

Note: If the steering wheel is manually adjusted while Park assist has control of the steering, Park assist will de-activate and the indicator lamp in the Park assist button will extinguish.