

BEFORE DRIVING OFF-ROAD

Before venturing off-road, it is absolutely essential that inexperienced drivers become fully familiar with the vehicle's controls. In particular, CommandShift™, Hill Descent Control (HDC) and the Terrain response system.

TERRAIN RESPONSE OPERATION

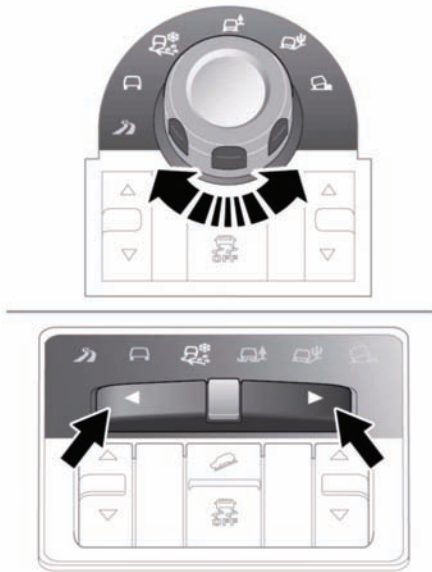

E141526

Depending on the vehicle specification, there is a choice of Terrain Response control.

When the vehicle is fitted with a gear selector lever, Terrain Response selection is via a rotary control. Depending on the vehicle specification, there are five or six Terrain Response programs marked around the control.

When the vehicle is fitted with a rotary drive selector, Terrain Response selection is via a rocker switch. Depending on the vehicle specification, there are five or six Terrain Response programs marked in front of the switch. Use the switch to move forward or back through the programs.

Information relating to the suitability of each terrain response program on different types of surface, is given on the touch screen, via the **Extra features** soft key. Touch the terrain response icon, then the information icon. The displayed text is relevant to the currently selected terrain response program.

GENERAL PROGRAM (SPECIAL PROGRAMS OFF)



This program is compatible with all on and off-road conditions. If not already active, it should be selected before driving on surfaces which are similar to a hard road surface. Dry cobbles, tarmac, dry wooden planks, etc., all fall into this category.

This program should be selected once the need for a special program has passed. Once the special program has been deselected, all of the vehicle systems will return to their normal settings except HDC. HDC will remain active if it was selected manually.

GRASS/GRAVEL/SNOW



This program should be used where a firm surface is covered with loose or slippery material.