

# Wheel changing

## USING WHEEL CHOCKS



Always chock the wheels using suitable wheel chocks. Place the chocks on both sides of the wheel diagonally opposite the wheel to be changed.



If jacking the vehicle on a slope is unavoidable, place the chocks on the downhill side of both wheels on the axle not being raised.

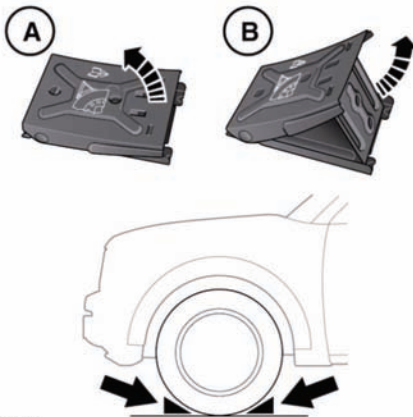

E135175

Wheel chocks are stowed in the tool kit.

1. Remove the chocks from the tool kit and lift the folded section (A) to assemble chock.
2. Lift support section (B) of chock until it locks into place.
3. Position the vehicle on level ground.  
Both chocks must be used. Position them on opposite sides of the wheel and fully push them home against the tyre.

## LOCKING WHEEL NUTS

Locking wheel nuts can only be removed and installed using the special adapter provided in the tool kit.

**Note:** A code number is stamped onto the underside of the adapter. This number should be recorded on the security card supplied with the literature pack. If a replacement adapter is required, you will be asked to quote this number. The security card must be kept safe, but should not be kept with the vehicle.

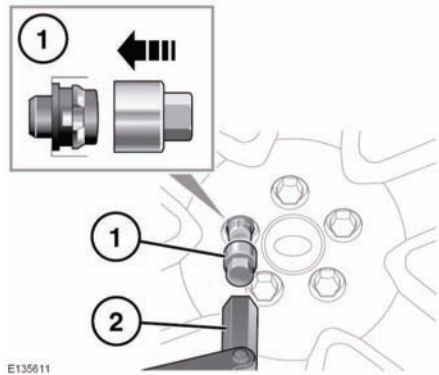

E135611

To release

1. Insert the wheel nut adapter into the locking wheel nut, ensuring that it is fully engaged.
2. Use the wheel brace to turn the wheel nut and adapter.

**Note:** After use store the wheel nut adapter correctly in the tool kit.