













## WHEEL CHANGING SAFETY

Before raising the vehicle or changing a wheel, ensure that you read and comply with the following warnings.

-  Always find a safe place to stop, off the highway and away from traffic.
-  Ensure that the vehicle and jack are both on firm level ground.
-  Apply the parking brake. Engage Park (P) on automatic vehicles, select 1st or reverse gear on manual vehicles.
-  Switch on the hazard warning lamps.
-  Ensure that the front wheels are in the straight ahead position, and engage the steering lock.
-  Disconnect trailer/caravan from vehicle.
-  Ensure that all passengers, and animals, are out of the vehicle and in a safe place away from the highway.
-  Place a warning triangle at a suitable distance behind the vehicle, facing towards oncoming traffic.
-  Never place anything between the jack and the ground, or the jack and the vehicle.
-  Always chock the wheels using suitable wheel chocks. Place the chocks on both sides of the wheel diagonally opposite the wheel to be changed.
-  If jacking the vehicle on a slight slope is unavoidable, place the chocks on the downhill side of the two opposite wheels.
-  Take care when lifting the spare wheel, and removing the punctured wheel. The wheels are heavy, and can cause injuries if not handled correctly.



Remove the spare wheel prior to jacking the vehicle, to avoid destabilising the vehicle when raised.



Take care when loosening the wheel nuts. The wheel brace may slip off if not properly attached and the wheel nuts may give way suddenly. Either unexpected movement, may cause an injury.



**WARNING - THAT NO PERSON SHOULD PLACE ANY PORTION OF THEIR BODY UNDER A VEHICLE THAT IS SUPPORTED BY A JACK.**

## WHEEL CHANGING

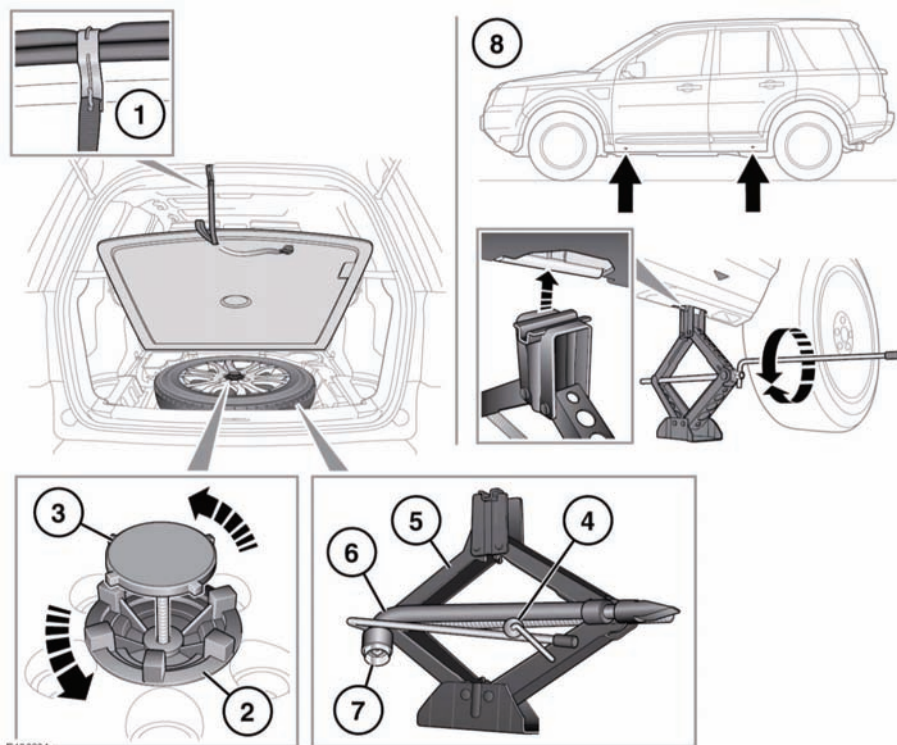

The spare wheel is heavy and if handled incorrectly may cause injury. Use extreme caution when lifting or manoeuvring the wheels.



Always secure the spare wheel, or the removed wheel, in the correct position using the retaining bolt.



Always remove the spare wheel before jacking the vehicle.



**WARNING - THAT NO PERSON SHOULD PLACE ANY PORTION OF THEIR BODY UNDER A VEHICLE THAT IS SUPPORTED BY A JACK.**

**Note:** Before removing the spare wheel, take note of its stowage position. The wheel to be changed must be correctly stowed in its place.

1. To access the spare wheel lift the floor panel and fit the retaining strap hook to the tailgate guttering.
2. Slacken the locking ring.
3. Undo and remove the retaining bolt. Then lift out the spare wheel.
4. To remove the jack and wheel brace undo the retaining bolt.
5. Vehicle jack.
6. Wheel brace.

7. Locking wheel nut adapter.
8. Raise the vehicle using the jack with a slow steady operation. Avoid rapid, jerky actions as they may cause the vehicle/jack to become unstable.
9. Remove the wheel nuts and place them together where they cannot roll away.
10. Remove the wheel and place to one side. Do not lay the wheel on its face, as this may damage the finish.
11. Fit the spare wheel to the hub.
12. Re-fit the wheel nuts, and lightly tighten them. Ensure that the wheel is making contact with the hub evenly.
13. Ensure that the space under the vehicle is clear of obstructions, and lower the vehicle slowly and smoothly.
14. With all wheels on the ground and the jack removed, fully tighten the wheel nuts. The wheel nuts must be tightened in sequence (see illustration) to the correct torque of 133 Nm (98 lb.ft).

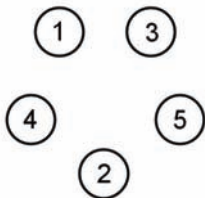

E132675

**Note:** If it is not possible to torque the wheel nuts when a wheel is replaced, they should be set to the correct torque as soon as possible.

If an alloy spare wheel is to be fitted, using a suitable blunt tool, knock the centre cap out of the removed wheel. Then using hand pressure only, press the centre cap into the newly fitted spare.

Check and adjust the tyre pressure as soon as possible.

### IMPORTANT – USE OF SPARE TYRE



Adhere to the instructions on the temporary spare warning label, affixed to the wheel.



Where fitted the temporary use spare wheel is **FOR TEMPORARY USE ONLY**.

Drive with caution while the temporary spare wheel is fitted.

Ensure that an original size wheel and tyre are fitted as soon as possible.



Do not fit more than one temporary spare wheel on the vehicle at any one time.



Do not exceed 50 mph (80 km/h) while the temporary spare wheel is fitted.



The tyre pressure in the temporary spare wheel should be 60 psi (4.2 Bar, 420 kPa).



DSC must be switched on while the temporary spare wheel is in use.



Traction devices such as snow chains cannot be used with a temporary spare wheel.

## LOCKING WHEEL NUTS

Locking wheel nuts can only be removed using the special adapter provided in the tool kit.

**Note:** When the vehicle is first supplied, the adapter may be stored in the glove compartment. It should be removed and stored in the tool kit as soon as possible.

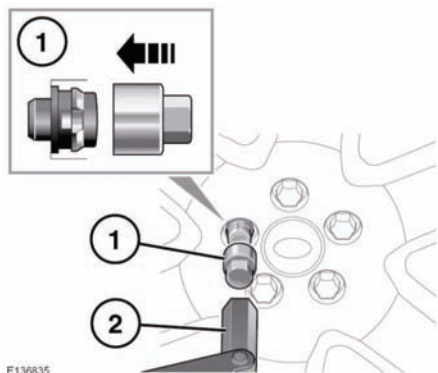

1. Insert the adapter into the locking wheel nut, ensuring that it is fully engaged.
2. Using the wheel brace, unscrew the wheel nut and adapter.

**Note:** A code number is stamped onto the underside of the adapter. This number must be recorded on the security card supplied with the literature pack. If a replacement adapter is required, you will be asked to quote this number. The security card must be kept safe, but should not be kept with the vehicle.