

# Starting the engine

## SWITCHING ON THE IGNITION

To turn on the ignition without starting the engine. Do not depress the brake/clutch pedal, press the start/stop button and hold until the warning indicators illuminate, then release the button.

## STEERING COLUMN LOCK

- ❗ During vehicle recovery, the remote control must remain docked.

Your vehicle is fitted with an electronic steering column lock. The column unlocks when the remote control is docked.

Any malfunction of the steering column lock will be indicated by the message **STEERING COLUMN LOCKED** being displayed in the message centre. If this occurs:

1. Lock and then unlock the vehicle using the remote control.
2. Try again to unlock the steering column lock, by turning the steering wheel gently to the left and right.
3. If the problem persists, seek qualified assistance immediately.

## STARTING THE ENGINE

- ⚠ **Never start the engine, or leave it running, when the vehicle is in an enclosed space. Exhaust gasses are poisonous and can cause unconsciousness and death if inhaled.**

- ❗ If the engine fails to start, do not continue cranking as this will discharge the battery. It may also damage the catalytic converter due to unburnt fuel passing through the exhaust.

**Note:** For diesel vehicles, the delay period before cranking begins will be longer in low ambient temperatures due to extended glow plug operation. During this extended delay the clutch pedal (manual transmissions) or brake pedal (automatic transmissions) must remain depressed. **CRANKING WILL COMMENCE AFTER GLOW PERIOD** is displayed on the message centre.

## STARTING: AUTOMATIC TRANSMISSION

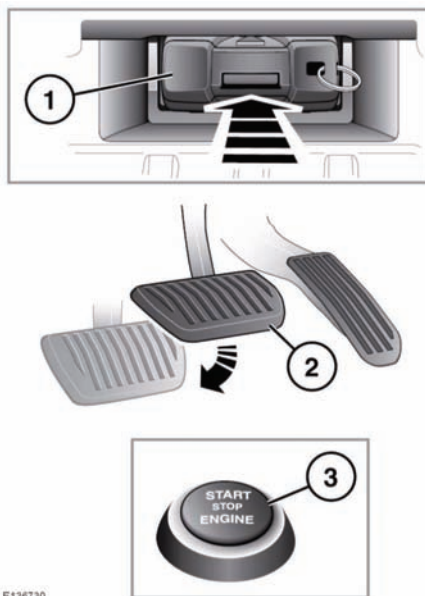

E136730

1. Insert the remote control into the docking port (buttons facing upwards) and press to latch.
2. Press the brake pedal.
3. With the brake pedal firmly depressed, briefly press and release the start button. The engine will crank automatically until it starts. For diesel engines there may be a delay whilst the glow plugs warm up, then the engine will crank automatically until it starts.

## STARTING: MANUAL TRANSMISSION

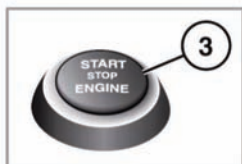
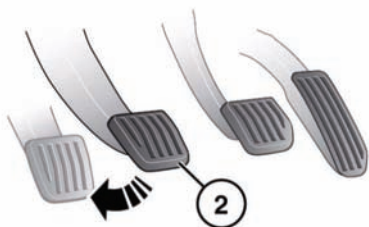
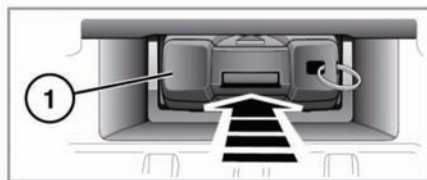

E136729

1. Insert the remote control into the docking port (buttons facing upwards) and press to latch.
2. Press the clutch pedal.
3. With the clutch pedal fully depressed, briefly press and release the start button. There may be a delay whilst the glow plugs warm up, then the engine will crank automatically until it starts.

## SWITCHING OFF THE ENGINE

Before stopping the engine, ensure that the vehicle is parked safely with the park brake applied.

1. Select P (Park) for automatic transmission, or Neutral for manual transmissions.
2. Press the Start/Stop button.

3. Press the remote to unlatch it, then remove it from the docking port by gripping the sides. Do not pull the remote out using the keyring attachment as this will only remove the emergency key.

**Note:** If the engine is switched off by the stop/start system, the remote control can be removed as previously described above in point 2.

## ECO STOP/START

The Eco Stop/Start system has been designed to improve fuel efficiency. The system is automatically activated when the ignition is switched on.



When the vehicle comes to a stop, neutral is selected and the clutch is fully released, the engine automatically switches off.

When the clutch is depressed prior to selecting a gear, the engine automatically restarts.

The engine will not automatically stop if:

- The external temperature is below approximately 0°C (32°F).
- The external temperature is above approximately 35°C (95°F).
- Engine has not reached operating temperature.
- Driver's seat belt is not fastened.
- Driver's door is not fully closed.
- The driver's foot is on either the clutch or accelerator pedals.
- Climate control system demand is high.
- Battery charge is low.
- The DPF is regenerating.
- HDC or a Terrain Response special program are selected.

## Starting the engine

When the engine has been stopped by the stop/start system, the Eco icon will illuminate.

**Note:** The stop/start system is disabled when a trailer electrical connection is made.

The engine will automatically start if:-

- Climate control system demand increases.
- The vehicle's speed reaches approximately 3 km/h (2 mph).
- HDC or a Terrain Response special program are selected.
- Battery charge becomes low.
- Brake vacuum has been reduced (eg using the brake pedal repeatedly with the engine off).

**Note:** Automatic stall restart will only operate once. If the engine is stalled a second time the engine must be restarted normally.

### ROLLING RE-START

If the engine is switched off while the vehicle is moving, a rolling re-start can be initiated by selecting neutral and pressing the engine START/STOP button.

### DEACTIVATING ECO STOP/START



To switch the system off (preventing automatic stop/start) press the **ECO** button. The LED indicator will extinguish to confirm that the system is off.

**Note:** The engine will restart automatically If the switch is pressed to disable the system, whilst an automatic engine stop is in progress.

If the LED indicator fails to illuminate at start up, a system fault may be present. Contact your Land Rover dealer for assistance.

### STALL RECOVERY

In the event that the engine stalls, it can be restarted by fully depressing the clutch pedal.