

Sunroof

SUNROOF OPERATION

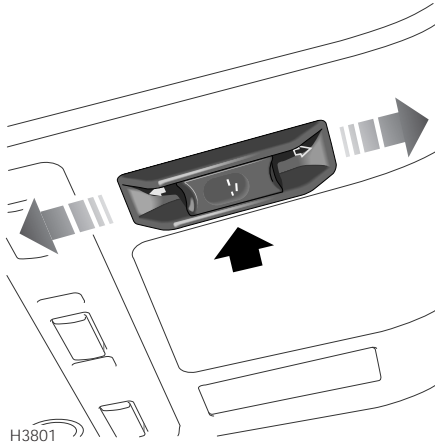

The electric sunroof can be operated when the starter switch is in the first or second position and for up to 16 minutes after the starter switch is turned off (provided a front door is not opened).

- **To tilt the roof:** Press the centre part of the switch - the rear edge of the roof automatically rises to the fully tilted position.
- **To open the roof:** Push the switch rearwards to the first position, the sunroof slides open until the switch is released - push the switch rearwards to the second position and release, to fully open the roof in one go.
- **To close the roof:** With the roof open or tilted, push the switch forwards to the first position - the roof closes until the switch is released.

To fully close the roof in one go, push the switch forwards to the second position and release.

Anti-trap mechanism

If the roof encounters resistance during closing, the closing operation is interrupted and the roof opens slightly. This is a safety feature designed to prevent inadvertent closing of the roof on vulnerable parts of the body or other obstructions. Remove any obstruction and then close the roof.

WARNING

 **Accidental closure of a sunroof on fingers, hands or any vulnerable part of the body, can result in serious personal injury. Always observe the following precautions:**

 **Ensure that children are kept clear and that the sunroof is not obstructed when opening or closing.**

 **Ensure that all adult passengers are familiar with the controls and the potential dangers of operating an electrically operated sunroof.**

 **Do not allow passengers to extend any part of their bodies through the sunroof aperture while the vehicle is moving - injury from flying debris, branches of trees or other obstructions could occur.**

 **Always close the roof when the vehicle is unattended.**

 **Never leave children alone in the vehicle as this could result in serious injury or death.**

 **It is recommended that the starter key be removed when leaving the vehicle.**

Driving with the sunroof open

If, when driving with the sunroof open, unwanted drafts are experienced, open the front facia air vents, and increase the blower speed if necessary. Do not operate the air conditioning.

Sunroof

Sunroof blind

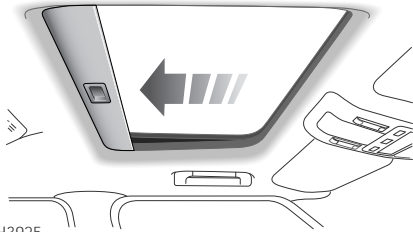

Pull the sunroof blind across the sunroof aperture to open and close.

Note: *The sunroof blind can be opened and closed manually, but will retract automatically when the sunroof is opened, and will open slightly if the roof is tilted.*

Caution: **It is not possible to fully close the sunroof blind with the sunroof in the tilt position. Attempts to close the blind may damage the sunroof mechanism.**

Operation after power supply interruption

If the vehicle power supply is interrupted, the sunroof will need to be recalibrated as follows:

- With the power supply reconnected, fully tilt the sunroof open.
- Continue to push the switch in the tilt position for approximately 20 seconds.

The sunroof can now be operated as normal.