

Compact Disc Player

COMPACT DISC PLAYER CONTROLS

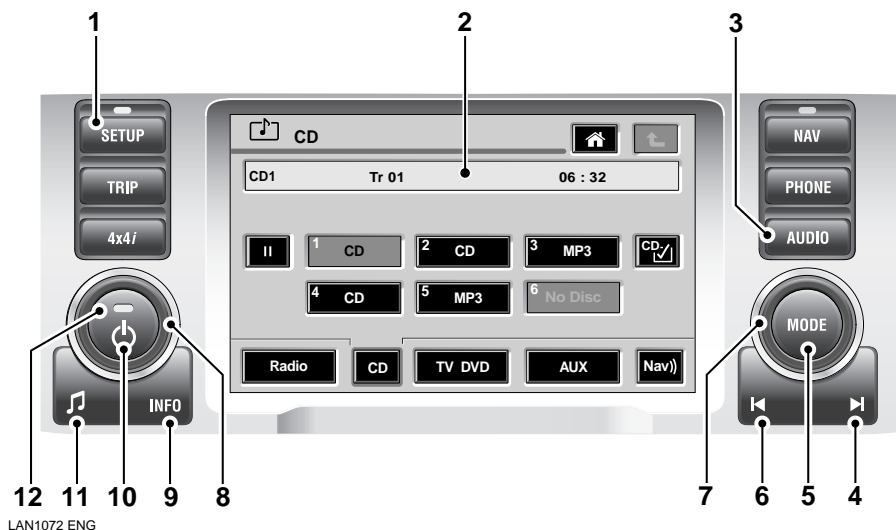

1. Settings
2. Touch screen display
3. A/V (audio/video)
4. Up/increase
5. Mode
6. Down/decrease
7. Audio
8. Volume
9. Info
10. Audio on/off
11. Tone
12. Audio on/off indicator

Dual/DVDPlus discs

Please be aware that a new generation of DVD discs is being adopted by the music industry. They are known as **Dual Discs** or **DVDPlus** discs. They have digital music on one side and video content on the other. Current in-car audio systems with a front loading CD player may load and play this type of disc. However, it is likely that the disc will not eject and may jam the mechanism. Such damage to a CD player will not be covered under warranty.

Note: The Infotainment system is operated by a combination of physical buttons on the touch screen surround and virtual buttons displayed on the touch screen. To avoid confusion when reading this handbook, the physical buttons are referred to as buttons and the on screen buttons as icons.

Compact Disc Player

CD AUTOCHANGER

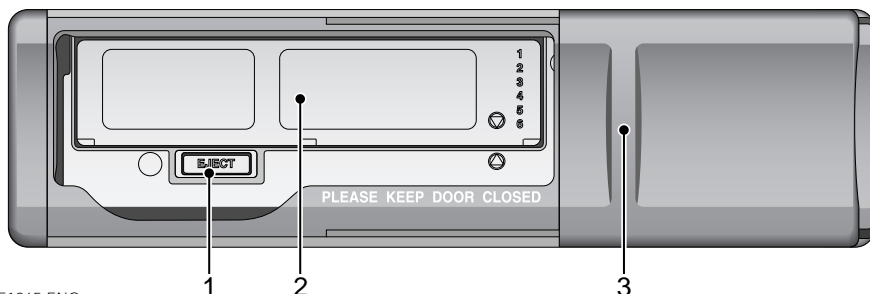

ICE1965 ENG

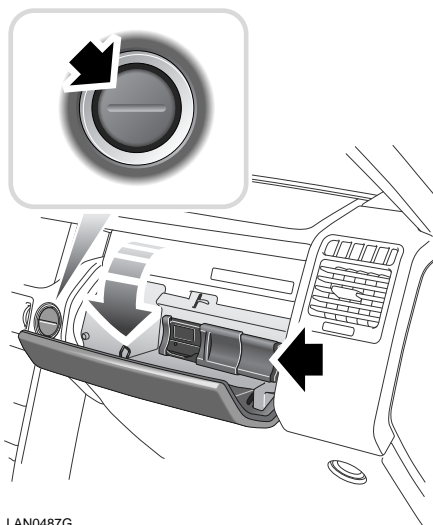

LAN0487G

The CD autochanger is located in the upper glove box on the passenger side of the vehicle. Press the release switch to open the glove box.

Fully open the sliding cover (3) to insert or remove the magazine (2).

Keep the cover closed at all other times, to prevent dirt and dust from entering the CD changer unit.

Press button (1) to eject the magazine.

CD autochanger maintenance

The manufacturers do not recommend the use of lens cleaning discs.

Loading and unloading the magazine

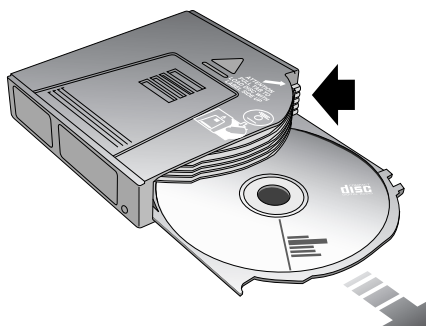

ICE1966 ENG

To unload the magazine, hold the magazine with the arrow uppermost, pull out each tray in turn by its tab (see arrow above), while holding the tray securely so as not to drop the disc.

Unload one disc at a time and handle only the edge and centre of the disc.

Compact Disc Player

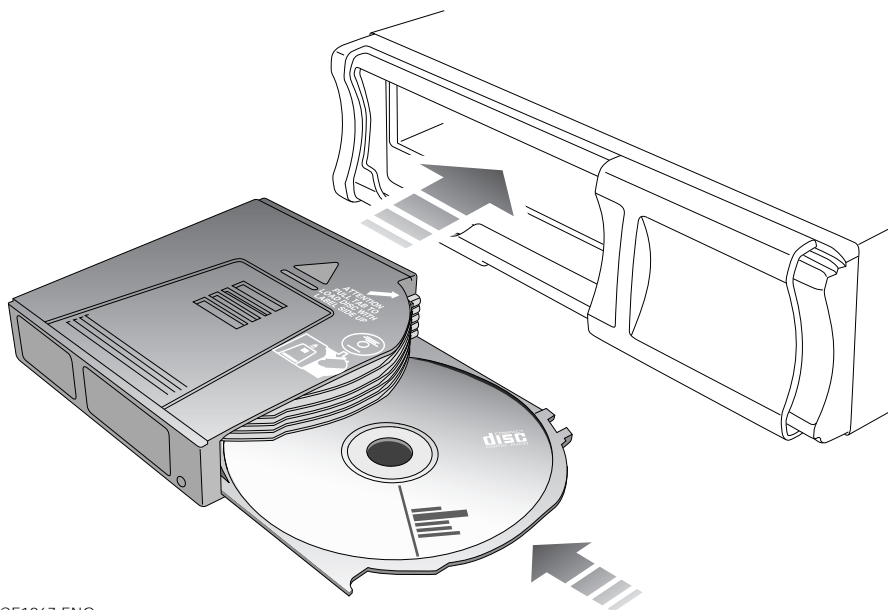

ICE1967 ENG

Place a disc (label side uppermost) onto each tray, holding only the outside edge and centre hole of the disc. Load only one disc in each tray. Correctly align the tray with the parallel slots on each side of the magazine and slide the tray fully into the magazine. Insert the magazine in the direction of the arrow marked on the magazine casing and push it fully into the CD changer. Close the sliding cover.

Important:

- The CD autochanger should only be used as described - any other application or method of use could result in the user being exposed to invisible laser radiation, exceeding the limit of laser Class 1.
- Use standard 12 cm CDs only.
- DO NOT use irregularly shaped or damaged CDs - these may damage the compact disc changer unit.

- 8 cm CD singles must not be used, even if a CD adaptor is fitted.
- Closed session CD-R and CD-RW discs can be played.
- The CD autochanger should not be used in temperatures outside the range -10°C to $+60^{\circ}\text{C}$ (14°F to 140°F). If the CD autochanger reaches temperatures higher than recommended for normal use, **HIGH TEMP** appears in the display. If this occurs, stop using the CD player, eject the magazine and allow the autochanger to cool down. If the problem persists, consult your Dealer/Authorised Repairer.

Note: Additional magazines can be obtained from a Land Rover Dealer/Authorised Repairer.

Compact Disc Player

CD CONTROLS

Selecting CD audio source

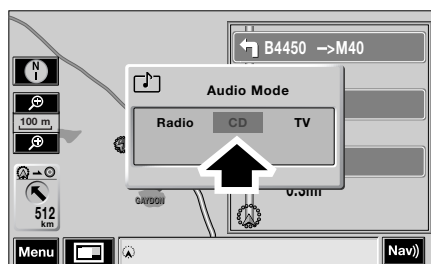
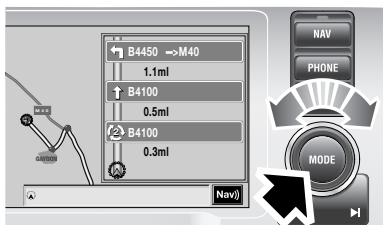

LAN1073 ENG

To select CD as the audio source, press the **MODE** button, which will display the Audio Mode pop-up. **CD** can be selected as the audio source by rotating the audio control, until **CD** is highlighted.

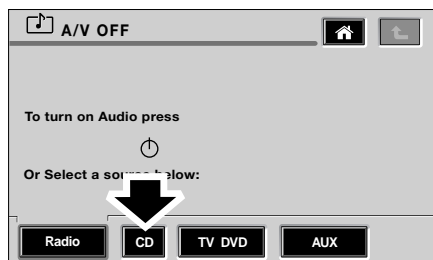

ICE2118 ENG

Alternatively, if any other audio source is currently in use, press the **CD** icon.

Playing CDs

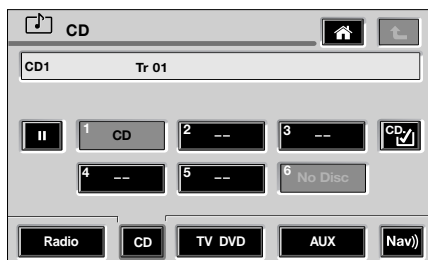
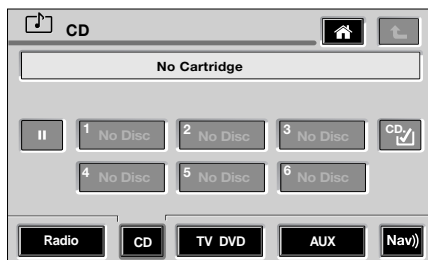

LAN1182 ENG

If CD mode is selected prior to inserting the magazine, the display will show **No Cartridge**. Once the magazine has been inserted, there will be a short delay whilst the system reads the discs, during which **Please Wait - Loading** will be displayed.

Once the magazine has loaded and the discs have been read, play will commence with disc one, track one.

Compact Disc Player

Selection/search controls

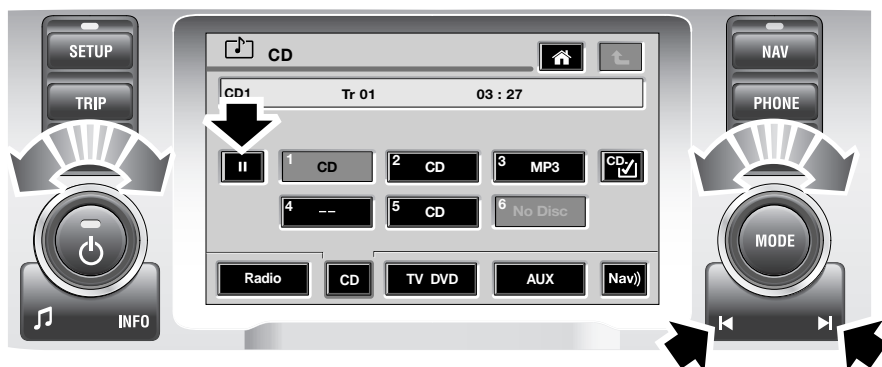

LAN1074 ENG

Track selection: With a CD playing, briefly press the right hand seek button to skip to the beginning of the next track, or the left seek button to return to the start of the current track. Press either button repeatedly, to reach the desired track.

Track search (fast forward/reverse): Press and hold either seek button to play rapidly, forward or back, through one or more tracks. Normal playback will resume when the button is released.

Pause

Touch the pause icon to suspend play; touch the icon again to resume play from the point at which it was suspended.

Disc selection icons (1-6)

With the CD changer selected, press the appropriate icon to select a disc from the changer. Playback will start from the beginning of that disc and progress sequentially through all the discs in the disc changer.

Note: *The audio system can only recognise a disc type after it has read the disc at least once.*

An empty compartment cannot be selected because the icon will be grey. If a CD is inserted upside down or a faulty CD inserted then the icon for that compartment remains at -- and the display shows **INVALID DISC**. Another disc must then be selected.

Compact Disc Player

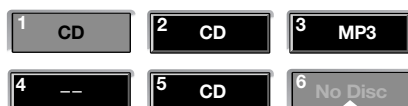
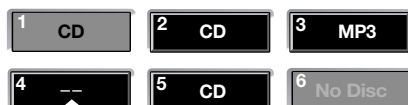
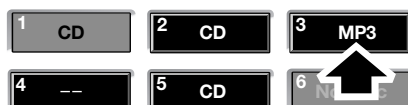
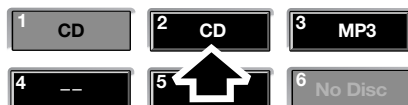
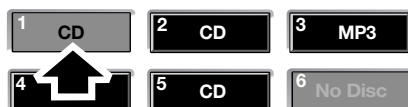

ICE2121 ENG

- **Icon-1**
Shows the currently playing CD.
- **Icons-2 & 5**
Position occupied by CD.
- **Icon-3**
Position occupied by MP-3 disc.
- **Icon-4**
Various reasons, e.g. disc not read yet or faulty disc or upside down disc etc.
- **Icon-6**
No disc in this position.

Playback features

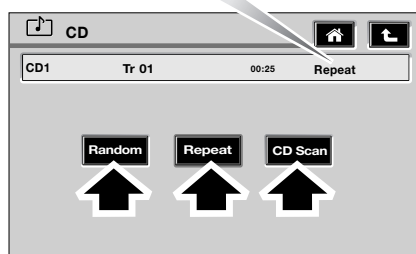
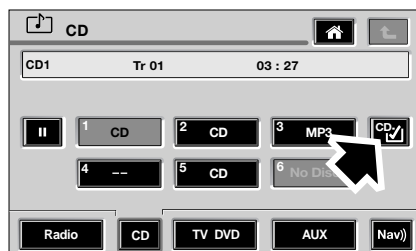

LAN1205 ENG

A selection of additional playback features are made available, by touching the CD settings icon (arrowed in top illustration).

- **Random**
The track order of play from the current disc is randomly selected by the CD player.
- **Repeat**
The CD player plays the current track continuously, from start to finish, again and again until repeat is cancelled.
- **Scan**
CD scan will play each track on the current disc in turn for ten seconds, until all tracks have been played. Play then resumes with the track from which Scan was initiated. This enables the user to sample each track before choosing one to listen to.

Compact Disc Player

To cancel any of the playback features:-

- Touch the feature icon that is in use.
- Select another playback feature.
- Press the forward or reverse buttons.
- Switch off the audio unit or the ignition switch.
- Eject the CD magazine.

Playing MP3 discs

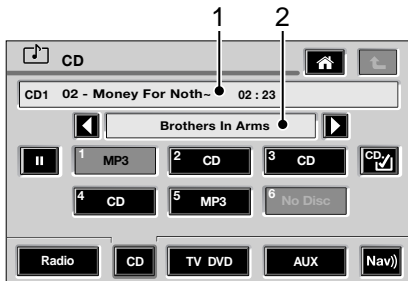

The CD unit is capable of playing MP3 discs, which are loaded into the magazine in the usual way.

Note: A mixture of both CDs and MP3 discs can be loaded into the magazine at the same time.

During playback of an MP3 disc (1), an additional information screen is displayed (2). If the MP3 disc has been recorded with the music files contained within folders, then the additional information screen will display folder information.

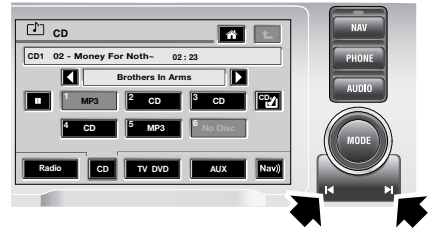

LAN1075 ENG

To move between tracks in a folder, use the up/down buttons.

Compact Disc Player



LAN1184 ENG

To move between folders, use the left/right icons alongside the additional information screen.

Track or file information is displayed in the usual way, via the top information screen.

Drivers message centre display.

When operating the radio/CD from the steering wheel mounted buttons, a message appears in the drivers message centre display below the instruments.

MP3 folder and track format

A CD-R or CD-RW can have MP3 folders and tracks recorded in many different ways, with many layers of folders and with tracks distributed throughout the folder structure. To minimise the loading on the system, a rigid folder structure is required. Therefore, only one level (or layer) of folders is permitted. Up to 20 folders, with a maximum of 20 characters per folder title, are permitted in this level. Up to 50 tracks can exist in the root directory and up to 50 tracks can exist in each folder.

Note: Any folder located within another folder will be ignored.

Note: Any CD containing a mixture of MP3 and CD-DA tracks will be treated as a CD (any MP3 tracks will be ignored).

Note: The CD autochanger may take a long time (1 minute or more) to load a disc, if the disc contains several sessions. The customer can create CDs with up to 40 sessions, but this will result in a prolonged loading time.

Note: The CD player is not guaranteed to play every disc available on the market, because of variations in the quality of discs available.