

STANDARD RADIO CONTROLS

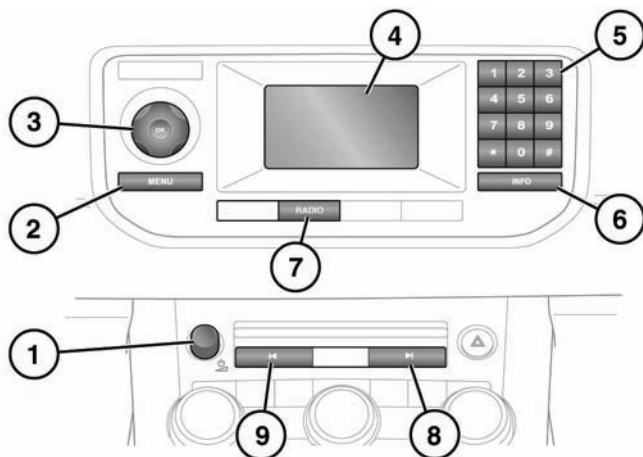

SL2144

See **114, STANDARD AUDIO CONTROLS.**

1. Press to switch on/off.

Note: The radio will switch off automatically after approximately 10 minutes if the ignition is turned off.

Rotate to adjust volume level.

Note: The maximum volume level will be restricted if the audio unit is used with the engine switched off.

2. **MENU** button:

- Audio settings
- Clock settings
- Language

3. **OK** and navigation control.

Use to move any menu cursor/highlight up, down, left or right. When the required option is highlighted, press **OK** to select.

4. Audio Information display.

5. Keypad.

6. **INFO.** Traffic/News information.

7. **RADIO.** Waveband select (FM, FMAST, AM, AMAST).

When DAB is fitted, select for DAB1 or DAB2.

8. Seek up:

- Short press:
 - to select the next radio station upward in frequency.
- Long press:
 - to enter radio manual seek mode. In radio manual seek mode further short presses will change the frequency in single increments.

9. Seek down:

- Short press:
 - to select the next radio station downward in frequency.
- Long press:
 - to enter radio manual seek mode. In radio manual seek mode further short presses will change the frequency in single decrements.

AUTO STORING RADIO STATIONS

AutoStore can be used to store the stations with the strongest signals available, either from the AM or the FM waveband.

Using Autostore:

1. Press the **RADIO (7)** button to select the desired waveband.
2. Find a station. If necessary, use the seek buttons (**8** and **9**).
3. Press and hold the **RADIO (7)** button until the display confirms that Autostore is in progress.

The system will search for stations with the strongest signals on the selected waveband. While the search is in progress, volume is muted.

When the search is complete, the previous volume level will be restored. The radio will switch to the FM-AST or AM-AST waveband where the strongest signal stations have been stored on the Autostore presets.

Note: *Autostore will store up to a maximum of the 10 strongest signals available and overwrite the previously stored stations.*

Note: *The Autostore waveband can also be used to store stations manually, in the same way as other wavebands.*

RADIO STATION PRESETS

This feature allows favourite stations to be stored so that they can be recalled later.

1. With the **RADIO (7)** button, select a waveband.
2. Tune to the required station. The station will begin play.
3. Press and hold one of the keypad buttons.
4. The station will be stored. Volume will mute momentarily as confirmation.
5. Release the button.

This can be repeated on each waveband and for each keypad button.

Note: *When driving to another area of the country, FM stations that broadcast on alternative frequencies and are stored on preset buttons, may be updated with the correct frequency for that area.*

RADIO DATA SYSTEM (RDS)

Your audio unit is equipped with RDS, which enables the audio unit to receive additional information with the normal radio signals.

On the FM waveband, RDS enables the audio to receive traffic and news information broadcasts. RDS also allows the audio to automatically re-tune to stations that are linked to the same network, if that network allows this.

Note: *Not all FM radio stations broadcast RDS. If a non-RDS station is selected, RDS features will not be available.*

REGIONALISATION (REG)

As you drive into different radio reception areas, RDS automatically re-tunes the radio to the strongest signal. When REG is on, the tuner is locked to the current local radio station. With REG switched off, the tuner is allowed to switch to a stronger Enhanced Other Network (EON) when the current EON linked radio station signal becomes weak.

To turn REG on:

1. Press the **MENU (2)** button.
2. Select **Audio Settings**.
3. Select **Regionalisation**.
4. Press **OK** to enable or disable REG.

ALTERNATIVE FREQUENCY (AF)

Some radio stations broadcast on different frequencies in different parts of the country. If the selected station signal weakens, the radio will automatically re-tune to a stronger Alternative Frequency (AF), if one is available. This feature is particularly useful on long journeys, where the vehicle travels through different transmitter areas serving the same radio station.

To enable/disable AF:

1. Press the **MENU (2)** button.
2. Select **Audio Settings**.
3. Select **ALTERNAT.FREQ.** Turn AF on or off.
4. Press **OK**.

SELECTING TRAFFIC INFORMATION

Normal reception can be interrupted to broadcast traffic information from stations on the FM waveband using the Radio Data System (RDS) and Enhanced Other Network (EON) links.

When a radio station capable of providing traffic information is selected, the **TP** indicator appears on the top line of the display.

Briefly press the **INFO (6)** button to select the Traffic Announcement (TA) function. The **TA** indicator appears on the top line of the display.

As soon as a traffic announcement is received, current audio entertainment is interrupted and **Traffic** appears in the display, along with the name of the station providing the information.

If a non-traffic station is selected or recalled using a preset button, the audio unit will remain on that station unless **TA** is turned off, then on again.

To cancel a Traffic announcement, briefly press the **INFO** button, or alternatively the **MODE**

button on the steering wheel, during the announcement. This will not turn off **TA**.

To deselect the TA function, briefly press the **INFO** button again. The **TA** indicator will disappear from the display.

TRAFFIC ANNOUNCEMENT VOLUME

Traffic announcements interrupt normal broadcasts at a preset minimum level that is usually louder than normal listening volumes. To adjust the volume of traffic announcements, use the volume control during an incoming TA broadcast. The display will show the level selected.

All subsequent traffic announcements will be at the set volume.

SELECTING NEWS INFORMATION

Normal reception can be interrupted to broadcast news bulletins from stations on the FM waveband using the Radio Data System (RDS) and Enhanced Other Network (EON) links, in the same way that traffic information is provided.

To set the NEWS feature:

1. Press the **MENU (2)** button.
2. Select **Audio Settings**.
3. Select **News**.
4. Press **OK** to enable or disable the News feature.

To cancel a News announcement, briefly press the **INFO** button, or alternatively the **MODE** button on the steering wheel, during the announcement. Select **INFO** again to turn off the News feature.

Note: Both traffic and news information can be selected at the same time. However, the radio will always give priority to traffic information.

TIME AND DATE SETTINGS

1. Press the MENU (2) button.
2. Select **Clock settings**.
3. Select a clock function.
4. Once the change has been entered, press **OK**

LANGUAGE SELECTION

To select a display language:

1. Press the **MENU (2)** button.
2. Select **Language**.
3. Once the change has been entered, press **OK**

DIGITAL (DAB) RADIO

If your vehicle is equipped for digital radio, press the **RADIO(7)** button to select either of two groups DAB1 or DAB2. These two groups permit the storing of a total of 20 preset stations or 'services' (ten in each group) using the buttons 0-9 on the keypad (5).

DAB radio can significantly increase the number of radio stations available. The DAB signals are transmitted to most major cities, towns and motorway networks.

Unlike AM/FM radio, digital transmits several services on a single frequency. This group of services is known as an ensemble. There may be a number of ensembles receivable in some areas, each typically carrying between six and twelve services.

Digital radio is transmitted from regional and local transmitters. Some services are national or regional and are replicated on multiple transmitters throughout the region or country. Other services are local and only available within a limited range of one transmitter.

FINDING DIGITAL SERVICES

Press the seek buttons (8 or 9) to search the waveband to find the local active ensembles. Note: Alternatively the steering wheel seek buttons can perform the same function.

The national channels use the same ensembles throughout a country and so there is usually no need to search for these. If you have stored your favourite national channels already then they will usually be found immediately on the same pre-set buttons.

If reception is lost when the vehicle is in motion, the vehicle may be moving out of range of the ensemble. Use the seek buttons (8 or 9) buttons to search for services which are stronger in that area.

Note: If any auxiliary electrical equipment is connected to the vehicle, DAB radio reception capability may be reduced.

SELECTING AND STORING DIGITAL SERVICES

Select DAB1 or DAB2. In each band the active station will be the last one used. To select another station, press the appropriate preset button (0 to 9).

Any preset can be used to store any Digital Radio service, from any ensemble. If you switch between presets which are on different ensembles, the tuning time can take a few seconds (the word '**Searching...**' briefly appears on the screen). Switching between services within the same ensemble is virtually immediate.

If there is no service stored on a pre-set, or if the service is not receivable at the current location, the message '**No Reception**' will be displayed.

If the service you want is not already stored in a preset button or cannot be received, then you can step through the other services in the current ensemble by repeated short presses on the Seek-up or Seek-down buttons. At the end of the ensemble, a further press will show '**Searching...**' for a few seconds and then the next ensemble will be shown. You can then step through each service in this new ensemble by repeated short presses as above.

To store a service on a preset: While playing the desired service, press and hold the desired preset button. A bar-graph will show, indicating how long you need to hold the button, followed by a 'Preset Stored' pop-up message. Now release the button.

DAB SERVICE LIST

A quick way to see all the services available on the presets and all the other services which may be received in the current ensemble is to use the navigation control (3) to go to the waveband list, select either DAB1 or DAB2, then the right navigation button to list the presets of DAB1 or DAB2. If the desired station is not listed, there is a **Service List** option at the top of the list. Scroll up to the **Service List** item and press the right navigation button to see all the services of the current ensemble listed. Use the navigation control up/down buttons to scroll up and down the list. If you want to select a service, scroll the outline box onto the desired service and press **OK**.

DAB MANUAL TUNING

Press and hold the seek-up or seek-down buttons for approximately 3 seconds to enter **Manual Tuning**. The **Manual Tuning** pop-up will appear on the display. Using the seek-up or seek-down buttons you can then move through all the services and ensembles in turn.

If an ensemble is empty or not receivable then the tuning will move along to the next. If an ensemble is only just strong enough to receive but the services are too weak to use, the tuning may stop on that ensemble and display the ensemble's name, and possibly the service's name, but without sound. If no sound is heard within 5 to 10 seconds then press the appropriate seek button again to move onto the next useable ensemble.

To select and play a service of your choice, locate it and ensure that the audio is receivable, then press **OK**.

The **Manual Tuning** mode allows up to 30 seconds of inactivity before it times out. If **Manual Tuning** times out with no new service tuned, the radio will revert to the service you were tuned to at the start of your Manual Tuning session.

SERVICELINK

ServiceLink is an item on the Menu (2) and can be enabled or disabled using the **OK** button.

When ServiceLink is enabled, two additional features come in to operation:

- If you are listening to a local service which has a partner service in an adjacent area, when the signal weakens it will automatically changeover to new area's partner service.
- If you have selected a digital service which has an equivalent FM service in the area and your digital service has deteriorated, then the radio will automatically switch to the alternative FM service until the digital reception becomes adequate again.

We advise that ServiceLink is switched off when searching for ensembles or using Manual Tuning.

DAB DISPLAYED MESSAGES

'**Searching....**' is displayed when the radio is tuning itself to the correct ensemble. You will see this for a few seconds during some preset changes, and when seeking up or down to another ensemble.

If ServiceLink is enabled and no alternative signal can be found, 'Searching....' may show for a long period of time since in this mode the radio will continue to search round all the bands automatically until you command it to go to a different service or switch off ServiceLink.

'**No Reception**' is displayed when ServiceLink is not enabled and you have selected a service which cannot be received in the vehicle's current position. Select an alternative service, or search for an alternative ensemble.

'**Serv00**', '**Serv01**' etc. may be shown when the radio can detect signals from an ensemble but cannot decode the service names. These are default labels to replace the non-receivable service names. In these cases the audio is generally impossible to receive from the vehicle's current location. Select an alternative service, or search for an alternative ensemble.

STANDARD PORTABLE MEDIA CONTROLS

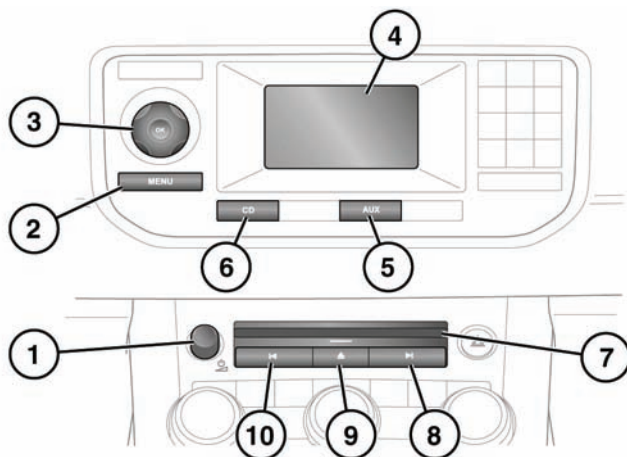

SL2121

1. Press to switch on/off. Rotate to adjust volume level.
2. **MENU** button:
 - Audio settings
3. **OK** and navigation control.
Use to move any menu cursor/highlight up, down, left or right. When the required option is highlighted, press **OK** to select.
4. Audio Information display.
5. **AUX** input select. Use when a portable device is connected.
6. **CD** menu.
7. CD loading slot.
8. Seek up:
 - Short press:
- to select the next track on chosen audio source.
 - Long press:
- to scan forward through a CD track or MP3 folder.
9. CD eject button.
10. Seek down:
 - Short press:
- to select the next track on chosen audio source.
 - Long press:
- to scan backward through a CD track or MP3 folder.

LOADING A COMPACT DISC

 Do not use discs with paper labels, dual discs or DVDPlus discs. The front loading CD player may load and play this type of disc, however it is likely that the disc will not eject and will block the CD mechanism. Such damage to a CD player will not be covered under warranty.

 Do not force the disc into the CD loading slot.

Note: *Copy-protected CDs may fail to play in your CD player or may be played subject to various limitations (e.g. sound quality may be impaired). If you experience a problem, try the CD in other players before contacting the CD vendor.*

The unit will play compact discs that conform to the international Red Book standard audio specification.

The unit will play Compact Disc Digital Audio (CDDA) discs, MP3, WMA and AAC files.

It is recommended that only high quality 12 cm (4.7 in.) circular discs are used.

Gently place a CD into the loading slot, the disc will be drawn into the player and begin play.

If a CD is already loaded, playback will resume from the point of last play.

TRACK SELECTION

When playing a CD, the display will show the current track being played and the time elapsed since the current track began to play.

To select a CD track for play:

1. Use the navigation control **(3)** right button to access the track list of the currently playing CD.
2. Use the navigation control up or down buttons to scroll to a track.

3. Press **OK** to select the track for play.

REPEAT AND SHUFFLE

Repeat will play the current track repeatedly. Shuffle alters the playback order for the current CD, so that tracks are played in a random sequence.

To turn Repeat or Shuffle on when a CD is playing:

1. Press the **MENU (2)** button.
2. Select **Audio Settings**.
3. Select **Repeat** or **Shuffle**.
4. Press **OK**.

MP3 FILE PLAYBACK

MP3 discs have the potential to hold more music than a conventional CD, because each track can be compressed to a greater degree during recording.

If an MP3 CD is to be used, each session must be properly closed after recording but the whole disc does not have to be finalised.

The highest compression rate supported, is 320 kbits per second (kbps). If anything less than 128 kbps is used, Digital Signal Processing (DSP) functionality may be lost.

The normal playing sequence on CDs with multiple folders, is to play the tracks within the top level first, then the tracks in any sub-folders.

If a CD contains a mixture of MP3 and CDDA tracks, any MP3 tracks will be ignored.

1. Use the navigation control **(3)** right button to access the track list of the currently playing folder. Use the left button to access the folder list.
2. Use the navigation control up or down buttons to scroll to a track or folder in the list.

Standard audio

3. Press **OK** to select the track for play or a folder to open.

MP3 REPEAT AND SHUFFLE

When an MP3 CD is playing, playback options include **Repeat** and **Shuffle**.

PORTABLE MEDIA CONNECTIONS

Portable devices can be connected to the vehicle media hub. Device types include:

- USB mass storage devices (e.g. a memory stick). Devices must use FAT or FAT32 file format.
- iPod (iPod Classic, iPod touch, iPhone and iPod Nano are supported - full functionality for older devices cannot be guaranteed). iPod Shuffle functionality cannot be guaranteed.
- Auxiliary device (personal audio, MP3 players, all iPods).
- Devices with Bluetooth® connectivity. Devices must support A2DP and AVRCP Bluetooth® protocols).

Note: iPod® is a trademark of Apple Computer Inc., registered in the US and other countries.

When connecting a portable storage device, use the **AUX (5)** button. Many of the controls are similar to those available for CD play.

-  Please disconnect your iPod when leaving the vehicle. Failure to do so may result in the iPod battery discharging.

To maximise playback quality, use lossless compression for any media files on iPod. Failing this, it is recommended that compressed files utilise a minimum bitrate of 192 kb/s (a higher bitrate is strongly recommended).

For media files delivered via USB or MP3 players, the highest compression rate supported, is 320 kbits per second (kbps). If anything less than 128 kbps is used, Digital Signal Processing (DSP) functionality may be lost.

Note: Some MP3 players may have their own file system that is not supported by this system. To use your MP3 player, you must set it to USB Removable Device or Mass Storage Device mode. Only music that has been added to the device in this mode can be played.

CONNECTING A DEVICE

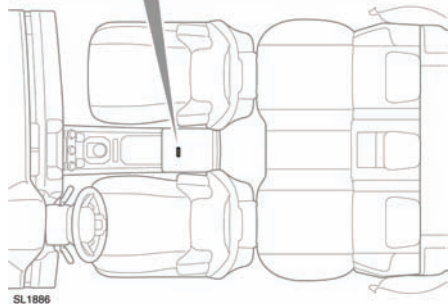
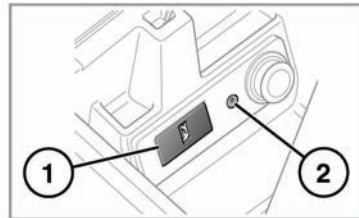

1. USB/iPod socket.
2. 3.5 mm AUX socket.

Connect the device into the appropriate socket.

Note: Use the cable supplied with your media device to connect to the USB socket.

When an iPod is connected, playback will continue from the point at which it was last playing, provided the iPod battery is in a good state of charge.

STANDARD TELEPHONE CONTROLS

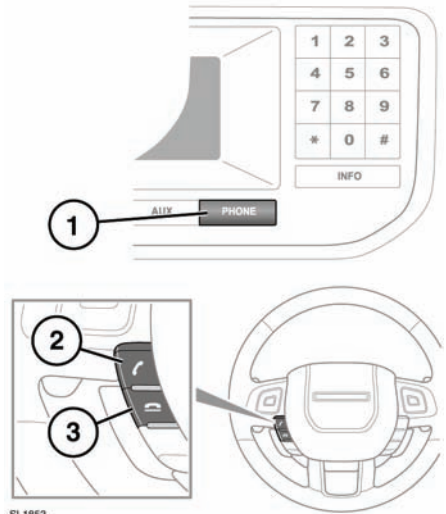

SL1853

1. Press to activate or deactivate telephone mode.
2. Press to answer a call or to dial a number.
3. Press to end a call or to reject an incoming call.

BLUETOOTH® INFORMATION



Bluetooth® is the name for short-range radio frequency (RF) technology that allows electronic devices to communicate wirelessly with each other.

The Land Rover Bluetooth® system supports Bluetooth® Hands-Free Profile (HFP), Advanced Audio Distribution Profile (A2DP) and Audio Video Remote Control Profile (AVRCP).

Note: HFP and A2DP/AVRCP profiles can be connected independently, so a phone can be connected via one, while a media device can be connected via the other, at the same time.

Before making use of the vehicle's Bluetooth phone system, your Bluetooth phone must be paired and connected to the vehicle system.

This is done via your mobile phone.

See **PAIRING AND CONNECTING USING THE MOBILE PHONE** (page 174).

Each time the ignition is switched on the system will attempt to connect with the last connected phone.

As mobile phones have a wide range of audio and echo characteristics, it may take a few seconds for the vehicle system to adapt and deliver optimum audio performance. To achieve this, it may be necessary to reduce the in-vehicle volume and ventilation fan speed slightly.

TELEPHONE COMPATIBILITY

Please refer to the Ownership section of the Land Rover website at www.landrover.com, for a list of compatible phones.

Note: The Bluetooth® equipped phones listed, have been tested for compatibility with Land Rover vehicles. Performance will vary, based on the phone's software version, battery condition, coverage and your network provider. Phones are warranted by their manufacturer, not Land Rover.

If the mobile phone paired to the system supports the Bluetooth® Hands-Free Profile (HFP), additional features will be available such as battery meter and signal strength. Refer to the mobile phone's display to determine these items.

TELEPHONE SAFETY



Switch off your telephone in areas with a high explosion risk. This includes filling stations, fuel storage areas or chemical factories, as well as places where the air contains fuel vapour, chemicals or metal dust.



Always stow your mobile phone securely.



The functioning of cardiac pacemakers or hearing aids may be impaired when the phone is in use. Check with a doctor or manufacturer whether any such devices you or your passengers are using, are sufficiently protected against high-frequency energy.

The Health Industry Manufacturers' Association recommends that a minimum separation of 15 centimetres (6 inches) is maintained between a wireless phone antenna and a pacemaker, to avoid potential interference with the pacemaker. These recommendations are consistent with the independent research by, and recommendations of, Wireless Technology Research.

PAIRING AND CONNECTING USING THE MOBILE PHONE

Note: The process of pairing and connecting your phone with the vehicle using your mobile phone, will vary depending on the type of mobile phone used.

1. Switch the ignition on and ensure that the audio system is active and that no other phone is currently connected to the vehicle's Bluetooth® system.

- Using the mobile phone, search for Bluetooth® devices. On some phones, this is referred to as a new paired device. See your phone's operating instructions for further information.
- When the vehicle's Bluetooth® system is discovered (named Range Rover Evoque), select this device from the list.
- When prompted, enter the Bluetooth® PIN (Personal Identification Number) into the mobile phone. This four digit number is randomly generated by the vehicle system and will be displayed on the screen.
- Once your phone is paired and connected to the system, it can dock automatically. If it does not automatically dock, you will have to connect manually with the Land Rover Bluetooth® system, via the mobile phone. Please consult the mobile phone's instructions for further information.

Note: Some mobile phones require the Bluetooth® pairing to be set as 'authorised' or 'trusted' in order to automatically connect. Please refer to your phone's operating instructions for further information.

CALL VOLUME

The phone call volume is operated by the audio system's volume control.

If the audio system is in use when a phone call is active, the audio source is suppressed for the duration of the call. Parking aid warnings are not suppressed.

ANSWERING/REJECTING/ENDING CALLS

- Press **PHONE (1)** or the steering wheel control **(2)** to answer an incoming call.
- To reject or end a call, press the **PHONE (1)** button or the steering wheel control **(3)**.

DIALLING

- With **PHONE (1)** or the steering wheel control **(2)** selected, use the numeric keypad to enter a telephone number.
- Press **OK** or the steering wheel control **(3)** to dial the number.

If the audio system is in use when a phone call is active, the audio source is suppressed for the duration of the call. Parking aid warnings are not suppressed.