

CONTROLS (FRONT TOUCH SCREEN)

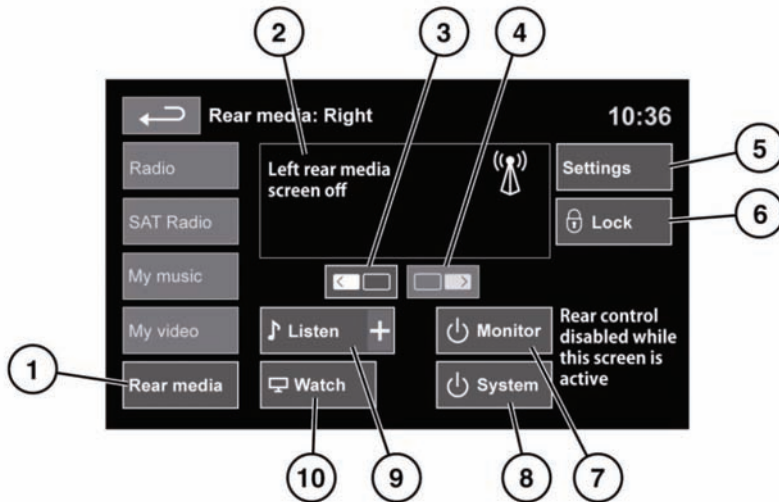

E130666

⚠ WARNING

Do not adjust the touch screen controls, or allow the system to distract the driver, while the vehicle is moving. Driver distraction can lead to accidents, causing serious injury or death.

1. Select rear media.
2. Current rear media display.
3. Left screen select.
4. Right screen select.
5. Settings screen.
6. Remote control lock.
7. Turns off the selected screen.
8. Turns off the selected system.
9. Audio source select.
10. Video source select.

REAR MEDIA CONTROL FROM THE TOUCH SCREEN

When the main rear media control screen is displayed on the touch screen, the rear media remote control will be locked out. No part of the rear media system will operate until it is turned on via the touch screen.

REAR MEDIA SETTINGS

The rear media settings screen allows **Limousine Mode** to be turned on or off.

When **Limousine Mode** is selected, the rear passengers can control the total cabin audio system via the remote control.

Rear seat entertainment

REMOTE CONTROL

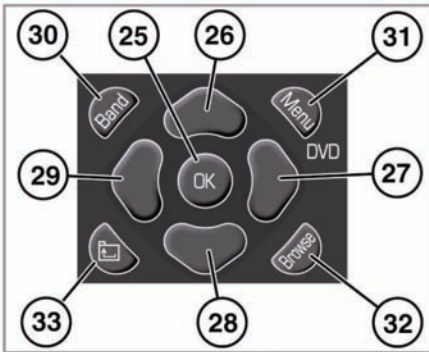

E136156

1. RSE on/off.
2. Cabin audio on/off (operates in Limousine mode only).
3. Cabin audio volume increase/decrease (operates in Limousine mode only).
4. Right user system select.
5. Screen brightness control: Select from day, night and auto.
6. Video screen format/zoom.
7. Rear USB socket select (video).
8. AUX socket input select (video).
9. iPod input select.
10. DAB radio select (market dependant).
11. Rear USB socket select (audio).
12. Data disc select (audio).
13. Indicates color of buttons with audio function.
14. Indicates color of buttons with video function.
15. CD select.
16. SAT radio select (market dependant).
17. Radio select.
18. DVD select.
19. Data disc select (video).
20. TV select (market dependant).
21. Screen on/off.
22. Left user system select.
23. Seek forward and backwards for selected source and next/previous chapter for DVD.
24. Play/Pause for all non-live media (USB/ iPod/ CD/ DVD/ Data Disc).
25. Press to select highlighted station/channel/menu item.
26. DVD menu navigation: Press to move up.
27. DVD menu navigation: Press to move right.

28. DVD menu navigation: Press to move down.
29. DVD menu navigation: Press to move left.
30. Radio band selection.
31. DVD menu display.
32. Browse: Select to view contents of connected device or CD.
33. Open next folder up.

USING RSE

Note: *On new remote controls, a plastic strip isolates the battery from the electrical contacts. Before you use the remote control for the first time, pull out and discard the plastic strip.*

Once rear seat entertainment has been selected on the touch screen, it can be operated with the remote control. To ensure the system responds to your selections, the upper end of the remote control should be pointed towards the applicable screen in the back of the front head restraint.

To activate the system, press the RSE on/off button (1), followed by the applicable user system button (4 or 22) and then the required audio or video function button. Subsequent selections on the remote control will operate the last selected user system. To avoid accidental operation of the wrong user system, it is advisable to always select the required user system before making any other selection.

HEADPHONES

The volume control for each set of headphones is adjusted on the headphones.

Press the channel selector button to cycle through available channels. Select the channel appropriate for the required screen.

Note: *These headphones are not intended for use by the driver or outside the vehicle.*

Note: *The earpiece exteriors must remain exposed to the infra red transmitter in the overhead console. Any barrier will prevent them from working correctly.*

When not in use, the headphones should be turned off.

WARNING

Always store headphones safely when not in use. Do not leave them unsecured as they may cause injury in the event of sudden braking or impact.

REMOTE CONTROL BATTERY

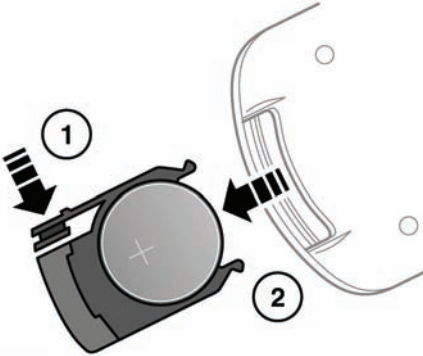

E136271

To renew the battery:

1. Press the locking catch inwards.
2. Pull out the battery cradle.

Install a new CR2025 type battery (available from your Land Rover Retailer/Authorized Repairer), with the positive (+) side positioned as shown.

NOTICE

Avoid touching the new battery, as moisture/oil from fingers can reduce battery life and corrode the contacts.

Push in the battery cradle and ensure the locking catch is engaged.



Battery disposal: Used batteries must be disposed of correctly, as they contain harmful substances. Seek advice on disposal from your Land Rover Retailer/Authorized Repairer or local authority.