

JACKING POINTS

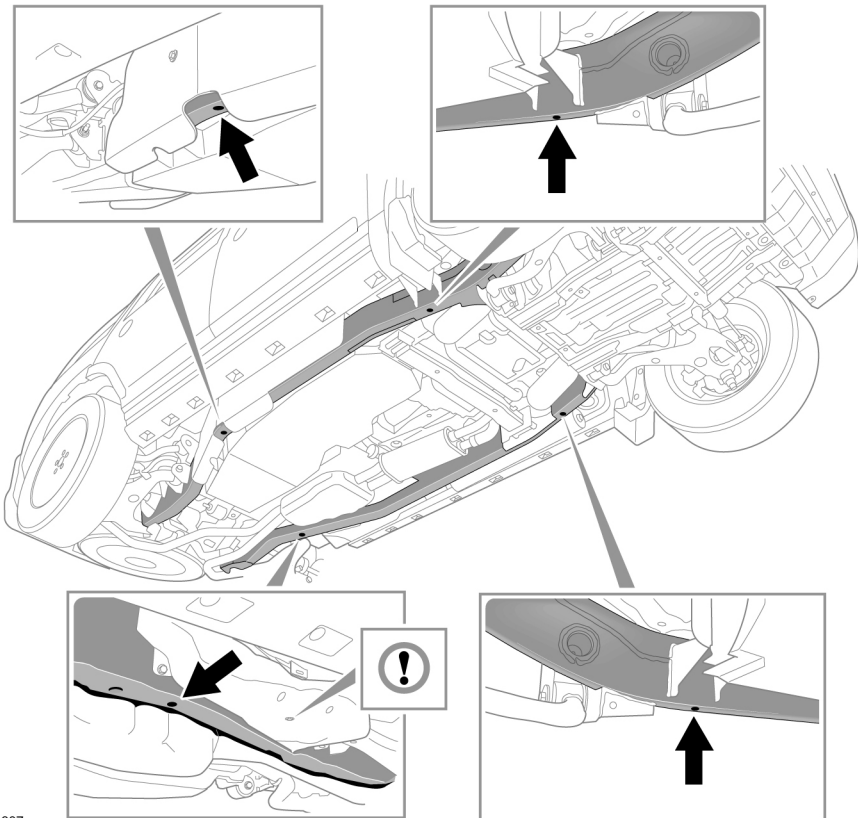

SL1907

- ⚠ DO NOT insert the jack pin into this hole. Doing so will damage the air suspension compressor pump.

RAISING THE VEHICLE

- ⚠ Ensure that the jack is on firm level ground.
- ⚠ Never place anything between the jack and the ground, or the jack and the vehicle.

- ⚠ Before raising the vehicle, chock the road wheels using suitable wheel chocks. Place the chocks on both sides of the wheel diagonally opposite the wheel to be changed.

- ⚠ If jacking the vehicle on a slight slope is unavoidable, place the chocks on the downhill side of the two opposite wheels.

Wheel changing

 Take care when lifting the spare wheel, and removing the punctured wheel. The wheels are heavy and can cause injuries if not handled correctly.

 Take care when loosening the wheel nuts. The wheel brace may slip off if not properly attached and the wheel nuts may give way suddenly. Either unexpected movement may cause injury.

 The jack is designed for wheel changing only. Never work beneath the vehicle with the jack as the only means of support. Always use vehicle support stands before putting any portion of your body beneath the vehicle.

 Always position the jack from the side of the vehicle, in line with the appropriate jacking point.

 Only jack the vehicle using the jacking points described, or damage to the vehicle could occur.

Note: Before positioning the jack under the vehicle, ensure that the air suspension is set to off-road height.

Note: Your vehicle is fitted with a tilt sensor which activates the alarm if the vehicle is tilted in any direction after it has been locked. If you wish to have the doors locked while jacking up the vehicle, lock the doors by pressing the lock button on the remote control once.

REMOVING THE TROLLEY JACK

The trolley jack is stowed beneath a floor panel in the rear loadspace area.

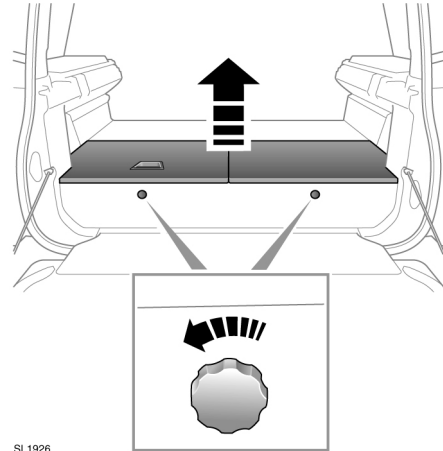

SL 1926

Remove the LH panel and then the RH. Reverse the process when refitting.

 The trolley jack is very heavy. Take care when lifting and particularly when removing it from the rear loadspace and when lifting it back into the vehicle. Use the handle attached.

OPERATING THE TROLLEY JACK

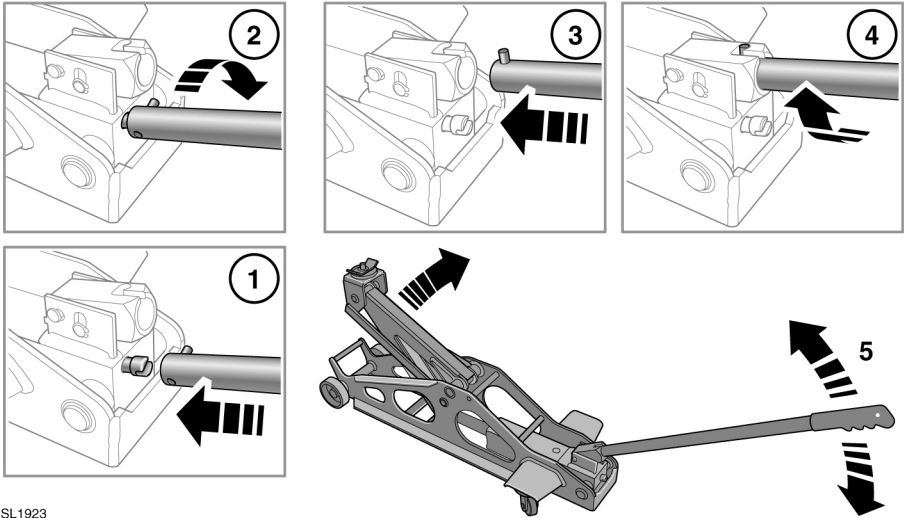

SL1923

Raising the jack:

1. Locate the open end of the jack lever over the jack release valve.
2. Turn the valve fully clockwise to close it.
3. Insert the jack handle into the receiver on the jack.
4. Turn the jack handle clockwise to secure it in place.
5. Position the jack beneath the jacking point.
6. Operate the jack handle up and down to first locate the pin on the jack head into the hole in the chassis.
7. Continue operating the jack lever to raise the vehicle.
8. When the vehicle is sufficiently raised to perform a wheel change, remove the jack lever.

When the vehicle is at the required height, remove the handle from the jack.

Lowering the jack:

1. Locate the open end of the jack lever over the jack release valve.
 - ⚠ Do not allow the vehicle to drop suddenly, as this could cause damage.
2. Slowly turn the valve counter clockwise to release hydraulic pressure and allow the vehicle to lower in a controlled manner.
3. To stop/control the vehicle lowering, turn the valve clockwise to partially close it.

Wheel changing

JACK MOVEMENT PRECAUTIONS

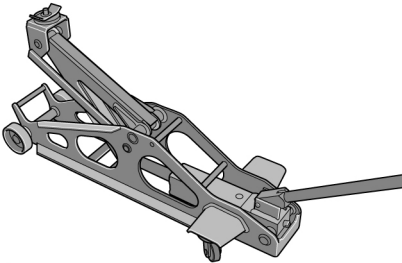
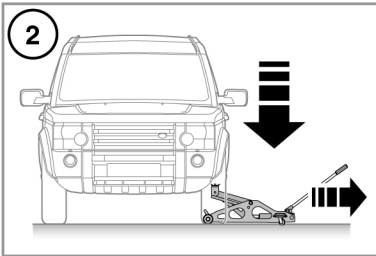
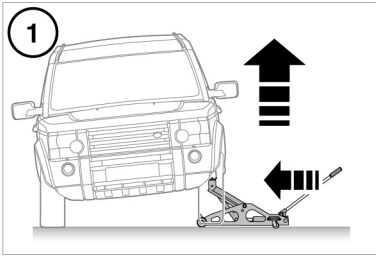

SL1924

As the lifting arm of the trolley jack is raised or lowered, the main body of the jack will move towards or away from the vehicle:

1. Raising the vehicle - the jack moves forwards.
2. Lowering the vehicle - the jack moves backwards.



It is important to clear away any stones and other debris from the ground, that might prevent free movement of the jack. Should the jack not be able to move, it could be damaged or the head of the jack could damage the vehicle jacking point and possibly cause other damage to the vehicle body.

Check that the wheels of the jack are free to rotate, and are not stiff or seized.

Storing the jack after use

With the jack in the fully closed position and the release valve in the open position, remove the jack lever.