

STEERING COLUMN

⚠ WARNING

Never adjust the steering column while the vehicle is in motion. Doing so may cause a loss of control, potentially resulting in an accident.

1. Move the lever fully down to unlock the column. Move the lever fully up to re-lock the column.
2. Move the steering column up, down, in or out, to the desired position.
3. Press to switch on the steering wheel heating. Temperature is thermostatically controlled.

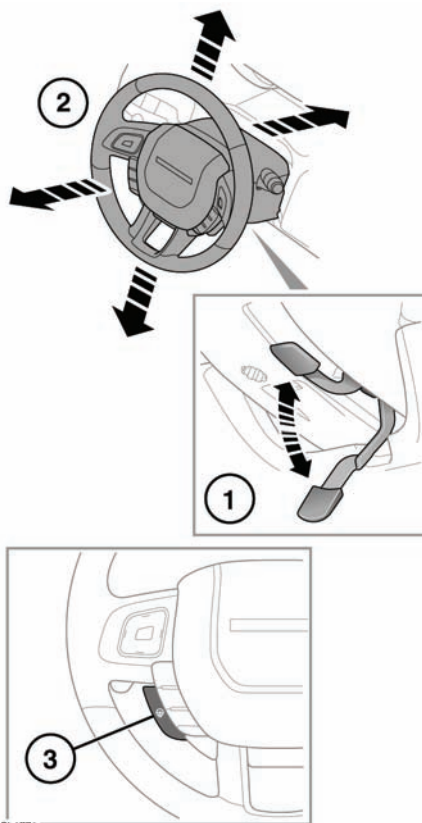

SL1771