

PORTABLE MEDIA



Make sure that any auxiliary devices are stored securely while the vehicle is in motion.



Do not place any item connected to the auxiliary input socket or the auxiliary power socket on the seats, carpets, or other upholstery.



Read the manufacturer's instructions for any device, before it is connected to the audio system.

PORTABLE MEDIA CONNECTIONS

Portable media devices can be connected to the media hub, located in the cubby box. The portable devices that you can connect to the system include:

- USB mass storage devices (e.g. a memory stick). Devices must use FAT or FAT32 file format.
- iPod® (iPod Classic®, iPod touch®, iPhone® and Nano® are supported - full functionality for older devices cannot be guaranteed). iPod Shuffle® functionality cannot be guaranteed.
- Auxiliary device (personal audio, MP3 players, all iPods®).

If you are connecting an iPod® or mass storage device, use the touch screen to operate and search the device. Many of the controls are similar to those available for CD play.



Disconnect your iPod® when leaving the vehicle. Failure to do so may result in the iPod® battery discharging.



During high ambient temperatures or direct bright sunlight, it is advisable to unplug and remove portable media devices from the vehicle.

Note: The audio system will play MP3, WMA and AAC files.

To maximise playback quality, it is recommended that lossless compression is used for any media files on USB or iPod®. Failing this, it is recommended that compressed files utilise a minimum bitrate of 192 kb/s (a higher bitrate is strongly recommended).

Note: iPod® is a trademark of Apple Computer Inc., registered in the US and other countries.

Note: Some MP3 players have their own file system that is not supported by this system. To use your MP3 player, you must set it to USB Removable Device or Mass Storage Device mode. Only music that has been added to the device in this mode can be played.

Note: The volume levels and sound quality available from devices connected to the auxiliary inputs may vary widely. If the connected audio device is equipped with a line out socket, as well as a headphone socket, the line out socket should be used.

PLAYING A PORTABLE DEVICE

If you are using a USB mass storage device or approved iPod®, you can control playback using the touch screen controls.

If you are using any portable media device via the AUX socket, then you must control playback from the device itself.

CONNECTING A DEVICE

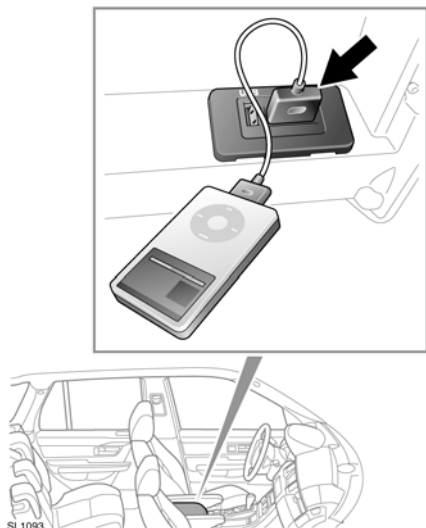

Connect the device into the appropriate socket in the cubby box.

Note: Use the cable supplied with your media device to connect to the USB socket. A dedicated iPod lead is available from your Land Rover Dealer.

- On the touch screen Home menu, select **Portable Audio**.

Note: You can also press the **MODE** button and then select **Portable Audio**.

- Select the required device (**USB** or **iPod**). Playback will start and the playback control menu is displayed.

When an iPod® is connected, playback will continue from the point at which it was last playing, provided the iPod® battery is in a good state of charge.

When a USB device is connected, playback will start from the first track in the first available folder. If a device is already connected when **Portable Audio** is selected, playback will continue from the point at which it was last playing.

When an auxiliary device is connected, playback will start when the device is switched on and played.

CONNECTING MULTIPLE DEVICES



Do not plug non-audio devices into the USB port.

You can connect multiple devices to the portable media interface simultaneously and switch between them using the touch screen. Select **USB** or **iPod**, to switch between modes.

The device docked first will remain the active device, until you choose to change.

If, after changing to the newly-docked device, you change back to the first device, play will resume at the point you left it (USB and iPod® only).

Note: You cannot use a USB hub to connect more than one USB device to the audio unit.

Note: Devices connected to the iPod® and USB ports will be charged, but devices that are fully discharged will not play.

Note: Options such as **Repeat** and **Random**, relate to the device currently playing, they will not apply to any subsequent device.

CONTROLS

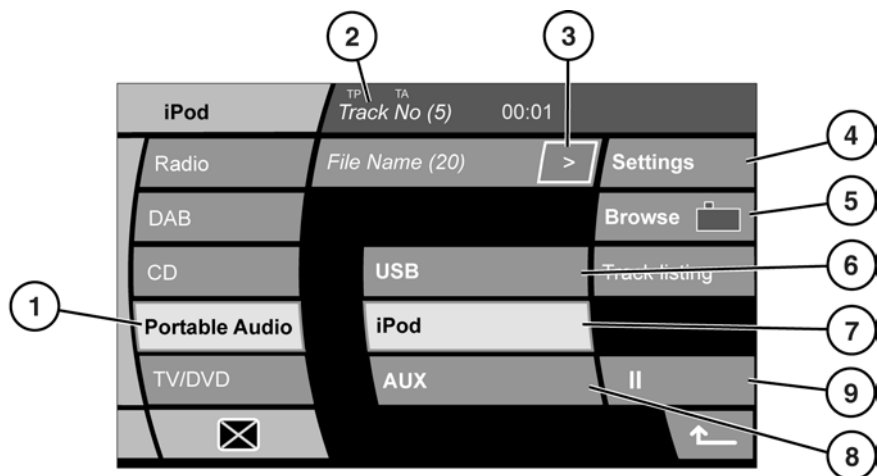

SL1368

1. Select to view the Portable audio menu.
2. Display of information about the current track, including elapsed run-time and play mode (Mix or Repeat).
3. Select to view more detailed information about the current track. Touch briefly to toggle through the information. Touch and hold to display the portable media text pop-up screen. Touch the pop-up to close.
4. Select, then select **Options**:
 - **Random**: Touch briefly to play tracks in the current folder.
 - **Repeat**: Touch briefly to play tracks in the current folder. Touch and hold for 2 seconds to play all tracks on the device.
5. Browse (iPod®/USB only):
 - Select to view the contents of the connected device which are displayed as dictated by the file structure of the device.
- Select a file to start playback (Browse view will remain). Select a folder or subfolder to view their contents.
- Select **Page jump** to jump through longer lists of items.
- To return to the Controls menu, select the Back soft key.
6. Touch to select playback from a USB device.
7. Touch to select playback from an iPod.
8. Touch to select playback from an auxiliary device.
9. Pause/Play: Select to pause playback. Select again to resume playback.

SEARCHING A TRACK

Use the audio fascia buttons for next/previous and fast forward/reverse track searches.

AUX INPUT SOCKET

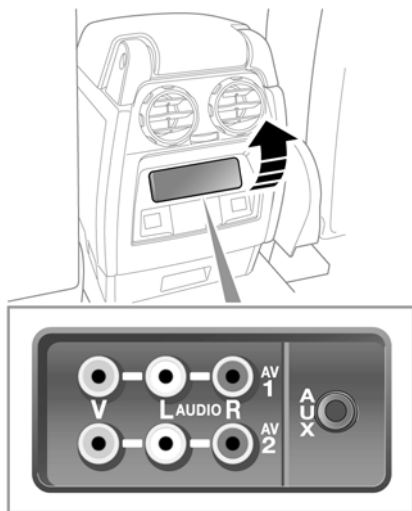

SL1317

The 3.5mm AUX socket allows additional equipment (e.g. personal stereo, MP3 player, hand-held navigation unit, etc.) to be connected to the audio system.

The auxiliary power socket, situated next to the auxiliary jack, can be used to power or charge any suitable device.

Note: iPod shuffle may be connected via the auxiliary input jack.

Note: On vehicles fitted with rear seat entertainment, additional Audio/Visual sockets (AV1 and AV2) are provided. This allows auxiliary equipment (such as a video game console) to be linked to the rear DVD screens. For installation information, please refer to the manufacturer's instructions.

SELECTING AN AUXILIARY INPUT

To listen to an auxiliary input source, select **Portable Audio**, from the touch screen, and then **AUX**.

Note: You can also press the mode button repeatedly to select Portable audio.

Play will start when the auxiliary device is switched on and started.

Note: Sound quality and volume levels available from devices connected to the auxiliary input may vary widely.