

LOCKING AND ARMING THE ALARM



Before exiting the vehicle, always ensure that the gear selector is in the Park (P) position, the engine is turned off, the parking brake is applied and the Smart Key is removed from the vehicle.

Press the lock button on the Smart Key briefly, to single lock the vehicle and activate the perimeter alarm. The hazard warning lamps will flash to confirm. A second press within three seconds will double lock the vehicle and activate the full alarm system. The hazard warning lamps will flash a second time to confirm the enhanced lock/alarm state.

Note: The fuel filler flap can only be opened when the vehicle is unlocked.

The vehicle can be locked in two ways.

SINGLE LOCKING AND PERIMETER ALARM

Single locking secures the vehicle and prevents the doors from being opened from outside. The doors may still be unlocked and opened from inside the vehicle. In this state, only the perimeter alarm is activated. The perimeter alarm will sound if:

- The bonnet, tailgate or a door are opened.
- The vehicle battery is disconnected.
- An attempt is made to disconnect the alarm siren.

Note: This setting should be used in circumstances such as travelling on a ferry, when pets are to be left in the vehicle, or if a window must be left open etc.

DOUBLE LOCKING AND FULL ALARM



Never double lock the vehicle with people, children, or pets inside. In the event of an emergency they would be unable to escape and the emergency services would be unable to release them quickly.

Double locking secures the vehicle and prevents the doors being opened from inside or outside of the vehicle. The doors cannot be unlocked or opened from inside the vehicle when double locked.

This provides additional security if the vehicle is left unattended. The vehicle cannot be opened by breaking a window and operating the door locks from inside.

Additionally, double locking also activates the full alarm system. Once activated the alarm system will sound if:

- The bonnet, tailgate or a door are opened.
- Movement is detected within the vehicle interior.
- A window, front or rear windscreen or sunroof glass are broken.
- The vehicle is raised or tilted.
- The vehicle battery is disconnected.
- An attempt is made to disconnect the alarm system.

Note: In this state, an open window or sunroof will cause the alarm to sound due to the movement of air currents. For this reason, ensure all windows and the sunroof are fully closed before double locking the vehicle.

Exiting the vehicle

INTERIOR PROTECTION

The interior protection feature of the full alarm system may be temporarily disabled via the Vehicle Settings menu. See **58, VEHICLE INFORMATION AND SETTINGS MENU**.

Note: Once enabled, this setting will activate the next time the vehicle is double locked with the Smart Key.

ALARM INDICATOR

An indicator in the instrument panel will flash whenever the alarm is active.

GLOBAL CLOSING



Ensure that no children, pets, or obstructions are in any open aperture before operating global closing. Safety mechanisms are in place to prevent serious injury, however injuries can still occur.

Press and hold the lock button for 3 seconds. The vehicle will single lock and the full alarm will be activated immediately. After 3 seconds any open windows will be closed. This feature can be enabled/disabled via the Vehicle settings menu (see **58, VEHICLE INFORMATION AND SETTINGS MENU**).

DRIVE-AWAY LOCKING

Drive-away locking automatically locks all the doors when the vehicle is in motion. This feature can be enabled/disabled via the Vehicle settings menu (see **58, VEHICLE INFORMATION AND SETTINGS MENU**).

Note: Pressing the lock or unlock button on the Smart Key will override drive-away locking for the current journey.

DOOR LOCKS AND RELEASE LEVERS

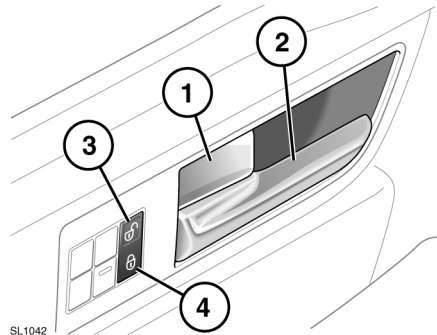

From inside the vehicle, all the doors can be locked by pressing either the driver or passenger lock lever (1).

Each rear door can be individually locked by pressing the appropriate locking lever.

To unlock and open a front door, pull the door handle (2). To unlock and open a rear door, first operate the lock lever, then pull the door handle.

Master lock/unlock buttons: To lock (4) or unlock (3) the vehicle press the respective button on the door.

Note: The master unlock button is inhibited when the vehicle is locked with the Smart Key.

MISLOCK

When attempting to lock the vehicle, if one or more of the doors, the bonnet or the tailgate are not fully closed, the vehicle will fail to lock and the horn will emit two tones. The vehicle will not fully lock until all doors, the bonnet and the tailgate are completely closed.

KEYLESS LOCKING



Never double lock the vehicle with people, children or pets inside. In the event of an emergency they would be unable to escape, and the emergency services would be unable to release them quickly.

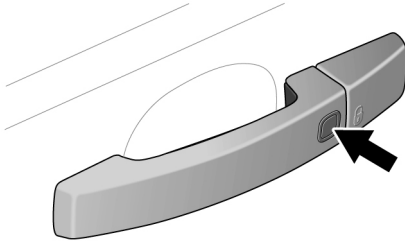

SL1143

The vehicle will not lock automatically.

- To single lock the vehicle press the keyless locking button (arrowed) on the door handle once. The hazard warning lamps will flash once to confirm. In some markets an audible warning will sound.
- To double lock the vehicle, press the keyless locking button (arrowed) twice within 3 seconds. The hazard warning lamps will flash twice to confirm (with a long second flash). In some markets a double audible warning will sound.

Note: Keyless locking will only activate if the Smart Key is detected outside the vehicle. If no Smart Key is present when the button is pressed, two warning tones will sound.

KEYLESS GLOBAL CLOSING

To initiate global window closing, press and hold the keyless locking button for 3 seconds. This will also lock the vehicle and activate the alarm.

Note: The windows will close only while the button is depressed. To fully secure the vehicle, continue to depress the button until all windows are fully closed.

DEACTIVATING THE ALARM WHEN TRIGGERED

If the alarm has been triggered it can be deactivated by pressing the Smart Key unlock button, or by positioning the Smart Key underneath the steering column (see 79, KEYLESS START BACKUP).

VALET MODE

Accessible directly from the home screen or from the Vehicle settings screen. Valet mode allows the vehicle to be driven, but leaves the luggage compartment locked and restricts use of the touch screen.

To enable Valet mode, enter a personally chosen four digit Personal Identification Number (PIN) into the soft key pad displayed on the touch screen. If you wish to cancel entry of the PIN, touch the **C** button at any time during PIN entry.

After entering the PIN, you will be prompted to enter the PIN again. Enter the same PIN and touch **OK** to confirm.

A pop-up screen is displayed, confirming your vehicle is now in Valet mode.

DESELECTING VALET MODE

On entering the vehicle, enter your PIN into the display, and touch the **OK** soft key.

Note: If the PIN number is lost or forgotten, the vehicle should be returned to your Dealer/ Authorised Repairer to have the PIN reset.