

USING CRUISE CONTROL

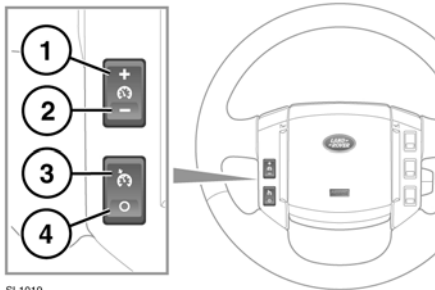

SL1019

1. Set target speed, or increase speed.
2. Decrease set speed.
3. Resume set speed.
4. Cancels cruise control operation without erasing memorised speed.

Note: Cruise control is not available when using Hill Descent Control or when a Terrain Response programs Mud-Ruts or Sand have been selected.

Note: Do not use cruise control when driving off-road.

Note: Do not use cruise control with **SPORT** mode selected.

ENGAGING CRUISE CONTROL



When setting the cruise control to the speed limit, it is important to remember that it is possible for the vehicle speed to increase when travelling downhill. This may result in the vehicle speed exceeding the speed limit.

Note: Cruise control can only be engaged when the appropriate gear has been selected at speeds in excess of 30 km/h (18 mph).

Accelerate until the desired speed is reached, then press the **+** switch (1) until the warning indicator illuminates. This sets the vehicle speed into the system's memory. Cruise control will now maintain that speed.



The cruise control warning indicator will illuminate to confirm cruise control is operational. Speed can be increased using the accelerator pedal as normal. As soon as the accelerator pedal is released, the vehicle speed will return to the set cruising speed.

Note: If the accelerator pedal is pressed for more than 5 minutes, cruise control will be cancelled.

SUSPENDING CRUISE CONTROL

Cruise control can be suspended by a single press of the cancel switch (4).

Cruise control will also be suspended if the brake pedal is pressed, the gear selector is moved to **N**, or if HDC or DSC are activated.

To resume cruise control at the previous set speed, press the resume switch (3).

Note: The set speed will not be erased by pressing the cancel switch. The set speed can only be erased by switching off the ignition.

DECREASING THE CRUISE SPEED

To reduce cruising speed, press and hold the **-** switch (2). Release the switch when the desired speed is reached, the new speed will be set and maintained.

The set speed can be decreased in steps of 2 km/h (1 mph), by briefly pressing the **-** switch (2).

INCREASING THE CRUISE SPEED

Press and hold the **+** switch (1) to increase speed. Release the switch when the desired speed is reached; the new speed will be set and maintained.

The speed can be increased in steps of 2 km/h (1 mph), by briefly pressing the **+** switch (1).

Speed can also be increased using the accelerator. When the desired speed is reached press the **+** switch to set and maintain the new speed.