

Convenience features

AUXILIARY POWER SOCKETS

CAUTIONS

❗ Only Land Rover approved accessories should be plugged into a power sockets. Using any other equipment may damage the vehicle's electrical systems. If you are in any doubt contact your Dealer.

❗ The engine should be running when using accessories for long periods. Failure to do so can discharge the battery.

Note: Power sockets can be used to power approved accessories that use a maximum of 180 Watts.

Front auxiliary power sockets

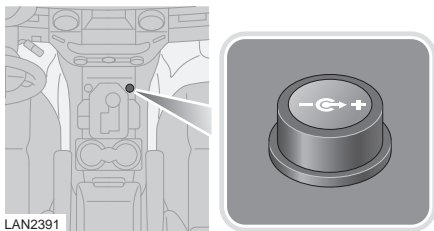

Note: Dependant upon vehicle specification, you may have a second power socket in place of the cigar lighter.

Rear auxiliary power sockets

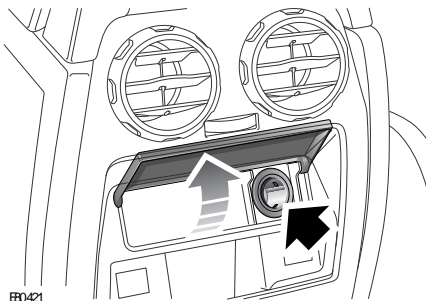

Raise cover to access the auxiliary power socket.

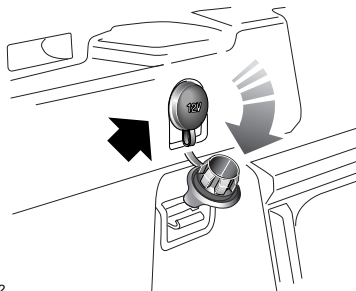

On 7-seat vehicles, a third power socket is fitted in the left-hand side trim in the loadspace area.