

# Climate control

## REAR PASSENGER CLIMATE CONTROLS

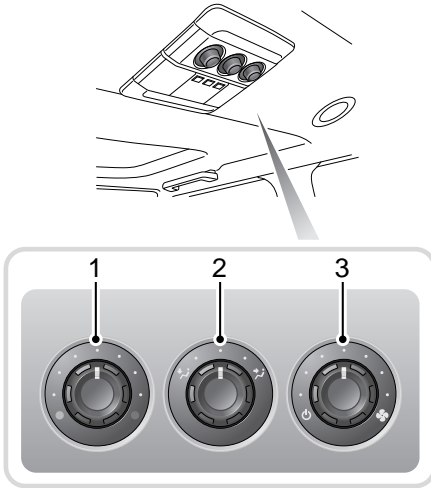





E81009

- 1 Temperature control: rotate clockwise (red dot) to increase the temperature of the incoming air.
- 2 Distribution control: rotate fully counterclockwise to direct air to the third row seats vent, rotate fully clockwise to direct air to the rear seat upper vents and the rear pillar vents.
- 3 Blower control: rotate clockwise to increase airflow.

**Note:** The panel is only active when the rear environment button on the front control panel is set to manual mode.

## AUXILIARY HEATER

### WARNINGS

-  Petroleum gases are highly inflammable and, in confined spaces are also extremely explosive
-  Operating the auxiliary heater when the vehicle in an enclosed space can cause a build-up of highly toxic fumes which may cause unconsciousness or death.
-  If the fuel-burning heater has been used recently, do not touch the unit's exhaust when working in the engine compartment.
-  When refuelling the vehicle, switch off the ignition to ensure that the fuel-burning heater is switched off.

Your vehicle may be fitted with an auxiliary heater which is power by fuel drawn from the vehicle's fuel tank. The heater operates at low temperatures, and is fully automatic.

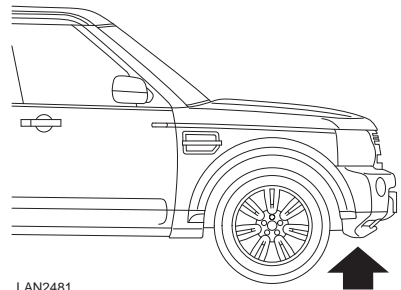

LAN2481

When the heater is operating, exhaust fumes from the heater may be seen coming from underside the vehicle. This is normal, and is not a cause for concern.