

# Portable audio interface

## PORTABLE AUDIO INTERFACE

### CAUTION

 We recommend that you replace the rubber cover when a portable device is not connected to prevent damage to the interface. The cover is not waterproof.

Located in the centre console cubby box is an interface to allow the connection of a variety of portable audio devices, including iPods, to the vehicle's audio system.

**Note:** Most devices connected to the iPod and USB ports will be charged, but devices that are fully discharged will not play.

If an iPod or mass storage device is connected to the interface, you can use the touch-screen to operate and search the device. Many of the controls are similar to those available for CD play.

The devices that you can connect to the portable audio interface include:

- USB mass storage devices, for example memory stick.
- iPod.

**Note:** The portable audio interface supports all iPod generations available at time of writing, including the 3rd & 4th generation, iPod Photo, iPod nano and the 5th generation models.

**Note:** The audio system will play MP3, WMA, WAV and AAC files.

**Note:** The system will support devices with a storage capacity up to 256 GB (approximately 65 000 tracks).

### Connecting an iPod

On the audio Home screen, select **Audio/TV**, then **Portable audio**, then **iPod**.

**Note:** You can also press the **MODE** button and then select **Portable audio device**.

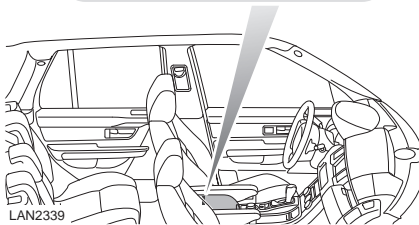
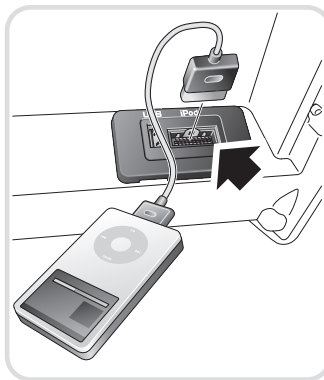

A dedicated iPod lead is supplied with the Portable audio interface. Plug in your iPod with the usual care necessary to protect the connector pins from damage.

Play will start automatically from the point at which the iPod was last played.

# Portable audio interface

## Connecting a USB device

On the audio Home screen, select **Audio/TV**, then **Portable audio**, then **USB**.

**Note:** You can also press the **MODE** button and then select **Portable audio device**.

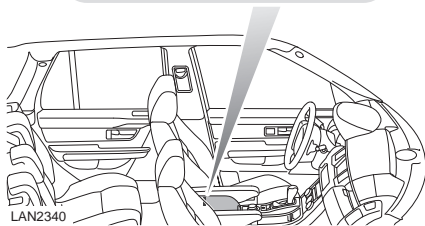
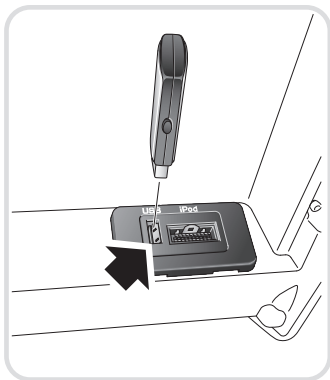

Insert the USB device into the socket.

Whenever the device is connected, the first track in the first available folder is played automatically.

**Note:** Some MP3 players have their own file system that is not supported by this system. To use your MP3 player, you must set it to **USB Removable Device** or **Mass Storage Device** mode (see manufacturer's information for further details). Only music that has been added to the device in this mode can be played via the vehicle's portable audio system.

**Note:** We recommend that only music files are loaded on the USB device. This will speed up the automatic indexing of files.

## Connecting more than one device



You can connect an iPod and a USB device simultaneously to the portable audio interface and switch between them using the touch-screen. Select **iPod**, **USB** or **AUX**, to switch between modes.

**Note:** Selecting **AUX** will select an input connected to the auxiliary input socket. See **AUXILIARY INPUT (AUX IN) SOCKET** (page 332).

The device docked first will remain the active device until you choose to change.

If, after changing to the newly-docked device, you change back to the first device, play will resume at the point you left it (USB and iPod only).

**Note:** You cannot use a USB hub to connect more than one USB device to the audio unit.

**Note:** Options such as **Repeat** and **Mix** relate to the device currently playing, they will not apply to any subsequent device.