

# Seats

## HEATED SEATS

The seat heaters can only be operated when the ignition is switched on. The seat heaters will maintain a pre-determined temperature according to the level selected on the switch.

Switching off the ignition will automatically turn off the seat heaters and require them to be reselected next time the ignition is switched on

**Note:** Because the seat heaters consume considerable power from the battery, we recommend they are only operated while the engine is running.

### Front seat heaters

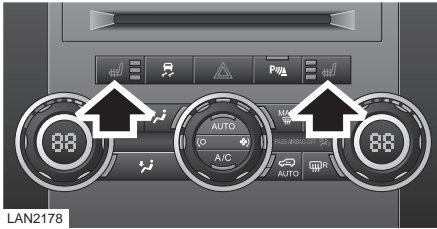

The front seats can be heated at three different heat levels.

- Press once to operate at the highest heat level. Three indicators will illuminate on the switch.
- Press twice to operate at the medium heat level. Two indicators will illuminate on the switch.
- Press a third time to operate at the lowest heat level. A single indicator will illuminate on the switch.
- Press a fourth time to turn off the heaters.

### Rear seat heaters

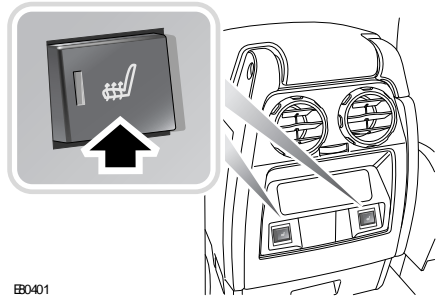

The rear seats can be heated at two different heat levels.

- Press once to operate at the higher heat level. As cabin temperature rises, the seat heaters automatically adjust to the lower heat level.
- Press twice to operate at the lower heat level.
- Press a third time to turn off the heaters.