

# Telephone (standard)

## MOBILE PHONE COMPATIBILITY

Not all phones are fully compatible with the Land Rover system. For the latest list of compatible phones and software versions, please refer to the Land Rover website. Alternatively consult your Land Rover Dealer/Authorised Repairer.

### Bluetooth supported features

- Make a call.
- Receive a call.
- End an active call.
- Call stacking - display of missed calls, last number called, call waiting.
- Phone book - access to the phone book stored on the phone or SIM card.

### Unsupported features

- Phone charging.
- Hold/unhold an active call.
- Rejecting an incoming call.
- No display of network operator, signal strength or caller id.

**Note:** Functionality will depend on model/manufacture of your mobile phone.

## TELEPHONE CONTROLS

### Facia

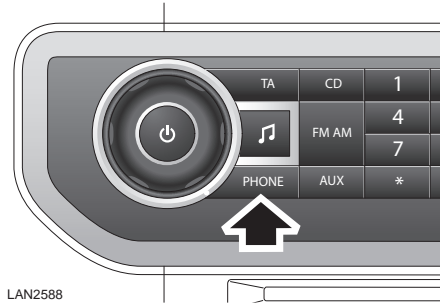

Press button on facia to enter or leave phone mode.

### Steering wheel

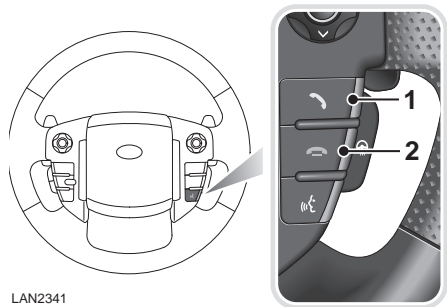

#### 1. Answer call/Dial switch

- Press the switch briefly to answer an incoming call or dial a displayed number. Press and hold the switch (for approximately two seconds) to redial the last number dialed.

#### 2. End/Reject call switch

- Press the switch to end the current call or reject an incoming call.