

Steering wheel

Entry and Exit mode

Entry and exit mode provides automatic movement of the steering column and driver's seat making it easier to enter or exit the vehicle.

This feature can be enabled by setting the steering column adjustment switch to the **AUTO** position.

To prevent automatic movement of the driver's seat and steering column, turn the switch clockwise to the manual position.

Note: If the steering column switch is moved away from **AUTO** when the driver's seat and steering column is in the exit position, the driver's seat and steering column will move back to their previous positions when the driver's door is closed and the ignition is switched on.

Steering column position memory

Three different steering column positions can be saved and recalled. See **DRIVER'S SEAT MEMORY FUNCTION** (page 44).

HEATED STEERING WHEEL

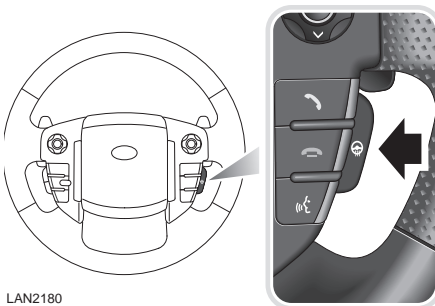

LAN2180

Press the switch to turn the heating on or off. The heated steering wheel icon will illuminate as follows:-

If the steering wheel heating is on, the icon will show amber.

If the steering wheel heating is off and headlamps are on, the icon will show green.

If the steering wheel heating and headlamps are off, the icon will not illuminate.