

Fuel and refuelling

FUEL FILLER

WARNINGS



Take careful note of all warnings and instructions given on the label affixed to the inside of the filler flap. Failure to do so may result in injury or death.



Open the fuel filler cap slowly and allow the pressure to release before fully removing the cap to avoid fuel spillage due to rapid expansion.

CAUTION



Do not force the fuel filler flap open, it may fail to close properly and you will need to seek qualified assistance.



The fuel filler is located behind the rear right-hand wheel arch. An arrow on the fuel gauge points to that side of the vehicle.

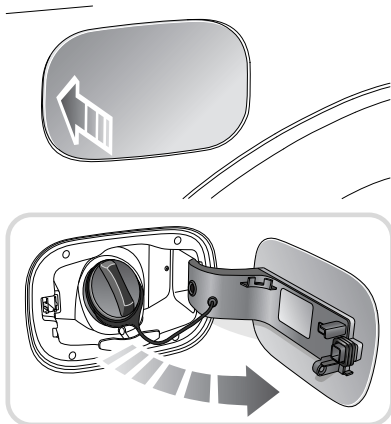

EB0364

With the vehicle unlocked, press the left side of the fuel filler flap to open.

The fuel filler flap springs open revealing the filler cap.

Note: The vehicle must be unlocked using the Smart Key before you can open the fuel filler flap.

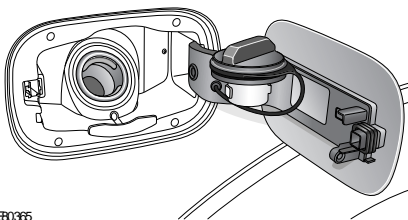

EB0365

The filler cap is secured to the vehicle by a strap. For your convenience a holder is provided on the flap to store the cap whilst refuelling.

Note: When replacing the fuel filler cap, tighten it until it clicks three times. Failure to do so may cause the engine warning indicator to illuminate due to increased evaporative emission levels.