

# Steering wheel

## ADJUSTING THE STEERING COLUMN

### WARNINGS



Never adjust the steering column position while the vehicle is in motion. Doing so will reduce control of the vehicle, and may cause unpredictable steering movements.

### Manual adjustment

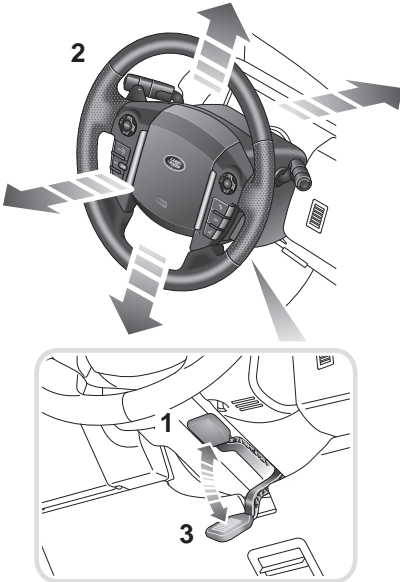

LAN2395

The steering column position can be adjusted in two directions.

Move the lever, located under the steering column, fully downwards (see inset).

Adjust the steering column up or down, in or out.

Move the lever fully up to lock.

### Electric adjustment

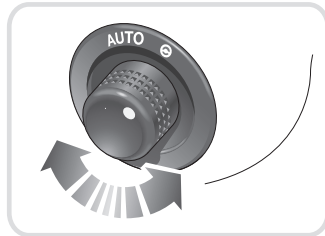

LAN2166

The steering column can be adjusted in four directions, corresponding with the movement of the adjustment control, to suit your driving position.

Move the control up or down to adjust the height of the steering column.

Move the control forwards or rearwards to move the steering column further away or closer to your body.