

AUTOMATIC TRANSMISSION

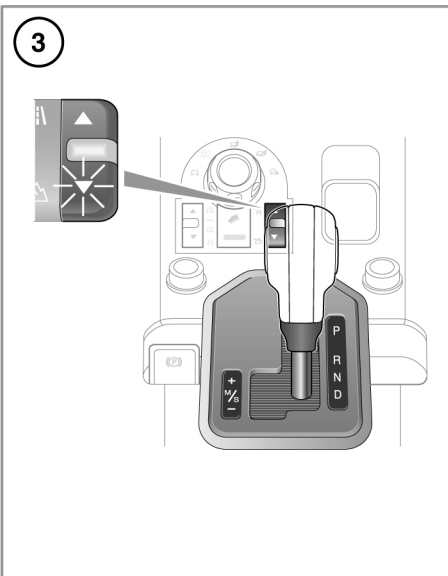
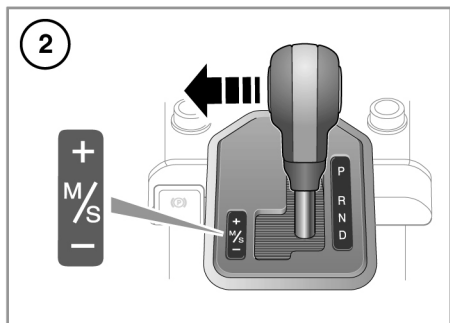
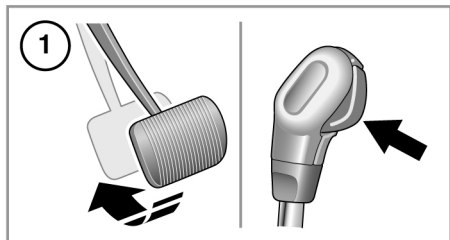

1. To select Drive (**D**) when the vehicle is stationary, apply the foot brake and press the gear selector release button.

Note: If pressure is applied to the selector lever before the foot brake is applied, any gear selected may not be available, irrespective of the lever position. In this situation, remove pressure from the selector lever, ensure that the foot brake is applied and select the required gear.

2. To select sport mode, move the gear selector to the left. **S** will appear in the gear selector display and the LED to the side of the gear selector illuminates.

To use CommandShift™, first select sport mode, then move the selector lever forward to move up a gear, and back to move down gear.

To return to automatic mode move the selector lever back to the **D** position. The **D** on the selector display will illuminate to confirm that automatic mode has been selected.

3. The transfer gearbox switch allows selection of high or low range gears.



Do not use auxiliary equipment, such as roller generators that are driven by only one or two wheels of the vehicle, as they will cause failure of the transfer gearbox.



Park (P) should be engaged and the parking brake applied when the vehicle is stationary.



Always select P and switch off the ignition before leaving the vehicle.

SL1079

- ❗ Never select Park (**P**) whilst the vehicle is in motion.
- ❗ Never select Reverse (**R**) whilst the vehicle is in forward motion.
- ❗ Never select a forward gear whilst the vehicle is in rearward motion.
- ❗ Do not rev the engine or allow it to run above normal idle speed, while selecting **D** or **R**, or whilst the vehicle is stationary with any gear selected.
- ❗ Do not allow the vehicle to remain stationary for any length of time, with a gear selected and the engine running. Always select **P** or **N** if the engine is to idle for a prolonged period.

COMMANDSHIFT™

If CommandShift™ is selected in high range, 1st gear must be used for moving off from stationary. In low range, gears 1, 2 or 3 may be used. This may prove useful in certain off-road driving conditions.

To return to Sport mode after CommandShift has been selected, move the gear selector lever into the **D** position, then back to Sport mode.

TRANSMISSION COMMANDSHIFT SELECTED will appear in the message centre when the transmission is in CommandShift mode.

Note: *In order to protect the engine, the transmission will automatically change up to prevent over-revving, or down if the engine is labouring.*

HILL DESCENT

With Hill Descent Control (HDC) selected in either automatic, Sport or CommandShift modes, a low gear will be selected and maintained to provide maximum engine braking. Should the gear lever be moved to **D** from the sport/CommandShift position, the selected gear will be retained until the descent is completed. See **101, HDC OPERATION**.

TRANSMISSION FAULT

In the event that the transmission develops a fault, a warning message may be displayed in the message centre and only limited gears may become available. You should seek qualified assistance immediately.

MANUAL TRANSMISSION

- ❗ Selection of reverse gear is prevented when the vehicle is travelling in excess of 24 km/h (15 mph). Never attempt to engage reverse gear whilst the vehicle is in forward motion. This may result in serious transmission damage and costly repairs.

TRANSFER GEARBOX

High range (Hi):

Hi should be used for all normal road driving and also for off-road driving across dry, level terrain.

Low range (Lo):

Lo should only be used in situations where low speed manoeuvring is necessary.

Also use **Lo** for more extreme off-road conditions. Do not attempt to use **Lo** for normal road driving.

STATIONARY RANGE CHANGING

With the vehicle stationary, select **N**.

Move the transfer gear switch towards the range required and release. The switch returns to the default position and range change status will be confirmed after several seconds.

RANGE CHANGE INDICATORS

In **Hi**, the **Hi** range switch indicator is illuminated.



In **Lo**, the green warning lamp in the instrument pack and the **Lo** range switch indicator are illuminated.

While a range change is in progress, the range indicator lamps will flash as follows:

Hi to Lo change:

- The **Lo** range warning lamp and indicator flash during the change and then illuminate constantly.
- The **Hi** range indicator extinguishes when the change is complete.
- The message **LOW RANGE SELECTED** is briefly displayed in the message centre.

Lo to Hi change:

- The **Hi** range indicator and the **Lo** range lamp and indicator flash during the change.
- The **Hi** range indicator illuminates constantly when the change is complete.
- The **Lo** range indicator extinguishes when the change is complete.
- The message **HIGH RANGE SELECTED** is briefly displayed in the message centre.

RANGE CHANGING ON THE MOVE

The recommended method of changing range is with the vehicle stationary. For experienced off-road drivers, a range change on-the-move can be accomplished, as detailed below.

AUTOMATIC TRANSMISSION HIGH TO LOW RANGE

1. With the vehicle slowing down, and travelling between 40 km/h (24mph) and 3 km/h (2 mph), select **N**.
2. Press the rear of the transfer gear switch to select **Lo**.
3. Wait for the range change to be completed (this may take several seconds). Once complete, select the desired gear. A gear cannot be selected until the range change is complete.

MANUAL TRANSMISSION HIGH TO LOW RANGE

1. With the vehicle slowing down, and travelling between 20 km/h (12 mph) and 3 km/h (2 mph), depress the clutch and select neutral.
2. Press the rear of the transfer gear switch to select **Lo**.
3. Wait for the range change to be completed (this may take several seconds). Once complete, depress the clutch and select the desired gear. If a gear is selected before the range change is complete, the range change will be cancelled, leaving the transfer box in neutral or **Hi**. An audible warning will be given.
4. After a failed range change, it will be necessary to reselect neutral in the main gearbox and repeat the range change procedure.

CHANGING FROM LOW TO HIGH RANGE

With the vehicle travelling no faster than 60 km/h (38 mph), select **N** or neutral. Press the front of the transfer gear switch to the **Hi** position and release it.

Indication of the range change status is the same as for the stationary method.

Now select **D** or the most appropriate manual gear for the vehicle speed.