

# DEFENDER

## QUICK START GUIDE

- 2 DRIVER CONTROLS
- 3 VEHICLE ACCESS
- 4 SEATS AND WINDOWS
- 6 EXTERIOR LIGHTING
- 7 WIPERS AND WASHERS
- 8 WARNING LAMPS
- 8 TRANSMISSION
- 10 CLIMATE CONTROL
- 11 AUDIO SYSTEM
- 15 TELEPHONE
- 16 FILLING STATION INFORMATION

SOME FEATURES MAY NOT BE FITTED TO YOUR VEHICLE.



DEFENDER

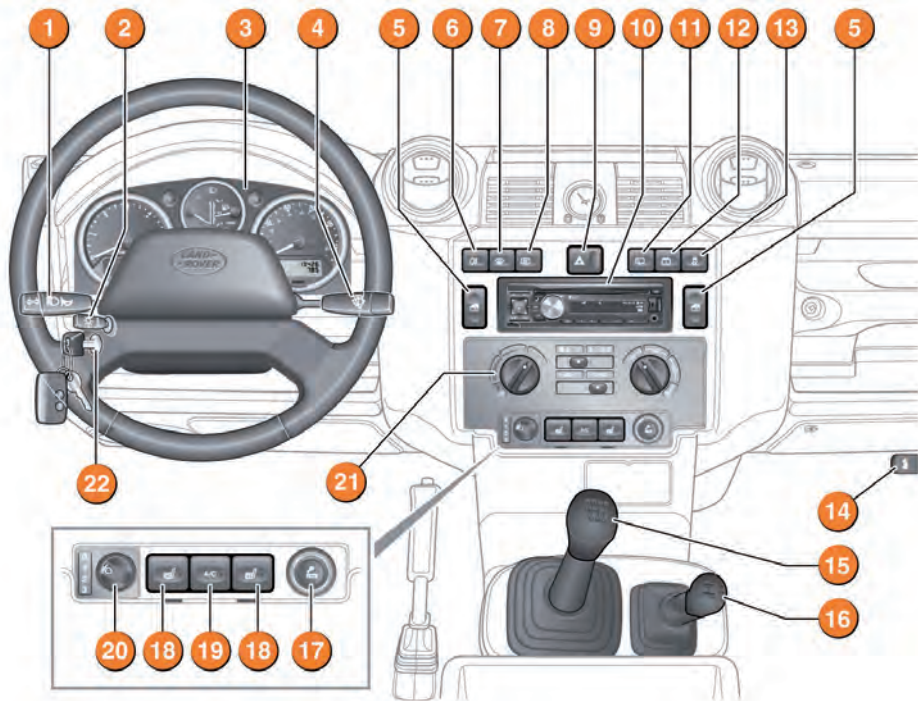

DEFENDER

DEFENDER

1. Direction indicators and high beam control.
2. Exterior lamps master switch.
3. Instrument panel.
4. Washer and wiper control.
5. Electric window switches.
6. Rear fog lamp switch
7. Windscreen heater.
8. Rear screen heater.
9. Hazard warning lamps.
10. Audio system and controls.
11. Rear screen wiper.
12. Rear screen washer.
13. Dynamic stability control off/on switch.
14. Bonnet release.
15. 6 speed gearbox selector.
16. Transfer gearbox selector.
17. Cigarette lighter.
18. Heated seats switches.
19. Air conditioning master switch.
20. Headlamp level control.
21. Heater and air conditioning controls.
22. Starter switch.

## Keys and remote control

### Vehicles with central door locking

#### Locking with the key

1. Insert the key into the driver's door lock and turn towards the rear of the vehicle to lock all of the doors, immobilise the engine, and arm the alarm.

*Note: Do not use the key to unlock. Depending on vehicle specification, the alarm may not disarm.*

#### Locking and unlocking with the remote control

2. Press once to lock all of the doors, immobilise the engine, and arm the alarm. The direction indicators will flash 3 times to confirm.
3. Press once to disarm the alarm and unlock all of the doors. The direction indicators will flash once and the interior lamps will illuminate.

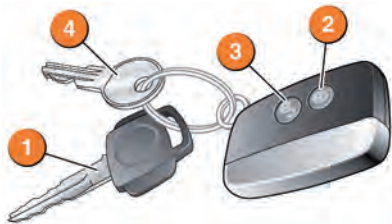

### Vehicles without central door locking

#### Locking and unlocking with the key

1. Each door must be locked or unlocked individually with the key. Turn the key towards the rear of the vehicle to lock, or towards the front to unlock. This key also operates the starter.

#### Remote control alarm setting

The remote control will not operate the door locks.

2. Press once to immobilise the engine and arm the alarm. The direction indicators will flash 3 times to confirm.
3. Press once to disarm the alarm. The direction indicators will flash once and the interior lamps will illuminate.
4. This small key unlocks the fuel filler cap.

Always keep a remote control on the same key ring as a starter/door lock key; the engine immobiliser detects the remote control near the starter switch. Never attach both remote controls to the same key ring.

### Emergency Key Access (EKA)

If the remote control is damaged or fails to operate, use the 4 digit EKA code, recorded on your Security Card, to disarm the alarm and re-mobilise the engine.

1. Remove the remote control from the key ring. Keep it well away from the starter switch.
2. Unlock the driver's door, enter the vehicle, and close the door.

*Note: When the door is opened, the alarm will sound for 30 seconds.*

3. Insert the Starter key into the starter switch and turn to position II. The alarm will sound.

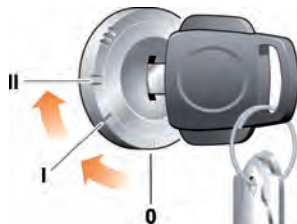

4. Turn the key to position 0, then open and close the door.
5. To enter the EKA code, turn the key to II and back to 0 the same amount of times as the first number, e.g., if your EKA code is 4321, turn the key 4 times.
6. Now open and close the door to confirm the entry.

Follow the same procedure to enter the next three numbers.

When a correct EKA code is entered, the alarm will be disarmed and the engine re-mobilised.

## Front seat adjustment



1. Raise the bar lock for forward and backward adjustment.

2. Pull up the lever to adjust the seatback

3. Squeeze together the locking mechanisms, below a head restraint, to allow adjustment.

## Second row seats

### Folding and stowing



1. Lower the head restraints as much as possible.

2. Push the seatback release lever down and fold the seatback forwards.

3. Pull the looped strap towards the front of the vehicle to pivot the seat into a stowed position.

### Floor latches



To create a flat loading area, fold the latches into the floor. Raise the latches before the seat is returned to the upright position. The seatback will not unfold until the latches are in the fully forward position and the seat base is latched in the locked position.

## Third row seats

### Folding and stowing

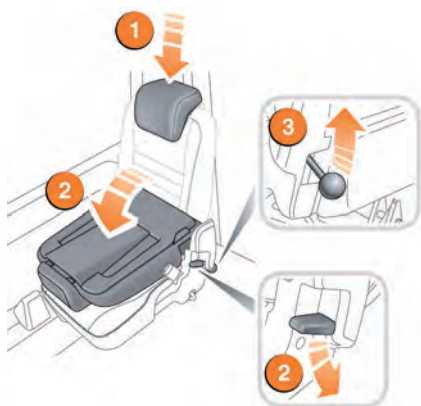

1. Lower the head restraints as much as possible.
2. Push the seatback release lever down and fold the seatback forwards.
3. Pull the seat base locking lever upwards to unlock.
4. Fold the seat upwards until it latches into position.

### Unfolding

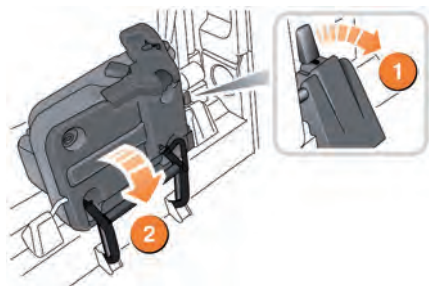

1. Pull the release catch inwards to release the seat assembly.
2. Lower the seat base and press down firmly to make sure that the base has latched onto the frame. Unfold the seatback and adjust the head restraint to the correct position.

#### Operating note

The seatback will not fully unfold unless the seat base has correctly latched onto the frame.

## Windows

### Electric front windows

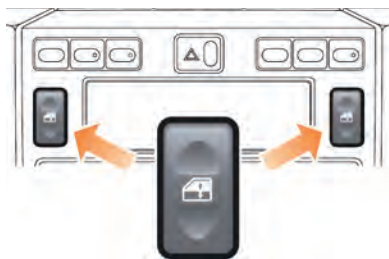

- To open a window, press and hold the lower part of the relevant switch.
- To close a window, press and hold the upper part of the relevant switch.

The window will stop moving when the switch is released.

### Rear sliding windows

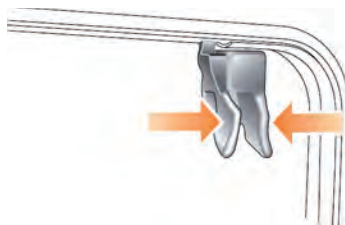

Squeeze the locking mechanism and slide the window to the desired position. Release it and make sure that the window is locked in position.

## Exterior lamps

### Lighting control

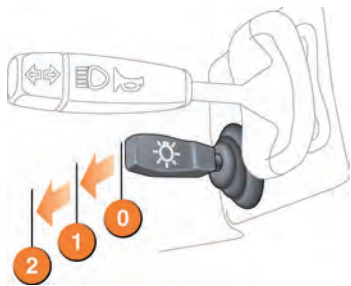

- 0. Exterior lamps off.
- 1. Side, tail, and Instrument panel lamps on.
- 2. Headlamps on.

The rear fog lamp switch is located on the centre console.

### Direction indicators and headlamp high beam

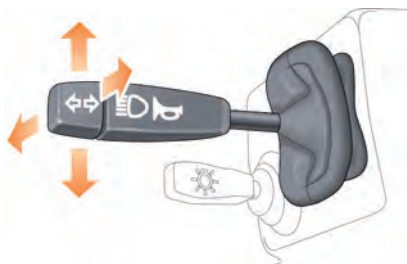

#### Indicators



A green lamp will flash in the Instrument panel when the indicators are in use.

#### Headlamps



Push the lever away from you to select headlamp high beam. A blue lamp will illuminate in the Instrument panel while high beam is operating.

To flash the headlamps, pull the lever towards the steering wheel and then release.

### Headlamp levelling control

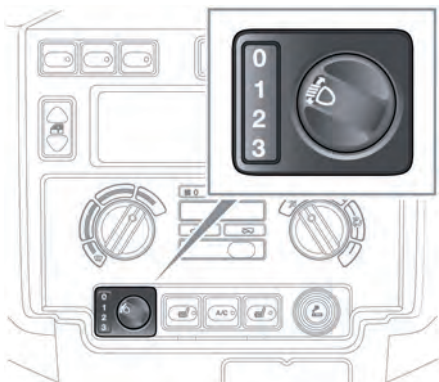

### Headlamp levelling control positions

Vehicle load	Position
Driver only with loadspace empty.	0
Driver and front seat passenger with loadspace empty.	0
All seats occupied with loadspace empty.	1
All seats occupied and loadspace loaded to the maximum rear axle weight.	2
Driver only with loadspace loaded to the maximum rear axle weight.	3

# Wipers and washers

## Front windscreen

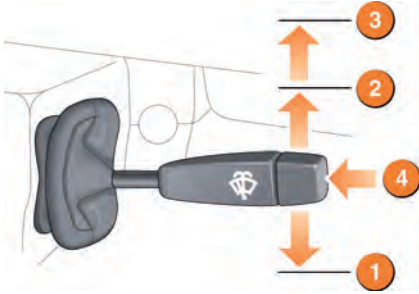

1. Intermittent wipe.
2. Low speed wipe.
3. Fast speed wipe.
4. Screen washer.

### Single wipe

To operate, push the control against spring pressure to position 2, then release.

## Rear window

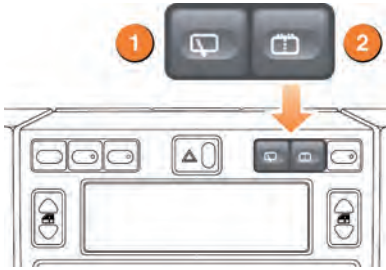

### Rear screen wiper

1. Press to turn on, press again to turn off.

### Rear screen washer

2. Press to operate. The washer will continue to operate until the switch is released.

# Warning lamps and transmission

## Instrument panel warning and information lamps

If any other warning lamp illuminates, refer to the Owner's Handbook as soon as possible. DO NOT ignore warning lamps.

Each time the Starter key is turned to position II, the Instrument panel lamps will illuminate. This is a system bulb check procedure and does not indicate a fault.

DEFENDER



Parking brake applied.



Heated rear screen.



Trailer attached.



Glow plugs active.



Illuminates when the DPF is full.



Headlamps high beam on.



Traction control operating.



Illuminates when the DPF is approaching capacity.



Rear fog lamps on.



Differential lock engaged.



Hazard warning lamps.



Dynamic stability control off

The Instrument panel fuel gauge has an indicator for low fuel. The indicator will illuminate amber when the remaining fuel drops to 9 litres (2 gallons).

DEFENDER

## Transmission

The transmission consists of a 6 speed gearbox and a high/low transfer box. The centre differential distributes drive to both axles providing permanent 4-wheel drive.

High range is used for all normal road driving and when off-road on dry, level terrain.

Low range is for very low speed manoeuvring and more extreme off-road conditions where progress cannot be maintained in High range. Some road conditions, such as heavy snow, may also be appropriate for Low range use.

### Transfer gearbox positions

1. H - High range.
2. N - transfer neutral.
3. L - Low range.
4. Differential lock.

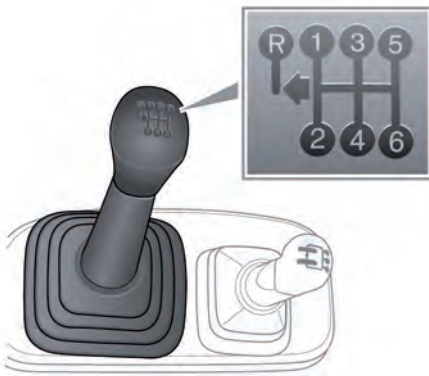

DEFENDER

## Transmission - continued

There are 2 methods for changing gear in the transfer box; stationary or on the move.

### Stationary method

1. With the engine running, press the clutch.
2. Move the lever to the **N** position, then into the desired range.

Do not force the lever if resistance is preventing gear selection. Instead, follow this procedure:

1. With **N** selected, press the clutch and select 2nd gear in the main gearbox.
2. Release the clutch momentarily, then press it again.
3. Move the transfer box lever from **N**, into the desired range.
4. Select the appropriate gear in the main gearbox and move away.

### On the move - high to low selection

This is the recommended method.

1. With the vehicle slowing down and at less than 5 mph (8 km/h), press the clutch and move the transfer lever to **N**.
2. Just before the vehicle comes to a halt, and with the clutch pedal still pressed, move the lever to **L**.
3. Select a suitable gear in the main gearbox and release the clutch. Continue driving.

### On the move - low to high selection

1. Apply slight backwards pressure to the transfer gearbox lever in preparation for the gear change.
2. In 3 simultaneous moves, press the clutch, release the accelerator, then move the transfer gearbox lever to **N**.
3. Release the clutch for 3 seconds, then press it again and move the transfer gearbox lever firmly to **H**.
4. Select a suitable gear in the main gearbox and release the clutch. Continue driving.

### Differential lock

Your vehicle has permanent 4-wheel drive, however, additional grip may be applied to loose and slippery surfaces by locking the differential.

*Note: If you want to lock the differential while moving, it is essential to be travelling in a straight line, on firm ground, and with no wheel slip.*

To lock the differential from **H** or **L** positions:

Ease off the accelerator, then move the transfer gearbox lever to the left, into the **DIFF LOCK** position.



When the differential lock is engaged, the amber warning icon in the Instrument panel will illuminate.

To unlock the differential:

Move the transfer gearbox lever to the right, into the **H** or **L** position.

### Operating note

Do not engage the differential lock if a wheel is slipping. Doing so could cause damage to the transmission.

Do not engage the differential lock from the transfer Neutral position.

Do not drive above 40 mph (60 km/h) with the differential locked.

Always unlock the differential for normal road driving, or as soon as you reach a hard surface.

Advice on off-road driving techniques can be found in the Land Rover publication, Off-Road Driving. This is available on line at: [www.ownerinfo.landrover.com](http://www.ownerinfo.landrover.com).

## Controls

DEFENDER

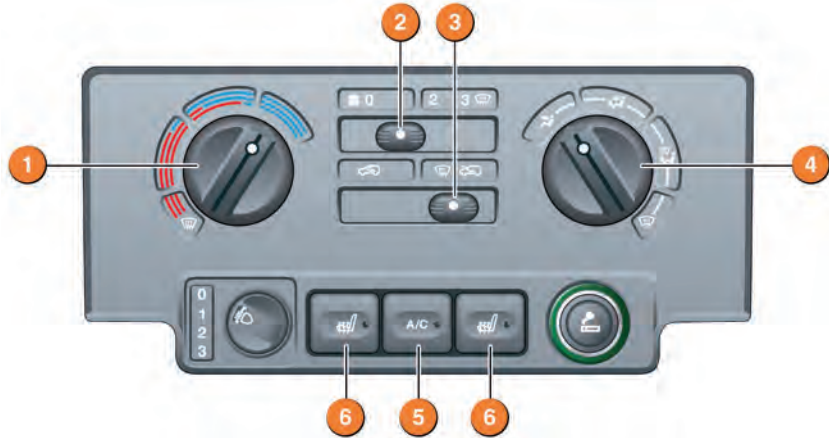

DEFENDER

DEFENDER

1. Temperature selection: Rotate the control to adjust the temperature air entering the passenger compartment.

2. Blower speed: Slide the blower control to adjust the airflow through the vents.

3. Air recirculation and fresh air: Slide the lever for re-circulated or fresh air.

*Note: For optimum demist performance, set this lever, the blower speed control, and the air distribution control to the windscreen icon positions.*

4. Air distribution: Rotate the control to direct air flow from the vents, as required.



Face level vents.



Foot and face level vents.



Windscreen and foot level vents.



Windscreen and side window vents.

5. Air conditioning: Press to switch the air conditioning on. Press again to switch off.

6. Heated seats: Press to activate the required seat heater. The seat heaters are thermostatically controlled to maintain a preset temperature. Press again to switch off.

### Front and rear heated screens

Switches for the heated screens are located on the fascia. The switches will illuminate while the heating element is operating.



Windscreen heater: The heating element will switch off automatically after approximately 8 minutes.



Rear window heater: Press to switch the heated window on, and again to switch it off.

### Heated seats

To prevent the battery from becoming discharged, the seat heaters should be operated only when the engine is running.

### External water deposits

The air conditioning system removes moisture from the air and deposits excess water beneath the vehicle. Puddles may form, but this is normal and no cause for concern.

# Audio system

## Audio system controls

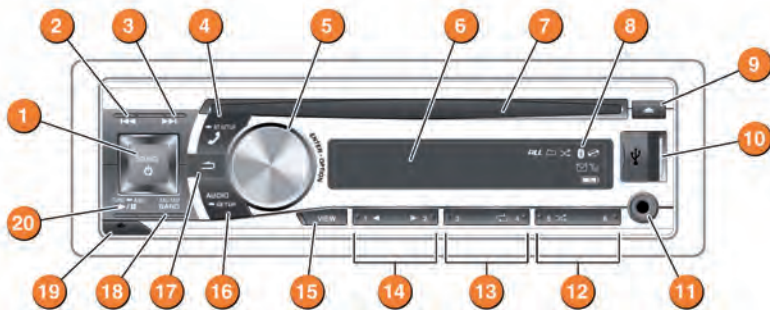

**1. SOURCE:** Press and hold to turn the system on or off. Press repeatedly to switch between **TUNER, DISC, USB AUDIO/iPod, AUXILIARY** and with the telephone option fitted, **BT AUDIO**.

**2. Seek down:** Short press to search down to the next station or the previous track in the current audio mode. Press and hold to search down through the current radio frequency or back through the track in the current audio mode.

**3. Seek up:** Short press to search up to the next station or the next track in the current audio mode. Press and hold to search up through the current radio frequency or forward to the next track in the current audio mode.

**4.** With the telephone option fitted, press to accept/disconnect a call.

**5.** Rotate to adjust the volume. When a menu is open, rotate to move to the next or previous menu. Press to select a menu item. During MP3 playback, press to search by folder or file name.

**6.** Information display.

**7.** CD slot.

**8.** Icons will illuminate when a feature is in use or a telephone/portable media device is connected.

**9.** CD eject.

**10.** USB connection.

**11.** AUX socket.

**12.** Radio preset buttons 5 and 6. Press and hold to store a station. Press briefly to select a station. Portable media track shuffle. Press repeatedly for options.

**13.** Radio preset buttons 3 and 4. Press and hold to store a station. Press briefly to select a station. Portable media track repeat. Press repeatedly for options.

**14.** Radio preset buttons 1 and 2. Press and hold to store a station. Press briefly to select a station. Portable media (MP3), select the next and previous folders.

**15. VIEW:** Change the displayed information.

**16. AUDIO/SETUP:** Short press to access the audio sound/tone settings menu. Press and hold to access the audio/telephone/clock setup menu. Select and adjust with control 5. Press and hold to close the menu.

**17. Menu back:** Short press to return to the previous portable media menu. Press and hold to close the portable media menu.

**18. BAND:**  
**In radio mode:** Press repeatedly to switch between radio wavebands. Press and hold to activate traffic announcements.

**In telephone mode:** When a call is in progress, press to switch the speaker's output between the Audio system and the telephone.

**19.** Faceplate release.

**20. TUNE/Pause play:**

**In radio mode:** Short presses to select radio auto-store modes **DX SEEK** or **SEEK**. Press and hold to auto-store 6 Radio Frequencies on the preset buttons.

**In portable media mode:** Pause/play the current audio source.

**In telephone mode:** When a call is in progress, press to mute the vehicle's microphone.

### Compatible disc types

Look for the 'Compact Disc Recordable' logo on new CD's. Other formats may not be recognised. Discs with paper labels and double-sided dual format discs should be avoided as they could become jammed.

## Portable media

Portable media includes iPod®, USB and AUX devices, and also **Bluetooth**® wireless technology devices, when the telephone option is fitted. The Audio system will play MP3 files from these devices, a USB memory stick, or a USB controlled MP3 player.

To connect a **Bluetooth** wireless technology media player, use the same procedure as when pairing and connecting a **Bluetooth** wireless technology device.

1. USB/iPod connection.
2. Auxiliary input: Uses a standard 3.5 mm audio jack.

*Note: The maximum shoulder size of any auxiliary input connector should not exceed 8 mm. A wider shoulder will prevent good connection.*

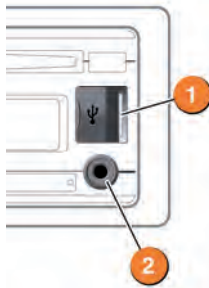

Connect a portable device, then press and release the **SOURCE** button repeatedly until **AUXILIARY** or **USB/iPod** is displayed. MP3 file play will now begin.

*Note: Sound quality and volume levels available from devices connected to the auxiliary input may vary widely.*

*Note: iPod/iPhone devices must be connected via the interface cable supplied with the device.*

### Controlling the iPod/iPhone device

Control of certain iPod/iPhone devices can be switched between the Audio system and the device. See the manufacturer's instructions. The iPod Control must be set to HU (Head Unit).

1. With an iPod/iPhone connected, press and hold **AUDIO/SETUP**.
2. Use the rotary control to select **iPod CONT**.
3. Select either **iPod MODE** or **HU MODE**.
  - **iPod MODE** - use the controls on the iPod/iPhone.
  - **HU MODE** - use the Audio system controls.
4. Press and hold **AUDIO/SETUP** to close the setup menu.

### iPod/iPhone song search

The Audio system's search facility can assist in finding the desired track.

1. With an iPod/iPhone connected, press and hold **AUDIO/SETUP**.
2. Use the rotary control to select one of the following options to begin the search.
  - **PLAYLIST**.
  - **ARTIST**.
  - **ALBUM**.
  - **SONG**.
  - **PODCAST**.
  - **GENRE**.
  - **COMPOSER**.
  - **AUDIOBOOK**.

Alternatively, select **SHUFFLE ALL** to play all of the audio tracks in a random sequence.

### Alphabet search

If the device has a refined track list, the alphabet search facility can be used to assist further.

1. While in the menu search mode, press **BAND** to activate the alphabet search mode.
2. Use the rotary control to select the first letter of the required track. A list of tracks beginning with that letter will be displayed.
3. Use the rotary control to select the required track and begin playback.

## Radio Data System (RDS)

RDS is a radio information system available from FM broadcasts. RDS allows reception of information, such as traffic information and station names, and also allows automatic retuning to a stronger transmitter that is broadcasting the same programme.

1. Press and hold **AUDIO/SETUP** to open the setup menu.
2. Use the rotary control to select **TUNER**.
3. Select one of the following options:
  - **AF** - Alternative Frequencies. Select **ON** or **OFF**.
  - **REGIONAL** - Regional programming. Select **ON** or **OFF**.
  - **PI SEEK** - Programme information seek. Select **ON** or **OFF**.
4. Press and hold **AUDIO/SETUP** to close the setup menu.

## Setting the clock

The clock can be set to automatically adjust according to RDS information.

1. Press and hold **AUDIO/SETUP** to open the setup menu.
2. Use the rotary control to select **TUNER**.
3. Select **AUTO CLOCK**.
4. Select **A-CLOCK ON** to enable or **A-CLOCK OFF** to disable.
5. Press and hold **AUDIO/SETUP** to close the setup menu.

## Standard audio system controls

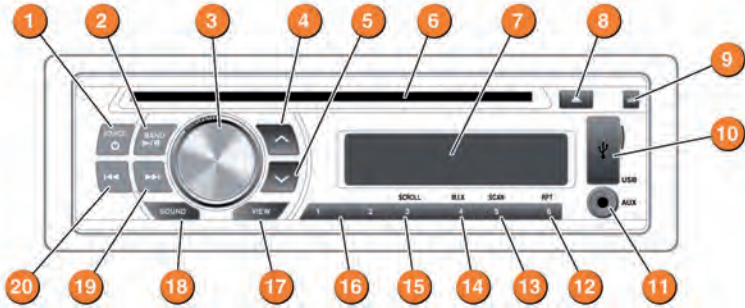

**1. SOURCE:** Press and hold to turn the system on or off. Press repeatedly to switch between **TUNER**, **DISC**, **USB AUDIO** and **AUXILIARY**.

**2. BAND:**

**In radio mode:** Short press to switch between radio wavebands.

**In CD/MP3 mode:** Pause/play the current audio source.

**3.** Rotate to adjust the volume. When a menu is open, rotate to move to the next or previous menu. Press to select a menu item.

**4. In radio mode:**

Long press to turn on Traffic Announcements.

**In MP3 mode:** Move to the previous folder.

**5. In radio mode:**

Press to activate TA (Traffic Announcements).

**In MP3 mode:** Move to the next folder.

**6.** CD slot.

**7.** Information display.

**8.** CD eject.

**9.** Faceplate release. Press to release and remove the faceplate.

**10.** USB connection.

**11.** AUX socket.

**12. In radio mode:**

Radio preset button 6. For all radio preset buttons, a short press will select the stored station. Press and hold to store the current radio station frequency to the preset button.

**In CD/MP3 mode:** **RPT** (repeat): Short press for continuous play of the current track. Press and hold for continuous play of the current MP3 folder.

**13. In radio mode:** Radio preset button 5.

**In CD/MP3 mode:** **SCAN.** Short press to play the first 10 seconds of all CD tracks. Press and hold to play the first 10 seconds of all tracks in each MP3 folder.

**14. In radio mode:** Radio preset button 4.

**In CD/MP3 mode:** **MIX** (shuffle): Short press for CD random play. Press and hold for MP3 folder random play.

**15. In radio mode:** Radio preset button 3.

**In CD/MP3 mode:** **SCROLL.** Press to scroll through a long title on the display screen.

**16.** Radio preset buttons 2 and 1.

**17. VIEW:** Change the displayed information.

**18. SOUND:** Short press to access the sound/tone settings menu. Press and hold to access the audio setup menu. Select and adjust with control 3. Press and hold to close the setup menu.

**19. Seek up:** Short press to search up to the next station or the next track in the current audio mode. Press and hold to search up through the current Radio Frequency or forward to the next track in the current audio mode. Press again to stop the search.

**20. Seek down:** Short press to search down to the next station or the previous track in the current audio mode. Press and hold to search down through the current Radio Frequency or back through the track in the current audio mode. Press again to stop the search.

## Bluetooth® wireless technology

### Pairing and connecting a Bluetooth® wireless technology device

The vehicle's audio system must first be set to **VISIBLE** as follows:

1. Press and hold **AUDIO/SETUP**.
2. Select **BLUETOOTH**.
3. Select **VISIBLE M**.
4. Select **VISI M ON** or **VISI M OFF**, as required.
5. Press and hold **AUDIO/SETUP** to close the setup menu.

### Bluetooth wireless technology phone compatibility

Compatible **Bluetooth®** wireless technology phones can communicate with the vehicle's telephone system. For the latest compatibility information, refer to [www.landrover.com](http://www.landrover.com). Select **OWNERS**, then **Bluetooth**.

To pair a telephone, use the following procedure in conjunction with your Bluetooth wireless technology phone manufacturer's instructions.

*Note: The process of pairing and connecting a phone to the vehicle will vary depending on the type of mobile phone used.*

*Note: If a **Bluetooth** wireless technology device is already connected, turn it off before making another pairing. Up to 3 devices can be paired to the system.*

1. Switch the ignition on.
2. Using the mobile phone, search for Bluetooth wireless technology devices. See your phone's operating instructions for further information.
3. When the vehicle's wireless technology system is discovered, select **PAIR YES** from the mobile phone menu.

*Note: Some mobile phones require a 4 digit PIN code. Enter 0000.*

4. Once your phone is paired, it may automatically connect to the vehicle's system. If not, follow the pairing procedure to pair the telephone manually.

*Note: Some phones require the pairing to be set as 'authorised' or 'trusted', in order to automatically connect. Please refer to your phone's operating instructions for further information.*

### Changing the Bluetooth wireless technology device

When there are two or more devices paired, follow the procedure to change to one of the other devices.

1. Press and hold **AUDIO/SETUP**.
2. Select **BLUETOOTH**.
3. Select **PAIRED DEV**.
4. Select the required device from the list.
5. Select **CONNECT**.
6. Press and hold **AUDIO/SETUP** to close the setup menu.

### Downloading phonebook entries

When a phone with phonebook download capability is connected, its phonebook directory can be automatically downloaded to the vehicle's system.

1. Press and hold **AUDIO/SETUP**.
2. Select **BLUETOOTH**.
3. Select **PB UPDATE**, then select **ON**.
4. Press and hold **AUDIO/SETUP** to close the setup menu.

### Searching phonebook entries

A contact number can be accessed from the phonebook to make a call.

1. Press and hold **AUDIO/SETUP**.
2. Select **BLUETOOTH**.
3. Select **PHONE BOOK**.
4. Press **ABC SKIP/TA** to activate the alphabet search mode.
5. Select the first letter of the contact name.
6. Press the skip button to move to the second letter.
7. Select the second letter of the contact name.
8. Press the skip button to move to the third letter.
9. Select the third letter of the contact name.
10. Use the rotary menu select control to show all matches.
11. Select the required contact number and press the menu select control to begin the call.

## Fuel filling

### Filler cap location



The fuel filler cap is located on the right side of the vehicle.



### To remove:

1. While holding the filler cap, insert the small metal key and turn it half a turn counter clockwise.
2. Remove the key.
3. Slowly unscrew the filler cap, allowing any fuel tank pressure to be released.
4. Remove the cap.

### To replace:

1. Refit the filler cap and tighten it clockwise. The ratchet must click at least 3 times.
2. While holding the filler cap, insert the key and turn it half a turn clockwise.
3. Remove the key.
4. The filler cap is now locked but can still be rotated.

Diesel fuels with a bio-diesel blend of up to 7%, in accordance with EN590 standard, can be used.

**DO NOT** use a bio-diesel blend of more than 7%.

The sulphur content of diesel fuel used in Land Rover vehicles should not exceed 0.3% (3000 parts per million).

In countries where the sulphur content is higher, more frequent servicing will be required.

Land Rover can accept no responsibility for damage caused by using incorrect fuels.

If the vehicle is filled with the wrong type of fuel:

**DO NOT** start the engine!

Call for qualified assistance!

## Tyre pressures

Tyre pressures are displayed on a label fixed to the inside of the front door opening, on the right side of the vehicle.