

# RANGE ROVER

## QUICK START GUIDE

- 2 DRIVER CONTROLS
- 3 VEHICLE ACCESS
- 4 COMFORT ADJUSTMENTS
- 6 DRIVING
- 12 TOUCH SCREEN
- 13 NAVIGATION SYSTEM
- 14 AUDIO/VIDEO
- 16 TELEPHONE



SOME FEATURES MAY NOT BE FITTED TO YOUR VEHICLE.

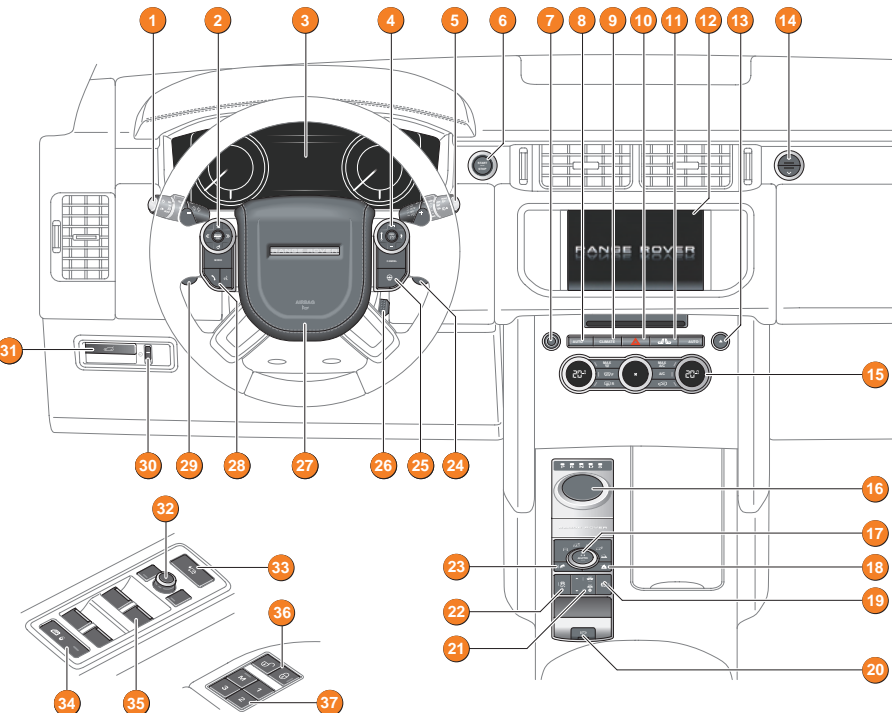



- |   |   |
|---|---|
| 1. Headlamps, direction indicators and trip computer  | 20. Electric parking brake                      |
| 2. Settings menu control                              | 21. Air suspension height control               |
| 3. Instrument panel, warning lamps and message center | 22. Stability control (DSC)                     |
| 4. Cruise control/adaptive cruise control             | 23. Hill Descent Control                        |
| 5. Wipers and washers                                 | 24. Up shift gear paddle                        |
| 6. Engine START/STOP                                  | 25. Heated steering wheel                       |
| 7. Audio on/off and volume                            | 26. Steering column adjuster                    |
| 8. Auto climate control                               | 27. Horn  |
| 9. Climate on/off                                     | 28. Telephone and voice recognition controls    |
| 10. Hazard warning lights                             | 29. Down shift gear paddle                      |
| 11. Heated/climate seat                               | 30. Interior lamps dimming control              |
| 12. Touch screen                                      | 31. Tailgate release                            |
| 13. CD eject  | 32. Mirror adjuster/power fold mirror           |
| 14. Upper/lower glovebox release                      | 33. Access/height adjustment                    |
| 15. Climate control                                   | 34. Rear windows isolation and child door locks |
| 16. Gear selector                                     | 35. Window controls                             |
| 17. Terrain response                                  | 36. Central locking switches                    |
| 18. Low range transmission switch                     | 37. Driving position memory                     |
| 19. Automatic speed limiter (ASL)                     |   |

## Smart Key

-  Press once to switch the headlamps on. Press again to switch off.
-  Press to unlock and release the tailgate. A powered tailgate will open to the set height.
-  Press and hold for 3 seconds to activate/cancel the panic alarm.

## Unlocking mode alternatives

-  Single-point entry. Press once to unlock only the driver's door. Press twice to unlock all doors and luggage area.
  - Multi-point entry. Press once to unlock all doors and luggage area.
- To change the mode - with the vehicle unlocked, press and hold the lock and unlock buttons simultaneously for 3 seconds. The hazard warning lamps will flash to confirm the change.

## Keyless entry

The Smart Key needs only to be on the driver's person while using a door handle. It does not need to be exposed.

## Operating note

The Smart Key may not be detected if placed in a metallic container or behind a device with an LCD screen, such as a smart phone, laptop (including when inside a laptop bag), games console etc. Keep the Smart Key clear of such devices when attempting keyless entry or keyless starting.

## Emergency key release

Slide the side section up to remove. Remove the keyblade and unfold it. Use the blade to gently prise off the front left side door lock cover.

Insert the key into the exposed lock and turn towards the front of the vehicle, then release it to unlock.

If the security system was previously armed with the Smart Key, when the door is unlocked the alarm will sound. To disarm the alarm, press the unlock button on the Smart Key or press the **START/STOP** button with the Smart Key inside the vehicle.

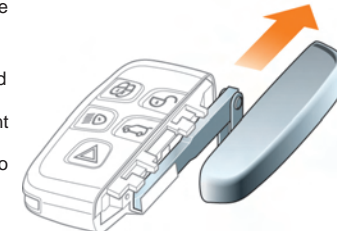

## Operating note

If the Smart Key fails to work, hold it flat against the side of the steering column with the buttons facing outwards. Start the engine as normal. The Smart Key can now be removed.

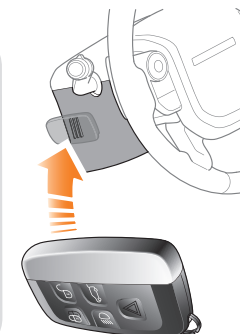

## Powered and manual tailgates *See page 2, item 31.*

1. Press to release the upper tailgate:

Alternatively, use the Smart Key or press the internal release switch.

A powered upper tailgate will continue to open to the set height.

2. With the upper tailgate open, press to release the lower tailgate.

To close the powered tailgate

3. Press and release to close the upper and lower tailgate.

## Operating note

When the powered tailgate closes onto the locking latch, it will continue to 'soft close' to the fully closed position.

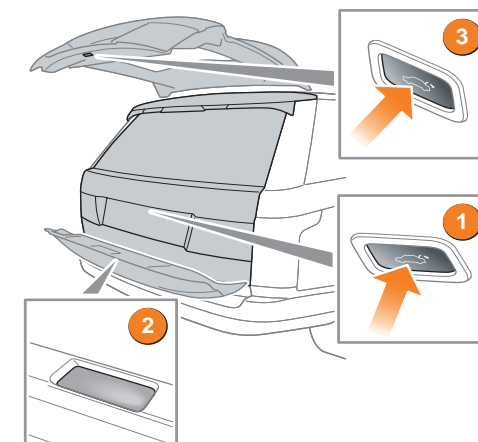

## Electric seat adjustment *See page 2, item 37.*

The front seats and rear business seats can be adjusted in up to 10 directions. The controls are located on the outer edge of the seat.

1. Side bolster - deflate.
2. Side bolster - inflate.
3. Lumbar support.
4. Backrest.
5. Height.
6. Forward and rearward.
7. Cushion angle tilt.
8. Cushion length.

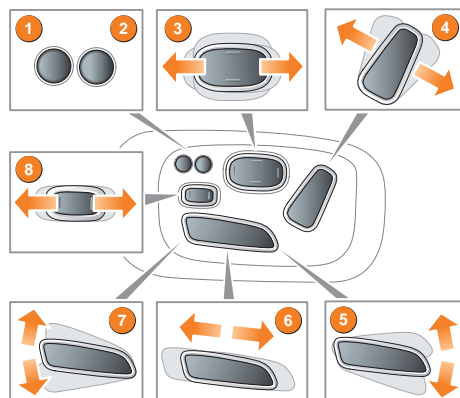

### Steering column

9. With the vehicle stationary, adjust the steering column to your ideal driving position.

### Memory seats and column

If seat memory is available, the driver's, rear business seats and exterior mirror positions can be saved to the vehicle memory. Up to 3 sets of seat and mirror positions can be saved at any one time.

1. When the required positions have been achieved, press the **M** button on the door mounted control panel.
2. Within 5 seconds, press one of the store buttons, **1**, **2** or **3** to memorise the positions. A confirmation message will be displayed in the Message center.
3. To recall a stored setting, press the relevant button.

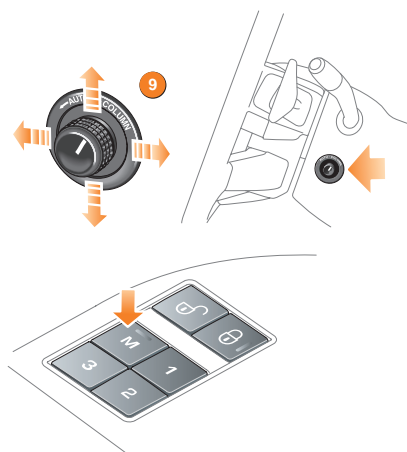

### Operating note

Memory seat buttons **1**, **2** or **3** must be pressed within 5 seconds after pressing the **M** button otherwise the memory store function will cancel.

## Seat belts and child restraints *See page 2, item 34.*



A warning indicator on the instrument panel will illuminate if a front seat belt is unbuckled. This may be accompanied by an intermittent chime.

### Child door and rear windowFm locks

If children are to be carried in the rear seat positions, it is recommended that the rear door interior handles are disabled.

Press the switch to activate child door locks and isolate rear windows. The LED indicator will illuminate when active and a message will display in the Message center.

Press again to switch off. The LED will extinguish and a message will display in the Message center.

### Child seats

It is the weight of a child, rather than age, that determines the type of seat required.

Refer to **Child seats** in the Owner's Handbook to determine the correct seat for your child.

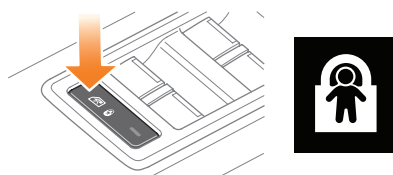

## Climate control *See page 2, item 15.*

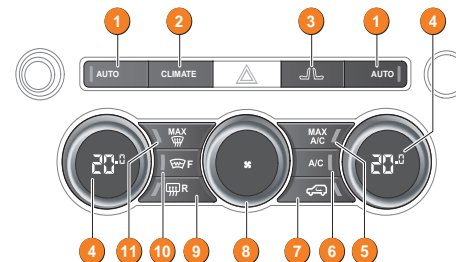

**AUTO** is the recommended operating mode. This will help prevent fogging.

1. **AUTO mode.** For fully automatic operation.
2. **CLIMATE.** To display the climate control menu.
3. Front heated/climate/massage seat menu.
4. **Temperature controls.** For individual driver/passenger settings.
- Note: The system allows temperature differential of up to 7°F (4°C) between left and right passenger areas.*
5. **MAX A/C.** Maximum air conditioning program.
6. **A/C.** For cooled and dehumidified air. Press to switch air conditioning off/on.
7. **Recirculation.** Press for timed recirculation. Press and hold for latched (continuous) recirculation. To cancel recirculation, press the button again.
- Note: Prolonged use at low temperatures may cause the windows to fog.*
8. **Blower control.** Rotate to adjust airflow from the facia vents. Rotate fully anti-clockwise to switch off climate control.
9. **Heated rear screen.**
10. **Heated front screen.**
11. **Maximum defrost.** Fastest method to remove frost or heavy fogging from the front screen.

### Touch screen controls

To access the touch screen control, touch **CLIMATE** on the climate control panel.

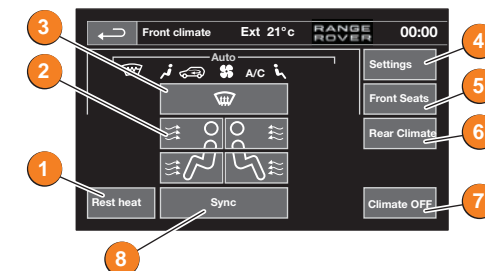

1. With the engine switched off press to operate Rest heat. Uses the engine heat to provide cabin heating.
2. Air distribution.
- Note: More than one setting may be selected at a time to achieve the desired distribution.*
3. Distribute air to windshield.
4. Climate control settings menu.
5. Front heated/climate/massage seat menu.
6. Rear climate menu.
7. Climate control system on/off.
8. Synchronize driver and passenger climate zone settings.

### Operating note

Seat heating and ventilating will operate only while the engine is running. This is to prevent the battery becoming discharged.

## Instrument panel menu *See page 2, item 2 and 3.*

A number of vehicle features and display settings may be configured via the Message center menu.

To display and navigate through the menu, operate the menu control on the steering wheel.

1. Steering wheel menu control.
2. Close or return to the main menu.
3. Access the vehicle driving features menu.
4. Access the trip computer menu.
5. Access the instrument display menu.
6. Access the vehicle set-up menu.
7. Access the vehicle service menu.

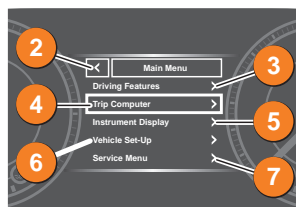
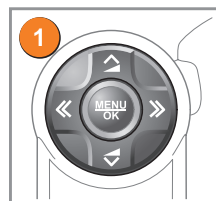

## Exterior lights *See page 2, item 1.*



**1. Outer collar.** First position for side lights, second position for headlamps, third position for **AUTO**. With **AUTO** selected, all lamps will switch on automatically when ambient light fades.

**2. Inner collar.** Turn up and release for front fog lamps. Turn down and release for rear fog lamps. Turn and release again for off.

**Headlamps high beam.** Push forwards for high beam. To flash the headlamps, pull back and release.

**High beam assist.** Active when set in the Instrument panel menu, **AUTO** is selected and low beams are in use. High beam will automatically activate when the sensor detects no light or very low light source ahead. Low beam will be automatically selected when appropriate.

## Wipers and washers *See page 2, item 5.*

1. Rotate to adjust intermittent delay.
2. High speed wipe.
3. Low speed wipe.
4. **AUTO** (sensor controlled) or intermittent wipe.
5. Rear screen wash/wipe.
6. Windscreen single wipe.
7. Windscreen wash/wipe.
8. Rotate to the first position for intermittent rear screen wipe. Rotate to the second position for continuous wipe.

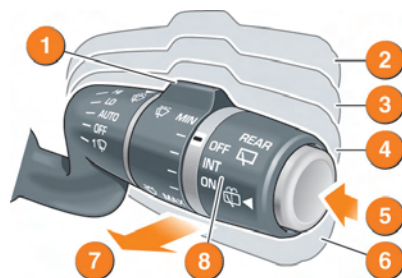

If freezing conditions are likely, the wipers can be set to a higher position so that they can be lifted from the screen. See **Instrument panel menu**.

### Care point

Before entering an automatic car wash, turn the wipers off to deactivate the **AUTO** wipe sensor.

## Cruise control *See page 2, item 4.*

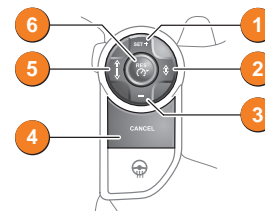

1. Press to increase or set the speed.
2. Press to decrease the follow mode gap.
3. Press to decrease the set speed.
4. Cancel cruise control.
5. Press to increase the follow mode gap.
6. Resume previous set speed retained in memory. Set speeds are cleared at ignition off.

## Panoramic roof and blind

1. Press once to tilt the panoramic roof. Once tilted, press again to open the roof.

Press to close the roof from tilt. From the fully open position, press once to close to the tilt position, then press again to close fully.

**One touch open/close,** briefly press the switch fully and release.

2. Roof blind open/close switch:

**To open the blind:** Press the rear of the switch and release. The blind will open.

**To close the blind:** Push the front of the switch and release. The blind will close.

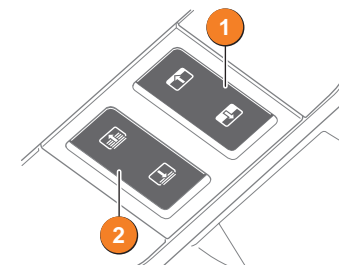

## Terrain response *See page 2, item 17.*

**Automatic mode** - Automatically determines and applies the most appropriate program for the conditions. If the rotary selector is in the elevated position, depress the selector to engage automatic mode.

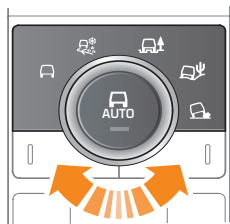

Manual program selection is via the rotary selector. Icons will illuminate as selected. The Message centre will also display an icon.

### Wading

Select the program most suitable for the surface beneath the water. DO NOT exceed a water depth of 35 in (900 mm).



**General** - Use for typical road surfaces.



**Grass-Gravel-Snow** - For surfaces which are firm but have a slippery surface, e.g. grass, snow, loose gravel, pebbles or icy conditions.



**Mud-Ruts** - Suitable for soft, muddy, uneven or rutted ground.



**Sand** - Suitable for soft, predominantly dry, yielding sandy ground, e.g. sand dunes and deserts. If the sand is damp or wet, the Mud-Ruts program may be more beneficial.



**Rock Crawl** - Only selectable when in LOW range. Suitable for crossing wet or dry, solid unyielding ground requiring high levels of wheel displacement, e.g. clusters of boulders or rocky river beds.

## Luggage and stowage

A luggage retention kit is provided to assist with safely securing items of luggage to the loadspace floor.

Floor mounted luggage rails provide a full width mounting channel that will accommodate either a flexible retracting band or a solid telescopic barrier, to retain luggage of all shapes and sizes.

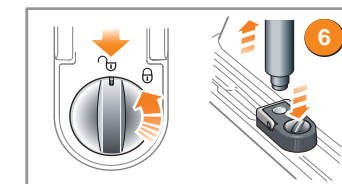
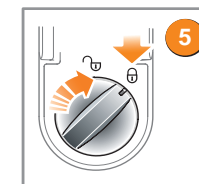
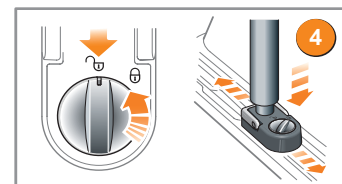
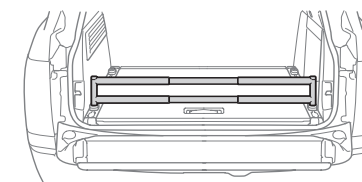
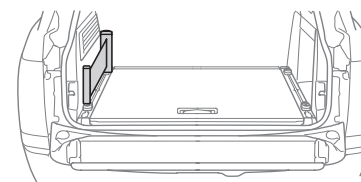
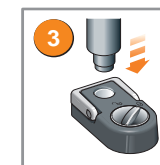
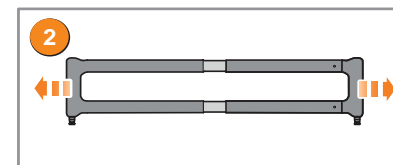
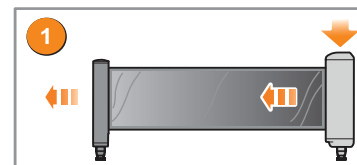

1. Press and hold to adjust length required of retracting band.
2. Adjust divider to required length.
3. Unlock required lashing eye, attach the luggage band/divider to the lashing eye.
4. With the lashing eye in the unlocked position, press the button and slide to the required position in the luggage rail.
5. Lock the lashing eye when in required position.
6. To remove luggage band/divider from lashing eye, unlock lashing eye and press the lock/unlock button and release.



## Blind spot monitoring (BSM)

While a forward gear is selected and the speed is above 10 mph (16 km/h), the BSM system will detect a vehicle approaching from behind, on either side, within its scanned range. Detection range is approximately 20 ft (6 m) to the rear and 8.2 ft (2.5 m) to the sides.

1. An amber icon, depicting an approaching vehicle, will illuminate in the relevant door mirror.
2. An amber dot will illuminate at speeds below 10 mph (16 km/h). BSM is active only when the amber dot is extinguished.

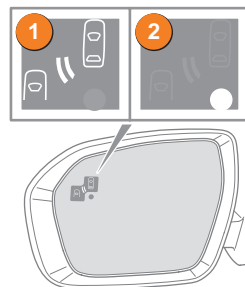

## Closing vehicle detection

The Closing vehicle detection system monitors a larger area behind the vehicle 1. If a rapidly approaching vehicle is detected 2, the amber warning icon will flash in the relevant door mirror to indicate a potential hazard and therefore, a lane change maneuver may be dangerous. Warning icons in both mirrors will flash if rapidly approaching vehicles are detected on both sides. When the vehicle reaches the area monitored by the

Blind Spot Monitor 3, the amber warning icon will illuminate continuously.

### Operating note

The system covers an area of a fixed lane width. If the lanes are narrower than a typical carriageway lane, objects travelling in non-adjacent lanes may be detected.

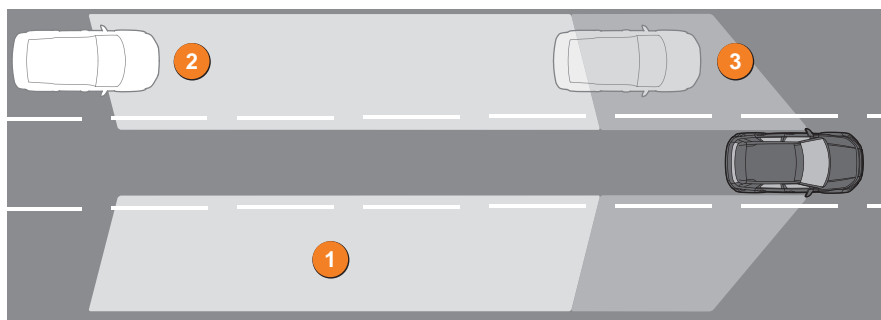

## Reverse traffic detection

The Reverse traffic detection system provides a warning of any moving vehicle that may pose an accident risk during a reversing maneuver.

1. An amber icon, depicting an approaching vehicle, will illuminate in the relevant door mirror, to indicate the presence of a moving vehicle.
2. The rear camera screen or the parking aid screen will also show a warning on the relevant side(s) of the screen.

To switch between the rear camera and the parking aid screen, touch the camera image or the Rear camera icon accordingly.

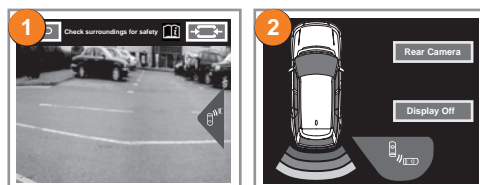

### Operating note

Reverse traffic detection is automatically disabled when a trailer is connected

## Parking aids

Front and rear parking aids are activated when reverse gear is selected. When a forward gear is subsequently selected, the parking aids remain active until vehicle forward speed exceeds 10 mph (16 km/h).

If an obstruction is detected, an intermittent tone will sound. Moving closer to the obstruction will increase the tone frequency.

### Parking aids switch

Press the switch to deactivate.

### Rear camera

When reverse gear is selected, the camera provides a rear view image with overlaid guidelines to assist while reversing.

To view the parking aid display instead or to cancel camera display at any time, briefly touch the display.

1. Broken line - full width of vehicle.
2. Solid line - projected reversing path.
3. Shade - area required for tailgate access.
4. Parking sensors activated.
5. User options. Touch one of the mini views to select overlay options.

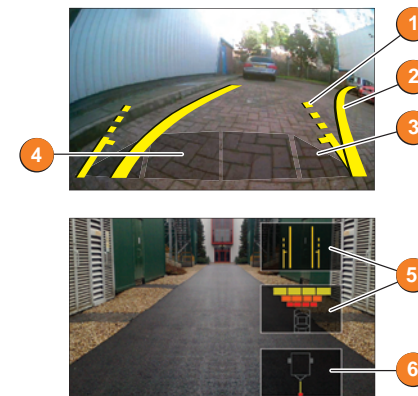
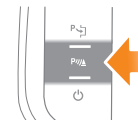

6. Hitch assist. To aid the process of guiding the vehicle to the trailer tow hitch. A single hitch line is displayed as the reversing guideline. As the vehicle closes to within 24 in (0.6 m) of the tow hitch, an automated zoom is operated.

## Park assist

Park assist helps the driver to parallel park. When the sensors identify a suitable space, the vehicle can be steered automatically into place while the driver operates the accelerator and brake. The driver does not steer the vehicle.

While searching for a parking space, use the following procedure:

1. Press to activate while driving forwards at a speed less than 19 mph (30 km/h).
2. Park Assist is displayed in the message center.
3. Park Assist searches for a space on the side of the front passenger. To search for a space on the driver's side, signal a turn in that direction.
4. As you drive forward, potential spaces are assessed. A short confirmation tone sounds when a suitable space is found.
5. Park Assist will instruct to stop or to drive forward to a starting point and when to select reverse gear.

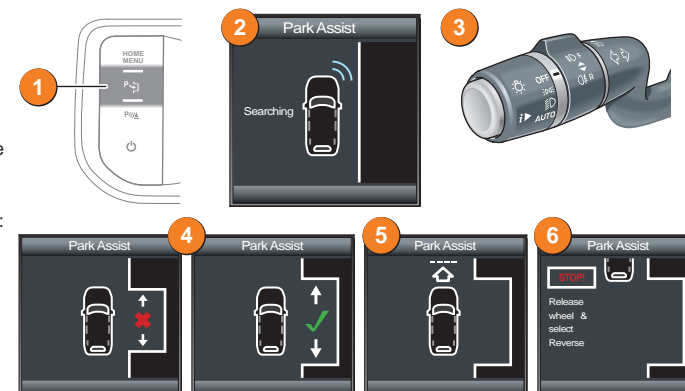

6. Park Assist will then take control of the vehicle's steering system. Release the steering wheel and apply the accelerator carefully to move the vehicle slowly into the space. Use the footbrake to stop when instructed by Park Assist.

Further maneuvering may be required. Follow instructions in the message center.

When the maneuver is completed, STOP will be displayed.

## Touch screen

The touch screen requires only light touches. Excess pressure could result in damage.

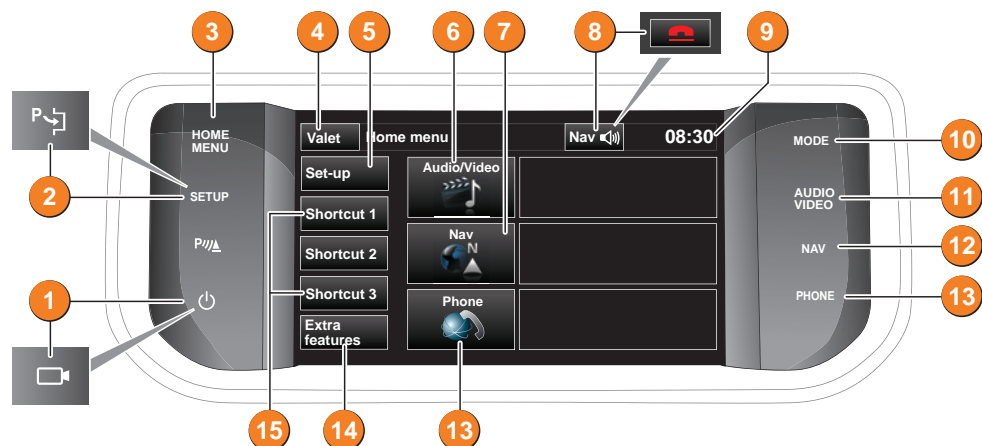

1. **Screen on/off.** Each time the ignition is turned on and this button is pressed, the **Home menu** will be displayed. If the ignition remains on and the touch screen is turned off and later turned on again, the last used screen or menu will be displayed. When cameras are fitted, this icon is changed and the button will turn cameras on and off.

2. **SETUP.** When Park Assist is specified, this icon is changed and the button will turn Park Assist on and off. The Settings menu is then accessed via the touch screen.

3. **HOME MENU.** Content will depend upon vehicle specification and options selected.

4. **Valet mode.** Locks the luggage areas and prevents access to the touch screen when allowing others, (e.g., a parking attendant,) to take charge of your vehicle. You will have to enter a 4 digit code of your choice. When re-entering the vehicle the code is needed to unlock this security feature.

5. **Set-up menu.** Set-up is divided into categories, Screen, System and Voice.

6. **Audio/Video menu.** An overview of current audio/video information is displayed.

7. **On road Navigation menu.** Current set destination is displayed.

8. **Touch to repeat the last navigation voice instruction.** During a phone call, the icon is temporarily changed to indicate a call is in progress. Touch to end the call.

9. **Touch to select time or date adjustment.**

10. **MODE.** Press repeatedly to scroll through all audio/video sources.

11. **AUDIO VIDEO** menu.

12. **NAV.** Touch to select Nav menu 1 of 2.

13. **PHONE** menu.

14. **Extra features.** There are more features available than can be displayed at one time, e.g. Ambient lighting, Cameras and Timed climate. Touch to display the feature list then use the forward and back soft keys to progress through it.

15. **Shortcut keys.** Use for personal shortcuts to any part of the system. Shortcuts can be made in the **Set-up** menu. Items in the **Extra features** list can be set as a shortcut. The shortcut soft keys can be changed at any time.

## Nav menu

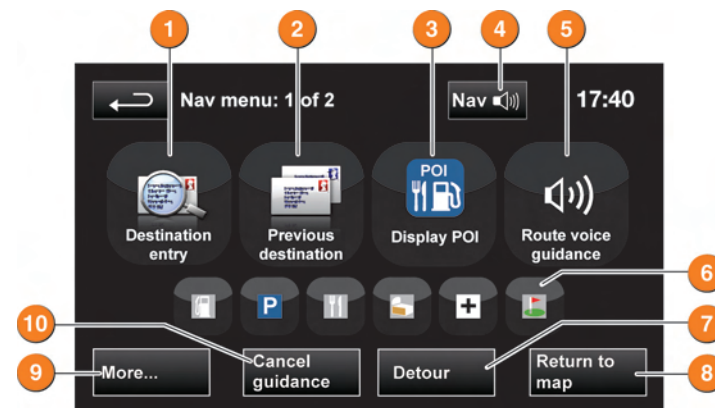

1. Use to enter a new destination. Provides a choice of options when entering a destination.

2. Displays previous destinations entered. Previous destinations can be selected.

3. Turns the POI (Point Of Interest) icons on the map on/off.

4. Only visible when a destination is set. Enables the last voice instruction to be repeated.

5. Soft key is highlighted while voice guidance is enabled. Touch to turn voice guidance off.

6. POI shortcuts: Touch icon to list available POIs that are close to the vehicle position.

7. Calculates a detour from the current route.

8. Advances to the main map screen.

9. Move to other Navigation menu. There are 2 navigation menu screens. The second map screen features soft keys for **Stored locations**, **TMC**, **Route options** and **Nav set-up**. Use the **More...** soft key to toggle between them.

10. Cancel current route guidance.

On the second screen, **Stored locations** is used to manage the stored data. **TMC** (Traffic Message Channel) will provide data about road conditions and any events that may affect the current route. **Route options** allows the selection of various options for the route and **Nav set-up** is for setting personal preferences within the navigation system.

### Selecting navigation

When navigation is selected after the ignition is turned on, a caution screen is displayed. Touch **Agree**.

*Note: At the first time of accessing the caution screen, set the required language.*

### Setting a destination

Select **Destination entry**.

Select **Address** and enter address details using the keyboard. As each part of the address is refined, touch **OK** or **List** to display all the streets and towns that are available to be selected. If the house number is not known, press **OK**, the mid-point of the road is then used as the destination.

When the address entry fields are complete, press **OK** to move to the map screen.

### Start guidance

When in the map screen touch **GO** to start guidance.

### Review route.

There will be a choice of **3 routes** or **Change route**. **3 routes** will display 3 different route options on the map. Select **Route 1**, **2** or **3** by touching the respective box displayed on the right side of the map and then select **GO**.

## Radio

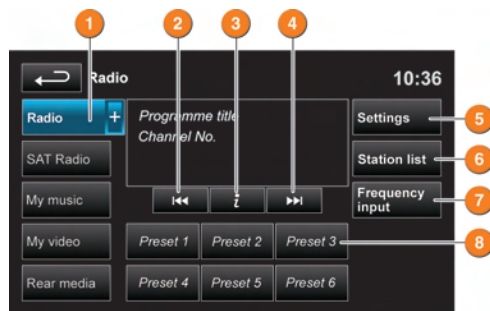

5. Touch to view and activate/ deactivate: RDS, Traffic, News, AF and REG.

6. Touch to view a list of available stations on the FM waveband.

7. Touch to enter a station frequency on the current waveband, using the numeric keypad. Select OK or wait for automatic tuning.

8. Station presets: Touch and release a preset to tune to the station stored on that preset. Touch and hold to store the current station to that preset.

1. Touch to view and select a waveband.
2. Seek down: Short touch to auto seek down to the next radio station. Long touch to activate manual seek mode.
3. Information from the current station.
4. Seek up: Short touch to auto seek up to the next radio station. Long touch to activate manual seek mode.

## SAT radio

Satellite radio is a subscription service. Channel 184 is available as a preview channel for a limited time. During this period the satellite radio provider (SIRIUS) telephone number and the SIRIUS ID number will be displayed. To activate and use the satellite radio, call SIRIUS while you are inside the vehicle.

The SIRIUS information can also be viewed via the **Settings** soft key in **SAT information**.

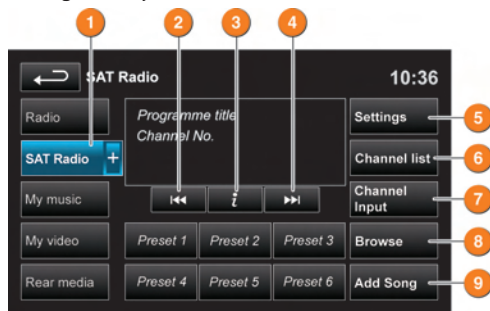

5. Touch to view:

**Options** - activate/deactivate Song seek features.  
**Channel skip** - select individual channels or entire categories.

**Parental lock** - Make selections and lock them with a 4 digit code to prevent access. The PIN default is 0000. Select **Edit PIN** to change it to your personal code.

**SAT information** - SIRIUS information.

6. Touch to view available categories. Select a category to view the corresponding channel list. Select a channel.

7. Touch to enable the numerical touch pad. Enter a channel number.

8. Select from the list of categories to view details. Select a channel.

9. Select to add the currently playing song reference information into the song memory. Subsequently, if a channel is playing a song and its reference information is stored in the song memory, a pop up will be displayed giving you the option to tune to that channel

1. Touch to view and select a SAT band (SAT 1, 2 or 3). The radio will tune to the last used channel on that band. Touch again to close.
2. Seek down: Short touch to seek previous available channel.
3. Channel information.
4. Seek up: Short touch to seek next available channel.

## Portable media



Includes CD, iPod®, USB, AUX and Bluetooth® devices. The full infotainment system also includes Stored CD.

1. Touch + icon to display all options. Select an option.

*Note: Sound quality and volume levels available from devices connected to the auxiliary input may vary widely.*

2. Touch to switch traffic and news on or off. Additionally, for MP3 recorded media, you can select the number of list entries that are skipped when you use the page up/down arrows.

3. Depending on the selected mode, this soft key will be either **Track list** or **Browse**.

**Track list.**

• Touch to view current CD or Stored CD track list. Select a track to start playback.

**Browse.** iPod, USB and Stored CD modes only.

- Touch to view contents of the connected device and start playback.
- 4. Touch to view and manage the Stored CD memory.
- Select Upload alongside an empty slot to upload a CD. There are 10 slots available.
- Select Replace to overwrite an existing CD.

*Note: Loading time is dependent on content type. Other features can be selected while upload is in progress.*

5. Skip/Scan forward.
6. **Repeat**  
In CD mode;
- Touch to repeat the current track continuously.

Touch again to repeat the current Stored CD (or folder for MP3 discs) continuously until **Repeat** mode is cancelled. Touch again to cancel.

In USB or iPod mode;

- Touch to repeat the current track continuously. Touch again to repeat the current folder (USB) or to cancel **Repeat** mode (iPod). Touch again to cancel.

*Note: Repeat mode is not available for Bluetooth® devices.*

7. Pause/Play: Select to pause playback. Select again to resume playback.

8. Information about the current track.

9. Touch to play random tracks from the current source. Touch again to cancel.

*Note: Shuffle mode is not available for Bluetooth® devices.*

10. Skip/Scan backward.

## Connecting a device

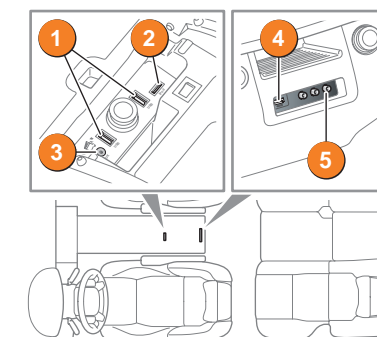

1. USB.
2. iPod sockets.
3. 3.5 mm AUX socket.
4. Rear media USB/iPod socket.
5. Rear media AV sockets.

Steering wheel audio control *See page 2, item 2.*

Audio system selections can also be made from the steering wheel control.



1. Volume increase.
2. Seek up.
3. Volume decrease.
4. Press repeatedly for options.
5. Seek down.



## Telephone

Compatible phones can communicate with the vehicle's inbuilt telephone system.

### Bluetooth® phone compatibility

For the latest list of compatible phones and their software, refer to [www.landroverusa.com](http://www.landroverusa.com). Select **OWNERS** then **Bluetooth**.

Use the following procedure in conjunction with your phone manufacturer's instructions.

### Pairing and connecting using the phone

*Note: The process of pairing and connecting a phone to the vehicle will vary depending on the type of phone used.*

1. Switch the ignition on and ensure that the touch screen is active.
2. From the **Home menu**, select **Phone**.
3. A menu will appear. If no phone is connected, select **Search new**, otherwise select **Change phone** and then select **Search new**.
4. Select **Device to vehicle** option.

*Note: The vehicle's Bluetooth system is discoverable for only 3 minutes.*

5. Using the phone, search for Bluetooth devices. On some phones, this is referred to as new paired device. See your phone's operating instructions for further information.
6. When the vehicle's Bluetooth system is discovered, begin the pairing process and follow the on-screen instructions.
7. When requested, enter a PIN of your choice into the phone and vehicle system.
8. Once your phone is paired it may automatically connect to the vehicle system. If not, use the device list shown on the touch screen or use the phone.

*Note: Some phones require the Bluetooth pairing to be set as 'authorized' or 'trusted' in order to automatically connect. Please refer to your phone's operating instructions for further information.*

### Downloading phonebook entries

When a phone with phonebook download capability is paired and docked, its phonebook directory can be automatically downloaded to the vehicle system.

See **PHONEBOOK** in the Owner's Handbook for more information.

### Calls via the touch screen



With a paired and active phone press the **PHONE** button on the touch screen surround.

1. Select **Digit Dial**, **Phonebook** or **Last 10**. With **Digit Dial** selected, use the keypad to enter the number. With **Phonebook** selected, choose a number from the downloaded phonebook. **Last 10** displays the previous 10 calls. Choose one to dial.

2. Touch the  to make the call.

3. The icon will change to . Touch the icon to end a call.

### Calls via the steering wheel controls

See page 2, item 2.

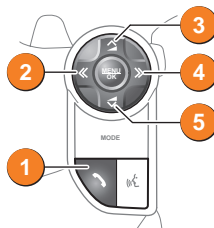

1. Press to answer a call. Press to end a call. Press and release to dial a number/contact. Press and release to access the last 10 dialed list. Press and hold to access the phonebook.

2. Press to scroll back through received calls, last 10 list and to exit list.

3. Press to increase volume when in a call or scroll up through a displayed list.

4. Press to scroll to received calls, last 10 list.

5. Decrease volume when in a call or scroll down a displayed list.