

RANGE ROVER SPORT

QUICK START GUIDE



SOME FEATURES MAY NOT BE FITTED TO YOUR VEHICLE.

- | | | | |
|----|---------------------|----|--------------------------------|
| 2 | VEHICLE ACCESS | 10 | CRUISE CONTROL |
| 3 | DRIVER CONTROLS | 11 | AIR SUSPENSION |
| 4 | COMFORT ADJUSTMENTS | 11 | TERRAIN RESPONSE |
| 6 | CLIMATE CONTROL | 12 | AUDIO SYSTEM WITH TOUCH SCREEN |
| 7 | ENGINE START | 14 | NAVIGATION |
| 8 | WARNING LAMPS | 15 | BLUETOOTH TELEPHONE |
| 10 | TRANSMISSION | 16 | GAS STATION INFORMATION |

RANGE
ROVER

Range Rover Sport Smart Key



Press once to lock the vehicle and arm the alarm.

Press and hold to close any open windows and lock all doors (Global closing).



Multi-point entry - Press once to disarm the alarm, unlock the doors and unlock the luggage compartment.

Press and hold to unlock all doors and open the windows (Global opening).



Press once to switch the headlamps on for 30 seconds. Press again to switch off.



Press to unlock and release the tailgate. If the alarm is armed, it will be inhibited while the tailgate is open.



Press and hold for three seconds to activate/cancel the panic alarm.

Emergency key release

Press the release button then slide the side section out. Pull up the keyblade. Use the blade to prise off the front left-hand door lock cover.

Insert the key into the exposed lock and turn towards the rear of the vehicle, then release it to unlock.

If the security system was previously armed with the Smart Key, when the door is unlocked the alarm will sound. To disarm the alarm, press the unlock button on the Smart Key or press the **START STOP** button with the Smart Key inside the vehicle.



Unlocking mode alternatives

Single-point entry allows only the driver's door to unlock with a single press. A second press unlocks all other doors and luggage area.

Multi-point entry will unlock all doors and luggage area with a single press.

To change between modes, with the vehicle unlocked, press and hold the lock and unlock buttons simultaneously for three seconds. The hazard warning lamps will flash to confirm the change.

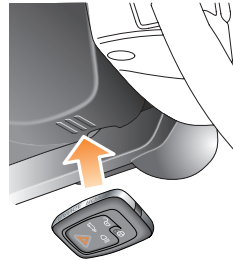

Operating note

If the Smart Key fails to operate, hold it under the steering column in the indicated position. Start the engine as normal (see page 7). The Smart Key can now be removed.

Central door locking

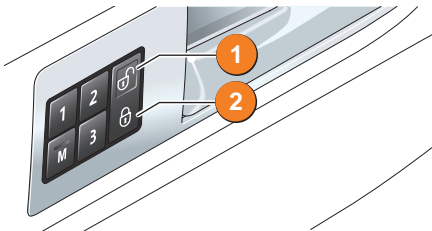

1. Press to unlock all doors and tailgate.
2. Press to lock all doors and tailgate. This will not enable the alarm

Operating note

If the vehicle has already been locked with the Smart Key, the master unlocking switch will not release the locks.

Drive away locking

If enabled, all apertures will automatically lock when the vehicle speed exceeds 5 mph (8 km/h).

The feature can be turned off or on in the **Settings** option accessed via the trip computer.

Driver controls

RANGE ROVER SPORT

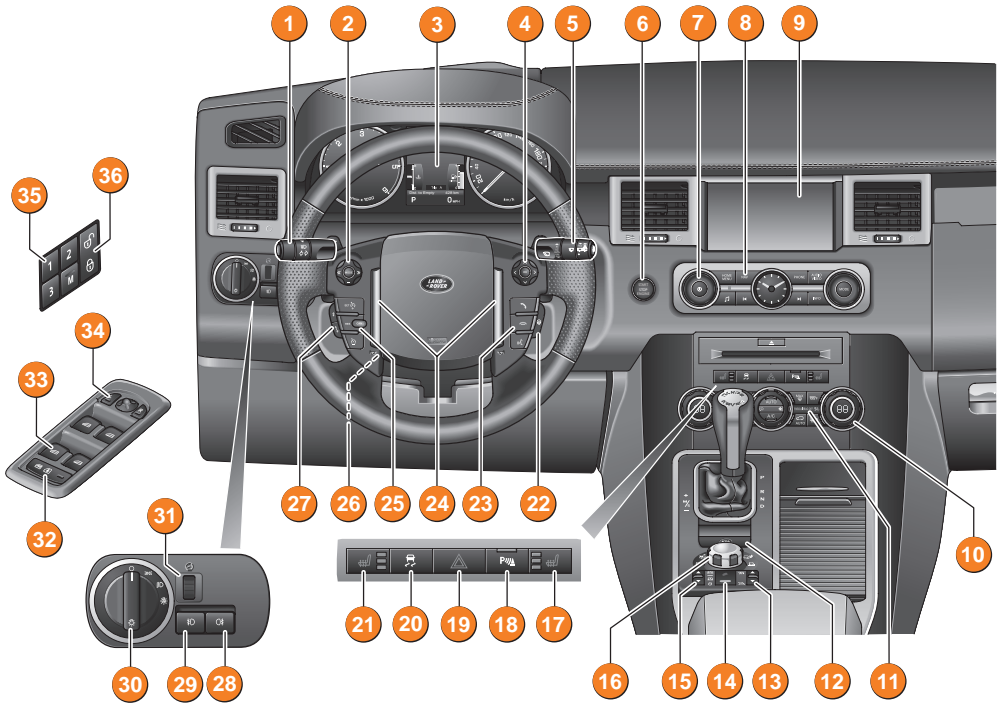

1. Headlamps, direction indicators and trip computer
2. Audio controls
3. Instrument panel, warning indicators and message center
4. Settings menu control
5. Wipers and washers
6. Starter
7. Audio system
8. Navigation system
9. Touch screen
10. Climate control
11. Passenger air bag status indicator
12. Electric parking brake
13. Transfer gearbox control
14. Hill Descent Control
15. Air suspension control
16. Terrain Response control
17. Heated seat - right side
18. Parking aids switch
19. Hazard warning switch
20. Dynamic Stability Control
21. Heated seat - left side
22. Heated steering wheel switch
23. Telephone and voice recognition controls
24. Horns
25. Cruise control switches
26. Electric steering column adjuster
27. Adaptive cruise control distance setting
28. Rear fog lamps
29. Front fog lamps
30. Exterior lamps master switch
31. Instrument illumination
32. Rear window isolation switch
33. Window controls
34. Mirror controls
35. Memory seat controls
36. Master locking switches

RANGE ROVER SPORT

Seat adjustment

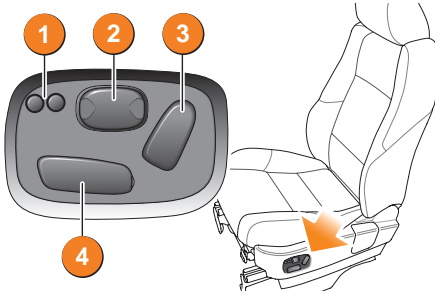

Power seats

1. Bolster inflate/deflate
2. Lumbar support
3. Seat back angle
4. Seat forwards and back, cushion height and cushion angle

Electric steering column adjustment *See page 3, item 6.*

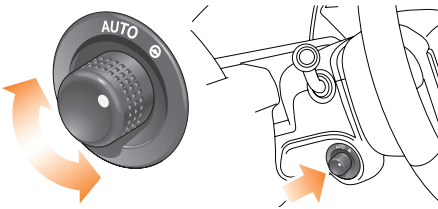

The steering wheel position can be adjusted in four directions, corresponding with the movement of the adjustment control.

With the vehicle stationary, rotate the control clockwise then adjust the steering column to your ideal driving position.

Return the control to the **AUTO** position.

Driving position memory *See page 3, item 35.*

Positions for driver's seat, steering column and exterior mirrors, can be stored in vehicle memory for future use.

1. Press the **M** button to activate the memory store function. The button will illuminate to indicate that the memory store function is active.
2. Within 5 seconds, press buttons **1**, **2** or **3** to store the current driving position to the chosen number. An existing setting on that button will be over written.
3. A stored memory position can now be recalled with a press of the appropriate button; **1**, **2** or **3**. The seat, steering wheel and mirrors will move to their pre set positions.

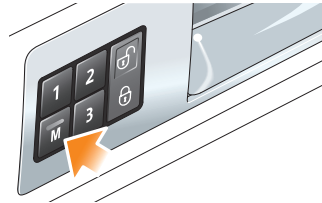

Operating note

Buttons **1**, **2** or **3** must be pressed within five seconds after pressing the **M** button otherwise the memory store function will cancel.

Electric windows *See page 3, item 33.*

Firmly press or lift the respective window switch and release it. Movement can be stopped by briefly operating the switch again.

When the rear window isolator switch is pressed an indicator lamp illuminates in the switch.

Resonance with lowered windows

If a resonance/booming sound occurs when a rear window is open, lowering an adjacent front window about 1 inch (25 mm) will eliminate the condition.

Comfort adjustments

Door mirrors *See page 3, item 34.*

Adjusting the position

1. Press the **L** or **R** button to select the relevant mirror.
2. Use the mirror adjuster to set the mirror position.

Powerfold door mirrors

Press the **L** and **R** buttons simultaneously to fold the mirrors back. Press again to return the mirrors to the opened position.

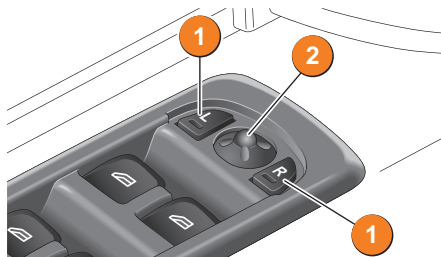

Seat belts and child restraints



A warning indicator on the instrument panel will illuminate if a front seat belt is unbuckled. This may be accompanied by an intermittent chime.

Child seats

It is the weight of a child, rather than age, that determines the type of seat required.

Refer to **Child safety** in the Owner's Handbook to determine the correct seat for your child.

Passenger air bag deactivation



The front passenger seat occupancy sensor determines the state of seat occupancy and sets the air bag status to suit.

- Seat unoccupied - air bag deactivated and indicator off.
- Seat occupied - air bag activated and indicator off.
- Low weight occupant or object - air bag deactivated and indicator on.

For further information, refer to Occupant detection in the Owner's Handbook.

Operating note

If the indicator is permanently ON when the seat is definitely empty, consult your Dealer immediately.

Clock setting

From the **Home** screen, select **System Settings**. Touch the **Clock** icon to access the **Set Clock** screen.

Use the scroll controls to set the time then press **OK**.

All clocks are synchronised.

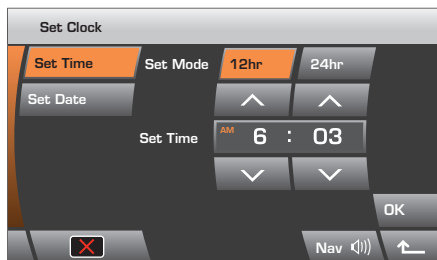

Climate control *See page 3, item 10.*

AUTO is the recommended operating mode. This will help prevent fogging.



AUTO (automatic) mode

Press for automatic operation of the climate control system.

The system will adjust the air conditioning, blower speed, air intake and airflow distribution to maintain the selected temperature(s).



Temperature control

Rotate the controls to set the required temperature.

Operating note

The automatic system allows a temperature differential of up to 4°C between left and right passenger areas.



Blower control

Rotate clockwise to increase and counter clockwise to decrease airflow from the vents.



A/C

For cooled and dehumidified air. Press again to switch air conditioning off.

Air distribution system - auto system

1. Face level
2. Front screen and side window vents
3. Foot level



The automatic system allows more than one setting to be selected at once.



Programmed defrost

Fastest method to remove frost and heavy fogging from the front screen. Press AUTO to switch off.



Recirculation

1. Press once to automatically restrict ingress of traffic fumes.
2. Press twice for manual recirculation control. Extended use causes screen misting.
3. Press again for normal operation.



Heated front screen



Heated rear screen



Front seat heaters

1. Press once for high level heat.
2. Twice for medium heat.
3. Three times for low level heat.
4. Press again to turn off.

External water deposits

The air conditioning system removes moisture from the air and deposits the excess water beneath the vehicle. Puddles may form but this is normal and no cause for concern.

Engine start and stop *See page 3, item 6.*

The **START STOP** button is operational only when the Smart Key is inside the vehicle.

Ignition only on

1. Press once to switch on the ignition.
2. Press again to switch off.

Engine start

1. The selector lever must be in **P** or **N** position.
 2. Depress the footbrake then press and release the **START STOP** button.
- To stop the engine, press the button again.

Operating note

The **START STOP** button must be pressed to stop the engine. If not, it will continue to run even if the Smart Key is removed from the vehicle.

Instrument panel *See page 3, items 3 and 4.*

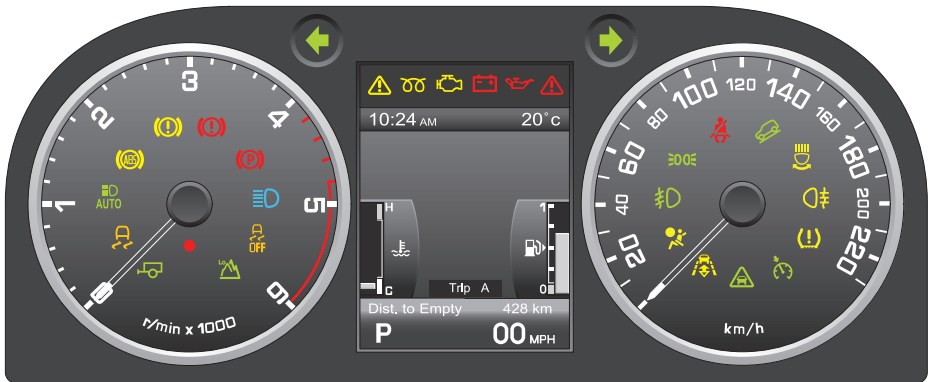

Driver information is displayed on the message center panel and on the inner sections of the instruments.

When the ignition is turned on, the instrument panel will progress through the initial start up display. Information symbols will illuminate while system checks are made.





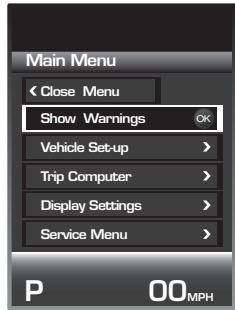







To access the main menu in the instrument panel

1. Press the **OK** button on the steering wheel control.
2. Use the direction controls to move through the menu and subsequent options.
3. Press **OK** to confirm your selections.



Instrument panel warning lamps

The following lamps may illuminate during normal driving to indicate that a related system or feature is operating. If any other warning lamp illuminates, refer to the Owner's Handbook. DO NOT ignore warning lamps.

	Seat belt reminder		HDC active		Front fog lamps on
	EPB on - USA		Low gear range selected		Rear fog lamps on
	EPB on - Canada		Cruise control active		Side lamps on
	DSC switched off		Trailer attached		Headlamp high beam on

Exterior lamps *See page 3, item 30.*

1. Exterior lamps off.
2. Side lamps.
3. Headlamps.
4. Automatic headlamps with high beam assist. A sensor monitors the exterior light levels and will switch side lamps and low beam headlamps ON and OFF as required. A related sensor also controls the high beam assist when it is enabled. The high beam/low beam control must be in the low beam position and road speed above 25 mph (40 km/h).
5. Front fog lamps.
6. Rear fog lamps.

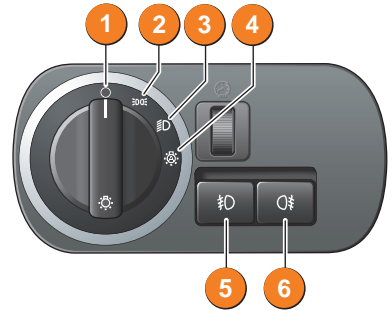

Wipers and washers *See page 3, item 1.*

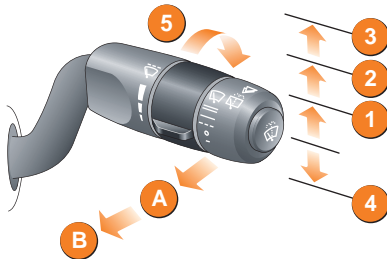

1. Intermittent wipe or rain sensor operation.
2. Normal speed wipe.
3. Fast speed wipe.
4. Single wipe.
5. Rotate collar to adjust speed of the intermittent wipe or sensitivity of the rain sensor.

Care point

Before entering an automatic car wash, turn the wipers off to deactivate the rain sensor. Otherwise the wipers will operate during the car wash program and may be damaged.

Front screen washer and wiper

Press and release the end button to operate the front screen washer. Press and hold to operate both washer and wipers.

Rear wiper and washer

- A. Pull the lever to the first position for intermittent wipe.
- B. Pull and hold the lever in position to operate both wiper and washer.

Headlamps and turn signals *See page 3, item 5.*

Headlamp high beam

Push the lever forwards to select headlamp high beam.

Headlamp flash

Pull the lever towards the steering wheel and release.

Turn signals flash

Move the lever up or down against spring pressure and release to flash the turn signals three times. Useful when lane changing.

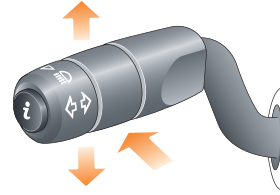

Electric parking brake *See page 3, item 12.*

Applying

With the vehicle stationary, pull up the parking brake lever and then release it. The red warning indicator in the instrument panel will illuminate.

- The parking brake will apply automatically if the ignition is turned off and the vehicle speed is below 2mph (3 km/h).

Releasing

With the ignition on, apply the foot brake and press down on the parking brake lever.

If the vehicle is stationary and either **Drive** or **Reverse** is selected, pressing the accelerator will automatically release the parking brake.

Parking aids

With the ignition on, the parking aids are activated whenever reverse gear is selected. A short confirmation tone will sound after one second. If an obstruction is detected by the sensors, an intermittent tone will sound. As the vehicle moves closer to the obstruction the intermittent tone increases in frequency.

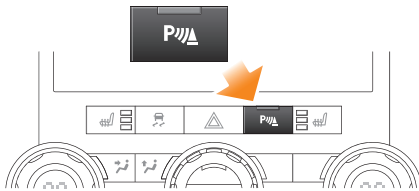

Manual control

Press the facia switch to activate the front parking aid. The switch will illuminate and a short confirmation tone will sound.

Rear view camera

The camera provides a rear view image with overlaid guidelines to assist when vehicle reversing.

Surround view camera system

The system consists of five cameras strategically located to aid vehicle positioning when maneuvering at speeds below 11 mph (18 km/h). Any two views can be selected simultaneously.

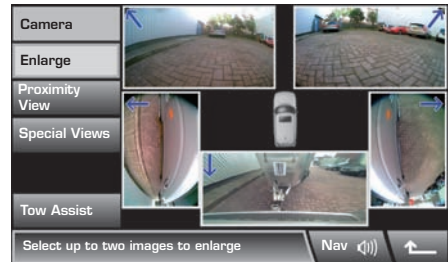

Tow assist

Designed to aid reversing while a trailer is attached. It becomes active when a trailer electrical connector is attached to the vehicle socket.

A tracking target sticker **MUST** be attached to the trailer and then trailer details added in the setup area. Refer to the Owner's Handbook for further details.

Transmission

Gearshift interlock

1. With the engine running and the foot brake applied, press in the selector release button. Move the gear selector from Park position.

Automatic gear selection

Select **Drive** for fully automatic gear changes.

Sport mode

This is an automatic gear change mode, however, change points are modified to make full use of engine power.

2. The **M/S** LED will illuminate and the message center will display **SPORT** when the gear selector is moved to the left side.

To return to automatic gear selection, move the gear selector back to the **Drive** position.

CommandShift gear selection

This is an alternative to the fully automatic modes and is effective when rapid acceleration and engine braking are required.

With Sport mode selected, move the selector lever forward or back for manual gear selection. After each gear change the selector returns to the central position. The message center will display the selected gear.

Transfer gearbox



Use **HIGH** range for all normal road driving and also for off-road when driving across dry level terrain.



LOW range should be used in situations where low speed maneuvering is necessary, or in extreme off-road conditions.

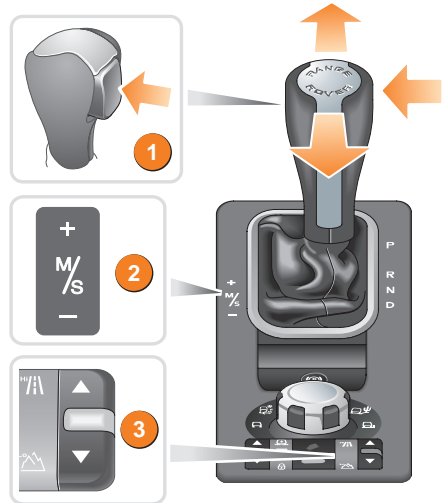

Range changing

The recommended method for range changing is with the vehicle stationary.

3. With the engine running and the main gearbox in Neutral, move the rocker switch to the required position and then release. The switch and instrument indicators will flash during a range change.

When range changing is complete a chime will sound and a message will be displayed on the message center.

Cruise control *See page 3, items 25 and 27.*

1. Press to activate cruise control and to set a speed or increase the speed in 1 mph (2 km/h) increments.
2. Press to resume previous set speed retained in memory. Set speeds are cleared at ignition off.
3. Press to cancel cruise control.
4. Press to decrease the speed in 1 mph (2 km/h) increments.

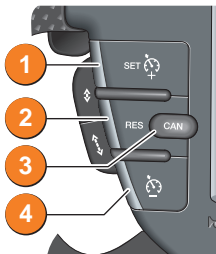

vehicle ahead. If the vehicle ahead is travelling slower than your set cruise control speed, your vehicle will slow down and automatically maintain your set gap until the road ahead clears. At that point your vehicle will accelerate to the set cruise speed.

See the Owner's Handbook for full details.

Adaptive cruise control (ACC)

This enhancement includes a front mounted radar that monitors traffic ahead. When ACC is operating, the system can be programed to maintain a set gap to the

Cruise control override

Cruise control will disengage if the brake pedal is pressed or when vehicle speed falls below 18 mph (30 km/h).

Suspension height See page 3, item 15.

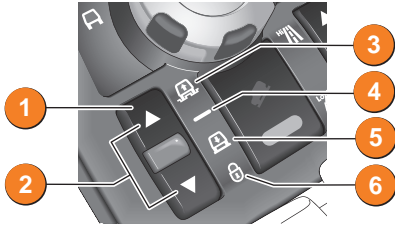

1. Raise/lower rocker switch. A height rise can be made only when the engine is running and all doors are closed.
2. Will illuminate while a height change is in progress.
3. Off-road height. Provides increased ground clearance.
4. On-road height. Normal ride height.
5. Access height. Lowers the vehicle to provide easier entry, exit and loading of the vehicle. This position may be selected up to 40 seconds after the starter switch is turned off. Can also be selected when slowing to a halt.

When speed slows to 12 mph (20 km/h) the vehicle will begin to lower. Indicator lamps will extinguish when access height is reached.

6. Crawl (locked at Access height). Allows the vehicle to be driven at low speeds at access height, to give increased roof clearance.

Vehicle height will automatically adjust according to road speed to maintain optimum driveability and handling.

Some Terrain Response programs will adjust suspension height automatically.

Terrain response See page 3, item 16.



Terrain Response is always active and cannot be switched off. When the vehicle is started the system will normally start in its General program.

Rotate the control to select a program. This will adjust vehicle systems, including drive and suspension, to enhance driveability and traction on specific surface conditions and terrains.

We recommend that a special program be engaged whenever driving conditions are difficult and cancelled once those conditions are no longer present.



General - Use for typical road surfaces.



Grass-Gravel-Snow - Suitable for surfaces which are firm but have a slippery surface, e.g. grass, snow, loose gravel, pebbles or icy conditions.



Mud-Ruts - Suitable for soft, muddy, uneven or deeply rutted ground. LOW range selection in the Transfer gearbox is recommended.



Sand - Suitable for soft, predominantly dry, yielding sandy ground, e.g. sand dunes and deserts. If the sand is damp or wet, the Mud-Ruts program may be more beneficial.



Rock Crawl - Only selectable when the transfer gearbox is in LOW range. Suitable for crossing wet or dry, solid unyielding ground requiring high levels of wheel displacement, e.g. clusters of boulders or rocky river beds.



Dynamic - This program optimises on-road traction, handling and driveability characteristics for maximum feedback and responsiveness.

Wading

Select the program most suitable for the surface beneath the water.

DO NOT exceed 24 inches (600 mm) water depth. With air suspension set at Off-road height, this is increased to 28 inches (700mm).

Audio system with touch screen

The touch screen requires only light touches. Excess pressure could result in damage.

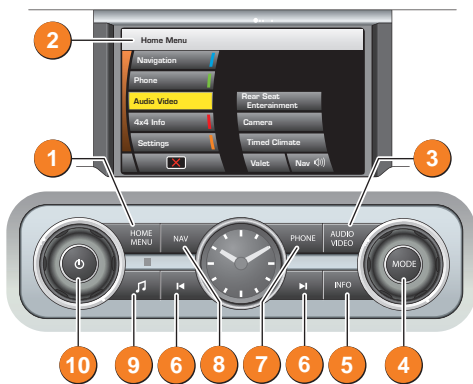

1. Press **HOME MENU** to display menu.
2. Touch screen **Home Menu** display.
3. Press for **AUDIO VIDEO** menu.
4. **MODE**. Press then rotate to select the required media.
5. Briefly press **INFO** to set Traffic information on or off. Press and hold to set News Information.
6. Press the search buttons to scroll through preset radio stations or to skip CD/MP3 tracks.
7. Press for **TELEPHONE** menu.
8. Press for **NAVIGATION** menu.
9. Short press to access sound settings. Long press to access volume offsets.
10. On/off and rotary volume control.

Steering wheel control

1. Press **MODE** repeatedly to scroll through the available audio sources.
2. Press to increase volume.
3. Press and release to scroll forward through preset radio stations or CD/MP3 tracks. For DVD movies and TV it will move up to the next chapter or preset channel. Press and hold for two seconds to search up for the next radio station or to advance through the CD/MP3 track. For DVD movies it will fast forward the movie.
4. Press to decrease volume.
5. Has the same action as 3 but moves in the opposite direction.

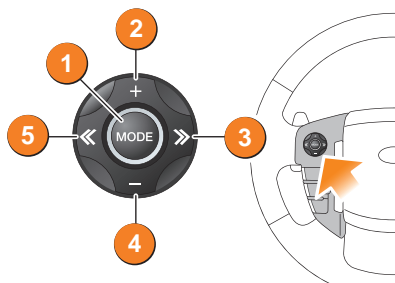

Radio operation



5. Use the autostore button **FMA** or **AMA** to find stations with the strongest signals or use the search buttons to find particular stations.
6. Press the **Settings** button to access the sound settings screen.

Storing radio stations

Autostore will automatically store the 9 strongest signals. Repeat this process for all wavebands.

To manually store a radio station, first tune to the required station. Decide which of the pre-set buttons the station is to be stored on and press that button for two seconds. The audio will mute and the selected button will display either the channel name or its frequency. The selected station will resume play.

1. Turn on the audio system.
2. Press the **AUDIO VIDEO** button to display the menu or if the **Home** menu is active, touch the **Audio Video** screen button.
3. Touch the **Radio** screen button.
4. To change between AM, FM and LW, touch the **Band** screen button.

Audio system with touch screen

Satellite radio

Satellite radio is a subscription service. To activate and use the satellite radio, call the satellite radio service provider (Sirius) and provide them with the Electronic Serial number (ESN) of your audio unit.

The telephone number for Sirius will be displayed when viewing the ESN.

To view the ESN:

1. Repeatedly touch the **Radio-SAT** icon to select the **SAT** mode.
2. Touch the following icon to display the ESN 

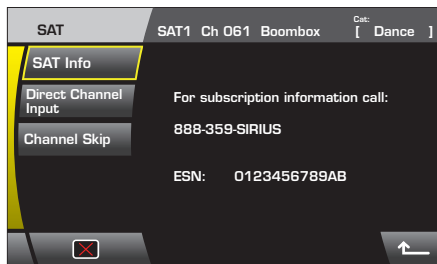

Sirius activation

The authorisation and activation process can take up to 35 minutes. Do not use a paired cell phone to make this call.

CD operation

Playing CD/MP3 discs

Select CD from the **Audio Video** menu. If a CD is loaded, playback will resume from the point of last play. If no CD is present, **No disc** will be displayed. Playback can be paused by touching the  softkey. Touch again to resume playback.

Press either of the pre set buttons to move to the next or previous tracks.

Information about the current CD is displayed at the top of the screen.

Touch the **Settings** softkey for Random, Repeat and CD scan options.

When an MP3 disc is selected, the folder information is displayed in an additional information window. To scroll through a folder, touch the movement icons either side of the window.



Incompatible disc types

The use of discs with paper labels or dual format discs (Dual Discs or DVD Plus) should be avoided as they could become jammed inside the player.

Touch screen navigation

The screen requires only a light touch to operate the function. Excess pressure could result in damage. On initial activation, ensure that both the correct country and area have been selected. For more information refer to the Owner's Handbook.

Setting a destination

1. From the navigation **Menu** screen, select **Destination Entry**.

2. Touch **Address**.

3. Now touch **Town** then use the on-screen keypad to enter address details. As each part of the address is displayed, select from the list to confirm.

4. When entry is complete, touch **OK**.

5. Touch **Destination** to begin calculation of the route options.

6. The screen displays **Route 1**.

To view alternative routes touch **3 Route**. To use an alternative route, touch one of the selections.

7. Touch **Start** to commence guidance.

The selected route will be displayed and guidance will begin. When your destination is reached, voice and visual confirmation is given.

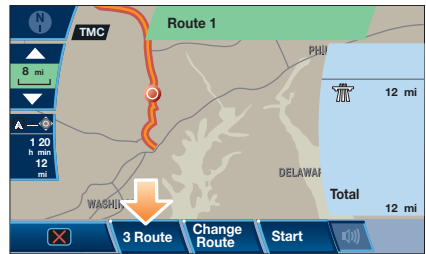
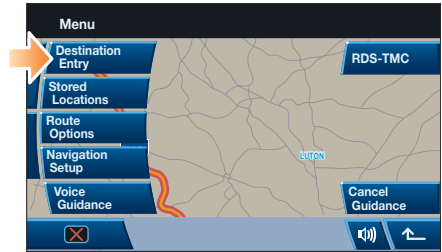

If the map is moved away from your current location, the position icon will be replaced by a touch button in the top left of the screen. Touch to bring the current location map back into view.



Touch this icon to repeat the last voice instruction. To deselect voice guidance go to the navigation **Menu** screen then select **Auto Voice Guidance Off**.

Cancelling guidance

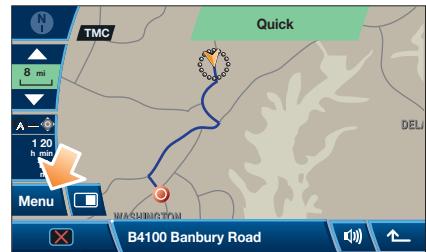

To cancel guidance, touch **Menu** then **Cancel Guidance**.

Bluetooth® phones

Compatible Bluetooth cell phones can communicate with the vehicle's inbuilt telephone system. Connection must be made with ignition on or engine running.

Operating note

'Docking' and 'docked' are terms used in relation to a paired cell phone that is fully linked to the vehicle system and can be used for calls. The cell phone is not physically docked in a cradle.

Bluetooth selection

When the starter is turned on, the vehicle searches for up to 5 previously paired cell phones, starting with the most recent pairing. Before attempting a new pairing, wait for 30 seconds for this process to complete.

Use the following procedure in conjunction with your Bluetooth cell phone manufacturer's instructions.

Pairing a cell phone to the vehicle

With the ignition on, touch-screen active and no phone currently docked:

1. Start the Bluetooth search function on your cell phone.
2. The phone will list any Bluetooth devices found. Select **Land Rover** from the list.
3. Now enter the Bluetooth PIN **2121** into the cell phone.

The phone will pair and dock to the vehicle system.

Cell phone auto connect

The phone may request '**set authorisation**' or '**always allow**'. If this is set the phone will subsequently connect automatically.

Downloading phonebook entries

When a cell phone with phonebook download capability is paired and docked, its phonebook directory will automatically download to the vehicle system.

The vehicle phonebook will be updated each time a cell phone is docked to the system.

Bluetooth phone compatibility

For the latest list of compatible phones and their software, refer to <http://www.landover.com/us/en/owners/about/bluetooth.htm>

Calls via the touch-screen

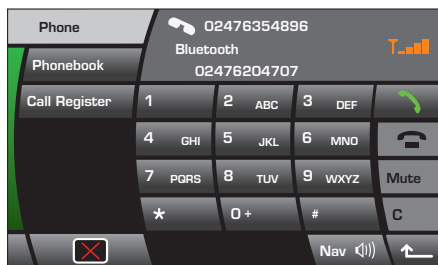

1. With a paired and active phone press the **PHONE** button on the screen surround.

2. Enter the number using the on-screen keypad.



3. Touch the icon on the screen to make the call.



4. Touch the icon to end a call.

Calls via the steering wheel controls

1. Press briefly to answer an incoming call or to redial the last number.

2. Press to end a call or to reject an incoming call.

Calls using voice control

3. Press to initiate voice control. Say 'Display show phone'. The Phone home page is displayed on the touch-screen.

Use the screen features as described above.



Continuing a call with ignition off

1. If you need to turn off the ignition during a telephone conversation, there are two choices of how to continue the telephone call.

2. If you want to continue using the vehicle phone system, ensure that the audio system is **ON** before turning off the ignition. The vehicle system will be available while the current call is active. At call end, the vehicle system will shut down.

3. To continue a call on the paired cell phone, ensure that the audio system is turned **OFF** before turning the ignition off.

Telephone echo

If echo is experienced when using the phone, reduce the audio system volume during the call.

Gas filling

Gas cap flap

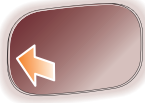

The gas cap flap is located on the left side of the vehicle. If the vehicle is locked with the Smart Key, the fuel filler flap can not be opened. Press and release the flap at the rear edge to open

Operating note

The gas flap has a spring loaded self release mechanism. Do not pull it open.

Operating the gas cap

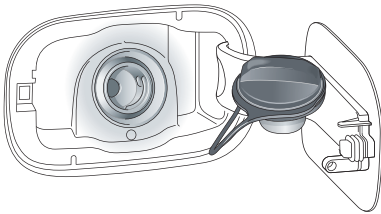

Twist the cap counter-clockwise to undo.

A hook is provided on the flap hinge to hold the cap while refuelling. After refuelling, tighten the cap until it clicks three times.

Fuel specification

The correct fuel specification for your vehicle is shown on the inside of the gas filler flap.

Incorrect fuelling

- DO NOT use E85 fuels (85% Ethanol content). Equipment necessary for the use of fuels containing more than 10% Ethanol is not fitted to this vehicle. If E85 fuels are used serious engine and fuel system damage will occur.

Filling with the wrong fuel

If the vehicle is filled with the wrong type of fuel:

- DO NOT start the engine!
- Call for qualified assistance!

Tire pressure label

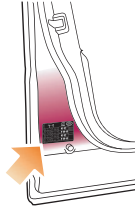

Tire pressures are shown on a label attached to the pillar behind the driver's door or to the rear of the driver's door.

Hood release

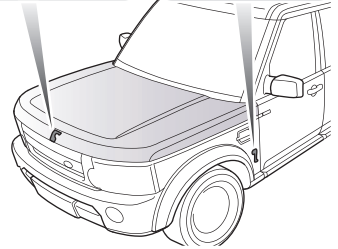
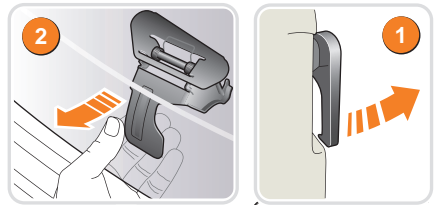

1. Pull the lever to release the hood lock.
2. Lift the hood lever and raise the hood.