

Keys & Handsets

KEYS AND HANDSETS

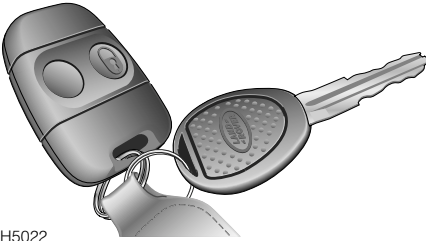

H5022

You have been supplied with a pair of identical keys and two remote control handsets.

WARNING

Keep the spare set in a safe place - NOT IN THE VEHICLE!

Your keys

The keys supplied with your vehicle are programmed to the vehicle's security system - they **CANNOT** be reprogrammed and the engine cannot be started without a valid programmed key. If a key is lost or broken, a replacement can be ordered only from a Land Rover Dealer/Authorised Repairer.

NOTE: *Land Rover Dealers/Authorised Repairers do not stock spare keys, time has to be allowed for replacements to be programmed to your security system and then delivered to the dealer.*

If you lose a key, contact your Land Rover Dealer/Authorised Repairer; a key reported lost will be deactivated. If the key is later recovered, your Land Rover Dealer/Authorised Repairer can have it reactivated.

Fascia Controls

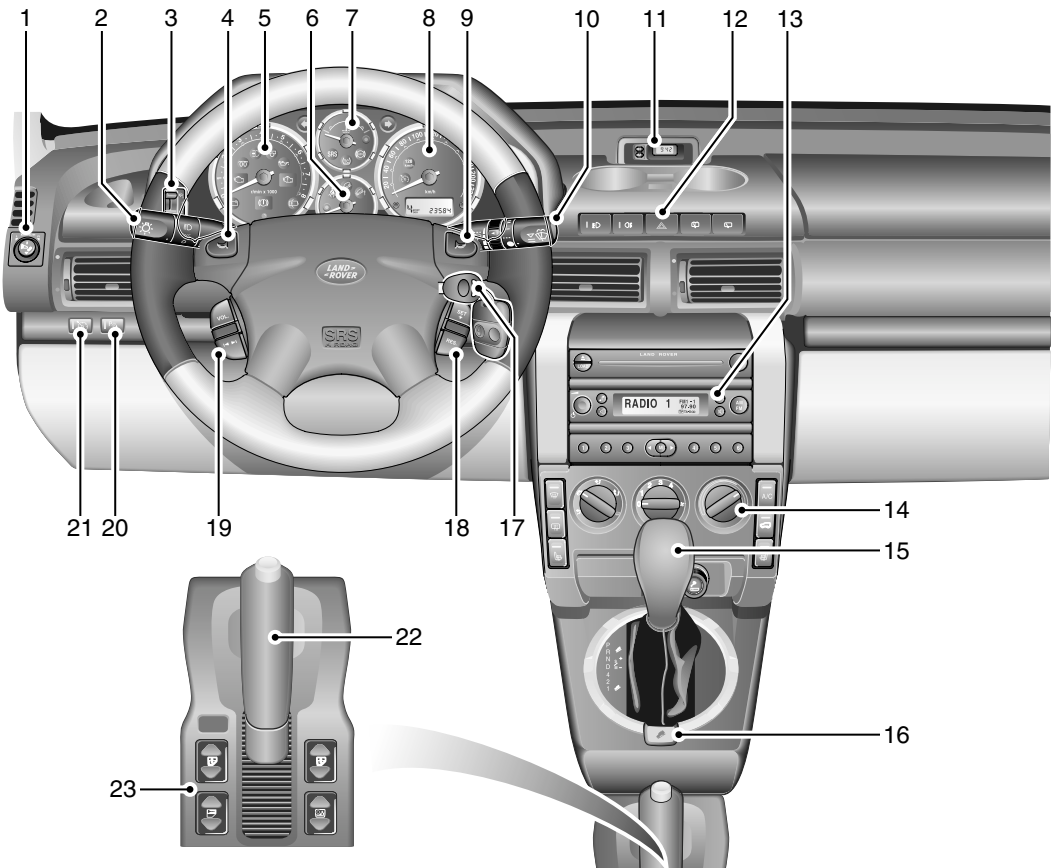

Fascia Controls

1. Exterior mirror control
2. Lighting and direction indicator controls
3. Headlight levelling control
4. Horn
5. Tachometer
6. Fuel gauge
7. Coolant temperature gauge
8. Speedometer
9. Horn
10. Windscreen wiper/washer controls
11. Clock display
12. Hazard warning switch
13. Audio system
14. Heater/Air conditioning controls
15. Gear lever
16. Hill descent control
17. Starter switch
18. Remote cruise control* switches
19. Remote audio controls*
20. Parking aid system switch
21. Cruise control master switch*
22. Handbrake
23. Centre console switches (3 Door shown)

NOTE: *The precise specification and location of the controls may vary according to territorial requirements and from model to model within the vehicle range.*

Locks & Alarm

STEERING COLUMN LOCK

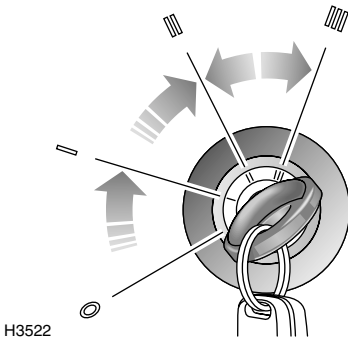

To unlock the steering column

Insert the key FULLY and turn the starter switch to position 'I'. A small movement of the steering wheel may be necessary to disengage the steering lock while turning the switch.

To lock the steering column

Turn the key to position '0' and withdraw it from the starter switch. Turn the steering wheel slightly until the lock engages.

WARNING

Once the steering lock has engaged, it is impossible to steer the vehicle. DO NOT remove the key or turn the starter switch to position '0' while the vehicle is in motion.

ALARM SYSTEM

Your vehicle is fitted with a sophisticated electronic anti-theft alarm and engine immobilisation system. In order to ensure maximum security and minimum inconvenience, you are strongly advised to gain a full understanding of the alarm system, by thoroughly reading this section of the handbook.

LOCKING THE VEHICLE AND ARMING THE ALARM

Before locking the vehicle and arming the alarm, ensure that all doors (including taildoor), windows, sunroof and bonnet apertures are securely closed.

There are three methods for securing your vehicle:

- 'Superlocking' using the handset - (recommended high security method).
- 'Superlocking' using the key.
- Locking using the key.

IMPORTANT

- If passengers or animals are to be left inside, DO NOT lock the vehicle using the handset - movement inside the vehicle may activate interior space protection*, causing the alarm to sound.
- FOR MAXIMUM SECURITY ALWAYS SUPERLOCK THE VEHICLE USING THE REMOTE HANDSET

Locks & Alarm

Using the remote handset

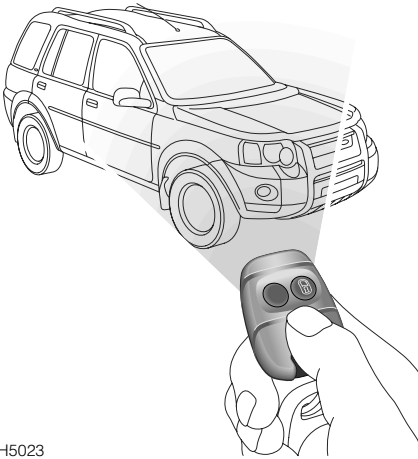

H5023

While it is not necessary to point the handset at the vehicle, the handset must be within range of the vehicle when a button is pressed. Note that the operating range may vary depending upon handset battery condition and may sometimes be limited by physical and geographical factors beyond your control. From a security point of view, it may not be wise to unlock unless you are in close proximity to the vehicle.

Locking

With the remote handset:

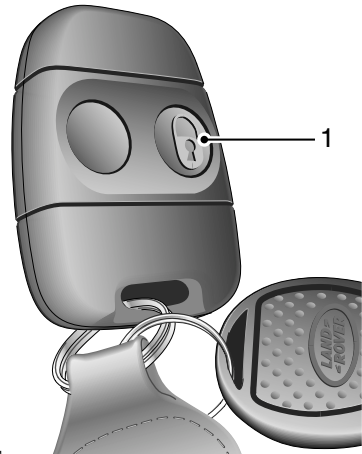

H5024

Press the lock (padlock symbol (1)) button once. Each time the vehicle is locked using the handset, a coded signal is transmitted to a receiver inside the vehicle, which activates the following security features:

- the central door locking system (all the door locks are activated).
- 'Superlocking' - the door locks cannot be operated from inside the vehicle.
- the perimeter alarm (protects the door, taildoor, and bonnet apertures).
- interior space protection*.

If the doors lock correctly, the direction indicator lights flash three times to confirm that the vehicle is secure and the anti-theft alarm indicator light (in the instrument panel) will start to flash rapidly.

Locks & Alarm

Once armed, the alarm will sound if any door is opened, or if the soft-back is raised or hard-back removed or if (after a checking period of 15 seconds) any movement is detected inside the passenger compartment (see '*Interior space protection**', page 31).

With the key:

Insert the key and turn towards the rear of the vehicle. Turning the key ONCE activates the following:

- all doors locked (not superlocked)
- perimeter alarm activated (protects the doors, bonnet and taildoor)

NOTE: *Interior space protection** is not activated!

Turning the key TWICE within 1 second activates, in addition to the above:

- Superlocking

If the doors lock correctly, the direction indicators flash three times to confirm that the vehicle is secure and the anti-theft alarm indicator light (in the instrument panel) will start to flash rapidly.

NOTE: *The engine will automatically be immobilised after the starter switch has been turned off.*

Superlocking

Provided all the doors are fully closed, the Superlocking feature is activated automatically whenever the vehicle is locked using the remote handset. Superlocking immobilises the interior door handles, thereby preventing an intruder from gaining entry by smashing a window and reaching inside the vehicle to operate the door handles.

WARNING

For safety, NEVER use Superlocking if passengers are to remain inside the vehicle - in an emergency they would not be able to escape.

Mislock

If one of the doors, taildoor or bonnet are not properly closed when the alarm is armed, a mislock occurs (the horn will sound a warning). The alarm will still be armed and the engine immobilised, but the open aperture will not be protected and, unless it is the bonnet that has been left open, interior space protection* will not have been activated. If the appropriate aperture is then closed, the alarm will fully arm without the need to press the lock button again unless the driver's door is open, in which case the alarm will be fully armed by pressing the lock button again.

If the taildoor glass is left open when the alarm is armed, the horn will sound as a reminder, but the vehicle will be locked and alarmed as normal. The taildoor glass can be closed from outside the vehicle using the starter key in the taildoor (see '*Raising and lowering*', page 71).

Locks & Alarm

Anti-theft alarm indicator light

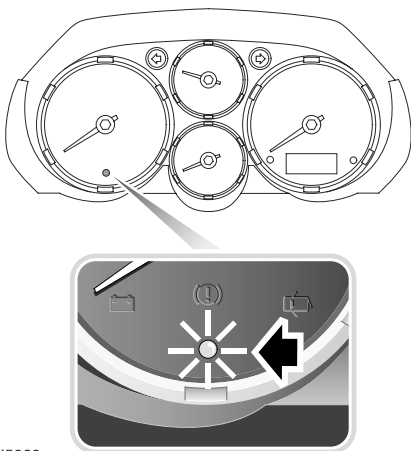

H5026

After locking, the RED indicator light on the instrument panel flashes rapidly while the alarm is arming itself.

After approximately 10 seconds, the indicator light adjusts to a slower frequency, and continues to flash as an anti-theft deterrent until the alarm is disarmed.

Unlocking

With the remote handset:

If your vehicle has been configured with the Single Point Entry security feature, and was locked with the handset, the handset unlocks the vehicle in two stages:

- Press the unlock (no padlock) button once to disarm the alarm and unlock the driver's door only (see 'Single point entry', page 29).
- Press the unlock button twice to disarm the alarm and unlock ALL the doors.

If your vehicle has not been configured with Single Point Entry, all the doors will unlock at the first press. In either case, the direction indicators flash once and the interior lights illuminate.

With the key:

Turn the key towards the front of the vehicle. The alarm will be fully disarmed. To remobilise the engine, the key must be inserted into the starter switch.

If the alarm sounds

If the alarm is triggered, it will sound for approximately 30 seconds before switching itself off and can be triggered up to ten times in total before needing to be reset.

To silence the alarm, press either handset button, or operate the door locks using the key in the driver's door.

Single point entry

This is a personal security feature, which enables the driver's door only to be unlocked, leaving the other doors in a locked state. It can be operated by the remote handset as follows:

Press the unlock button once to unlock the driver's door, press a second time to unlock the remaining doors and taildoor.



Single point entry can be disabled by a Land Rover Dealer/Authorised Repairer.

Locks & Alarm

Interior locking switch - 5 door vehicles

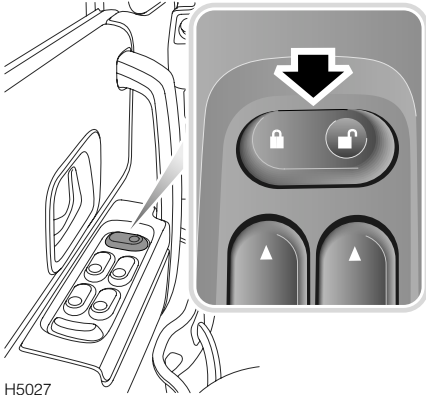

H5027

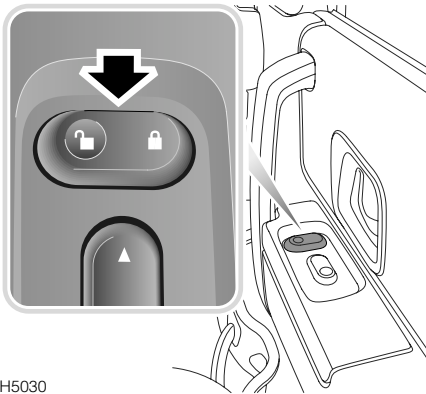

H5030

This is a personal security feature which allows the driver (or passenger) to lock (or unlock) all the doors from inside the vehicle (while driving or with the vehicle stationary). Press the padlock symbol part of the switch to lock (the alarm will not be armed), and the unlocked padlock symbol to unlock.

NOTE: If interior locking has been activated, pull the interior door handle once to unlock, and twice to open the door.

Interior locking switch - 3 door vehicles

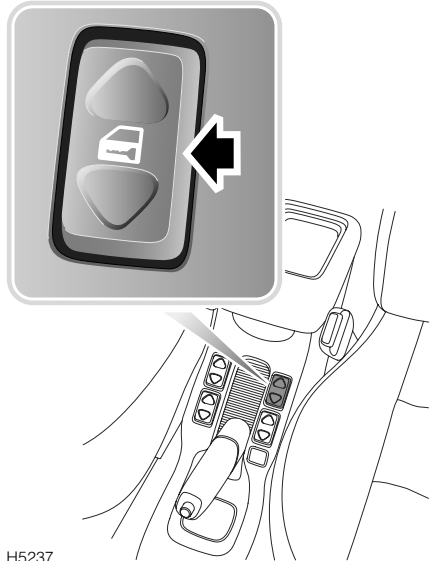

H5237

This is a personal security feature which allows the driver (or passenger) to lock (or unlock) all the doors from inside the vehicle (while driving or with the vehicle stationary). Press the lower part of the switch to lock (the alarm will not be armed), and the upper part to unlock.

NOTE: If interior locking has been activated, pull the interior door handle once to unlock, and twice to open the door.

Locks & Alarm

Door handles and door sill locking buttons

From inside the vehicle, each door can be individually locked by depressing (arrowed in illustration) the appropriate door sill button. However, doors cannot be unlocked by raising the sill button.

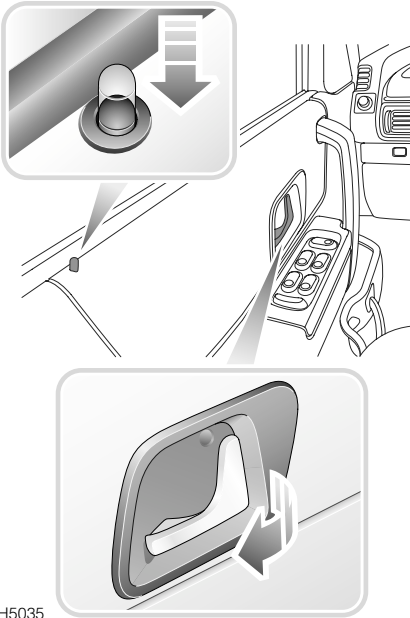

H5035

Use the door handles to unlock, as follows:

- First operation of the door handle unlocks the door.
- Second operation of the door handle opens the door.

NOTE: The door handles will not open the doors if the vehicle has been superlocked (see 'Superlocking', page 28)

Interior space protection*

Interior space protection is designed to protect the interior of the vehicle from intrusion (entry by a thief through a smashed window, for example). A sensor inside the vehicle monitors the interior space and activates the alarm if movement is detected in the passenger compartment.

Using the handset:

Interior space protection is activated automatically whenever the remote handset is used to set the alarm.

Key operation:

Using the key to lock the vehicle will NOT activate interior space protection.

WARNING

Never activate interior space protection if passengers or animals are to be left inside the vehicle - any movement will activate the alarm.

Locks & Alarm

CHILD-PROOF LOCKS

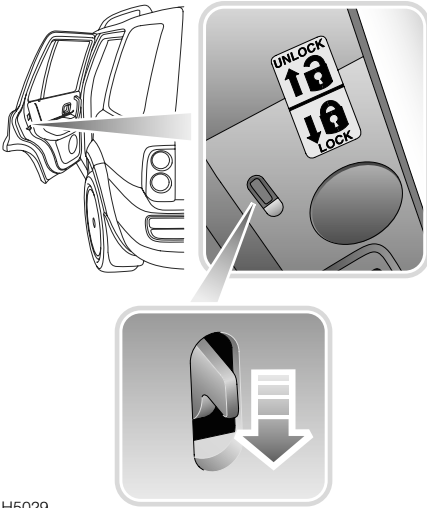

H5029

On 5-door models, move the lever on the rear doors down (arrowed in illustration) to engage.

With the child-proof locks engaged, the rear doors cannot be opened from inside the vehicle, thereby avoiding the risk of a door being opened accidentally.

WARNING

NEVER leave children unsupervised in the vehicle.

ENGINE IMMOBILISATION

Engine immobilisation is an important aspect of the security system and is designed to safeguard the vehicle from theft. Engine immobilisation prevents the engine from being started unless a valid key is inserted into the starter switch and occurs automatically.

The engine is re-mobilised by a signal to the starter switch transmitted from a transponder contained within the key head. This occurs automatically whenever a valid key is inserted into the starter switch and turned to position 'I'.

WARNING

DO NOT keep more than one starter key or keys from other vehicles on the same key ring, because the engine may not re-mobilise automatically.

Locks & Alarm

DOOR LOCKING CUT-OFF SWITCH

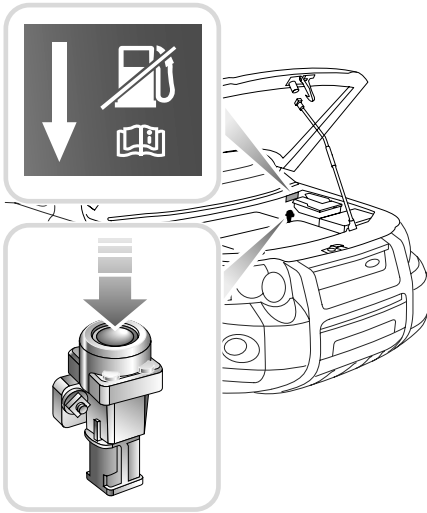

H5033

In the event of an accident or sudden impact, an inertia switch operates when the starter switch is in position 'II', preventing the doors from centrally locking (or, if the doors are already locked, unlocks them). If this occurs, central locking will be inhibited until the driver's door has been opened and closed, and the inertia switch is reset.

The inertia switch is located inside the engine compartment on the left hand side, beneath and to the rear of, the engine compartment fuse box. The switch must be reset before the engine can be restarted. Reset the switch by pressing the rubber top (arrowed in illustration).

On petrol models, this will also reset the fuel system, see 'FUEL CUT-OFF SWITCH (Petrol engine vehicles only)', page 106).

WARNING

Always check for fuel leaks before resetting the switch. Activating the switch when the fuel system has been damaged will cause additional fuel leakage, increasing the risk of fire or personal injury.

Locks & Alarm

REMOTE HANDSET

WARNING

The handset contains delicate electronic circuits and must be protected from impact and water damage, high temperatures and humidity, direct sunlight and the effects of solvents, waxes and abrasive cleaners.

The battery should last for approximately three years dependent upon use. When the battery needs replacing, it will be apparent from the following symptoms:

- A gradual deterioration in range and performance.
- The alarm buzzer and the anti-theft alarm indicator light will double bleep/flash every second, for ten seconds, after the alarm is disarmed and driver's door opened.

It is recommended that you fit a Land Rover YWX10003L or a Panasonic CR2032 replacement battery (available from a Land Rover Dealer/Authorised Repairer).

Battery replacement

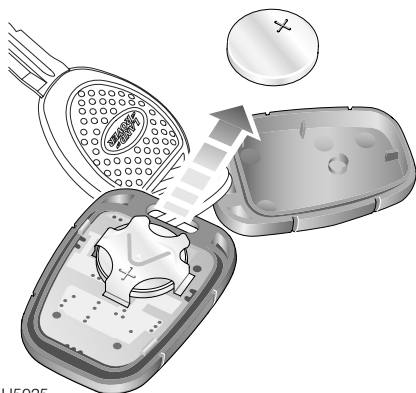

H5025

1. Carefully prise the handset apart, start from the keyring end using a small coin or screwdriver. Avoid damaging the seal between the two halves of the case and DO NOT allow dirt or moisture to get inside the handset.
2. Slide the battery out of its clip, taking care to avoid touching the circuit board or the contact surfaces of the clip.
3. Press and hold each button in turn for at least five seconds (this will drain any residual power from the handset).
4. Fit the new battery, ensuring that correct polarity is maintained ('+' side facing up). Finger marks will adversely affect battery life; if possible, avoid touching the flat surfaces of the battery and wipe them clean before fitting.
5. Press the two halves of the handset firmly together and ensure that both halves are fully joined to prevent dirt or moisture from entering the handset.
6. Resynchronise the handset.

The handset is now ready for use.

Handset resynchronisation

If the handset fails to lock or unlock the car, this may be because the coded signal transmitted by the handset, and the signal expected by the alarm control unit are no longer synchronised.

To resynchronise the handset, operate either button of the handset at least five times in quick succession (in close proximity to the vehicle).

Seats

FRONT SEATS

WARNING

To avoid the risk of loss of control and personal injury, DO NOT adjust the driver's seat or head restraint while the vehicle is in motion.

DO NOT travel with the seat backs reclined steeply rearwards. Optimum benefit is obtained from the seat belt with the seat back reclined to a maximum 30 degrees from the upright (vertical) position.

SITTING CORRECTLY

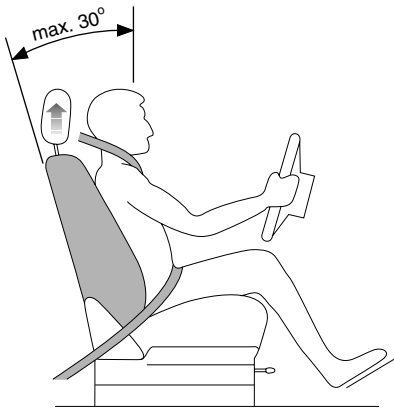

H4767

The seats, head restraints, seat belts and airbags all contribute to the protection of the occupants. Optimal use of these components will give you more protection. Therefore, observe the following points:

- Sit in the most upright position with the base of your spine as far back as possible and the backrest not reclined more than 30 degrees.

- Adjust the head restraints so that the top of the head restraint is level with the upper portion of the head.
- Do not move the front seat too close to the instrument panel. The driver should hold the steering wheel with slightly bent arms. The legs should also be slightly bent so that the pedals can be pressed to the floor.
- The seat belt should rest in the centre of the shoulder. The lap part should fit tightly across the hips and not on the stomach.

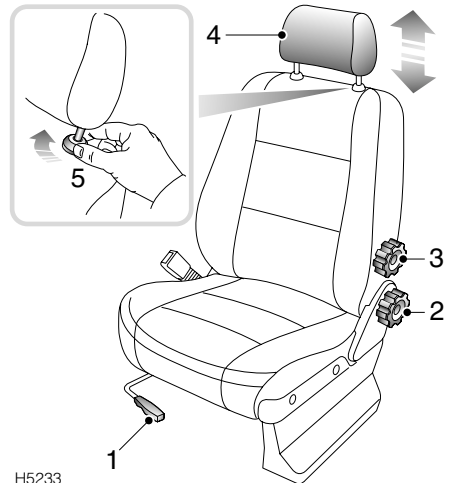

H5233

Forward/backward adjustment

Lift the lever (1) and slide the seat into position. Make sure that the seat is locked in position before driving.

Backrest adjustment

Rotate the handwheel (2) to adjust.

Lumbar support adjustment (Driver's seat only)

Rotate the handwheel (3) to increase or decrease support to the lumbar region of the back.

Seats

Head restraint adjustment

Raise or lower the restraint (4) until the top of the cushion is level with the top of the head.

WARNING

Head restraints are designed to support the back of the head (NOT THE NECK), and to restrain rearward movement of the head in the event of a collision. The restraint must be positioned level with the head to be effective.

Head restraint removal

Turn the right hand mounting (5) a quarter turn anti-clockwise and pull the restraint upwards.

After replacing a head restraint, turn the right-hand mounting clockwise.

WARNING

DO NOT drive with the head restraints removed from occupied seats.

Backrest release lever (3-door models)



H5234

To enable rear seat passengers to enter or exit the vehicle, lift the backrest release lever upwards to fold the front seat backrest forwards.

After the backrest has been returned to its normal, upright position, ensure that it is securely retained by attempting to pull it forward again, but without operating the release lever. There should be no appreciable movement.

The rear seat access lever also acts as a seat belt presenter, improving access to the seat belt (see 'Seat belt presenter (3-door models)', page 42).

WARNING

Ensure that the backrest is secure before driving.

Seats

HEATED FRONT SEATS*

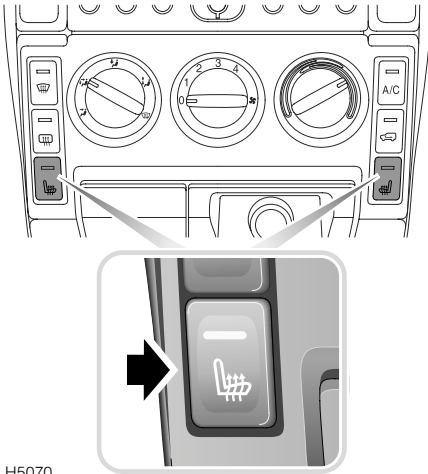

H5070

With the starter switch turned on and the engine running, press the switches to operate the heating elements in either the driver's or front passenger seat (the indicator light in the switch illuminates). Press a second time to switch off.

NOTE: The seat heaters will switch off automatically 45 seconds after the starter switch is turned off, or either front door is opened.

The seat heaters are thermostatically controlled and operate intermittently to achieve and then maintain a predetermined temperature between 26°C and 36°C.

NOTE: Owners should be aware that the seat heaters consume considerable power from the battery and for this reason, it is recommended that they are operated only with the engine running.

Seats

REAR SEATS

Folding the rear seats

On vehicles not fitted with 60/40 split rear seats the whole seat can be folded forwards to increase luggage space. On vehicles fitted with 60/40 split rear seats, either or both parts of the seat can be folded.

NOTE: Before folding the rear seats, ensure that the centre rear seat belt is unbuckled. Also ensure that the front seats are moved forward and the backrest is not reclined. This will avoid damaging the rear of the front seats when a rear seat is folded.

WARNING

Ensure that the rear seat backrests are securely latched in the upright position when the seat is in use and when loads are carried in the luggage area.

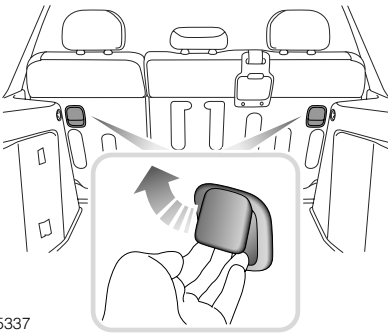

H5337

Lift the release levers (see inset) to release the backrest (lift both levers simultaneously on vehicles without 60/40 split seats) and fold the backrest forwards.

WARNING

DO NOT carry unsecured equipment, tools or luggage that could move, causing personal injury in the event of an accident, or emergency manoeuvre - where possible, use the seat belts to secure luggage carried on the seats.

Accommodating long loads

Remove the head restraints from the front passenger and rear seats (see 'Head restraint removal', page 36), move the front passenger seat forwards as far as possible and fully recline the seat backrest. Finally, fold the rear seat backrest (or the appropriate part of the backrest in the case of 60/40 split seats) fully forward as shown.

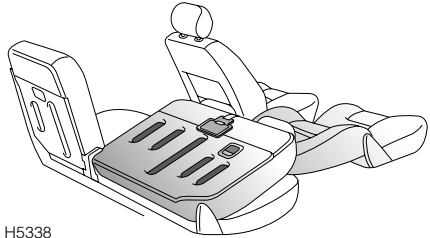

H5338

Loads that are too long to be carried inside the vehicle should be carried on the roof. (See 'ROOF RACK', page 147).

If it is necessary to carry a load that protrudes through the taildoor, or taildoor window, be aware of any territorial restriction restricting the length of any such load. In addition, ensure that loads DO NOT rest on the glass of a partially open window. Damage to the glass or window mechanism may occur.

Seats

WARNING

You are advised NOT to carry loads which require driving with the taildoor or taildoor window open - poisonous fumes will be drawn into the vehicle! If driving the vehicle in this condition is unavoidable, switch the heater to face level vents with all vents open, close the sunroof and windows and turn the air blower to position 4.

Maximum luggage space

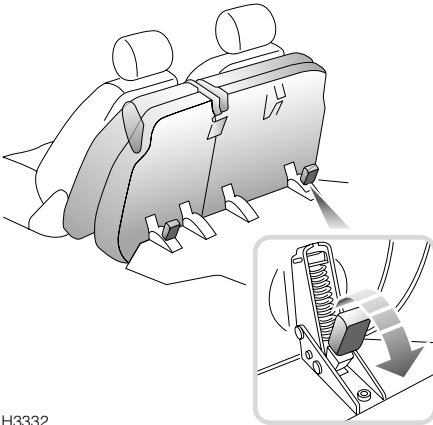

H3332

To create an extra large luggage area:

1. Lift the seat release levers to release the backrest and fold the seat backrest forward.
2. Tip the whole seat assembly forward as shown in illustration and readjust the front seats as required.

To return the seats to their normal position; push the seat base release levers (shown in lower inset) rearwards to unlock the seat base and unfold the seats. Ensure the seat backrests are properly secured by attempting to push them forwards - there should be no movement.

WARNING

It is extremely dangerous to ride in the cargo area. In a collision, anyone riding in this area is more likely to be injured or killed. Do not allow anyone to ride in any area of your vehicle that is not equipped with seats and safety belts. Be sure that everyone in your vehicle is in a seat and using a safety belt properly.

'Latch secure' indicator

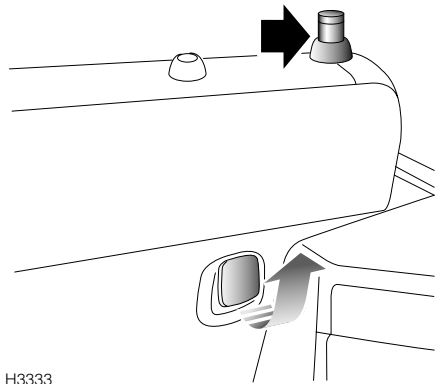

H3333

A 'latch secure' indicator, mounted on the top of the right hand side of the rear seat backrest, will pop up showing a red band, when the catch is released.

When returning the seat to the upright position, ensure the indicator drops back into the backrest and that the red band is no longer visible - this confirms that the larger portion of the backrest is secure.

NOTE: The 'latch secure' indicator does NOT indicate that the smaller portion of the 60/40 split backrest is secure - this must be checked individually.

NOTE: When returning the seats to the upright position, ensure that the seat belts are not trapped!

Seat Belts

SEAT BELT SAFETY

Seat belts fitted to your vehicle are designed for adults and larger children. Each belt should be used by one occupant only.

Observe the following precautions:

- DO make sure ALL passengers are securely strapped in at all times, using the appropriate restraint - even for the shortest journeys.
- ALWAYS adjust seat belts to eliminate any slack in the webbing. DO NOT slacken the webbing by holding the belt away from the body - to be fully effective, the seat belt must remain in full contact with the body at all times.
- ALWAYS fit the lap strap as low on the hips as possible (never across the abdomen), and ensure that the diagonal belt passes across the shoulder without slipping off or pressing on the neck.
- DO NOT wear seat belts over hard, sharp or fragile items in clothing, such as pens, keys, spectacles etc.
- Always replace a seat belt assembly that has withstood the strain of a severe vehicle impact, or if the webbing shows signs of fraying.
- Where possible use the seat belts to secure large items of luggage that are to be carried on the seats - in the event of an accident, unsecured items become flying missiles capable of causing serious injury.
- DO NOT use a seat belt that is twisted or obstructed in any way that could impede its smooth operation.

- DO NOT allow front seat occupants to travel with the seat backs reclined steeply rearwards. Optimum benefit is obtained from the seat belt with the seat back angle reclined to a maximum of 30 degrees from the upright (vertical) position.
- DO NOT allow foreign matter (particularly sugary food and drink) to enter the seat belt locks - such substances can render the locks inoperative.
- In most countries, all occupants are required by law to wear a seat belt, unless they have been issued with a medical exemption certificate.

WARNING

The airbag supplementary restraint system (see 'Airbag SRS') is designed to add to the overall effectiveness of the seat belts. It does not replace them. SEAT BELTS MUST ALWAYS BE WORN!

Ensure that all seat belts are worn correctly - an improperly worn seat belt increases the risk of death or serious injury in the event of a collision.

Seat Belts

PREGNANT WOMEN

WARNING

Pregnant women must wear a correctly positioned seat belt; it is safer for mother and unborn child.

There are many ways that the belt can be misused for the sake of comfort, but there is only one way of wearing it safely.

During pregnancy, women should wear the lap belt across the hips below the baby, with the diagonal belt passing across the shoulder, between the breasts and to one side of the baby - if in doubt, consult a doctor.

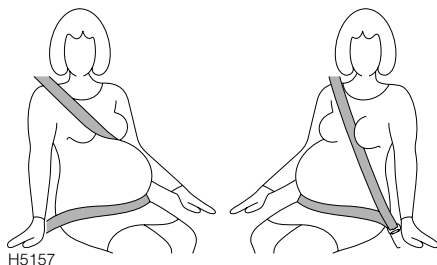

Never place anything between you and the seat belt in an attempt to cushion the impact in the event of an accident. It can be dangerous and reduce the effectiveness of the seat belt in preventing injury.

SEAT BELTS

To minimise injury in the event of an accident, it is important that seat belts are worn correctly. Read the instructions below and the advice contained under the heading 'SEAT BELT SAFETY', page 40.

Fastening the seat belts

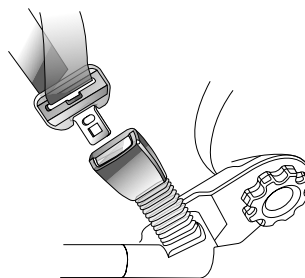

Inertia reel belts are fitted to all front and rear seating positions.

Pull the belt over the shoulder and across the chest and, ensuring that the webbing is not twisted, insert the metal tongue plate into the buckle nearest the wearer - a 'CLICK' indicates that the belt is securely locked.

NOTE: The centre rear seat belt* tongue plate will not latch into either of the outer seating position buckles.

Seat belts are designed to bear upon the bony structure of the body (pelvis, chest and shoulders) and can only be worn safely with the seats in a near upright position - DO NOT allow front seat occupants to travel with the seat steeply reclined.

NOTE: Where possible, rear seat passengers should adjust their position on the seat to enable the seat belt webbing to cross the shoulder without pressing on the neck.

Seat Belts

Releasing the belt

Press the RED button on the seat belt buckle.

Front seat belt upper anchorage adjustment (5-door models)

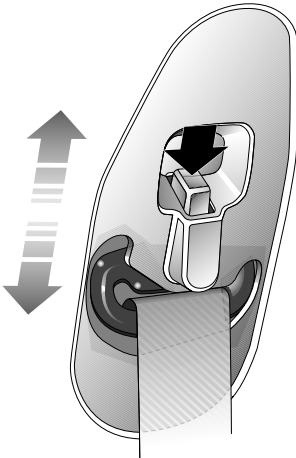

H2344A

The height of the seat belt upper anchorage can be adjusted for comfort AND safety. Adjust the height of the seat belt anchorage point by pressing the button (arrowed in illustration) and sliding the anchor up or down. For safety, the seat belt should always be worn with the webbing crossing the shoulder MIDWAY BETWEEN THE NECK AND THE EDGE OF THE SHOULDER.

Ensure the anchorage has 'clicked' into one of the locked positions before driving, and DO NOT adjust the height once the vehicle is in motion.

Seat belt presenter (3-door models)

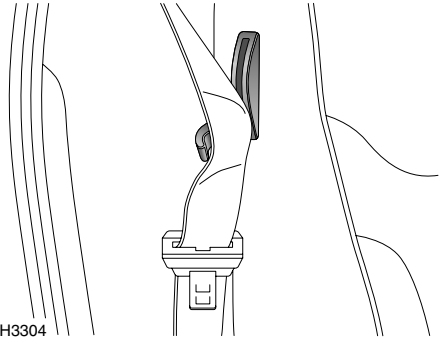

The rear seat access lever can be used as a seat belt presenter to improve accessibility of the front seat belts.

Seat Belts

SEAT BELT PRE-TENSIONERS

The seat belt pre-tensioners activate in conjunction with the airbag SRS and provide additional protection in the event of a severe frontal impact on the vehicle (see 'HOW THE AIRBAG SRS WORKS', page 48). The pre-tensioners automatically retract the seat belts fitted to the front seats. This reduces any slack in both the lap and diagonal portions of the belts, thereby reducing forward movement of the belt wearer in the event of a severe frontal collision.

The airbag SRS warning light on the instrument panel will alert you to any malfunction of the seat belt pre-tensioners.

If the pre-tensioners have been activated, the seat belts will still function as restraints, and must be worn in the event that the vehicle remains in a driveable condition.

NOTE: *The seat belt pre-tensioners will NOT be activated by rear, side or minor frontal impacts.*

WARNING

After the seat belt pre-tensioners have been activated once, they MUST BE REPLACED by a Land Rover Dealer/Authorised Repairer. Failure to replace the pre-tensioners will reduce the efficiency of the vehicle's front restraint systems.

After any frontal impact, always have the seat belts and pre-tensioners checked and, if necessary, replaced by a Land Rover Dealer/Authorised Repairer.

In the interests of safety, it is recommended that removal or replacement of the front seats and seat belts should be carried out only by a Land Rover Dealer/Authorised Repairer.

Second row seat belt locking mechanism

The second row seat belts have a special locking mechanism which aids the retention of child seats. The procedure to install a child seat is as follows:

1. Install the child seat in the vehicle, attach the seat belt and secure the buckle in accordance with the manufacturer's fitting instructions.
2. Pull on the shoulder section of the belt to unreel all of the remaining webbing to the limit of its travel. This will engage the automatic locking feature, which then acts as a ratchet, allowing the webbing to retract ONLY.
3. Allow the seat belt to retract onto the child seat (a 'clicking' sound will confirm that the ratchet has engaged), while firmly pushing the child seat into the vehicle seat.
4. Ensure there is no slack in the seat belt by pulling upwards on the shoulder belt immediately above the child restraint. The seat belt should now be locked and the child seat held firmly in position.

Once the child seat is removed and all the seat belt webbing is allowed to retract, the seat belt locking mechanism reverts to normal operation.

NOTE: *Where possible, use the seat belt automatic locking mechanism to secure large items of luggage that are to be carried on the seats - in the event of an accident, insecure items become flying missiles capable of causing serious injury.*

Seat Belts

Service information

WARNING

DO NOT attempt to service, repair, replace, modify or tamper with any part of the pre-tensioner and airbag SRS, or wiring in the vicinity of a pre-tensioner or airbag SRS component; this could cause the system to activate, resulting in personal injury.

After fifteen years from the original date of registration (or the installation date of a replacement pre-tensioner), some components will need to be replaced by a Land Rover Dealer/Authorised Repairer (note the 'Seat belt pre-tensioner replacement date' shown on page 2 of the Service Portfolio book).

In addition, ALWAYS contact your dealer if:

- an airbag inflates.
- a pre-tensioner activates.
- the front or side of the vehicle is damaged, even if the pre-tensioner has not activated.

CARING FOR SEAT BELTS

Regularly inspect the belt webbing for signs of fraying, cuts and wear; also pay particular attention to the condition of the fixing points and adjusters.

DO NOT bleach or dye the webbing and avoid contaminating the webbing with polish, oil or chemicals (see 'Seat belts', page 194).

Testing inertia reel belts

- With the seat belt fastened, give the webbing near the buckle a quick upward pull. The buckle must remain securely locked.
- With the seat belt unfastened, unreel the webbing to the limit of its travel. Check that unreeling is free from snatches and snags and then allow the belt to FULLY retract.
- Partially unreel the webbing, then hold the tongue plate and give it a quick forward pull. The mechanism must lock automatically and prevent any further unreeling.

If a seat belt should fail any of these tests, contact your dealer immediately.

WARNING

Always replace a seat belt that shows signs of webbing damage or has withstood the strain of a severe vehicle impact.

Child Restraints

CHILD SAFETY SEATS

Seat belts fitted to your vehicle are designed for adults and larger children. It is very important that all infants and children under 12 are restrained in a suitable child safety seat appropriate to their age and size (see table).

Only fit a child safety seat of a type approved for the specific seating positions in your vehicle (see table), and ensure the seat manufacturer's fitting instructions are followed exactly.

WARNING

Do not attempt to fit a child safety seat in the central rear position on 3-door vehicles fitted with only four seats.

For optimum safety, children should travel in the rear of the vehicle at all times; front passenger seat travel is NOT recommended. However, if a passenger airbag is fitted and it is ESSENTIAL that a child travels in the front, set the vehicle seat fully rearward and seat the child in an approved FORWARD-FACING child seat. DO NOT use a rear-facing child seat - an inflating airbag could impact with the seat and cause serious injury!



The above symbol affixed to the passenger side fascia panel of your vehicle, warns against the use of a REAR-FACING child safety seat in the front passenger seat, when a passenger airbag is fitted. This type of seat could cause serious injury to a child in the event of an airbag deployment.

WARNING

DO NOT install a rear-facing child safety seat in a passenger seat equipped with an airbag system. Failure to follow this advice could result in serious injury, or even death, for the child in the event of an airbag deployment.

Child Restraints

NOTE: Child restraint information given in the table is correct at time of going to press. Please refer to your dealer for the latest information.

Mass Group (As displayed on Child Restraint packaging)	Seating Positions			
	Front Passenger All vehicles	Rear Outboard 2 seater	Rear Outboard 3 seater	Rear Centre
0 = Up to 10 kg (0-9 months)	X	U	L	L
0+ = Up to 13 kg (0-18 months)	X	U	L	L
I = 9 to 18 kg (9 months - 4 years)	UF**	U	L	L
II & III = 15 to 36 kg (4-12 years)	UF**	U	L	L

U = Suitable for 'universal' category restraints approved for this mass group.
L = Suitable for particular child restraints as listed below.
UF = Suitable for Forward Facing 'universal' category restraints approved for this mass group.
X = Not suitable for child restraints in this mass group.
Group 0 - BRITAX Rock-A-Tot.
Group 0+ - BRITAX Rock-A-Tot.
Group I - BRITAX Renaissance.
Group II & III - BRITAX Horizon Booster.

NOTE: Seating positions marked ** will accept 'universal' seats provided that the seat back is positioned vertically.

WARNING! Do not install a rear facing child restraint in a passenger seat equipped with an airbag system.

Airbag SRS

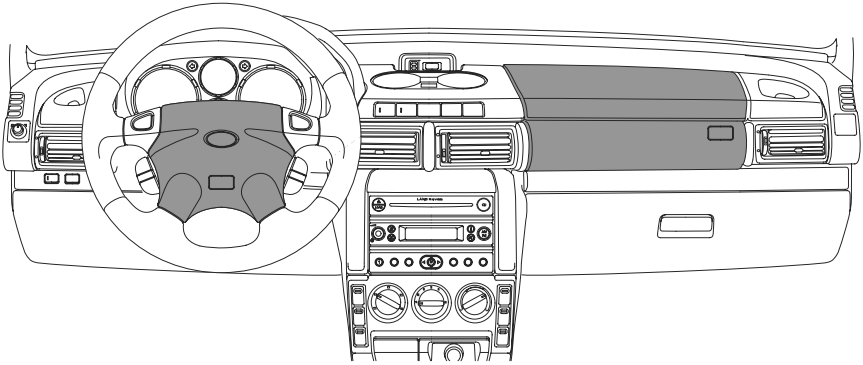

H5204

AIRBAG SRS



The airbag supplementary restraint system (SRS) provides additional protection for the driver and front seat passenger, in the event of a severe frontal impact on the vehicle.

WARNING

*The airbag is a supplementary restraint system that provides **ADDITIONAL** protection in a frontal impact only - it does **NOT** replace the need to wear a seat belt. For maximum safety protection in all crash situations, a seat belt must be worn.*

Provided the front seat occupants are correctly seated, with seat belts properly worn, the airbags will provide additional protection to the chest and facial areas in the event of the vehicle receiving a severe frontal impact.

NOTE: *Inflation and deflation of the airbags takes place very quickly and will not protect against the effects of secondary impacts that may occur.*

The airbag(s) are located in the centre pad of the steering wheel and in the fascia panel above the glovebox (see illustration).

WARNING

Do not allow a front seat passenger to obstruct the operation of the airbag by placing feet, knees or any other part of the person, or any other objects in contact with, or in close proximity to, an airbag module.

WARNING

DO NOT attach or position items to or on an airbag cover (steering wheel centre pad or fascia panel), which could interfere with the inflation of the airbag or, if the airbag inflates, be propelled inside the car causing injury to the occupants.

Airbag SRS

To ensure correct deployment of the airbags, it is essential that obstructions are not allowed to intervene between an airbag and the occupant. The following are examples of the type of obstructions that could either, impede correct operation of the airbags, or jeopardise personal safety in the event of an airbag deployment:

- Accessories attached to or obscuring an airbag cover.
- Items of hand luggage, or other objects placed on an airbag cover.
- Feet, knees or any other part of the anatomy in contact with, or in close proximity to, an airbag cover.

Seating positions

In order to provide optimum protection in the event of a severe frontal impact, it is necessary for the airbags to deploy with considerable speed.

An inflating airbag can cause facial abrasions and other injuries if the occupant is too close to the airbag at the time of its deployment.

WARNING

To reduce the risk of accidental injury from inflating airbags, seat belts should be correctly worn at all times. In addition, both driver and front seat passenger should adjust their seat to provide the maximum practical distance from the airbags.

HOW THE AIRBAG SRS WORKS

In the event of a severe frontal impact, the airbag control unit monitors the rate of deceleration induced by the collision, to determine whether the airbags should be deployed.

Operation of the airbag SRS is dependent entirely on the rate at which the vehicle's passenger compartment changes speed as a result of a collision. The circumstances affecting different collisions (vehicle speed, angle of impact, type and size of object hit, for example), vary considerably and will affect the rate of deceleration accordingly.

NOTE: The airbag SRS is not designed to operate as a result of rear collisions, minor frontal or side impacts or roll-over accidents; nor will it operate as a result of heavy braking or driving over bumps and potholes.

It follows, therefore, that significant superficial damage can occur without the airbags deploying or, conversely, that a relatively small amount of structural damage may cause the airbags to be deployed.

NOTE: Airbags will only deploy when they are required to supplement the restraining force of the seat belts.

In the case of a severe frontal collision, both front airbags and seat belt pre-tensioners will be deployed.

Airbag SRS

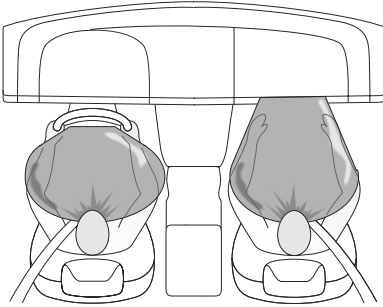

H5206

Airbag inflation is virtually instantaneous and occurs with considerable force, accompanied by a loud noise. The inflated bag, together with the seat belt restraint system, limit the movement of a front seat occupant, thereby reducing the risk of injury to the head and upper torso.

WARNING

An inflating airbag can cause facial abrasions and other injuries. Minimise the risk of injury by ensuring that front seat occupants are wearing their seat belts and are seated correctly, with the seat as far back as is practical.

When an airbag inflates, a fine powder is released. This is not an indication of a malfunction. However, the powder may cause irritation to the skin and should be thoroughly flushed from the eyes and any cuts or abrasions of the skin. After inflation the airbags deflate immediately. This provides a gradual cushioning effect for the occupant and also ensures that the driver's forward vision is not impaired.

WARNING

After inflation, some airbag components are hot - DO NOT touch until they have cooled.

Airbag SRS warning light

SRS

A warning light mounted on the instrument panel will alert you to any malfunction of the airbag SRS.

The light illuminates as a bulb and system check when the starter switch is turned to position 'I' and will extinguish after approximately five seconds. The airbag SRS should always be checked by a dealer if any of the following symptoms occurs:

- The warning light fails to illuminate when the starter switch is turned to position 'II'.
- The warning light fails to extinguish within approximately five seconds after the starter switch is turned to position 'II'.
- The warning light illuminates after the engine is started, or while the vehicle is being driven.

Airbag SRS

SERVICE INFORMATION

WARNING

DO NOT attempt to service, repair, replace, modify or tamper with any part of the airbag SRS, or wiring in the vicinity of an airbag SRS component; this could cause the system to activate, resulting in personal injury.

After fifteen years from the original date of registration (or the installation date of a replacement airbag SRS), the airbag modules will need to be replaced by a Land Rover Dealer/Authorised Repairer (see the 'airbag module replacement date' shown on page 2 of the Service Portfolio book). The dealer should stamp and sign the appropriate page once the work has been completed.

In addition, ALWAYS contact your Dealer/Authorised Repairer if:

- an airbag inflates.
- the front of the vehicle is damaged, even if the airbag has not inflated.
- any part of an airbag module cover (the steering wheel centre pad or fascia panel) shows signs of cracking or damage.

IMPORTANT

The components that make up the airbag SRS are sensitive to electrical or physical interference, either of which could easily damage the system and cause inadvertent operation or a malfunction of the airbag.

For your safety it is recommended that you seek the assistance of a Land Rover Dealer/Authorised Repairer to carry out any of the following:

- Removal or repair of any wiring or component in the vicinity of any of the SRS components, including the steering wheel, steering column, instrument and fascia panels.
- Installation of electronic equipment such as a mobile phone, two-way radio or in-car entertainment system.
- Modification to the front of the vehicle, including the bumper and chassis.
- Attachment of accessories to the front of the vehicle.

Disposing of vehicles

If you sell your vehicle, be sure to inform the new owner that the vehicle has an airbag SRS. In addition, make sure the new owner is aware of the airbag module replacement date shown on page 2 of the Service Portfolio book.

If your vehicle is to be scrapped; uninflated airbags are potentially very dangerous and must be safely deployed in a controlled environment by qualified personnel, before a vehicle is scrapped.

Steering Column

STEERING COLUMN ADJUSTMENT

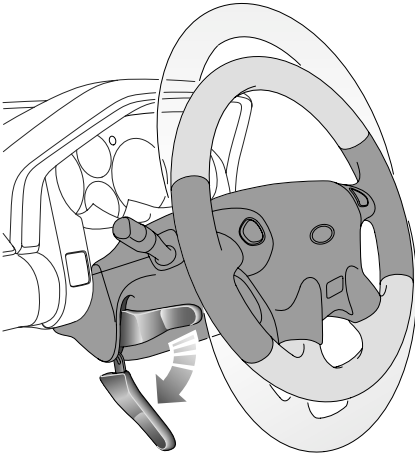

H5084

The angle of the steering column can be adjusted to suit your driving position:

1. With the vehicle stationary, push the locking lever fully down to free the steering column.
2. Move the steering wheel (up or down) into the desired position, making sure that the instrument panel is clearly visible.
3. When adjustment is complete, pull the locking lever fully up to lock the steering column in position.

WARNING

DO NOT adjust the steering column while the vehicle is in motion. This is extremely dangerous!

DO NOT drive the vehicle unless the locking lever is in the locked position (fully up).

Instruments

INSTRUMENT PANEL

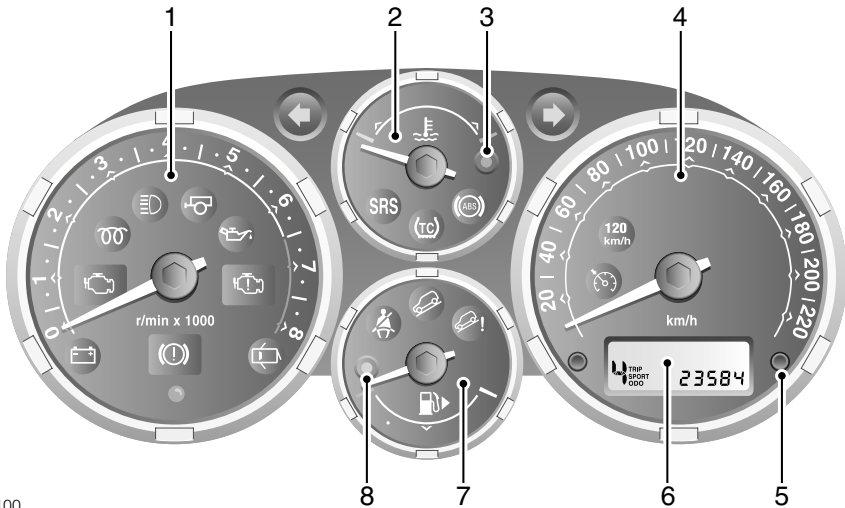

H5100

Petrol model illustrated

1. Tachometer

Indicates engine speed in revolutions per minute (x 1000). To protect the engine from damage, NEVER allow the tachometer pointer to enter the RED sector.

NOTE: On diesel models, the tachometer is only calibrated up to 6,000 rev/min.

2. Temperature gauge

This gauge indicates the temperature of the engine coolant. As the engine warms up, the pointer will rise to the mid-point of the gauge, where it should remain while the engine is operating at its normal temperature.

If the pointer reaches the RED sector, the coolant is too hot and severe engine damage could result; stop the vehicle as soon as safety permits and seek qualified assistance.

3. Over-temperature warning light

Illuminates when the engine coolant temperature reaches the RED sector (120°C). Illuminates as a bulb check when the starter switch is turned to position 'I' and extinguishes when the engine is started.

4. Speedometer

Indicates road speed in kilometres per hour.

5. Trip recorder reset button

When the starter switch is turned on, the display shows either the odometer reading or the trip recorder reading. By pressing the trip recorder reset button briefly, the display will change between the trip recorder and odometer modes. With the trip recorder mode displayed, press and hold the reset button for 2 seconds to reset the display to zero.

Pressing the button with the ignition off, will display the odometer reading for 5 seconds.

Instruments

6. Digital display

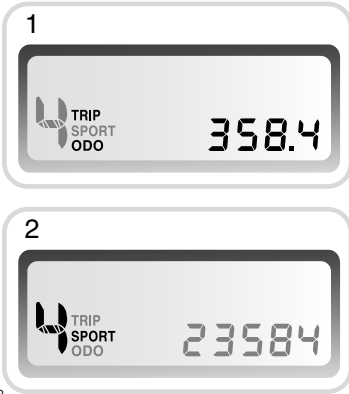
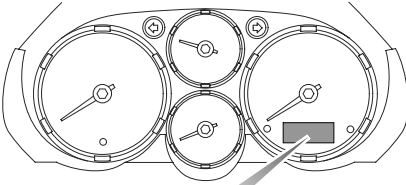

H5103

The panel displays the following:

1. Odometer reading (shows the total distance travelled by the vehicle). The word 'ODO' is displayed.
Trip recorder (for recording individual journey distances). The word 'TRIP' is displayed instead of 'ODO'.
2. Automatic gear selector position ('1', '2', '4', 'P', 'R', 'N', 'D') - automatic transmission only.
The word 'SPORT' confirms the selection of Sport mode - automatic transmission only.
Manual mode gear selection information ('1', '2', '3', '4' or '5') - automatic transmission only

For further information concerning the automatic transmission, (see 'CommandShift® TRANSMISSION', page 108).

7. Temperature display units

Press to change the temperature units shown on the digital display from Fahrenheit to Celsius, and vice versa.

8. Fuel gauge

The pointer indicates the fuel level when the starter switch is turned to position 'II'. After refuelling, the pointer rises to the new level after the starter switch is turned on. When the starter switch is turned off, the pointer quickly lowers to the 'empty' position.

An arrow on the face of the fuel gauge indicates the side of the vehicle on which the fuel filler is situated.

WARNING

Never allow the vehicle to run out of fuel - the resultant misfire could damage the catalytic converter.

NOTE: Driving on twisting or hilly roads may disturb the accuracy of the fuel gauge. It is advisable to check the fuel level when the vehicle is travelling on a straight, level road.

9. Low-fuel warning light

Illuminates when the fuel level is low (approximately 2 gallons (9 litres) remaining). If the light illuminates, refuel at the earliest opportunity.

Illuminates as a bulb check when the starter switch is turned to position 'II' and extinguishes when the engine is started.

Instruments

Instrument illumination control

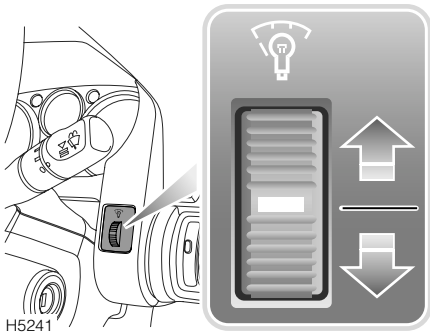

Rotate the control up to increase, or down to decrease the intensity of the instrument panel illumination.

The instrument illumination control also adjusts the level of illumination for all switch lighting sources forward of the driver.

Warning Lights

INSTRUMENT PANEL

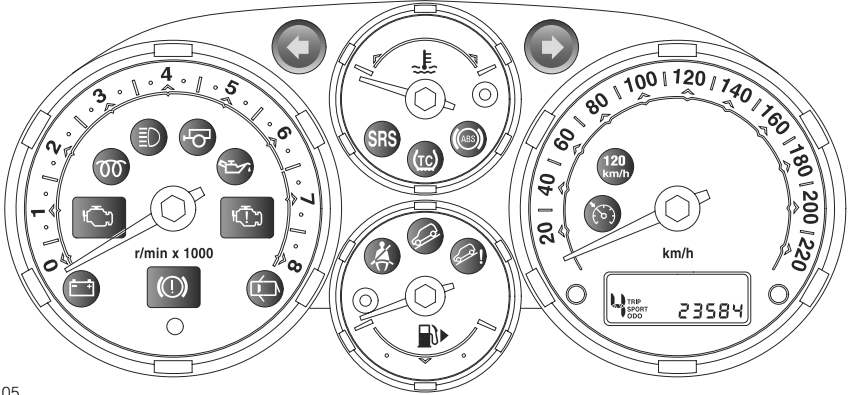

H5105

The location and specification of the warning lights may vary according to model and market requirements.

Direction indicators - GREEN



The left or right warning light flashes in time with the relevant direction indicator when they are operated. If either warning light fails to flash or flashes rapidly, the selected direction indicator light is not operating.

NOTE: If the hazard warning lights are operated, both direction indicator warning lights will flash together.

Headlight main beam - BLUE



Illuminates when the headlights are switched to main beam.

Cruise control - AMBER*



Illuminates when the cruise control master switch is turned on and cruise control is active, and extinguishes when the switch is turned off or if cruise control is deactivated.

Engine malfunction indicator - M.I.L - AMBER



Illuminates as a bulb check when the starter switch is turned to position 'II' and extinguishes when the engine is started. If the light illuminates while the engine is running, this indicates the detection of an emissions fault by the engine management system.

If the light illuminates and the vehicle drives normally:

- Arrange a service appointment at your earliest convenience - you may still drive the vehicle.

If the light flashes and/or the vehicle does not drive normally:

- Avoid high speeds and seek qualified assistance urgently.

Warning Lights

Handbrake & brake system - RED



The light illuminates when the handbrake is applied and extinguishes when it is fully released. If the light illuminates while the handbrake is released, a fault with the braking system is indicated, check the brake fluid level (see '*BRAKE FLUID*', page 178). If the light continues to illuminate, seek qualified assistance urgently.

Door open - RED



Illuminates when any of the doors (including the taildoor and bonnet) are not fully closed. DO NOT drive the vehicle with the light illuminated.

Traction control - AMBER



Illuminates as a bulb and system check when the starter switch is turned to position 'II' and extinguishes after approximately 4 seconds. The light illuminates for a minimum of 2 seconds, whenever traction control is operating.

If the light illuminates continuously while traction control is NOT operating, a fault with the system is indicated; seek qualified assistance.

The light also has an overheat function: if traction control is required, but the brakes are too hot, the light will flash for the period when traction control is required and traction has been lost.

ABS - AMBER



Illuminates for approximately 1 second as a bulb and system check when the starter switch is turned to position 'II', and then extinguishes. The light may blink during this time.

If the light remains on or subsequently illuminates while driving, a fault has been detected by the self-monitoring system. This means that full ABS control may not be available and you should seek qualified assistance urgently.

Hill descent control (HDC) 'failure' - AMBER



The light illuminates briefly as a bulb check when the starter switch is turned to position 'II'. The light will flash if the brakes become in danger of overheating and continue flashing until the brakes have cooled sufficiently to enable HDC to operate again (see also '*HDC fade-out*', page 114).

If the light illuminates at any other time, a fault in the system is indicated. If this occurs, deselect HDC and consult your Land Rover Dealer/Authorised Repairer.

Hill descent control (HDC) 'information' - GREEN



Illuminates briefly as a bulb check when the starter switch is turned to position 'II' and will illuminate when HDC is selected.

If HDC is selected when either of the operating gears is engaged (1st or reverse), the light will illuminate continuously.

When HDC is selected and a non-operating gear is engaged, the light will flash to inform the driver that HDC is selected, but not operating (see also '*HDC fade-out*', page 114).

Warning Lights

Low oil pressure - RED



Illuminates as a bulb check when the starter switch is turned to position 'II' and extinguishes when the engine is started. If the light remains on, flashes on and off or illuminates continuously when driving, serious engine damage could occur; stop the vehicle as soon as safety permits and SWITCH OFF THE ENGINE IMMEDIATELY. Seek qualified assistance before driving.

Seat belt - RED*



The light illuminates when the starter switch is turned to position 'II' as a reminder to the driver to ensure that the seat belts of all occupied seats are securely fastened. The light extinguishes after approximately five seconds, or when the driver's seat belt is fastened.

Airbag SRS - RED



The light illuminates when the starter switch is turned to position 'II' and extinguishes after about five seconds. If the light illuminates at any other time, seek qualified assistance urgently.

Overspeed - AMBER*



Illuminates as a bulb check when the starter switch is turned to position 'II' and extinguishes after approximately 2 seconds. The light will also illuminate when the vehicle's road speed exceeds 120 km/h and extinguishes again once road speed drops below 120 km/h.

Engine malfunction - AMBER



Illuminates briefly when the starter switch is turned to position 'II'. If it remains on, or illuminates at any other time, the engine management system requires attention. Stop the vehicle as soon as safety permits and switch off the engine for at

least 30 seconds; if the light illuminates again after the engine is restarted, it is permissible to continue driving (with reduced engine power), but qualified assistance must be sought as soon as possible, to prevent potential engine damage.

Battery charging - RED



The light illuminates as a bulb check when the starter switch is turned to position 'II' and extinguishes as soon as the engine is running. If it remains on, or illuminates when driving, a fault with the battery charging system is indicated. Seek qualified assistance urgently.

Glow plugs - AMBER (Diesel models)



Illuminates when the starter switch is turned to position 'II'. When the engine is cold, wait for the light to extinguish before starting. If the engine is warm, the light may not illuminate.

Trailer direction indicators - GREEN



Illuminates in conjunction with the vehicle direction indicator lights to show that all trailer indicator lights are functioning correctly. In the event of a bulb failure on the trailer, the warning light flashes once and then remains off.

When a trailer is not fitted, the warning light will flash once each time the direction indicator switch is operated.

NOTE: The trailer direction indicator light will also flash when the hazard warning lights are activated, whether a trailer is attached or not.

Lights & Indicators

DIRECTION INDICATORS

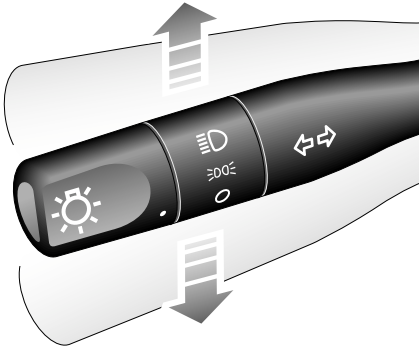

H5093

Move the lever DOWN to indicate a LEFT turn, and UP to indicate a RIGHT turn (the appropriate GREEN warning light on the instrument panel will flash in time with the direction indicators).

Hold the lever part-way up or down against spring pressure to indicate a lane change.

LIGHTS

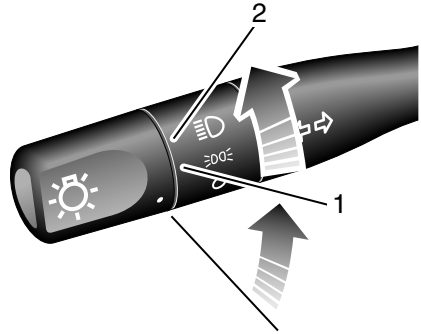

H5094

The side, tail and headlights operate with the starter switch in any position.

If the exterior lights are left on after the starter switch is turned off, a warning chime will sound as soon as the driver's door is opened. The chime will cease as soon as the lights are switched off, or the door is closed.

Side, tail and instrument panel lights

Turn lighting switch to position 1.

Headlights

Turn lighting switch to position 2.

Lights & Indicators

Headlight main and dipped beams

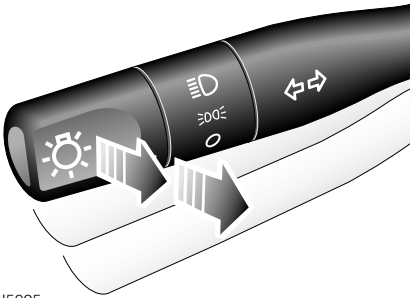

H5095

Pull the lever fully towards the steering wheel to change headlight beams (BLUE warning light glows when the headlights are on main beam).

To flash the headlights, pull the lever part way towards the steering wheel and release.

Headlight levelling

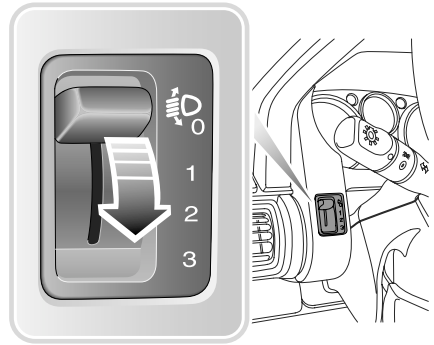

H5072

The angle of the headlight beams is affected by the distribution of weight inside the vehicle. The headlights should be adjusted so that the point at which the beams meet the road surface ahead of the vehicle provides adequate illumination without dazzling other road users.

The four-position switch should be used to adjust the headlight beams in relation to the vehicle loadings identified below.

Loading Condition	Switch Position		
	4 Cyl. Petrol & Diesel Standard Suspension	6 Cyl. Petrol Standard Suspension	All Models Sports Suspension
Driver only.	0	0	0
Driver plus one front passenger.	0	0	0
All seats occupied.	1	1	1
All seats occupied plus MRAL.	2	3	1
Driver plus MRAL.	3	3	2

NOTE: MRAL = Maximum Rear Axle Load.

Lights & Indicators

FOG LIGHTS

WARNING

Fog lights should ONLY be used when visibility is severely restricted - other road users could be dazzled in clear conditions.

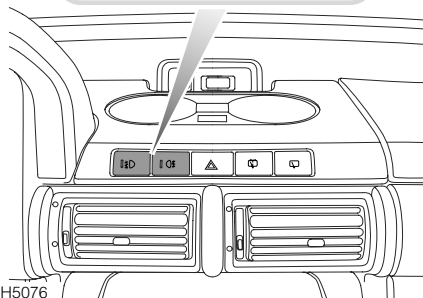
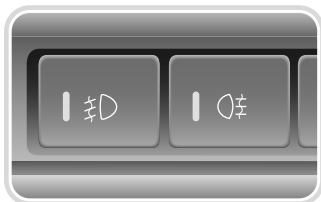

H5076

Front fog lights*

 Press to operate, press a second time to switch off (the green indicator light in the switch illuminates when the fog lights are switched on).

The front fog lights operate ONLY when the starter switch is at position 'II' and the side or headlights are also switched on. The front fog lights extinguish automatically when the side lights or the starter switch is turned off, but will automatically be reselected when the starter switch is turned back on.

DO remember to switch off as soon as visibility is clear.

Rear fog guard lights



Press to operate, press a second time to switch off (the red indicator light in the switch illuminates when the fog guard lights are switched on).

The rear fog guard lights operate ONLY when the starter switch is turned to position 'II' and the headlights are switched on. Switching off the headlights, or turning the starter switch to position '0', will automatically extinguish the rear fog guard lights.

DO remember to switch off as soon as visibility is clear.

HAZARD WARNING LIGHTS

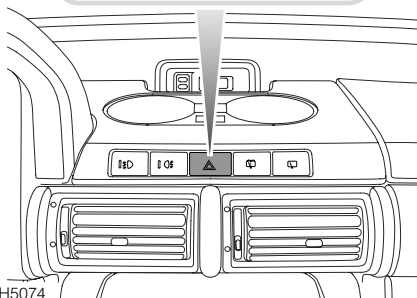
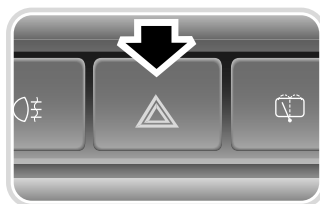

H5074



Press to operate; all the direction indicator lights (including those fitted to a trailer) will flash together. Use ONLY in an emergency to warn other road users when your stationary vehicle is causing an obstruction, or is in a hazardous situation. Remember to switch off before moving away.

Wipers & Washers

OPERATING

The wipers and washers will only operate when the starter switch is turned to position '1' or '1I'.

IMPORTANT

- DO NOT operate the wipers on a dry screen.
- In freezing or very hot conditions, ensure that the blades are not frozen or stuck to the glass.
- In winter, remove any snow or ice from around the arms and blades, including the wiped area of the windscreen and the heater air intakes.

NOTE: If the wiper blades have stuck to the glass, a thermal cut-out may temporarily prevent the wiper motor from operating. If this is the case, switch the wipers off, free them from the obstruction and then switch on again.

WINDSCREEN WIPERS

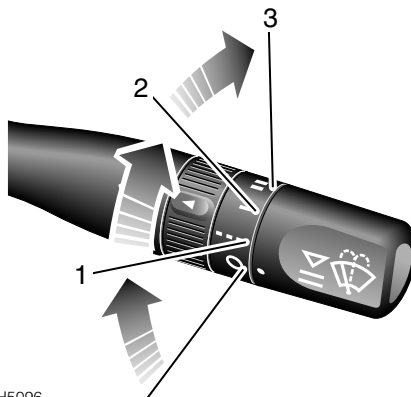

H5096

Intermittent wipe

Turn switch to position 1.

Normal speed wipe

Turn switch to position 2.

Fast speed wipe

Turn switch to position 3.

NOTE: If the front screen wipers are operating (in either intermittent or continuous mode), the rear wiper operates automatically whenever reverse gear is selected.

Wipers & Washers

Single wipe

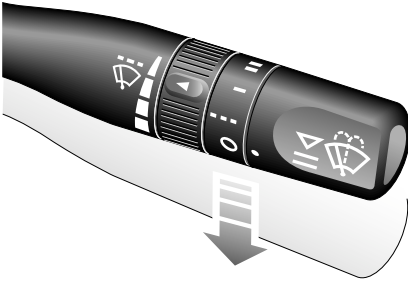

H5097

Pull the lever down and release immediately.

NOTE: With the lever held down, the wipers will operate at high speed until the lever is released.

Variable delay (intermittent wipe)

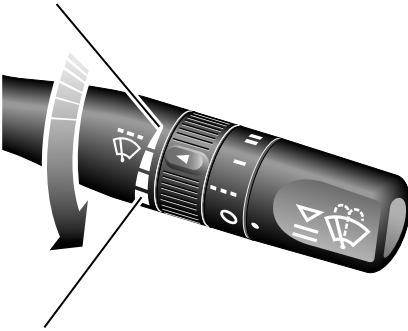

H5098

Rotate the inner switch to vary the delay between wipes.

WINDSCREEN WASHERS

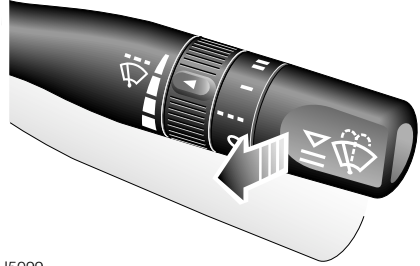

H5099

Pull the lever toward the steering wheel. The windscreen wipers will operate in conjunction with the washers for as long as the lever is held in this position, the wipers continuing for a further 3 to 4 wipes after the lever is released.

Wipers & Washers

REAR SCREEN WIPER AND WASHER

Rear window wash/wipe

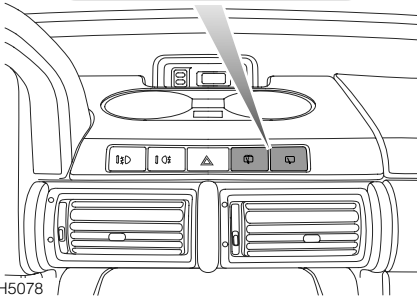

Press and hold the switch for the required duration of screen washing. The wiper operates automatically during washing and continues for a further 4 wipes (approx.) after the switch is released.

Rear screen wiper



Press to operate: after continuously wiping 3 or 4 times, the wiper operates intermittently (approx. once every 6 seconds) until switched off.

NOTE: When reverse gear is selected, the rear wiper will operate continuously in tandem with the front wipers.

NOTE: Opening the taildoor, or lowering the rear screen, will switch the rear wiper off.

Horn

HORN

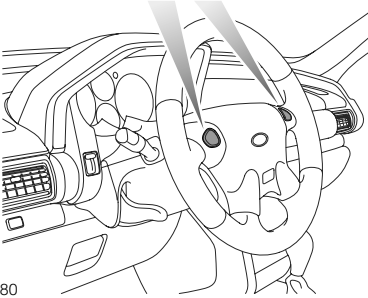
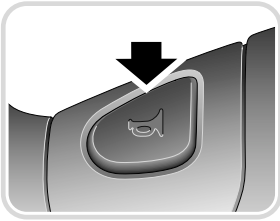

H5080

To operate, press either of the horn switches set into the steering wheel pad.

Mirrors

EXTERIOR MIRRORS

NOTE: The mirror glass is convex, providing a wider field of vision. As a result, objects reflected in the mirror are closer than they appear.

Adjustment

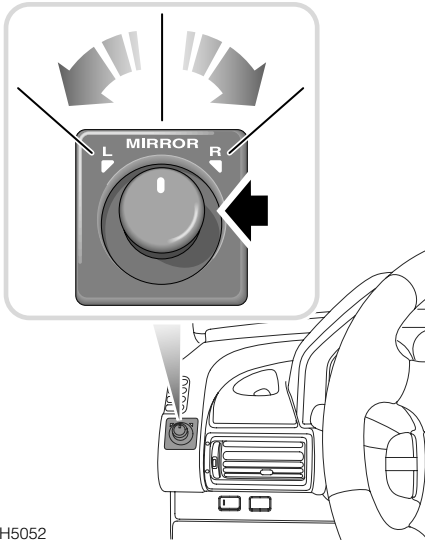

- Turn the control to the 'L' or 'R' position to select either the left or right hand mirror.
- With the starter switch turned to position 'II', push the control in the appropriate direction to tilt the mirror glass up/down/left or right.
- When adjustment is complete, return the control to the OFF position (midway between 'L' and 'R').

Heating elements

The exterior mirrors have integral heating elements for dispersing ice and mist, which operate automatically whenever the starter switch is in position 'II'.

Folding the mirror body

The body of each door mirror is designed to fold forwards or rearwards on impact. They can also be folded back manually towards the side windows into a 'park' position, to enable the vehicle to negotiate narrow openings.

Manual operation: On some vehicles this operation can be carried out manually, by physically pushing the mirror bodies back towards the side windows, and then pulling them back into the normal (extended) positions.

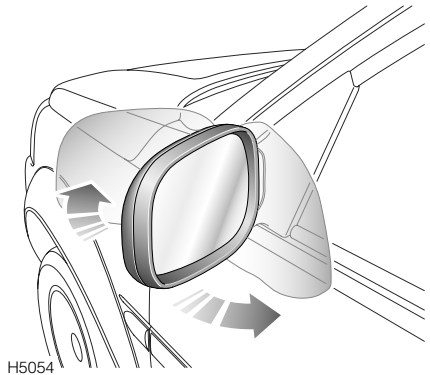

Mirrors

Electric operation:*

On some vehicles, mirror folding can be carried out electrically, as follows:

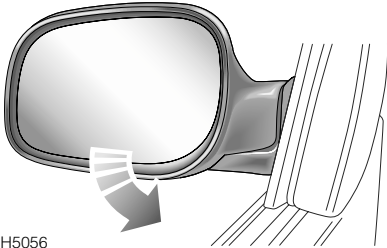
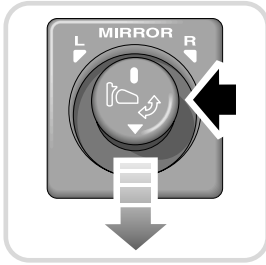

H5056

1. Ensure the mirror control is turned to the centre position.
2. Push the control down once to fold the mirrors back towards the side windows.
3. Before driving, push the control down a second time to return the mirrors to their normal driving position.

If one mirror is accidentally knocked out of position, an additional operation of the switch will re-synchronise them.

NOTE: After several consecutive operations of the control, the mirror motor will cut-out. This is not a fault and occurs automatically to prevent the motor from overheating.

INTERIOR MIRROR

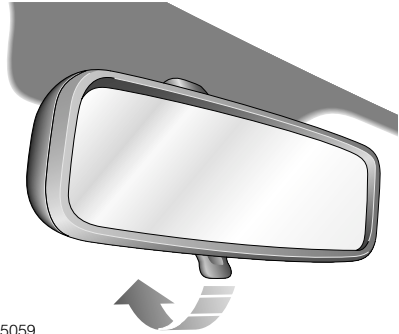

H5059

The interior mirror can be dipped to reduce glare from following vehicles. In the event of excessive glare, move the lever at the base of the mirror forward to 'dip' the mirror. Normal visibility is restored by pulling the lever back to its original position.

NOTE: In some circumstances, the view reflected in a 'dipped' mirror can confuse the driver as to the precise position of following vehicles. Remember to take additional care!

Mirrors

VANITY MIRROR*

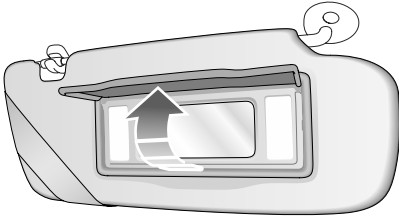

H5061

To use the vanity mirror, pull down the passenger's sun visor. On some models, the vanity mirror is illuminated; lift the mirror cover to illuminate.

NOTE: Always close the cover, or on vanity mirrors not fitted with a cover, always return the visor to its stowed position when not in use, to avoid possible scorching of the seats by the sun reflected in the mirror.

Windows

ELECTRIC WINDOW CONTROLS

WARNING

Accidental closing of an electrically operated window on fingers, hands or any vulnerable part of the body, can result in serious injury. Always observe the following precautions:

ISOLATE the rear window switches when carrying children.

ENSURE that children are kept clear whilst raising or lowering windows.

ENSURE that all adult passengers are familiar with the controls and the potential dangers of electrically operated windows.

DO NOT allow passengers to extend any part of their bodies through a window aperture while the vehicle is moving - injury from flying debris, branches of trees or other obstructions could occur.

It is recommended that the starter key be removed when leaving the vehicle.

5 DOOR VEHICLES

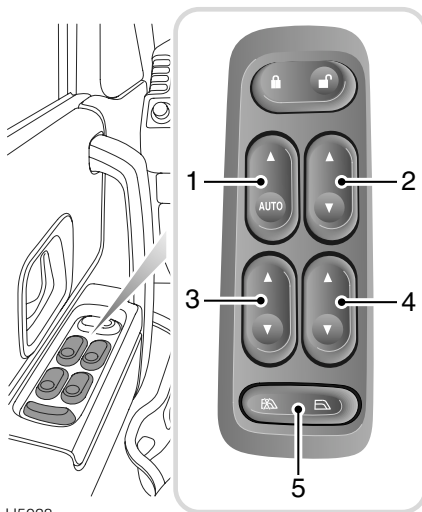

H5038

The switches on the driver's door console operate the windows as follows:

1. Left hand front window.
2. Right hand front window.
3. Left hand rear window.
4. Right hand rear window
5. Isolation switch for rear door window switches.

NOTE: *Electric rear windows can also be operated by the individual switches mounted on each rear door, provided that the isolation switch has not been activated.*

Windows

Operating the windows

The electric windows can be operated when the starter switch is at position 'II' and for up to 45 seconds after the starter switch is turned off (provided neither front door is opened in the meantime).

Press and hold the bottom half of a switch to lower and the upper half to raise. The window will stop moving when the switch is released.

NOTE: ENSURE that all adult passengers are familiar with the controls and the potential dangers of electrically operated windows.

Rear window isolation switch

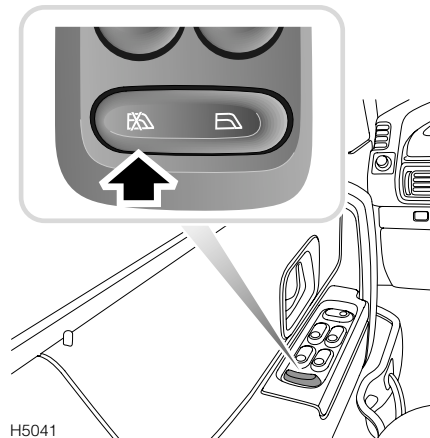

Press switch '5' as indicated to isolate the rear window switches. Press the other end of the switch to restore independent control.

'One touch' down (Driver's door only)

By pressing (and then releasing) the bottom half of switch '1' (AUTO) to the second detent position, the window will open fully at a single touch. Window movement can be stopped at any time by briefly pressing the upper half of the switch.

Front door - passenger's window switch

The front seat passenger can also independently control the raising and lowering of their window by using the switch on the passenger door. Press and hold the bottom half of the switch to lower and the upper half to raise. The window will stop moving when the switch is released.

Rear door - passenger's window switch

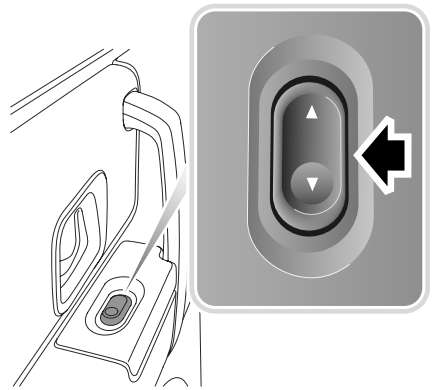

Rear seat passengers can control the raising and lowering of their window by using the switch on either of the rear doors. (Provided that the rear windows have not been isolated by the driver).

Press and hold the bottom half of a switch to lower and the upper half to raise. The window will stop moving when the switch is released.

NOTE: ENSURE that all adult passengers are familiar with the controls and the potential dangers of electrically operated windows.

Windows

3 DOOR VEHICLES

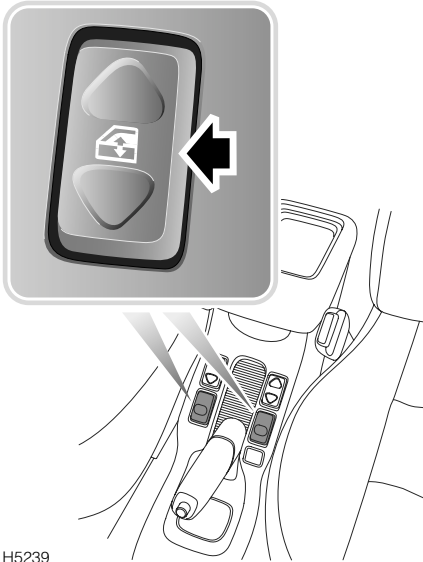

H5239

'One touch' down (Driver's door only)

By briefly pressing (and then releasing) the bottom half of the driver's window switch, the window will open fully at a single touch. Window movement can be stopped at any time by briefly pressing the upper half of the switch.

The switches on centre console operate the windows as follows:

Operating the windows

The electric windows can be operated when the starter switch is at position 'II' and for up to 45 seconds after the starter switch is turned off (provided neither door is opened in the meantime).

Press and hold the bottom half of a switch to lower and the upper half to raise. The window will stop moving when the switch is released.

NOTE: ENSURE that all adult passengers are familiar with the controls and the potential dangers of electrically operated windows.

Windows

ELECTRIC TAILDOOR GLASS

WARNING

Long loads should be carried on the roof rack. If it is necessary to carry a load that protrudes through the taildoor window, the weight of the load must NOT rest on the glass of a partially open window. Damage to the glass or window mechanism may occur (see also 'Accommodating long loads', page 38).

NOTE: The taildoor glass can be lowered from outside the vehicle, to enable easy access to the loadspace area when it is impossible or inconvenient to open the taildoor.

Raising and lowering

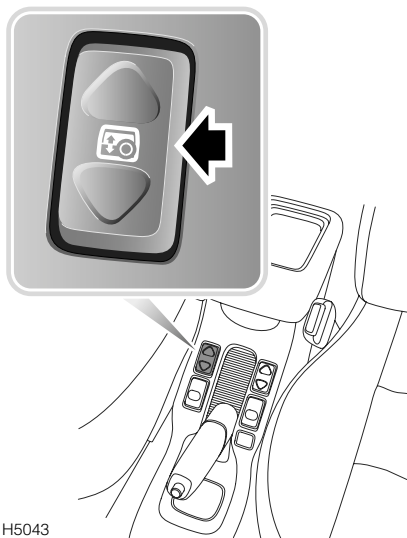

From inside the vehicle:

With the starter switch in position 'II', press and hold the bottom half of the switch to lower the glass, movement will stop when the switch is released.

Press the upper half of the switch to raise the glass. If the switch is released before the glass is fully raised, it will automatically lower again.

NOTE: On 3-door models, the taildoor glass cannot be raised if the soft-back is raised/removed or if the hard-back is removed.

One touch down:

By briefly pressing (and then releasing) the bottom half of the switch, the taildoor glass will open fully at a single touch.

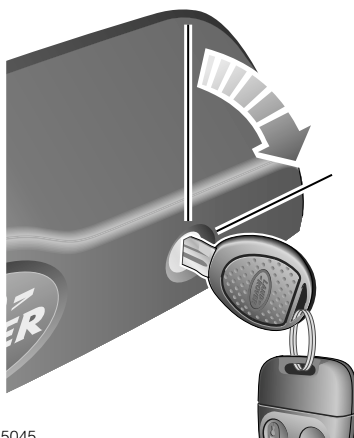

From outside the vehicle:

Press and hold the UNLOCK button on the remote handset (hold for 2 seconds) - the taildoor glass will fully lower.

To raise the glass, insert the starter key into the switch mounted in the taildoor handle and turn clockwise. If the switch is released before the glass is fully raised, it will automatically lower again.

NOTE: If the vehicle is locked when the glass is lowered using the handset, the driver's door will unlock and the security features will be disarmed.

Remember to relock the vehicle (if required).

Windows

Battery disconnection

If the battery has been disconnected, the taildoor glass will need to be recalibrated. If the alarm was armed when the battery was disconnected (or discharged), disarm the alarm after reconnection - the glass will fully lower. This will happen automatically if the alarm was in a disarmed state when the battery was disconnected.

After battery reconnection, fully raise the glass - the taildoor glass is now recalibrated (if the glass is not fully raised, an error 'beep' will sound).

REAR VENTILATOR WINDOWS (3-door models)

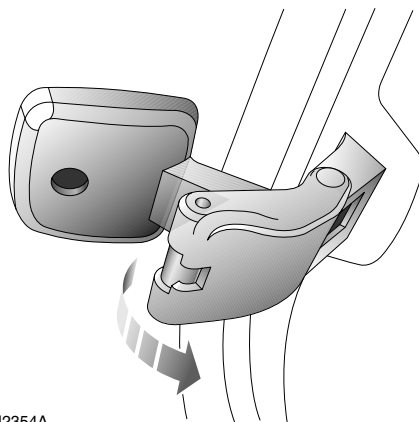

H2354A

To open, pull the catch forwards and push outwards until the window 'clicks' into position.

To close, pull the centre of the catch inwards, then push rearwards until the catch is felt to 'clip' into the locked position.

NOTE: *Ensure that children are kept clear while operating the windows.*

Sunroof

ELECTRIC SUNROOF*

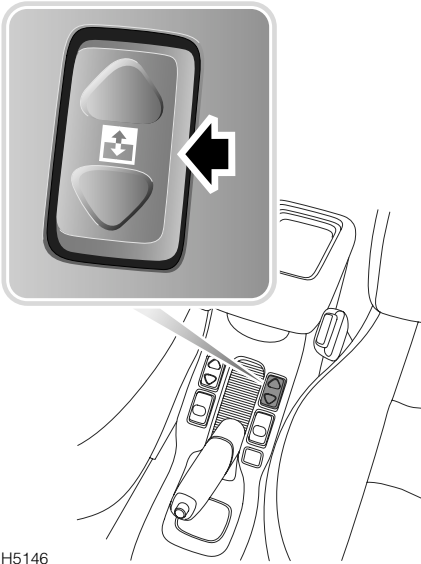

H5146

The sunroof can be operated when the starter switch is turned to position 'II' and for up to 45 seconds after the starter switch is turned off (provided neither front door is opened in the meantime).

The roof opens in two separate phases as follows:

- **To tilt the roof:** Press the bottom half of the switch - the rear edge of the roof rises to the tilted position.
- **To open the roof:** With the sunroof fully tilted, press the bottom half of the switch - the roof remains tilted and slides towards the rear until fully open or the switch is released.

NOTE: Do not operate the sunroof when it is obstructed, or covered in ice or snow - damage could be caused.

To close the roof: press the upper half of the switch - the sunroof will first close to the tilted position, then it will return the tilted roof to the closed position. The sunroof can be stopped (at any position) by releasing the switch.

WARNING

Accidental closure of a sunroof on fingers, hands or any vulnerable part of the body, can result in serious personal injury. Always observe the following precautions:

ENSURE that children are kept clear and that the sunroof is not obstructed when opening or closing.

DO NOT allow passengers to extend any part of their bodies through the sunroof aperture while the vehicle is moving - injury from flying debris, branches of trees or other obstructions could occur.

Do not open the sunroof if the load on the roof rack will impede its operation.

ALWAYS close the roof when the vehicle is unattended.

NOTE: ENSURE that all adult passengers are familiar with the controls and the potential dangers of operating an electrically operated sunroof.

Sunroof visor

The sunroof visor needs to be opened and closed manually.

Driving with the sunroof open

If, when driving with the sunroof open, unwanted drafts are experienced, open the front fascia air vents, and increase the blower speed if necessary. DO NOT operate the air conditioning.

Sunroof

Sunroof blind

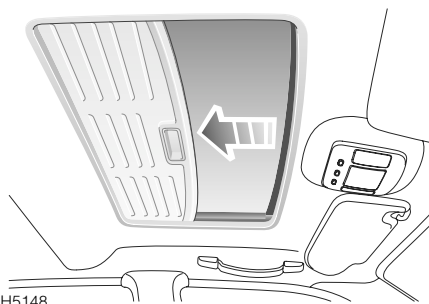

H5148

Pull the sunroof blind across the sunroof aperture to open and close.

Heating & Ventilation

VENTILATION

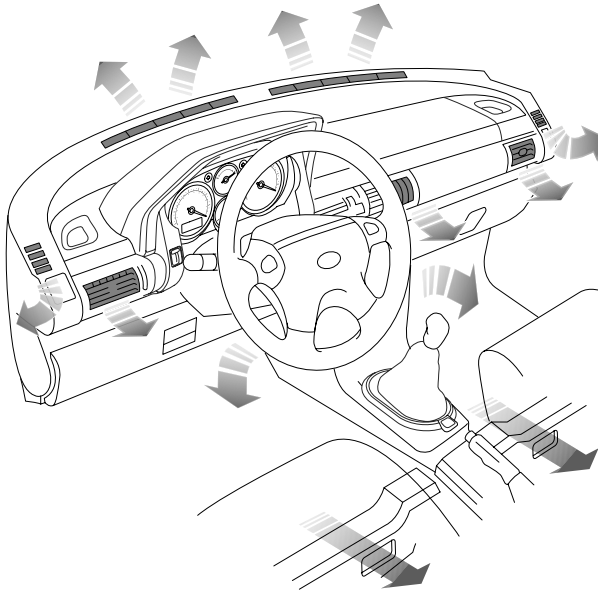

H5213

The ventilation system provides fresh or heated air to the interior of the vehicle from the air intake grille in front of the windscreen.

NOTE: Always keep the air intake grille clear of obstructions such as leaves, snow or ice.

Air outlets are provided to the windscreen, face and feet - the location of the vents is shown in the illustration above. The temperature of the air is controlled by the heater.

Information concerning the operation of the heating and ventilation system, as well as the air conditioning, appears on the pages that follow.

Particle filter*

Particle filters help to keep the vehicle interior free from pollen and dust. To remain fully effective, the filter should be replaced at least every 12 months or 20,000 km, at the time of a main service.

Heating & Ventilation

HEATER CONTROLS

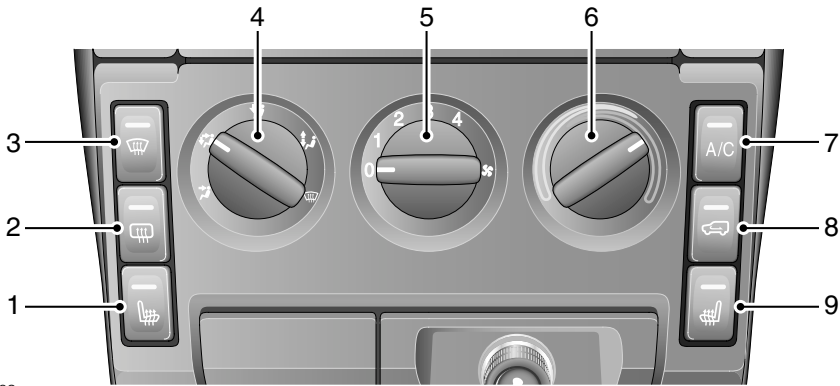

H5063

1 & 9. Heated front seats*

With the starter switch turned on and the engine running, press the switches to operate the heating elements in either the driver's or front passenger seat (the indicator light in the switch illuminates). Press a second time to switch off.

NOTE: The seat heaters will switch off automatically 45 seconds after the starter switch is turned off, or either front door is opened.

The seat heaters are thermostatically controlled and operate intermittently to achieve and then maintain a predetermined temperature between 26°C and 36°C.

NOTE: Owners should be aware that the seat heaters consume considerable power from the battery and for this reason, it is recommended that they are operated only with the engine running.

2. Heated rear window

Press to operate; press a second time to switch off. The indicator light in the switch illuminates whenever the heater is on and extinguishes when the heater is turned off.

NOTE: The heated rear window will operate only with the taildoor fully closed and when the engine is running and will switch off automatically after approximately 15 minutes.

WARNING

DO NOT stick labels over the heating elements, and **DO NOT** scrape or use abrasive materials to clean the inside of the window.

3. Heated front screen*

Press to operate; press a second time to switch off. The indicator light in the switch illuminates whenever the heater is on and extinguishes when the heater is turned off.

NOTE: The front screen heater will operate only when the engine is running and will switch off automatically after approximately 10 minutes.

Heating & Ventilation

4. Air distribution control

Rotate to select air distribution:



Air to face vents
(to ensure best performance, the face level vents must be fully open)



Air to face vents and foot outlets
(to ensure best performance, the face level vents must be fully open)



Air to foot outlets



Air to foot outlets and windscreen
(if the ambient temperature is approximately 5° C or higher, the air conditioning (if fitted) will automatically dehumidify the air to reduce misting).



All air to windscreen
(if the ambient temperature is approximately 5° C or higher, the air conditioning (if fitted) will automatically dehumidify the air to reduce misting).

5. Air blower control

Turn the control clockwise to progressively increase the blower speed.

NOTE: With the control in position '0', the volume of air entering the vehicle is dependent on driving speed alone.

6. Air temperature control

Rotate the control clockwise (towards the RED segments) to increase the air temperature, or anti-clockwise (towards the BLUE) to reduce the temperature.

7. Air conditioning button*

With the engine running, press to operate. The indicator light in the switch illuminates when the air conditioning is switched on.

8. Air recirculation button*

Press to recirculate air inside the vehicle (indicator light illuminates).

The air recirculation mode prevents the heating system from taking in fresh air from outside the vehicle. Instead, the air already inside the vehicle is recirculated, thus preventing the entry of traffic fumes. In cold weather air recirculation also enables warmer air to be used to defrost the windscreen when the engine is still cold.

WARNING

The air recirculation mode can cause the windscreen to mist. If this happens, switch off air recirculation immediately.

Heating & Ventilation

USING YOUR HEATER

Fresh air enters the heater unit through the grille in front of the windscreen and stale air is drawn out through vents in the rear of the vehicle. Ducts beneath the front seats provide heating for rear seat passengers - these must not be obstructed.

The following examples of basic heater settings are intended as a general guide; the air distribution, temperature and blower controls can then be further adjusted to suit your comfort requirements.

Always remember that full heating is not available until the engine has reached its normal operating temperature.

Maximum heating

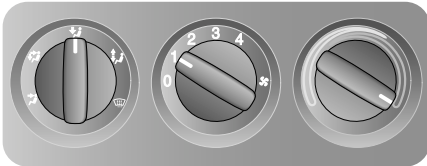

H5065

Petrol engine vehicles: Set the controls as shown, with the blower at the slowest speed (position 1) until the temperature gauge indicates that the engine is warming up - the blower speed can then be increased.

Diesel engine vehicles: Set the controls as shown, but with the blower set to **position 3** until the temperature gauge indicates that the engine is warming up - the blower speed can then be increased if required.

Demisting

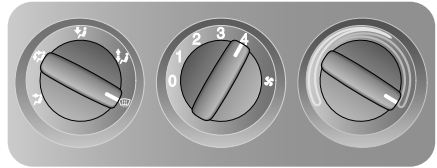

H5066

Set the controls as shown, to obtain the maximum flow of heated air from the windscreen and side window vents. Selection of air conditioning* will also assist in demisting.

On vehicles NOT equipped with air conditioning, opening a window may improve ventilation.

Defrosting

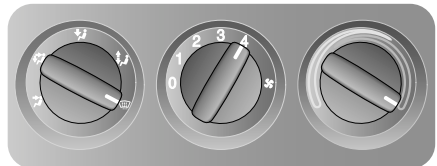
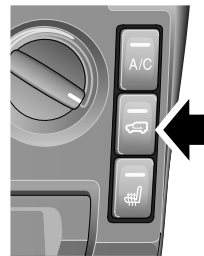

H5067

Set the controls as shown and switch on air recirculation to prevent cold air from being drawn into the vehicle. Turn air recirculation off as soon as the windscreen is clear, to prevent any possibility of the windscreen misting.

Heating & Ventilation

Maximum ventilation

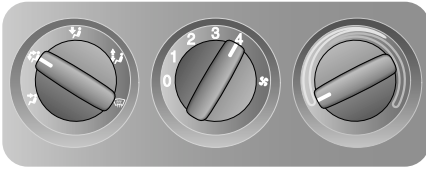

H5069

Set the controls as shown, with the face level vents open. Adjust the blower speed as required.

PTC Heater (Diesel only)

The PTC (Positive Temperature Coefficient) heater is a supplementary heating system that compensates for the relatively low coolant temperatures inherent in the diesel engine.

The PTC heater operates while the engine is running or for a limited time if the ignition is switched on without starting the engine. When the heater blower is selected and the temperature control is turned to the warm/hot range, the PTC heater activates and boosts the air temperature within the vehicle.

NOTE: On vehicles with manual transmission, engine speed may increase when idling, to further enhance the performance of the heater.

Fuel Burning Heater (Diesel only)*

The Fuel Burning Heater (FBH) is an auxiliary heating system that only operates while the engine is running and the ambient temperature is less than 5° C (41° F). At low temperatures, the FBH system maintains the temperature range required for optimum heating within the vehicle. Operation is fully automatic, with no intervention required by the driver.

NOTE: Exhaust emissions from the FBH may be noticed from the front left hand side of the vehicle.

FACE LEVEL VENTS

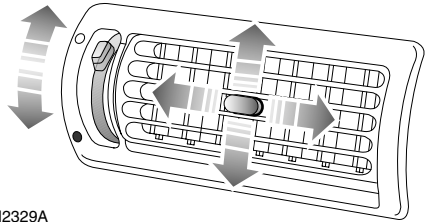

H2329A

Rotate the thumbwheel down to open or up to close the vents. Direct the air flow by moving the control in the centre of the louvres up or down, or from side to side.

To increase output from the centre face vents, shut the outer vents.

When carrying rear seat passengers, use the outer vents for the front seat occupants and use the more powerful centre vents for the rear seat passengers.

On 3-door models, when driving with either the hard or softback removed (or folded in the case of the softback), open all the vents and turn the blower switch on - this will help prevent the ingress of poisonous exhaust fumes.

NOTE: On both 3 and 5-door models, driving with the taildoor or taildoor window open is not recommended because poisonous exhaust fumes will be drawn into the vehicle. (See 'Accommodating long loads', page 38).

Heating & Ventilation

AIR CONDITIONING*

The air conditioner provides additional cooling and also reduces humidity. This can be used to demist windows quickly in damp weather and, when used in conjunction with the heater, makes the interior of the vehicle warm and dry.

NOTE: *In high humidity conditions, slight screen misting may be experienced when the air conditioning is turned on. This is a natural occurrence for most automotive air conditioning systems; it is not a fault with the system and will clear after a few seconds, once the air conditioning is operating.*

Using the air conditioning

The air conditioning can only be used when the engine is running and with the blower switched on. For the air conditioning system to operate efficiently, all windows (and the sunroof/Targa roof) should be closed, and the air intake vents free from ice, snow, leaves and other debris. DO NOT operate the air conditioning with the softback opened, or the hardback removed.

With the engine running, press the 'A/C' button and adjust the air distribution, blower and air temperature controls as required.

NOTE: *The air conditioner will automatically operate when the air distribution control is set to 'All air to windscreen' or 'Air to foot outlets and windscreen', see '4. Air distribution control', page 77.*

Operation of the air conditioning system places an extra load on the engine. In very hot conditions or when the engine is required to work unusually hard (climbing long hills or driving in congested traffic, for example), this could result in high engine temperatures. If the pointer nears the RED zone of the temperature gauge, temporarily turn the air conditioning off until engine temperatures return to normal.

NOTE: *Under extreme conditions, the air conditioning may automatically switch off, to prevent damage to the engine.*

Rapid cooling:

With the engine running press the 'A/C' button, turn the air temperature control to the BLUE segment, select air recirculation and turn the blower switch to '4'. Turn the air distribution control to the face vent setting and fully open all four face level vents. Turn off air recirculation and adjust the blower when the vehicle interior is cool.

NOTE: *In very hot conditions, it may be advisable to fully ventilate the vehicle by opening the windows and sunroof for a while before closing them again and operating the air conditioning.*

Maintaining the air conditioning

The air conditioning system is sealed and major maintenance should only be carried out by a qualified technician. To maintain the system in peak condition, owners should ensure that the system is operated for a short period every week (even during the cold winter months); with the engine at its normal operating temperature, run the air conditioning for at least ten minutes whilst driving at a steady speed.

Surplus water produced by the dehumidifying process is expelled from the system via drain tubes beneath the vehicle. This may result in a small pool of water forming on the road when the vehicle is stationary and is not a cause for concern.

Interior Equipment

COURTESY & MAP READING LIGHTS (5-door models)

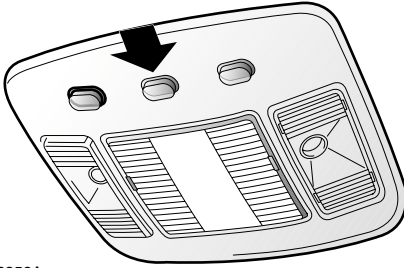

H2352A

Front courtesy and map reading lights

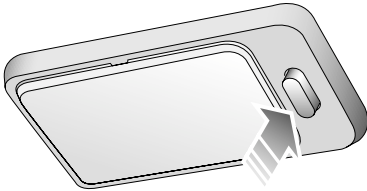

H2593

Rear courtesy light

Press the appropriate switch to illuminate (or extinguish) the lights manually.

The front and rear lights illuminate automatically when the vehicle is unlocked or whenever a door or taildoor is opened, and extinguish approximately 15 seconds after ALL the doors are closed, or as soon as the starter switch is turned on.

If a door or the taildoor remains open for ten minutes or more, a 'time out' function will extinguish the courtesy lights in order to prevent the battery from discharging.

NOTE: *If the map reading lights or rear courtesy light are left on after being manually selected, they will NOT extinguish automatically.*

The courtesy lights will extinguish when the vehicle is locked.

COURTESY LIGHT (3-door models)

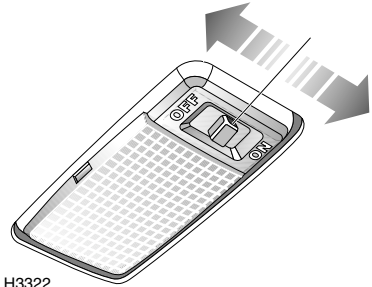

H3322

Switch positions:

- 'OFF' - Light permanently off.
- 'ON' - Light illuminates continuously.

With the switch in the centre position, the interior light illuminates automatically whenever the vehicle is unlocked or when a door or taildoor is opened. The light remains illuminated for 15 seconds after the doors and taildoor are closed, or until the starter switch is turned on.

If a door or the taildoor remains open for ten minutes or more, a 'time out' function will extinguish the courtesy lights in order to prevent the battery from discharging.

NOTE: *If the courtesy light is left on after being manually selected, it will NOT extinguish automatically.*

The courtesy lights will extinguish when the vehicle is locked.

LUGGAGE COMPARTMENT LIGHT

Illuminates automatically when the taildoor is opened.

Interior Equipment

CLOCK

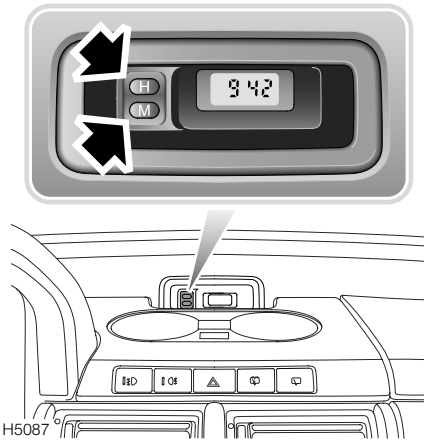

The digital clock display illuminates when the starter switch is turned on and dims for night viewing when the sidelights are switched on.

With the starter switch turned to position 'I', press the hour ('H') and minute ('M') buttons to set the time. If both buttons are pressed together, the display will change between 24 hour and 12 hour displays.

NOTE: If the battery is disconnected, the clock will need to be reset.

GLOVEBOX

WARNING

DO NOT drive with the glovebox open. An open glovebox could cause injury to the front seat passenger in the event of a collision.

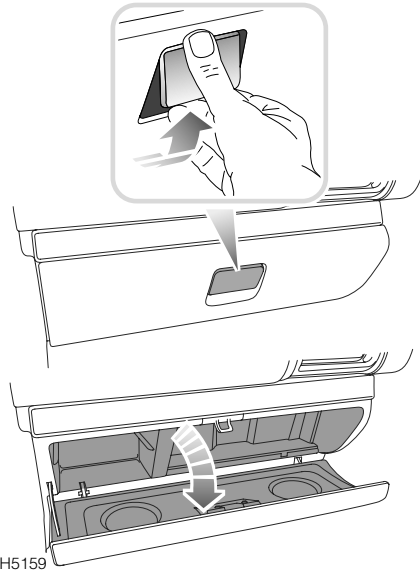

Lift the handle to open the glovebox - the two recesses in the glovebox lid can be used, when the vehicle is stationary, as cup stands.

The left hand compartment in the glovebox can be used to store CD cases.

Glovebox light

Operates automatically when the exterior lights are switched on and the passenger glovebox is opened.

Interior Equipment

DRIVER'S STORAGE AREA

WARNING

DO NOT drive with the storage area open. The storage area lid could cause serious injury in the event of a collision.

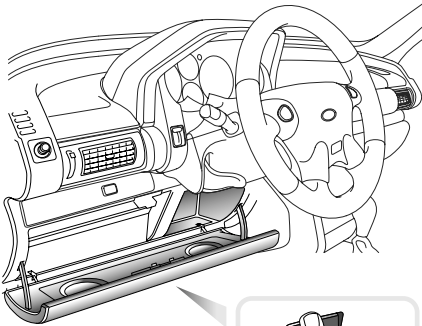

H5161

Lift the handle to open the driver's storage area - when the vehicle is stationary, the two recesses in the lid can be used as cup stands.

The right hand compartment in the storage area can be used to store tape and CD cases.

DRINKS STOWAGE

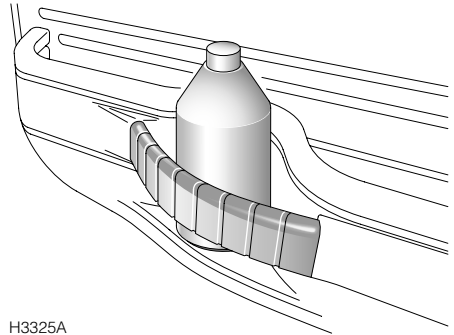

H3325A

The expanding strap fitted to the front door storage compartment on 5-door models can be used to store drink containers securely when driving.

NOTE: Drink containers over 0.5 litre capacity will not be properly secured by the strap.

WARNING

Do not use the strap to store hot drinks.

Interior Equipment

CUP HOLDERS*

WARNING

The driver should not drink and should not use the cup holder while driving.

If the cup holder is retractable, it should be kept closed when not in use.

DO NOT place anything other than suitable drinks containers in the cup holders, because such items may be thrown about in the passenger compartment and possibly injure occupants in the event of an accident or emergency manoeuvre.

Do not carry open-top drink containers in the cup holders while the vehicle is in motion; a spilled hot drink could cause personal injury. Spilled drinks can also damage upholstery, carpeting and electrical components.

Use only for soft containers. DO NOT use to hold cups made of glass, china or hard plastic, as these may cause injury in the event of an accident or emergency manoeuvre. Unopened, sealed containers (drinks cans, for example) are hard objects and may also cause injury.

Front cup holders

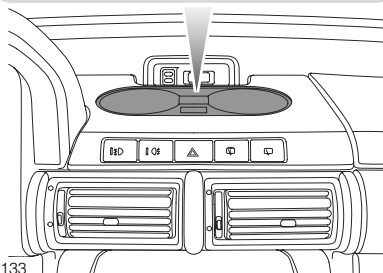
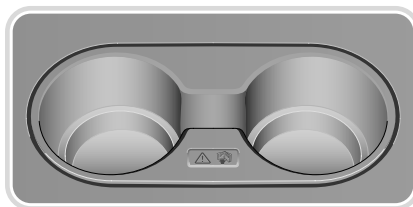

H5133

The front cup holders are located on the top surface of the fascia panel, as illustrated above.

Rear cup holders*

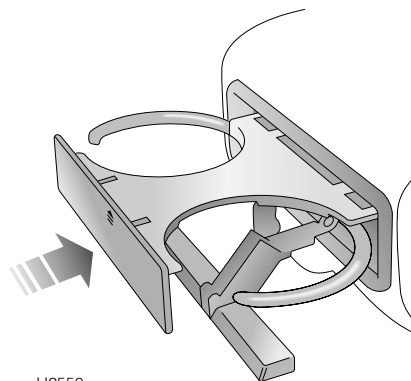

H2550

With the centre armrest lowered, press the front of the cup holder to open. The retaining arms can be adjusted to suit a range of container sizes. Press the front of the cup holder again to close.

Interior Equipment

SUN VISOR

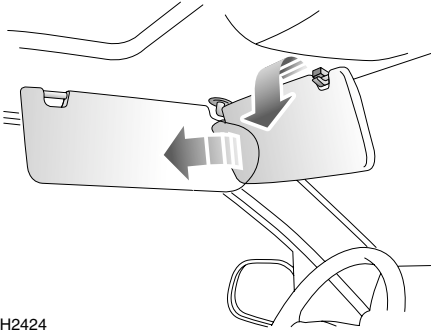

H2424

To shield your eyes from the sun, pull the visor down from the roof; the visor can be used to shield the upper part of the windscreen or the side window as required.

NOTE: On some models, the sun visors are fitted with a vanity mirror on the underside.

SUNGLASSES POCKET (3-door models)

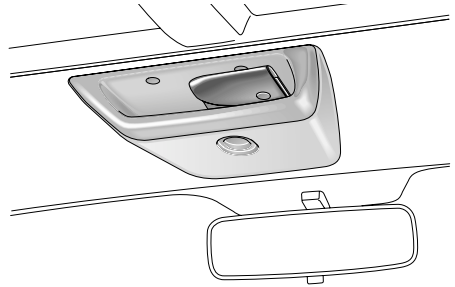

H3326

On 3-door models, there is a pocket designed to be a convenient place to stow sunglasses.

NOTE: Keep sunglasses in a soft case, to prevent scratching.

WARNING

Do not store loose items (tapes, coins etc.) in the sunglasses pocket these could become dangerous projectiles in the event of a sudden stop or collision.

Interior Equipment

ASHTRAY

WARNING

DO NOT use the ashtray for disposing of waste paper or other combustible items.

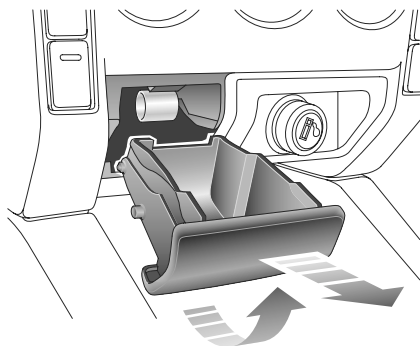

H5200

Front ashtray illustrated

Push the front to open the ashtrays. To remove for emptying; with the ashtray open, carefully pivot the ashtray upwards and withdraw it from the aperture.

To refit the ashtray, partially insert the tray into the aperture, then pivot downwards before pushing the ashtray closed.

CIGAR LIGHTER

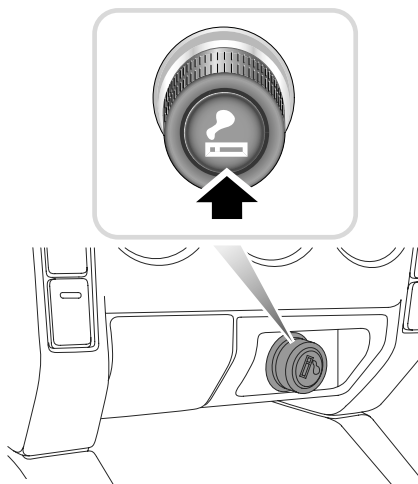

H5201

With the starter switch turned on, press the lighter in to heat up. When it has reached the correct temperature it will partially eject and can then be withdrawn for use.

- ONLY hold the cigar lighter by the handle.

WARNING

DO NOT plug accessories into the cigar lighter socket, unless they are approved for that purpose by Land Rover, as potential damage could occur to the vehicle's electrical systems.

ALWAYS ensure that driving controls are not inhibited by any accessories plugged into the cigar lighter socket.

For your safety and convenience, an auxiliary power socket may be provided in the centre console, above the rear ashtray. See 'AUXILIARY POWER SOCKET*', page 87.

Interior Equipment

AUXILIARY POWER SOCKET*

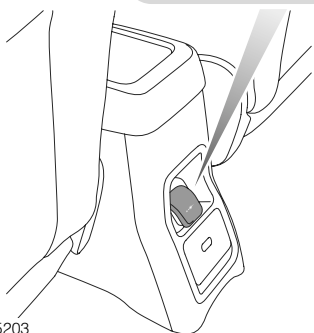
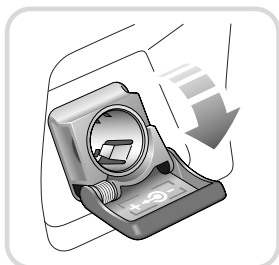

H5203

An auxiliary power socket is mounted in the centre console, above the rear ashtray. This can be used to power Land Rover approved accessories that use a maximum of 180 watts.

Always run the engine during prolonged use of electrical accessories, otherwise the battery may become discharged.

WARNING

NEVER plug non-approved accessories into the power socket - damage to the vehicle's electrical systems could occur.

Rear Door

REAR DOOR

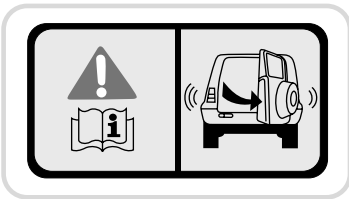
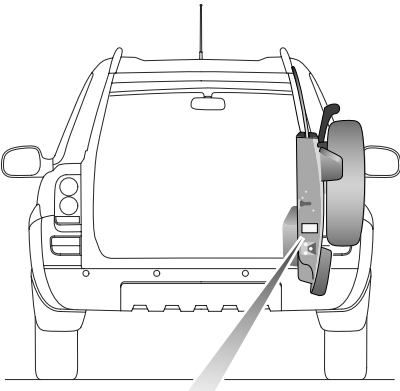

H5158

WARNING

Lights located on the same side of the vehicle as the rear door hinges will be obscured when the door is fully open.

NOTE: Owner should be mindful of and considerate to local traffic/environmental conditions.

Loadspace Cover

LOADSPACE COVER

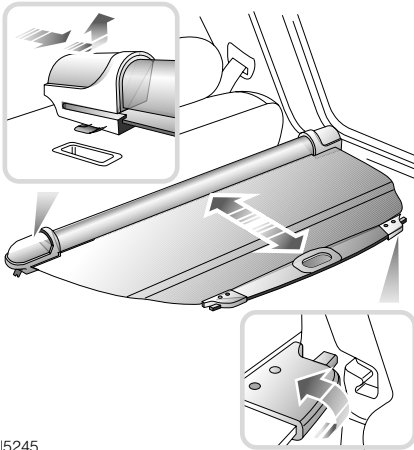

I5245

On 5-door models the rear loadspace can be covered by a spring loaded roller blind, which can be retracted when not in use by detaching the cover from the hooks at the rear of the vehicle (see lower inset).

To remove the loadspace cover:

1. Slide the retracted cover firmly to the right.
2. Lift the left hand end of the cover from its location.
3. Carefully manoeuvre the cover from the rear of the vehicle.

Refitting the loadspace cover is the reverse of the removal procedure.

NOTE: Removal of the loadspace cover may be eased by folding the rear seat backrest forward.

WARNING

DO NOT carry loose items of luggage on top of the loadspace cover - these may obscure vision and could become dangerous projectiles in the event of a sudden stop or collision.

All equipment, luggage or tools carried in the loadspace should be secured to reduce the risk of injury to the driver and passengers in the event of an accident or emergency manoeuvre.

DO NOT store the loadspace cover loose in the vehicle.

In-Car Telephones

IN-CAR TELEPHONES

A fully approved telephone package, including 'hands-free' operation and remote dialling, is available for your vehicle. Please consult your dealer for further information.

For your safety, always note the following precautions before fitting or using an in-car telephone, or any mobile communication equipment.

- Only use an installation kit incorporating an aerial external to the vehicle.
- Ensure that the installation is carried out by a competent installer.

WARNING

Using any hand-held appliance while driving can be dangerous. Always stop the vehicle before making a call and ensure the telephone is switched off while you are driving.

Audio System

AUDIO EQUIPMENT

NOTE: Full operating instructions for any audio equipment fitted as standard to your vehicle, are contained in the 'Audio System' book in the literature pack.

CD autochanger*

The CD autochanger is located under the front passenger seat. Full operating instructions are contained in the 'Audio System' book in the literature pack.

RADIO AERIAL

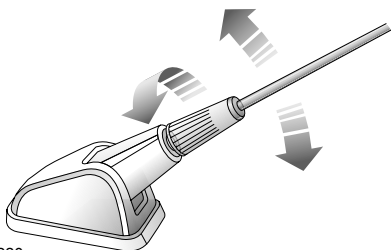

H2330

Your vehicle is equipped with a detachable mast aerial, mounted on the roof.

NOTE: ALWAYS unscrew and remove the aerial before entering an automatic car wash.

Aerial height

Always check the available headroom and, if necessary, adjust the angle of the aerial (see illustration) before entering or leaving a garage or car park with insufficient headroom.

REMOTE AUDIO CONTROLS

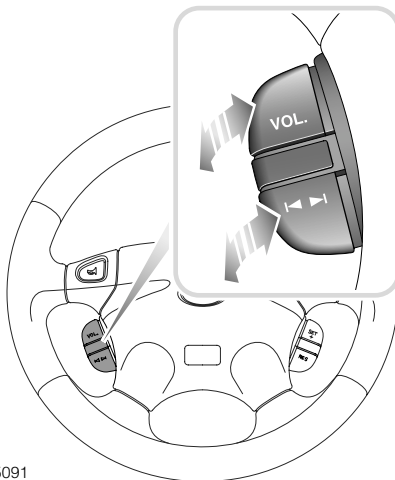

H5091

Volume control

Lift or press down to increase or decrease volume.

Search control

Lift or press down to search for the next or previous radio station on the selected waveband.

During CD play, lift the control to move forward to the next track, or press down to return to the start of the current track. Operate the control repeatedly to move forward or back through several tracks at a time.



Driving & Operating

Starting & Driving

STARTER SWITCH	95
STARTING - Petrol models	96
STARTING - Diesel models	97
DRIVING	98
FUEL ECONOMY	99
EMISSION CONTROL SYSTEM	100

Catalytic Converter

CATALYTIC CONVERTER	101
-------------------------------	-----

Fuel System

TYPE OF FUEL	103
SAFETY ON THE FORECOURT	104
FUEL FILLER	104
FUEL FILLING	104
EMPTY FUEL TANK	105
FUEL CUT-OFF SWITCH (Petrol engine vehicles only)	106

Manual Gearbox

GEAR LEVER	107
----------------------	-----

Automatic Gearbox

CommandShift® TRANSMISSION	108
GEAR SELECTOR LEVER	108
USING AN AUTOMATIC GEARBOX	111
AUTOMATICALLY SELECTED MODES	112

Hill Descent Control

HILL DESCENT CONTROL	113
--------------------------------	-----

Cruise Control

CRUISE CONTROL	116
--------------------------	-----

Brakes

FOOT BRAKE	118
HANDBRAKE	119
ANTI-LOCK BRAKES	120

Traction Control

ELECTRONIC TRACTION CONTROL	122
---------------------------------------	-----

Parking Aid System

USING THE PARKING AID SYSTEM	123
--	-----

Targa Roof

TARGA ROOF 125

Softback

FOLDING AND UNFOLDING THE SOFTBACK . . 127

Hardback

REMOVING AND FITTING THE HARDBACK . . . 138

Fitting 140

Roof Bars

REMOVING AND FITTING THE ROOF BARS . . . 142

Taildoor

OPENING AND CLOSING 145

Load Carrying

LOADSPACE SIDE POCKETS 146

LUGGAGE ANCHOR POINTS..... 146

STOWAGE BOX..... 146

VEHICLE LOADING..... 147

ROOF RACK 147

Towing

TOWING 149

TOW BARS 151