

# Telephone

---

## GENERAL INFORMATION

### WARNINGS



Using the telephone near the car: do not telephone inside a garage or near an open car bonnet. The air may contain fuel vapours and the telephone could produce sparks and start a fire.



Unusual ambient conditions: Switch off the telephone in areas where high explosives are being used. High frequency remote controls could be interfered with and cause an explosion. Switch off your telephone in areas with a high explosion risk. This includes filling stations, fuel storage areas or chemical factories, as well as places where the air contains fuel vapour, chemicals or metal dust. The telephone might possibly produce sparks and cause a fire or explosion.



Medical equipment: The functioning of cardiac pacemakers or hearing aids may be impaired when the phone is in use. Check with a doctor or manufacturer whether any such devices you or your passengers are using are sufficiently protected against high-frequency energy.



Always stow your mobile phone securely. In an accident loose items can cause injury.

**Note:** The vehicle's Bluetooth telephone system can be used with an appropriate Bluetooth-equipped mobile telephone.

**Note:** Please refer to your Land Rover Dealer/Authorised Repairer for a list of compatible telephones.

### Telephone networks

The Telephone network standard allows you to use your telephone in many countries.

However, telephone reception may be poor or unavailable in remote regions. This may be due to the inadequate power of the transmitter, which results in a weak signal or incomplete coverage.

---

**Note:** The vehicle telephone system is designed to function with a wide variety of Bluetooth telephones. As these telephones have a wide range of audio and echo performance characteristics, it may take a few seconds for the vehicle telephone system to adapt and deliver optimum audio performance. It may be necessary to reduce the in-vehicle volume slightly to fully optimise audio performance and reduce echo.

# Telephone

## TELEPHONE CONTROLS

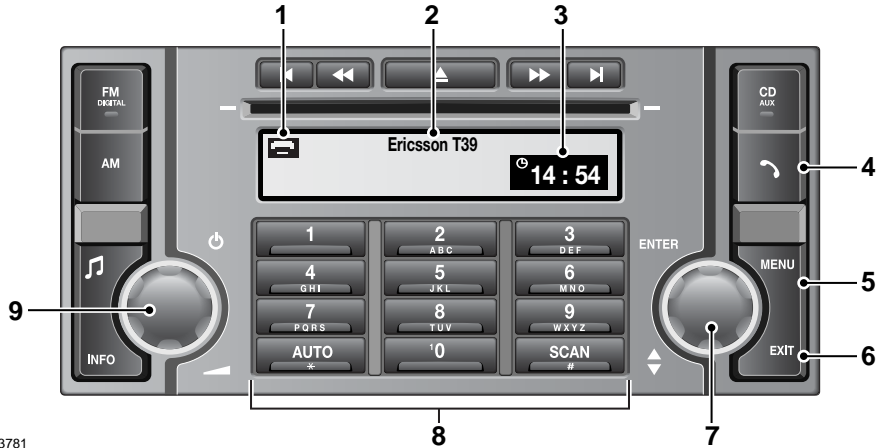

E83781

1. Call status icon
  - Indicates whether the telephone is in use.
2. Paired telephone name
  - The name of the telephone which is paired to the vehicle system.
3. Clock
4. Telephone mode button
  - Press to enable operation of telephone. (Press and hold to switch telephone operation off).
5. **MENU** button
  - Press to enter the telephone main menu.
6. **EXIT** button
  - Press to exit a menu or to delete entered numbers.
7. **ENTER** button
  - Rotate to select menu options. Press to confirm selections.
8. Keypad
  - Use to enter numbers. Also used to select phonebook letters.
9. On or off or volume button
  - Rotate (when in Ring Volume menu) to adjust the ring volume.

# Telephone

## Telephone controls - Steering wheel

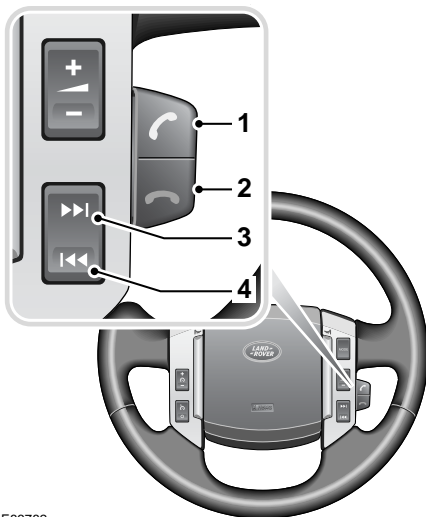

E83782

1. Answer call or dial switch
  - Pull the switch towards the steering wheel to answer an incoming call, or to view the list of the last 10 dialed numbers (if the audio unit is in telephone mode). A second pull of the switch will dial the highlighted number. Pull and hold the switch (for approximately two seconds) to activate voice tag dialling. See **TELEPHONE VOICE CONTROL** (page 261).
2. End or reject call switch
  - Pull the switch towards the steering wheel to end the current call or reject an incoming call.
3. Menu next button
  - Press to scroll down through a menu.
4. Menu previous button
  - Press to scroll up through a menu.
5. To leave the menu press the **EXIT** button.

## BLUETOOTH SETUP

Before you can use your telephone with your vehicle it must be paired to the vehicle telephone system.

When pairing a Bluetooth telephone with the vehicle system make sure that the telephone is switched on, Bluetooth is enabled and discoverable, its battery is fully charged and the telephone User's Handbook is available.

**Note:** A maximum of five pairings can be made to the vehicle, but only one telephone can be used at any time.

## Pairing and Docking using your mobile phone

Follow the steps below to pair and dock your phone with the vehicle using your mobile phone.

**Note:** The process of pairing and docking your phone with the vehicle using your mobile phone will vary depending on the type of mobile phone used. See your phone's operating instructions for further information.

1. Ensure that the ignition is on and the audio unit display is active.
2. Ensure that there is no phone currently docked with the vehicle's Bluetooth system. If a phone is docked with the system, you will not be able to pair and dock another phone until the current phone has been undocked.
3. Using the mobile phone, search for Bluetooth devices.
4. When the vehicle's Bluetooth phone system is discovered, your mobile phone will list **Land Rover** as a Bluetooth device. Select this device from the list.

# Telephone

5. You will now be requested to enter a Bluetooth PIN on your mobile phone. When pairing and docking from your mobile phone, this number is always **2121**.

Once your phone is paired to the vehicle's Bluetooth system, it can connect automatically. If the phone does not automatically connect, you will have to connect manually with the Land Rover Bluetooth System via your mobile phone. Please consult the mobile phone's operating instructions for further information.

Alternatively, you can pair and dock your phone with the vehicle using the vehicle's audio display unit. Please refer to the main owner's handbook section; Pairing a Telephone to the System.

**Note:** *You do not need to manually pair and dock the phone with the vehicle every time you switch the ignition on.*

The Bluetooth system supports Hands Free Profile 1.5 (HFP1.5). If the mobile phone paired to the system also supports this profile, additional features will be available such as signal strength and network operator. If the mobile phone does not support these features, they will not be available on the audio unit display. However, you can refer to the mobile phone's display to determine these items.

Please refer to the Land Rover website at <http://www.landrover.com/us/en/owners/about/bluetooth.htm> for a list of compatible telephones.

## Adding or changing a telephone

1. Select the telephone main menu. See **TELEPHONE SETUP** (page 249).
2. Select **Bluetooth**, then select the option to **change a telephone**.
3. **Add new phone** will appear at the top of the list. Repeat the procedure for pairing a telephone to the system.

If the maximum number of telephones are already paired to the system, a message will be displayed and you are given the option to remove one. This must be carried out before a new telephone can be paired.

## Removing a telephone from the system

1. Select the telephone main menu. See **TELEPHONE SETUP** (page 249).
2. Select **Bluetooth**, then select the option to **remove a telephone**.
3. Select a telephone by rotating the **ENTER** button, highlight the telephone to be removed then press the **ENTER** button. A confirmation message to remove a telephone will appear on the audio unit display, press the **ENTER** button.
4. The **remove telephone** screen will be displayed, and if no further telephones are to be removed, press the **EXIT** button.

## Loss of Bluetooth link

If the link between the telephone and the vehicle is lost, you have the choice to reconnect or to exit from the telephone system. To reconnect press the **ENTER** button. There will be a short delay whilst the connection is established and then your telephone name will be shown in the display.

Alternatively, press the **EXIT** button if you do not wish to reconnect your telephone.

### Mobile phone compatibility

Not all phones are fully compatible with the Land Rover system. For the latest list of compatible phones and software versions, please refer to <http://www.landrover.com/us/en/owners/about/bluetooth.htm>

Alternatively consult your Land Rover Dealer.

# Telephone

**Note:** The use of unapproved phones may cause unexpected effects during calls. The effects may include loss of audio and phone lock up.

## TELEPHONE SETUP

### Telephone main menu



E83808

Press the **MENU** button then rotate the **ENTER** button to select from:

- Missed calls
- Received calls
- Dialled calls
- Phonebook
  - See **PHONEBOOK** (page 257).
- Bluetooth
  - See **BLUETOOTH SETUP** (page 247).
- Phone settings

- Clock
  - See **CLOCK** (page 98).

Press the **ENTER** button to confirm your selection.

### Missed calls

The audio unit display will list the numbers of the last 10 calls which have been missed. These are displayed in chronological order, with the last number missed first and highlighted.

**Note:** Some mobile telephones reverse the missed call list, which results in the last missed call number being at the bottom of the list, rather than the top.

Rotate the **ENTER** button to select the number, then press again or operate the answer call switch on the steering wheel to dial the number.

If there are no entries, an empty list is shown, press **EXIT** to return to the phone view.

**Note:** When viewing missed calls, do not rotate the volume button as this will result in your highlighted selection returning to the first entry in the list, irrespective of your previously highlighted position.

### Received calls

The audio unit display will list the numbers of the last 10 calls which have been received. These are displayed in chronological order, with the last number received first and highlighted.

**Note:** Some mobile telephones reverse the received call list, which results in the last received call number being at the bottom of the list, rather than the top.

Rotate the **ENTER** button to select the number, then press again or operate the answer call switch on the steering wheel to dial the number.

# Telephone

If there are no entries, an empty list is shown, press **EXIT** to return to the phone view.

**Note:** When viewing received calls, do not rotate the volume button as this will result in your highlighted selection returning to the first entry in the list, irrespective of your previously highlighted position.

## Dialled calls

The audio unit display will list the numbers of the last 10 calls which have been dialled. These are displayed in chronological order, with the last number dialled first and highlighted.

**Note:** Some mobile telephones reverse the dialled call list, which results in the last dialled call number being at the bottom of the list, rather than the top.

The dialled calls list can also be accessed by pressing the **ENTER** button, when telephone mode is selected.

Rotate the **ENTER** button to select the number. Then to dial the number, press **ENTER** again, or operate the answer call switch on the steering wheel.

If there are no entries, an empty list is shown, press **EXIT** to return to the phone view.

**Note:** When viewing dialled calls, do not press the volume button as this will take you back to the radio or CD.

## Phone settings

Select **Call options** from the **Phone Settings** menu, and press the **ENTER** button.

## Call options

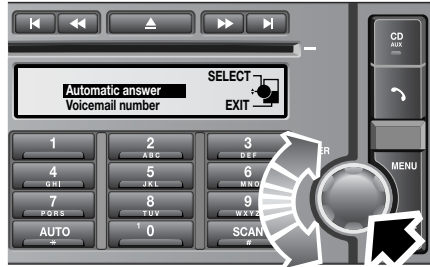

E83809

This feature is used to turn the automatic answer facility on or off and also to enter the voice mail number.

Rotate the **ENTER** button to highlight **Automatic answer** and press the **ENTER** button. Select **On** and press the **ENTER** button again.

When automatic answer is on, all incoming calls are answered automatically and when the mode is off you must accept the call or press **EXIT** to reject.

To enter a voice mail number, rotate the **ENTER** button to highlight **Voicemail number** and press the **ENTER** button. Enter your voice mail number on the keypad and press the **ENTER** button again.

Use the **EXIT** button to delete an incorrect number.

# Telephone

## Sounds and alerts



E83810

Selecting sounds and alerts gives you the choice to alter the ring tone and the ring volume.

This only applies to the **Car ring tones**. If **Mobile ring tone** is selected, no ring tone will be played. When **Mobile ring tone** has been selected, the volume can only be changed when there is an incoming call, i.e. ringing.

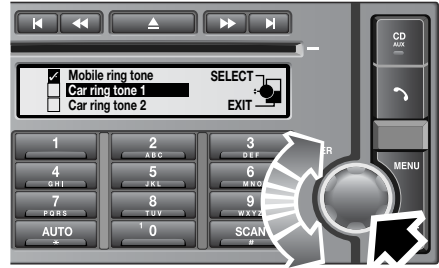

E83812

Select ring tone by rotating the **ENTER** button to highlight **Ring tone** and then press the **ENTER** button to select. Rotate the **ENTER** button to select one of the four alternative ring tones, or use the mobile telephone ring tone. Once you have selected a ring tone, press the **ENTER** button to hear the selected ring tone.

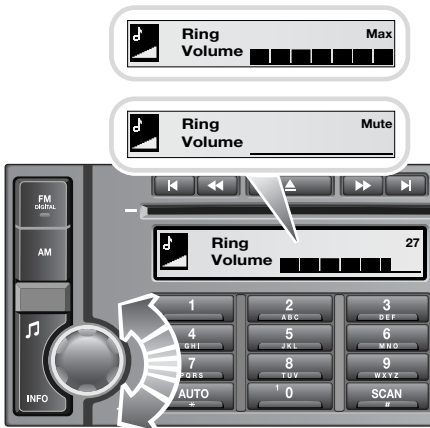

E83811

To select the ring volume, rotate the **ENTER** button to highlight **Ring volume** and then press the **ENTER** button to select. Now by rotating the **On or off or volume** button you can change the ring volume.

**Note:** If the ring volume is not changed, the ring tone will sound for eight seconds. If the ring volume is changed, the ring tone will return to the menu two seconds after the change has been made.

**Note:** This only applies to the **Car ring tones**. If **Mobile ring tone** is selected, no ring tone will be played. When **Mobile ring tone** has been selected, the volume can only be changed when there is an incoming call, i.e. ringing.

# Telephone

Another brief press of the **ENTER** button will store the tone. If you press the **EXIT** button the tone will not be stored and the ring tone menu will remain visible. Press the **EXIT** button again to return to the main menu or to the function previously selected.

**Note:** *Not all mobile telephones support **Mobile ring tone**, in this case it will not be possible to select and store the **Mobile ring tone** setting in the vehicle system.*

## Autocopy phonebook

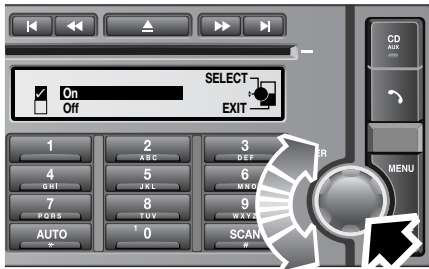

E83813

This feature allows you to choose whether or not your phone book is automatically updated every time you connect your telephone to the vehicle system. If **On** is selected and your telephone has the capability, the vehicle phone book will be updated the next time the telephone is connected to the vehicle. If **Off** is selected the phone book will not be downloaded to the vehicle system. See **PHONEBOOK** (page 257).

Press the **ENTER** button after making your selection. Pressing the **EXIT** button will return you to the previous screen. To return to the telephone main display, press and hold the **EXIT** button.

## USING THE TELEPHONE

### Selecting telephone mode

Switch on the ignition. If your telephone is switched on and previously paired or connected with the system, you can select the vehicle telephone system.



E83788

Briefly press the telephone mode button (arrowed). Visual confirmation of telephone operation is given via the display.

If a telephone is not paired to your vehicle system, **No paired Phone** and **Do you want to pair?** is displayed. See **BLUETOOTH SETUP** (page 247).

To exit telephone mode, press one of the audio system mode buttons, i.e. **FM**, **AM** or **CD or AUX**.

To turn off the telephone system, press and hold the telephone button on the audio unit.



# Telephone

## Telephone display

There are four different call status screens:

### No call



E83789

### Dialling

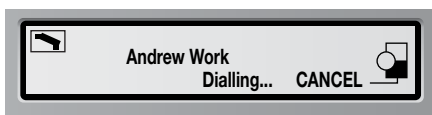

E83790

### Incoming call

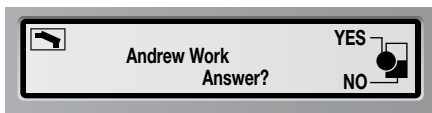

E83791

### Call in progress

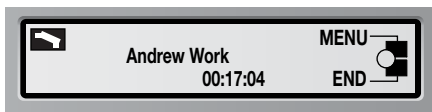

E83792

## Dialling a number manually

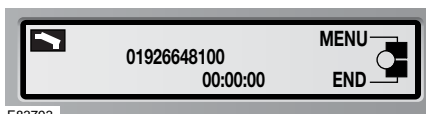

E83793

Enter the telephone number to be dialled, using the vehicle keypad. The digits of the number appear in the display.

To pause during number entry, press and hold the **AUTO** key. A \* symbol will appear in the display.

The international dial symbol + can be entered by pressing and holding the **0** (zero) key.

When the telephone number has been entered, briefly press the **ENTER** button or operate the answer call switch on the steering wheel to dial the number (**Dialling** appears in the display supported by ringing tones). A successful connection is shown on the display.

# Telephone

**Note:** To cancel a call at any time, press the **EXIT** button or operate the end call button on the steering wheel.

## Correcting or deleting numbers



E83795

If an incorrect digit is entered, press the **EXIT** button (arrowed) to delete the last digit, then enter the correct digit.

Press and hold the **EXIT** button (for approximately two seconds) to delete all entered digits.

## Multiple choice dialling

If the number you have dialled has an automated voice that requests another number, for a different area or department, use the keypad to enter that number.

## Last number redial

The last number dialled can be redialled using the answer call switch on the steering wheel. If telephone mode is active, pull and release the switch. The number will appear in the audio unit display. Pull and release the answer call switch for a second time and the number will be dialled.

If telephone mode is not active, press the telephone mode button to enter telephone mode.

**Note:** Some mobile telephones reverse the last dialled number list, which results in the last dialled number being at the bottom of the list, rather than the top.

## Ending telephone calls

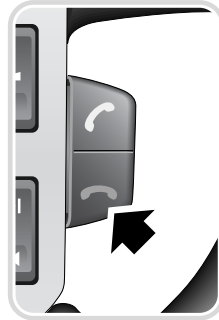

E83796

To end a telephone call, press the **EXIT** button or operate the end call switch on the steering wheel.

# Telephone

## Receiving telephone calls



When a call is received, the number or caller ID (if entered into the phone book) will appear in the audio unit display.

If the audio or a CD was in use before the telephone call then that function will resume at the end of the phone call. A CD will continue playing from the point at which it was paused by the telephone call. The telephone display will be visible for the duration of the call.

The call can be answered in two ways:

- Operate the answer call switch on the steering wheel (arrowed in inset).
- Briefly press the **ENTER** button (arrowed).



If automatic answer is switched on, the call is accepted automatically. If automatic answer is switched off, and you do nothing, the vehicle system will operate as your mobile telephone would operate, i.e. go to voice mail or continue ringing.

**Note:** The automatic answer feature can be switched on or off. See **TELEPHONE SETUP** (page 249).

When the call is accepted, the display shows that the call is in progress and the duration of the call in minutes and seconds.

### Rejecting an incoming call

To reject a call without answering, briefly press the **EXIT** button or operate the end call switch on the steering wheel.

# Telephone

## Telephone in-call menu

A number of settings can be made while a call is in progress. These are:

- muting the call
- privacy call
- accessing the phonebook.

When the call is ended the in-call settings return to their default values.

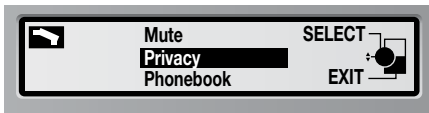
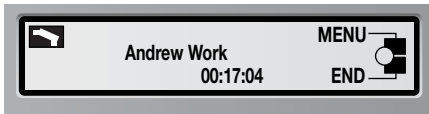

E83801

To enter the in-call menu, press the **MENU** button and then rotate the **ENTER** button to highlight the required option. Press the **ENTER** button to select.

## Mute the call

Select **Mute** and press the **ENTER** button, this will prevent the caller from hearing any conversation in the vehicle.

Select **Mute Off** and press the **ENTER** button to resume your telephone conversation.

## Privacy mode

Select **Privacy** and press the **ENTER** button, this will transfer the call to the mobile telephone preventing the vehicle occupants from listening in to your received conversation.

Select **Hands Free** and press the **ENTER** button when you wish to return to using the vehicle system.

***Note:** Some mobile telephones may end the call or lose the Bluetooth connection when transferring between Privacy and Hands Free modes.*

## Phone book

You can access your phone book during a telephone conversation if you need to find a particular number.

Select **Phonebook** and press the **ENTER** button.

Press the **EXIT** button to return to your telephone conversation.

# Telephone

## Voice mail

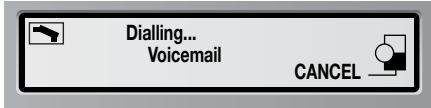
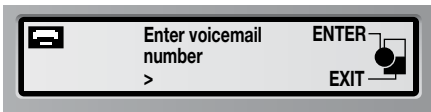
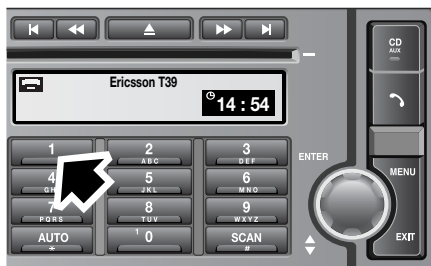

E83803

Voice mail may be set up by your service provider and can be used by the vehicle system.

Before voice mail can be used in the vehicle system, the voice mail number needs to be entered. See **TELEPHONE SETUP** (page 249).

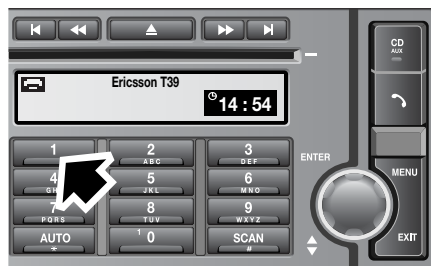

E83804

You can access your voice mail when the mobile telephone is switched on, the voice mail number has been stored in the vehicle system and the vehicle system is in telephone mode. Press and hold the number **1** key on the keypad. This will send a message to the mobile telephone to dial the voice mail number.

You can also access voice mail by using **Call options** in the **Phone Settings** menu. See **TELEPHONE SETUP** (page 249).

The audio unit display will indicate when voice mail is empty.

## PHONEBOOK

When your telephone is next connected to the vehicle and autocomp phonebook is set to **On**, your phonebook is downloaded automatically to the vehicle system, provided your telephone has the capability. See **TELEPHONE SETUP** (page 249).

**Note:** If there is a communication problem with the telephone or the telephone does not support this feature, the message **Phonebook is empty** will be displayed, and the phonebook will not be downloaded.

# Telephone

Once downloaded, the phonebook can be accessed through the telephone main menu.

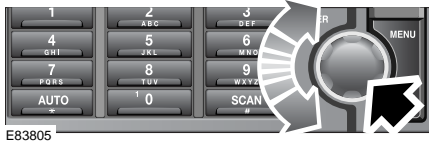
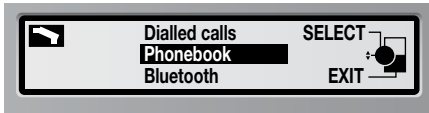

E83805

1. Press the **MENU** button to access the telephone main menu.
2. Rotate the **ENTER** button to highlight **Phonebook** and press the **ENTER** button again to select.

**Note:** To exit the phonebook without selecting an entry, press the **EXIT** button.

## Phonebook menu

Rotate the **ENTER** button to select one of the following options:

- Search Phonebook
- Copy from Phone
- Erase car entry
- Erase car Ph.book

Press **ENTER** to confirm your selection.

## Search Phonebook

**Note:** When viewing the phonebook, do not rotate the volume button as this will result in your highlighted selection returning to the first entry in the phonebook, irrespective of your previously highlighted position.

The following methods can be used to search the phonebook:

- browsing
- alphabetic search
- quick search

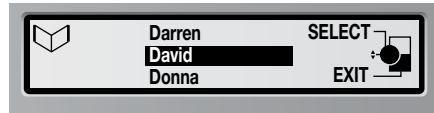

E83806

## Browsing the phonebook

1. With phonebook displayed, rotate the **ENTER** button clockwise, or operate the menu next button on the steering wheel to scroll down the phonebook. To scroll up the phonebook, rotate the **ENTER** button counterclockwise or press the menu previous button on the steering wheel.
2. Once the chosen phonebook entry is highlighted, press the **ENTER** button, or operate the answer call switch on the steering wheel, to dial the number.

# Telephone

3. If an entry was selected by mistake, either operate the end call switch on the steering wheel, or press the **EXIT** button to cancel dialling.



E83807

2. If there are a large number of entries beginning with the letter **H**, the second and subsequent characters of the name can be added by repeatedly pressing the relevant key until the character appears in the audio unit display.
  - For example; if the required phonebook entry is **Helen**, press the **4** key on the keypad twice the **2** key on the keypad twice, and the **5** key on the keypad three times. The display will now show all entries beginning with **Hel**.
3. Once the chosen phonebook entry is highlighted, press the **ENTER** button, or operate the answer call switch on the steering wheel, to dial the number.

## Alphabetical search

1. With the phonebook displayed, press the appropriate key the corresponding number of times according to the initial letter of the entry.
  - For example; if the initial letter of the required phonebook entry is **H**, press the **4** key on the keypad twice. The display will now show all entries beginning with the letter **H**.

# Telephone

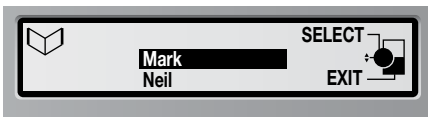

E83840

## Quick search

1. To find a specific number from your phonebook without accessing the phonebook, while in telephone mode, press and hold a key (between **2-9**) which corresponds to the first letter of the name.
  - For example; if the initial letter of the required phonebook entry is an **M**, press and hold the **6** key of the keypad. The phonebook will open at the selected point.
2. If there are a large number of entries beginning with letter **M**, the second and subsequent characters of the name can be added by repeatedly pressing the relevant key until the character appears in the audio unit display.
  - For example; if the required phonebook entry is **Mark**, press the **2** key on the keypad once and the **7** key on the keypad three times. The display will now show all entries beginning with **Mar**.

3. Once the chosen phonebook entry is highlighted, press the **ENTER** button, or operate the answer call switch on the steering wheel to dial the number.

## Copy from phone

If the phonebook in the vehicle system does not match that of the mobile telephone (and your mobile telephone supports this feature), the following procedure will allow you to resynchronise.

***Note:** The vehicle system phonebook allows 750 entries to be downloaded. If your mobile telephone contains more than this, the mobile telephone will send these in memory location order. Which means that your telephone phonebook may not always match the vehicle system.*

1. Enter the phonebook menu and select **Copy from Ph. book**. Press the **ENTER** button to confirm.
2. If successful, **Phonebook downloading to the car is in progress** will appear on the display.
3. On completion of the download, the display will return to the telephone main menu.

If the phonebook download is not supported, the message **Phonebook download is not supported by this phone** will appear in the display.

## Erase car entry

Once a phonebook has been downloaded, individual entries can be erased from the vehicle system, not from the mobile telephone.

***Note:** If Autocopy phonebook is switched on, the next time the telephone is connected to the vehicle system, the mobile telephone's phonebook will be sent to the vehicle. This may result in your previously deleted entry being re-instated in the vehicle system phonebook.*



# Telephone

1. Enter the phonebook menu and select **Erase car entry**.
2. Press the **ENTER** button to confirm.
3. Rotate the **ENTER** button to select the entry you wish to erase and press the **ENTER** button.
4. A confirmation message will appear on the display. Press the **ENTER** button to erase the entry or press the **EXIT** button to retain the entry and return to the menu.

## Erase car Ph. book

Once a phonebook has been downloaded, it can be erased from the vehicle system, not from the mobile telephone.

**Note:** If Autocopy phonebook is switched on, the next time the telephone is connected to the vehicle system, the mobile telephone's phonebook will be sent to the vehicle. This may result in your previously deleted phonebook being re-instated in the vehicle system.

1. Enter the phonebook menu and select **Erase car Ph. book**. Press the **ENTER** button.
2. A confirmation message will appear on the display. Press the **ENTER** button to erase the phonebook or press the **EXIT** button to retain the phonebook and return to the menu.

## TELEPHONE VOICE CONTROL

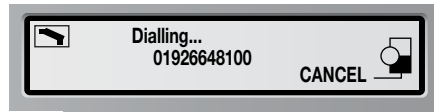

E83802

The vehicle system is able to use any voice tags which are stored in the mobile telephone.

**Note:** Voice tags are stored via the mobile telephone and should be set up without the mobile telephone connected to the vehicle.

1. Press and hold the **ENTER** button, or pull and hold the answer call switch on the steering wheel to access voice tag dialling.
2. The phone display will show that voice tag dialling is in progress and, after an audible prompt from your mobile telephone, you should recite the name that you want to call.
3. A message on the audio unit display will confirm your voice tag and the number is then dialled.
4. If the name you requested is not recognised then you will be informed.
5. Press the **EXIT** button to cancel voice tag dialling.



# Index

## A

ABS driving hints	110
Accessories	31
Adaptive front lighting system (AFS)	64
Adjusting the steering wheel	60
Adjusting the windshield washer jets	80
Blocked jets	80
Front	80
Rear	80
AFS	64
Air bag service information	54
Air bag warning lamp	53
Air vents	95
Alternative frequencies	218
	218
Approach lamps	65
Arming the alarm	38
Alarm indicator	38
Ashtray	99
Audio control	60, 215
Audio control using the telephone buttons	61
Balance adjustment	215
Bass response adjustment	215
Centre speaker settings	216
Fader adjustment	216
Resetting tone values	216
Subwoofer settings	216
Surround sound settings	215
Treble response adjustment	215
Audio unit overview	213
Audio overview	213
Basic audio functions	214
Automatic climate control	13, 92
Controls	13, 92
Automatic transmission	106
Automatic mode	106
Electronic gear change strategies	108
Sport mode and CommandShift™	107
Autostore control	216
	216
Auxiliary input (AUX IN) socket	241
Auxiliary mode	242
Auxiliary power sockets	100

## B

Battery care	157
Battery charging	160
Battery warning symbols	157
Bluetooth setup	247
Adding or changing a telephone	248
Loss of Bluetooth link	248
Removing a telephone from the system	248
Booster cables	159
Booster cushions	57
Brake fluid check	151
Checking the fluid level	152
Topping up the fluid	152
Brakes	
Principle of operation	110
Bulb changing	66
Bulb specification chart	76
<b>C</b>	
Car wash	140
Changing a bulb	66
Front fog lamp	70
General information	66
Headlamp unit bulbs	68
High level brake lamp	73
Interior lamp bulbs	75
Number plate lamp bulb	72
Rear lamp bulbs	71
Removing the headlamp unit	67
Removing the rear lamp unit	71
Side repeater lamp	72
Changing a fuse	189
Changing a road wheel	167
Positioning the jack	169
Temporary spare wheel	170
Wheel changing safety	168
Changing the vehicle battery	160
Battery disposal	161
Disconnecting	160
Effects of disconnecting	161
Refitting	161
Replacement batteries	161

# Index

Changing the wiper blades . . . . .	81	Driving after a collision . . . . .	202
Changing the front wiper blades . . . . .	82	Before starting or driving . . . . .	202
Changing the rear wiper blades . . . . .	82	Resetting the fuel cut-off . . . . .	202
Service position . . . . .	81	When driving . . . . .	202
Charging the vehicle battery . . . . .	160	<b>E</b>	
Checking the wiper blades . . . . .	80	Economical driving . . . . .	116
Child safety locks . . . . .	59	Driving tips for economy . . . . .	116
Child seats . . . . .	55	Maintenance and fuel economy . . . . .	116
Child restraint check lists . . . . .	56	Ejecting compact discs . . . . .	237
Seat belt locking mechanism . . . . .	55	Ejecting multiple compact discs . . . . .	237
Cigar lighter . . . . .	99	Electric exterior mirrors . . . . .	85
Cleaning the alloy wheels . . . . .	140	Adjusting . . . . .	85
Cleaning the exterior . . . . .	140	Mirror dip when reversing . . . . .	85
Cleaning after off-road driving . . . . .	141	Electric seats . . . . .	40
Washing the vehicle . . . . .	140	Driving position memory . . . . .	41
Cleaning the interior . . . . .	141	Electric sunroof . . . . .	95
Airbag module covers . . . . .	142	Anti-trap mechanism . . . . .	96
Carpets and fabrics . . . . .	142	Calibration . . . . .	96
Instrument pack, clock, and audio equipment . . . . .	142	Operation . . . . .	95
Leather . . . . .	141	Sunroof blinds . . . . .	97
Plastic and cloth . . . . .	141	Electric windows . . . . .	83
Seat belts . . . . .	142	One shot operation . . . . .	83
Clock . . . . .	98	Overriding anti-trap protection . . . . .	83
Setting the clock . . . . .	98	Window isolator . . . . .	84
Compact disc display options . . . . .	238	Window reset . . . . .	84
Compact disc function menu . . . . .	238	Engine compartment overview . . . . .	147
Compact disc pause . . . . .	237	1. Engine oil filler cap (Black) . . . . .	148
Compact disc playback . . . . .	237	2. Engine oil dipstick (Yellow) . . . . .	148
Compact disc selection . . . . .	237	3. Brake fluid reservoir cap (Yellow) . . . . .	148
Compact disc track scanning . . . . .	239	4. Coolant reservoir cap (Yellow) . . . . .	148
CD scan . . . . .	239	5. Washer fluid reservoir cap (Blue) . . . . .	148
Coolant check . . . . .	150	6. Power steering fluid reservoir cap (Black) 148	
Cruise control . . . . .	117	Engine coolant check . . . . .	150
Principle of operation . . . . .	117	Checking the coolant level . . . . .	150
Cup holders . . . . .	101	Topping up the coolant . . . . .	150
<b>D</b>		Engine oil check . . . . .	148
Dimensions . . . . .	209	Checking the oil level . . . . .	148
Direction indicators . . . . .	64	Engine oil specification . . . . .	149
Disarming the alarm . . . . .	38	Topping up the oil . . . . .	149
Deactivating the alarm when triggered . . . . .	38	Engine specifications . . . . .	208
Disarming when the unlock button fails to work . . . . .	38	Essential towing checks . . . . .	139
		Event data recording . . . . .	28

# Index

## F

Fast forward/reverse . . . . .	238
Fastening the seat belts . . . . .	47
Releasing the seat belts . . . . .	47
Filling station information . . . . .	26
Engine coolant specification . . . . .	27
Engine oil specification . . . . .	27
Fuel filler flap . . . . .	26
Tire pressures . . . . .	27
Front fog lamps . . . . .	63
Fuel cut-off . . . . .	131
Resetting the fuel cut-off . . . . .	131
Fuel filler flap . . . . .	131
Fuel quality . . . . .	129
Alternative fuels . . . . .	129
Octane rating . . . . .	129
Fuse box locations . . . . .	190
Fuse specification chart	
Engine compartment fuse box . . . . .	191
Luggage compartment fuse box . . . . .	198
Passenger compartment fuse box . . . . .	195

## G

General driving points . . . . .	115
Battery charging - red . . . . .	115
Low oil pressure - red . . . . .	115
General information on radio frequencies . . . . .	35
FCC and Canadian warning statement . . . . .	35

## H

Handbrake . . . . .	111
Hazard warning flashers . . . . .	63, 201
HDC . . . . .	123
Head restraints . . . . .	42
Headlamp washers . . . . .	79
Headphones . . . . .	244
Heated mirrors . . . . .	95
Heated seats . . . . .	44
Hill descent control . . . . .	123
Hill descent control (HDC)	
Principle of operation . . . . .	123
Hints on driving with ABS . . . . .	110
ABS and off-road driving . . . . .	111
ABS warning indicator . . . . .	110
Electronic Brake Distribution (EBD) . . . . .	111
Emergency Brake Assist (EBA) . . . . .	111

Hood lock . . . . .	146
---------------------	-----

## I

Information messages . . . . .	89
Main message centre . . . . .	89
Messages . . . . .	90
Inspecting safety system components . . . . .	203
Instrument panel overview . . . . .	87
Instrument panel . . . . .	87
Interior lamps . . . . .	65
Interior mirror . . . . .	86
Auto dimming . . . . .	86

## J

Jump starting . . . . .	159
-------------------------	-----

## K

Keys . . . . .	34
----------------	----

## L

Lashing points . . . . .	205
Front . . . . .	205
Rear . . . . .	205
LATCH anchor points . . . . .	57
Installing a LATCH child restraint . . . . .	57
Tether anchorages . . . . .	58
Levelling . . . . .	137
Lighting control . . . . .	62
Daytime running lamps (Canada only) . . . . .	62
Headlamp courtesy delay . . . . .	62
Main beam . . . . .	62
Main switch panel . . . . .	62
Load carrying	
General information . . . . .	133
Loading compact discs . . . . .	236
Loading a CD . . . . .	236
Locking and unlocking . . . . .	37
Drive-away locking . . . . .	37
Locking and unlocking from inside the vehicle . . . . .	37
Mis-lock . . . . .	37
Luggage anchor points . . . . .	134
Luggage covers . . . . .	134
Fitting the luggage cover . . . . .	134
Operating the luggage cover . . . . .	135

# Index

## M

Maintenance	
General information	143
Technical specifications	155
Menu functions	229
Accessing a locked channel	234
Category search	229
Changing the PIN	235
Locking a channel	232
Sirius radio text	230
Sirius text	230
Skipping channels	232
Song seek	231
Mirrors	95
MP3 file playback	240

## O

Occupant sensing	52
Operational status indicator	53
Oil check	148
On/off control	215
Opening and closing the hood	146

## P

Parking aid	114
Principle of operation	113
Parking brake	111
Applying the parking brake	112
Parking on a slope	111
Releasing the parking brake	112
Phonebook	257
Phonebook menu	258
Power steering fluid check	153
Checking the fluid level	153
Topping up the fluid	153

Principle of operation	
Air bag deployment effects	52
Air bag operation	51
Air bags	50
Before driving off-road	123
Brake pads	110
Deployment and deflation	51
Dynamic Stability Control (DSC)	127
Introduction	49
Roll stability control (RSC)	127
Seat belt checks	46
Seat belt locking mechanism	46
Seat belt safety	45
Seat belts	45
Wet conditions	110
Priority programme type (PTY)	218
PTY search	220
PTY selection	218
Production option weights	186

# Index

## Q

Quick start	
Audio system	22
Automatic transmission	19
CD operation	24
Clock setting	24
Cruise control	20
Driving position memory	10
Engine starting	8
Exterior lighting	18
Facia	14
Gearshift interlocks	18
Hill Descent Control (HDC)	20
Hood	9
Instrument pack	15
Master lock and unlock switches	8
Overhead console	11
Parking aid	21
Passenger air bag	12
Power operated seat adjustment	9
Radio operation	23
Remote control	7
Satellite radio	23
Seat belts and child restraints	12
Steering column	11
Taildoor	9
Telephone - Bluetooth system	25
Terrain Response system	21
Warning indicators (attention)	16
Warning indicators (information)	17
Windows and door mirrors	10
Wipers and washers	17

## R

Radio broadcast data system (RBDS)	218
Radio controls	223
Radio display	225
Program Descriptive Text (PDT)	225
Radio reception	212
Rain sensor	78
Operation	78
Rear fog lamps	63
Rear seat controls	243

Rear seats	42
Folding the rear seats	43
Raising the rear seats	44
Rear window wiper and washers	79
Reversing	79
Wash/wipe	79
Wiper	79
Receiving radio broadcasts	226
Direct channel selection	228
Recalling a preset channel	227
Selecting a category	226
Selecting a channel	226
Signal availability	228
Storing channels as presets	227
Unsubscribed channels	228
Recommended towing weights	138
Reduced engine performance	115
Check engine	115
Refuelling	132
Remote control	35
Repairing minor paint damage	142
Resetting the audio unit	220
Running out of fuel	130
Running-in	115

## S

Safety	30
Safety precautions	129
Satellite radio	
General information	222
Seat belt height adjustment	47
Seat belt reminder	47
Seat belts	
Principle of operation	45
Shuffle/random	239
Random selection	239
Sitting in the correct position	39
Snow chains	182
Stability control	128
Principle of operation	127
Starting a petrol engine	105
Starting	105
Stopping the engine	105
Starting the engine	
General information	104
Station preset buttons	217

# Index

Storage compartments	102	Tire repair kit	171
Glovebox storage	103	Checking the tire pressure after a repair	175
Subscription	224	Land Rover tire repair kit	173
Sun visors	99	Land Rover tire repair kit safety information	171
Sunroof	95	Using the Land Rover tire repair kit	174
Supplementary restraints system		Tool kit	170
Principle of operation	49	Tow bar	139
<b>T</b>		Trailer hitch	139
Technical specifications		Towing a trailer	136
Accessory wheels and tires	188	Trailer electrical connection	136
Capacities	156	Towing points	204
Lubricants and fluids	155	Front and rear towing eyes	204
Transmission fluids and capacities	109	Towing the vehicle on four wheels	205
Telephone	252	Driving after towing	206
General information	245	Towing procedure	205
Telephone controls	246	TPMS	183
Telephone controls - Steering wheel	247	Track selection	237
Telephone setup	249	Traction control	126
Dialled calls	250	Traction devices	182
Missed calls	249	Transmission	
Phone settings	250	Technical specifications	109
Received calls	249	Transporting the vehicle	205
Telephone main menu	249	Trip computer	89
Telephone voice control	261	Type approvals	210
Terrain response	119	Declarations of conformity	210
Principle of operation	119	<b>U</b>	
Tire care	176	Using booster cables	159
Age degradation	177	Disconnecting the cables	159
Directional tires	178	Using cruise control	117
Flat spots	182	Engaging cruise control	117
High performance wheel and tire combinations	178	Increasing the cruise speed	118
Pressure compensation for ambient temperature changes	181	Reducing the cruise speed	118
Punctured tires	177	Suspending cruise control	117
Replacement tires	178	Using HDC	123
Steps for determining correct load limit	180	Gradient release control (GRC)	124
Tire checks	177	HDC operation	124
Tire pressures	179	Selecting HDC	123
Tire wear	176	Warning messages	125
Tire glossary	186	Using seat belts during pregnancy	48
Terms used	186		
Tire pressure monitoring system (TPMS)	183		
TPM system operation	184		



# Index

Using stability control . . . . .	128
Deactivating DSC . . . . .	128
DSC . . . . .	128
DSC system fault . . . . .	128
Reactivating DSC . . . . .	128
Using terrain response . . . . .	119
Before driving off-road . . . . .	119
Driver override options . . . . .	119
Terrain response messages . . . . .	122
Terrain Response operation . . . . .	120
Using the key . . . . .	34
Removing the cover . . . . .	34
Replacing the cover . . . . .	34
Using the parking aid . . . . .	114
PDC activation . . . . .	114
Sensor care . . . . .	114
System fault . . . . .	114
Using the remote control . . . . .	35
Approach lighting . . . . .	36
Emergency alarm . . . . .	36
Locking . . . . .	36
Remote battery . . . . .	36
Remote control . . . . .	35
Taildoor . . . . .	36
Unlocking . . . . .	36
Using the telephone . . . . .	252
Ending telephone calls . . . . .	254
Making telephone calls . . . . .	253
Receiving telephone calls . . . . .	255
Selecting telephone mode . . . . .	252
Telephone in-call menu . . . . .	256
Voice mail . . . . .	257
Using traction control . . . . .	126
Before driving off-road . . . . .	126
Electronic Traction Control (ETC) . . . . .	126
Using winter tires . . . . .	182
<b>V</b>	
Vehicle identification number (VIN) . . . . .	207
Vehicle identification plate . . . . .	207
Vents . . . . .	95
VIN . . . . .	207
Volume control . . . . .	215
Automatic Volume Control (AVC) . . . . .	215
Reset volume settings . . . . .	215

## W

Warning triangle . . . . .	201
Washer fluid check . . . . .	154
Topping up the fluid . . . . .	154
Washing . . . . .	140
Waveband button . . . . .	216
Weights . . . . .	208
Wheels and tires	
General information . . . . .	162
Technical specifications . . . . .	188
Windshield washers . . . . .	79
Windshield wipers . . . . .	77
Intermittent variable delay . . . . .	77
Speed-dependent mode . . . . .	78
Wiper operation . . . . .	77
Winter tires . . . . .	182

