

Navigation Touch Screen Care

TOUCH SCREEN CARE



ICE2073 ENG

Care points

The touch screen fitted to your vehicle, allows control of the Infotainment systems from a single point. To ensure that it continues to operate correctly, some basic care points are listed below.

- Clean only with a lightly moistened soft cloth.
- Do not use chemical agents, or domestic cleaners, to clean any part of the touch screen or its surround.

- Only use your finger to operate the touch screen. Ensure that only one finger at a time is in contact with the screen, to prevent incorrect entries.
- A short, light touch is sufficient to operate functions. Do not use excessive pressure.
- Do not allow any sharp, hard, or abrasive objects to come into contact with the screen.
- Where possible avoid exposing the touch screen to direct sunlight for long periods.

Note: None of the functions of the touch screen are operated by dragging icons from one position to another.

System Settings

SYSTEM SETTINGS

The first time the system is switched on, the home menu will be displayed. Switching the system on subsequently, will display the screen or menu that was in use when the system was switched off.

Personalising the system settings

Your vehicle is delivered with the system settings (language etc.), tailored to the market for which the vehicle is intended.

These settings can be altered to suit your preferences.



ICE1974 ENG

To access the system settings screen, press the **Driver Information** button on the screen surround.

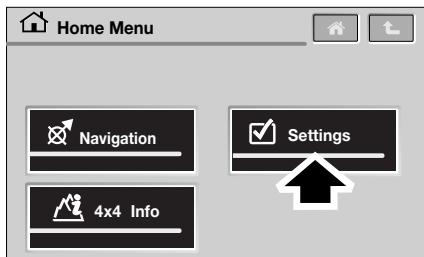

ICE1975 ENG

On the Home Menu screen, touch the **Settings** icon.

Changing the language setting

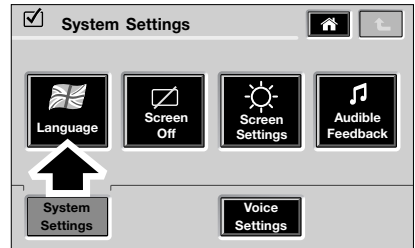

ICE1976 ENG

To change the language used by the system, touch the **Language** icon on the System Settings menu.



ICE1977 ENG

The language choices are displayed as a list. Scroll up or down through the list using the on-screen arrows. The current language will be indicated by an orange icon.

System Settings

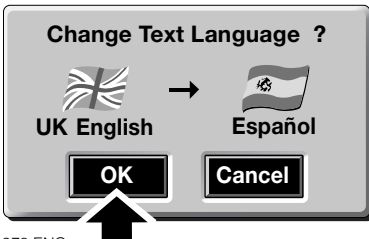

ICE1978 ENG

Touch the icon next to the language you wish to use. A pop-up menu will appear, indicating the current language, the new language and the option to cancel or accept the change.

Once your language choice has been made and you have touched the **OK** icon, the main settings screen will be displayed.

Note: If the display has been set to a language that you are unable to read, it is possible to set the system to a language of your choice by making a selection using the icon positions as shown. The country of origin for the language is indicated by the country's flag.

Audible feedback on/off

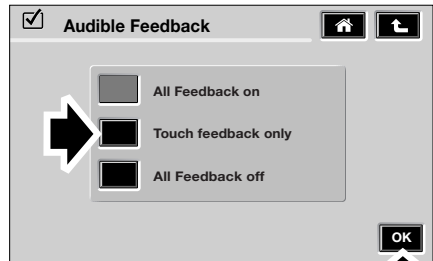
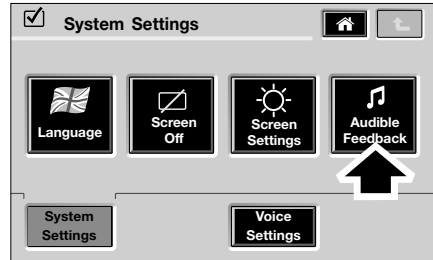

ICE1979 ENG

To change your audible feedback preferences (information messages etc.), touch the **Audible Feedback** icon on the System Settings menu.

From the Audible Feedback menu touch the **All Feedback on**, **Touch Feedback only** or **All Feedback off** icon as required, followed by the **OK** icon to confirm your choice.

System Settings

Screen settings

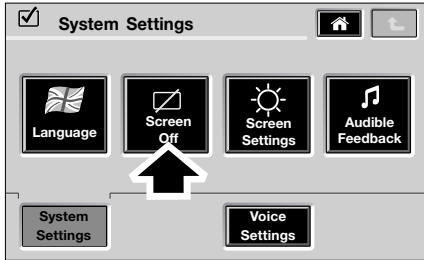

ICE1982 ENG

Occasionally, it may be preferable to turn the touch screen off - when driving at night, for example.

To turn off the touch screen display, touch the **Screen Off** icon.

To turn the touch screen display on, touch the screen at any point.

Display settings

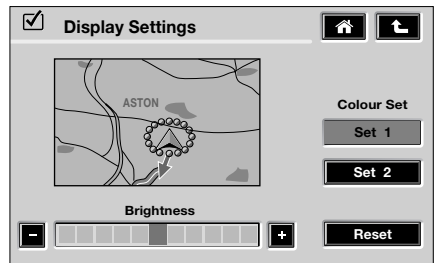
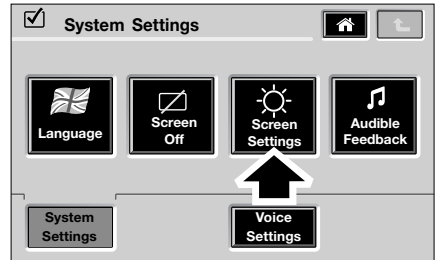

ICE2386 ENG

From the System Settings menu, touch the **Screen Settings** icon.

Note: If the map screen is not currently available then the preview screen will display **Map not available**.

Brightness is adjusted by touching the + or - icons, to increase or decrease the brightness. Touching the **Reset** icon will return the brightness control to the center position.

Two colour sets can be selected by touching either the **Set 1** or **Set 2** icons. Adjustments can be made to the brightness level for each colour set. This allows a quick change of settings with a single touch, which may be useful for day and night settings, for example.

System Settings

Voice settings

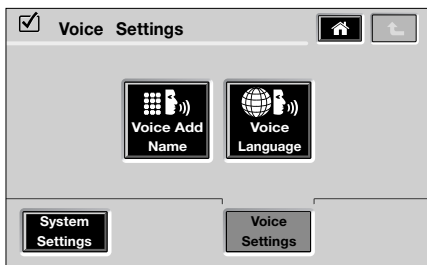
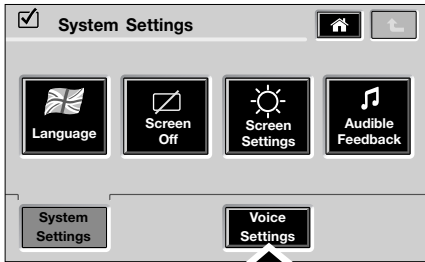

ICE1983 ENG

From the System Settings menu, touch the **Voice Settings** icon.

Voice language

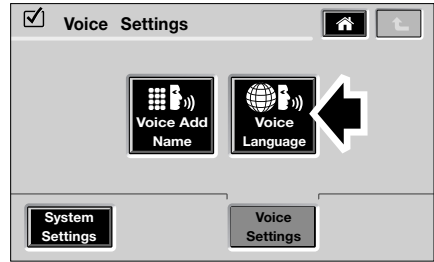

ICE1984 ENG

From the Voice Settings screen, touch the **Voice Language** icon.

It should be noted that the Voice Language icon is only available with the Extended voice option and not with Basic voice.

Touch the up and down arrows to scroll through the list of available languages.

System Settings

Select the required language by touching the relevant icon.

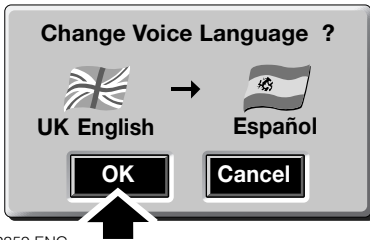

ICE2359 ENG

Touch the icon next to the language you wish to use. A pop-up menu will appear, indicating the current language, the new language and the option to cancel or accept the change.

Once your language choice has been made and you have touched the **OK** icon, the main settings screen will be displayed.

Satellite Navigation

HOW THE SYSTEM WORKS

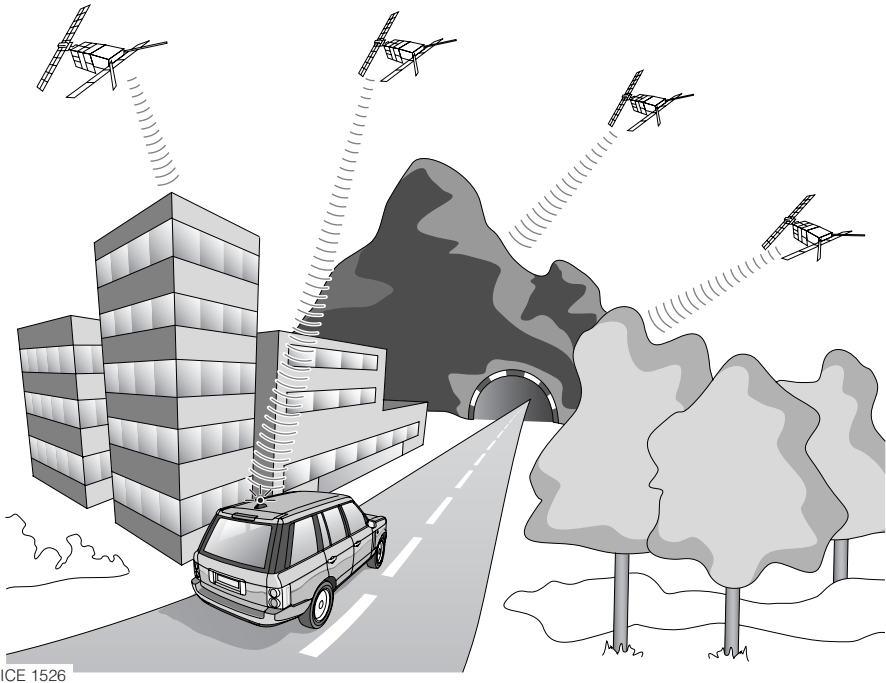

ICE 1526

The system uses signals from the Global Positioning System (GPS) satellites, which allow the approximate position of the vehicle to be calculated. This is combined with information from vehicle sensors and data from the navigation Digital Versatile Disc (DVD), to establish the true vehicle position.

The navigation computer then integrates this data with the information stored on the navigation DVD, enabling you to plan and follow a route map to your desired destination. This is particularly useful if you are travelling to or through unfamiliar territory.

Digitised area

The navigation system can only provide information and guidance for the area covered by the navigation DVD - ensure that you are using the latest version of the correct DVD for your country.

Note: Your Land Rover Retailer will have details of how to order DVD updates.

The navigation DVD provided, contains a digitised street map. Freeways, main and regional roads, as well as district roads are detailed in this street map. Larger cities and boroughs are completely covered. The regional and unclassified roads or access roads and the city center for smaller cities and boroughs are included.

Satellite Navigation

One way streets, pedestrian zones, turn bans and other traffic regulations are taken into account as far as possible. There may be discrepancies between the data on the navigation DVD and the actual local situation, due to temporary or permanent changes to road systems and their traffic regulations.

If the vehicle battery has been disconnected, or if the vehicle has been transported to a new location on another vehicle (e.g. by trailer or train), the navigation system may require several minutes to identify the new position.

Reception of GPS signals

GPS signals are highly directional and reception may occasionally be interrupted. Some examples of situations likely to cause problems are shown below:

- Inside tunnels.
- Inside buildings.
- Roads under raised highways.
- Densely tree-lined roads.
- Forest roads between mountains.
- Between tall buildings.
- Roads under cliffs.

However, the vehicle's direction and speed sensors will minimise any adverse effect on the operation of the navigation system, if this should occur. Normal operation will resume once the obstruction has been passed.

Errors in vehicle position

Under certain driving conditions, it is possible that the vehicle position shown may be incorrect. Some examples are shown below:

- When the vehicle is transported by ferry or train.
- Driving on steep roads.
- After vehicle battery removal or supply fuse failure.
- When using snow chains.
- After the tires have been replaced.
- After the vehicle has been rotated on a turntable.
- Where there are two roads parallel to each other.
- Elevated roads in proximity to other roads.
- Driving up or down circular ramps in car parks.

Satellite Navigation

SAFETY WARNINGS

Caution: Do not use the system until you have familiarised yourself with its operation.

Observation of traffic signs and local traffic regulations always takes priority.

Traffic guidance is restricted to passenger vehicles. Special driving recommendations and regulations for other vehicles (e.g. commercial vehicles) are not taken into account. The destination must only be entered when the vehicle is stationary.

WARNING

- **The navigation Database reflects reality as existing before you received the Database and it comprises data and information from government and other sources, which may contain errors and omissions. Accordingly, the Database may contain inaccurate or incomplete information due to the passage of time, changing circumstances, and due to the nature of the sources used. The Database does not include or reflect information on – amongst other things – neighbourhood safety; law enforcement; emergency assistance; construction work; road or lane closures; vehicle or speed restrictions; road slope or grade; bridge height, weight or other limits; road or traffic conditions; special events; traffic congestion; or travel time.**
- **Only operate, adjust or view the system when it is safe to do so.**

Safety information

The caution screen is displayed each time the starter switch is turned on, and the navigation system is selected.

The caution screen gives the following information:

- Most functions are inhibited while the vehicle is in motion.
- Please read the handbook for operating instructions.
- Always obey traffic regulations.

Danger of accident:

- Through operation of the navigation unit when driving, e.g. entering destination;
 - the destination must only be entered when the vehicle is stationary.
 - use of the navigation unit is only permitted if traffic conditions are suitable and you are absolutely sure that no risk, obstruction or inconvenience will be incurred to you, your passengers or other road users.
- Through non-observance of road traffic regulations;
 - the requirements of road traffic regulations retain their validity. It is possible that inaccurate or incorrect instructions are given due to altered traffic routes, e.g. due to road works or deviating data. The actual road signs and traffic regulations must therefore always be observed.
- Through misuse of the unit;
 - the navigation system serves solely as an aid to navigation. In particular, the navigation system cannot be used as an aid to orientation when visibility is poor. The volume of the car radio/navigation system must be adjusted so that external noise is still audible.
 - switch off the unit immediately if a fault occurs (e.g. emission of smoke or odours).

Satellite Navigation

GENERAL NOTES

- Radio or DVD operation continues during navigation operation.
- When entering the address, only those letters, digits and symbols which are relevant for the address are displayed. The entries are automatically completed. Spaces (e.g. in Long Lawton) must be entered using the underline symbol. Letters, numbers and symbols can be selected from the screen alpha or numeric keypad.
- The route is recalculated by the system, if deviation from the route is made.

GENERAL INFORMATION

The navigation system assists the driver by providing a route to a selected destination. Guidance is given by means of audible instructions (voice guidance), complemented by map and turn information which is displayed on the touch-screen. Both On Road and Off Road information is available. Digital map information is held on the navigation DVD, which is loaded into the navigation control unit.

The system has an extremely comprehensive range of features, yet is easy to use. Some time spent reading this handbook will ensure that the best results are obtained.

The touch-screen is used to control the system by means of menus, text screens and map displays.

The area covered by the navigation system depends on which version of the navigation DVD is loaded.

The driver is directed to the destination by voice guidance and/or the on-screen instructions.

Navigation DVD

LOADING THE NAVIGATION DVD

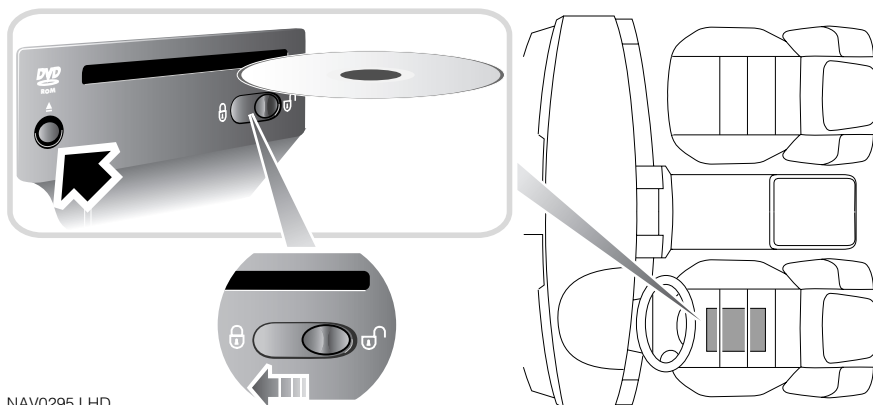

NAV0295 LHD

Note: It is necessary to raise the left-hand seat to its highest setting and then power the seat forward to its foremost position, before accessing the navigation DVD unit.

1. Turn the starter switch to position I, then move the lock/unlock button on the front of the DVD unit to the unlock position.
2. If a DVD is already loaded, push the eject button.
3. Load the Navigation DVD with the printed side upwards.

Caution: Do not allow moisture or foreign objects to enter the slot.

4. Move the lock/unlock button to the lock position.

Screen Displays

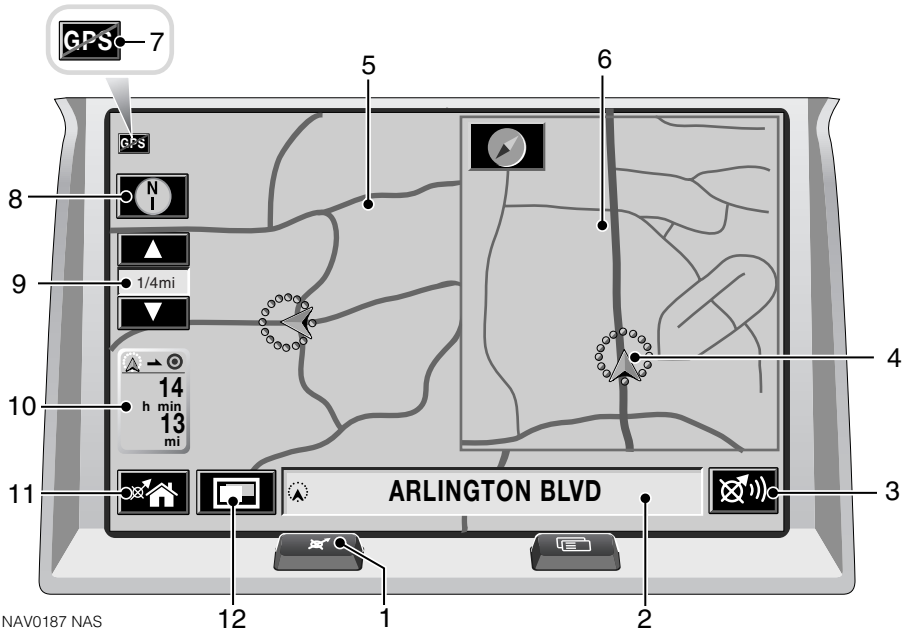

SCREEN DISPLAYS

Initial map display

A key to the main features is given below:

1. **Navigation button** - Press this navigation button on the display surround to start, or return to, the navigation system.
2. **Vehicle current position** - This shows the road number, street name etc., on which the vehicle is positioned.
3. **Repeat nav guidance** - Touch this to hear the last navigation voice guidance instruction.
4. **Current position cursor** - This icon shows the vehicle current position on the road map.
5. **Map** - A map of the local area.
6. **Map inset** - A more detailed local area view showing the current vehicle position (4). Use display mode change (12) to select the inset view required.
7. **GPS icon** - Indicates that insufficient GPS satellite signals are being received for accurate map positioning. This icon is only displayed when a GPS signal is not being received.
8. **Compass** - Control and indication of the map orientation, with North up or with the vehicle heading up. Touch the icon to toggle between the two views.

Screen Displays

9. Zoom - Control and indication of the current map zoom level. The available map scales range from the highest level of zoom of 50 metres (1/32 mile), to the lowest of 256 kilometres (128 miles).

Touching the up or down arrow decreases or increases the zoom level.

10. Distance - While driving under guidance, the estimated distance to the end of the route is displayed either in Imperial or Metric units, depending on your settings. Above this, is the estimated time of travel or the estimated time of arrival.

11. Menu icon - Touch the icon to select the Navigation menu.

12. Display mode change - Touch the icon to access the display mode options. Touch the desired option icon to select.

The more detailed map inset (see item 6 on previous page) will not be shown in single map display.

Map scrolling

Whilst the vehicle is stationary, if you touch on the map display for the first few seconds, the cursor will smoothly scroll across the screen towards the point where the screen is being touched. After the first few seconds, the cursor will jump to the position where the screen was being touched.

When the vehicle is being driven and you touch the map display, the cursor will jump immediately to the touched position.

Changing the display language

The screen text and voice guidance are available in a number of languages. To change the language:

- From the Home Menu see **SELECTING NAVIGATION, 34**, touch the **Settings** icon.
- From the User Settings menu, touch the **Language** icon.
- To select a language touch the flag of the country required and then touch the **OK** icon to confirm.

This procedure changes the on-screen language for all the touch-screen systems.

Glossary

ROUTE GUIDANCE

The touch-screen icons, types of guidance screen and other guidance features are described in the following pages.

Before you start

Before the vehicle reaches the start of a highlighted route, and during route recalculation, the straight line distance and direction to the destination are shown.

Breaks in a journey

While driving under guidance, the journey can be broken without affecting the stored route. When the journey is continued, the route guidance will resume automatically.

Whole route display

The map screen showing the entire route can be displayed. This is selected from the Route Options menu. From this screen the display of the remainder of the route and the route turn list can be selected.

Avoiding points and areas

At any time while a route is set, you can select a point to be avoided on the current route. This can be enlarged into an **avoid area**, if required. When the route is recalculated, the points or areas selected will be avoided (where possible). Avoid areas can also be set up to be avoided permanently in all route calculations.

TOUCH CONTROLS

The icons displayed on the guidance map screen are as follows:

Nav Menu icon

Displays the Navigation menu.

Audible repeat icon

Repeats the last audible instruction. If the manoeuvre point has been passed, the audible instruction for the next manoeuvre point will be heard.

Guidance screen icon

Displays the guidance screen overlay in place of the next turn arrow icon.

Turn arrow icon

Displays the next turn arrow icon in place of the guidance screen overlay.

Map orientation icons

These icons select the desired map orientation (north or vehicle heading to the top of the screen). The current selection is shown on the map.

Zoom control

Selects the desired map zoom level by touching one of the arrow icons. The currently selected scale is shown.

Glossary

ADDITIONAL TOUCH ICONS

These icons are displayed after touching the map display.

Chg Route icon

Selects the Route Options menu, to make changes to the route preference settings.

Set Dest icon

Stores a selected map location as a destination (displayed in place of the Chg Route icon, after touching the screen twice within 5 seconds.)

Store icon

Stores a selected map location as a memory point.

POI icon

Selects the Quick POI function to display POI icons on the map.

Home icon

Sets a route to the home position (only displayed when a home position is set).

Note: *If the **Set Dest** or **Home** icons are touched, the current route will be cancelled and a new route calculated.*

Auto Reroute

While under guidance, if the vehicle deviates from the route, a new route will be calculated automatically. While the route is being recalculated, the time and distance to destination information is replaced by the straight-line distance and direction to the destination.

Note: *If the vehicle is within 400 metres (1/4 mile) of the destination or next way point, the route recalculation will not occur.*

WAY POINTS

When the vehicle arrives at a way point, the navigation system will say “**You have arrived at your Way Point**” and **Guidance will now begin for the next stage of your route** is displayed on-screen.

When the journey is resumed, route guidance continues automatically, either to the next way point or to the final destination.

After way points have been visited (or the route cancelled), they will be deleted from the way points list.

For information on programming way points, see **WAY POINTS, 42**.

Note: *As way points are entered, they are automatically added to the list of previous destinations.*

UNMARKED ROADS

Whilst driving under On Road Navigation guidance, if you enter an unfinished or unmapped road there will be a voice guidance warning stating that you are entering this area and turn by turn guidance will not be given. When you first calculate the route, a small triangle appears on-screen to show that there is an unfinished or unmapped road on route.

Glossary

ROUTE GUIDANCE SCREEN TYPES

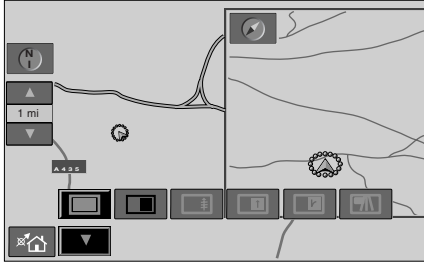

NAV0021ENG



Touch this icon during route guidance, to change the screen configuration to suit personal preference. A row of option icons appears in the bottom half of the screen. Touch the relevant icon to select the desired screen type, as follows:

Single map mode

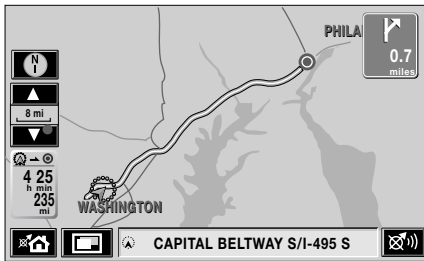

NAV0291 NAS



This mode shows the main navigation map, with an icon in the top right of the screen indicating the next navigation instruction (left turn, right turn or third exit at the next roundabout, for example) and the distance to the junction.

Dual map mode



NAV0368NAS



This mode shows the main navigation map, with a second map on the right half of the screen. The two maps have independent zoom facilities and the secondary map can be viewed in 2D or 3D modes. See **2D/3D VIEW, 63**.

The secondary map can be used to show a magnified view of the current vehicle position. The navigation instruction icon is still shown in the top right corner.

Turn list mode



NAV0205 NAS



In addition to the main navigation map, this mode also displays the next three turns or manoeuvres on a panel on the right half of the screen.

Glossary

Arrow mode

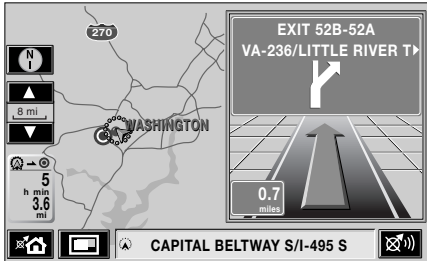

NAV0204 NAS



An easy to read guidance arrow is displayed on the right half of the screen.

Guidance screen



NAV0203 NAS



This facility is only available once route guidance has started and appears automatically when approaching an intersection. A magnified view of the next intersection or manoeuvre is displayed on the right half of the screen.

Note: The Guidance screen is displayed automatically if **Guidance screen** is set to **Yes** on the User Settings menu. See **USER SETTINGS, 67**.

Freeway information

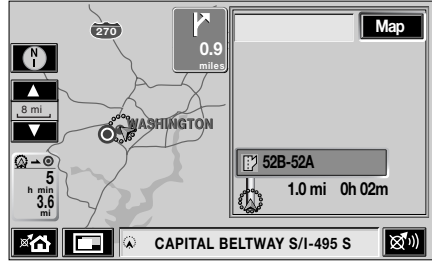

NAV0290 NAS



This facility is only available when travelling on a freeway and appears automatically to display the remaining freeway exits (up to the required exit for your route) and the exit numbers. In addition, the points of interest (POIs) available at each exit of the freeway can also be displayed.

Touch the **Map** icon to view POIs in the area surrounding the freeway exit currently highlighted on the list.

Note: The Freeway Information mode is displayed automatically if **Freeway Information** is set to **Yes** on the User Settings menu. See **USER SETTINGS, 67**.

Glossary

MAP CONTROLS

Screen configuration



Touch this icon to change the screen configuration. See **ROUTE GUIDANCE SCREEN TYPES, 31**.

Compass



The upper icon indicates that the map is displayed with North pointing upwards. Touch the icon to toggle to the alternative display, where the map is displayed with the vehicle direction pointing upwards.



Map scale



This icon is your zoom icon, enabling you to alter the map scale. The current level of zoom is shown between the two arrows.

Note: Some functions will not be available if the zoom level is too large. A message will be shown to tell you if this is the case.

Journey time and distance



This icon shows information concerning journey distance and the estimated time remaining before arrival at way point 1, which is 13 miles away and at your current speed you will arrive in 14 minutes

(if kilometres is your set preference then the display will show kilometres to your way point).

Touch the icon to view the display options for the icon.



NAV0148 ENG

The options available are:

- Distance and time to first way point.
- Distance and time to second (or subsequent) way point.
- Distance and time to destination.

Select the desired option or the arrow icon, to return to the guidance screen.