

# Vehicle recovery

## TOWING POINTS

### WARNINGS



The towing points at the front and rear of the vehicle are designed for on-road recovery only. If they are used for any other purpose it may result in vehicle damage or serious injury.



Never use towing points to tow a trailer, caravan etc. Doing so may result in vehicle damage or serious injury.

### CAUTION



Remove the front towing eye cover before driving off-road. This will prevent damage to or loss of cover.

## Off-Road Recovery

### WARNING



Before using the towing eyes for off-road recovery, it is essential that off-road driver training covering recovery techniques is undertaken.

Further information on off-road driver training can be found at

<http://www.landroverexperience.com>

## Front towing point

The front towing point can be used to tow your vehicle.

The front towing point is set behind a removable cover in the lower front bumper. Before driving off-road, remove the cover as a precaution against accidental loss.

## Front towing point cover

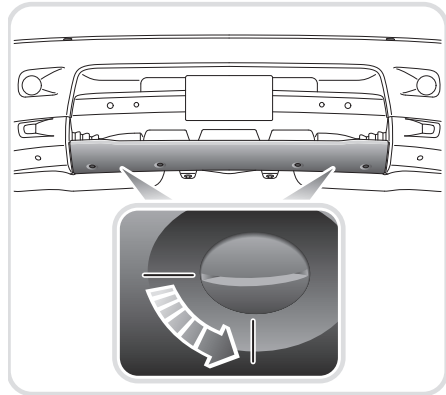
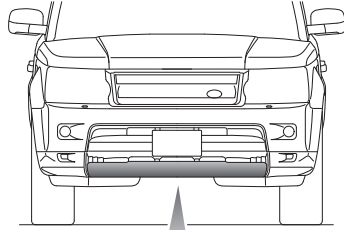

LAN2285

1. Rotate each of the fasteners 90 degrees counterclockwise with a coin (or similar).
2. To remove the cover, lower the top edge and then pull the cover forward.
3. Offer up the cover and ensure that the two lugs on the bottom edge engage with the holes in the body panel.
4. To secure the cover, turn each fastener 90 degrees clockwise.

# Vehicle recovery

## Rear towing point

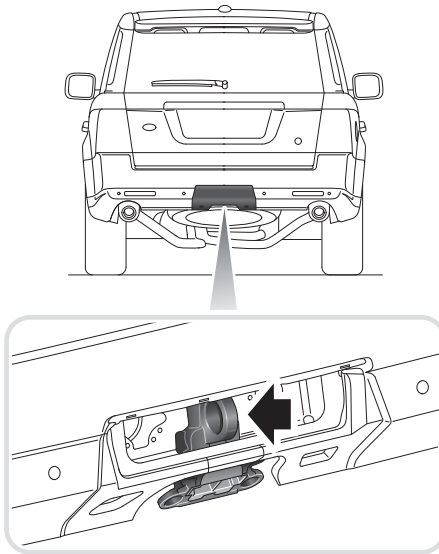

LAN2286

The rear towing point can be used to tow your vehicle, or another vehicle, in recovery situations.

Before driving off-road, remove the cover as a precaution against accidental loss.

## Rear towing point cover

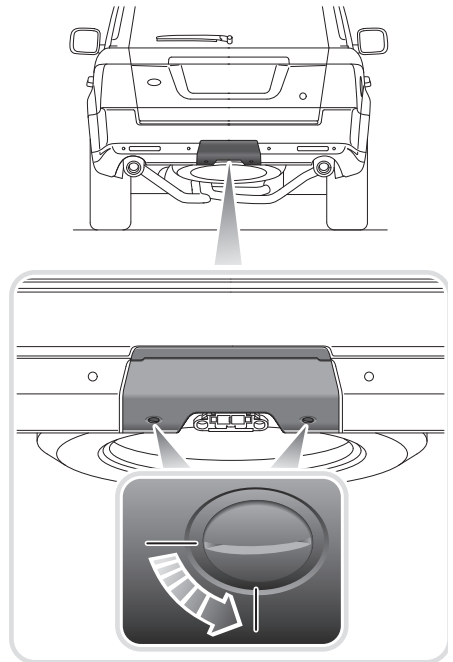

LAN2287

1. Rotate each of the fasteners 90 degrees counterclockwise with a coin (or something similar) to release the lower edge.
2. Rotate the cover to release the hooks at the top.
3. Remove the cover.
4. Position the cover and ensure that the four hooks on the top edge engage with the holes in the body panel.
5. To secure the cover, turn each fastener 90 degrees clockwise.

# Vehicle recovery

## LASHING POINTS

### WARNING



The front and rear lashing points must be used only for securing the vehicle during transportation. If they are used for any other purpose it may result in vehicle damage and serious injury.

### CAUTION



If the vehicle electronics are operational, the air suspension must be set to access height before securing the vehicle to a recovery vehicle or trailer. See **ADJUSTING THE SUSPENSION** (page 169).

**Note:** The front and rear lashing points are for lashing only and must not be used for towing.

## Front lashing points

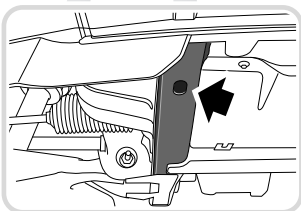
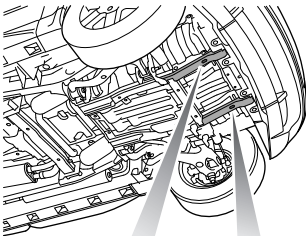

E92033

## Rear lashing points

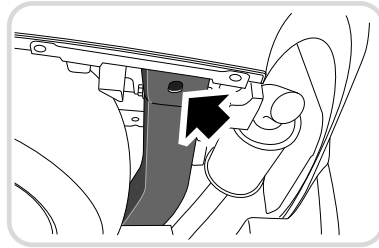
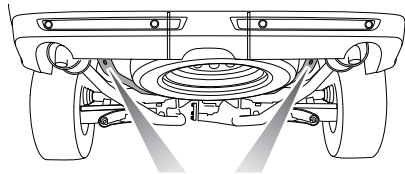

E92034

The two pairs of lashing points on the underside of the vehicle are provided for the insertion of appropriate hooks. Do not secure lashing hooks to any other part of the vehicle.

## TRANSPORTING THE VEHICLE

### WARNING



Use extreme caution when moving or towing the vehicle. Death or serious injury may occur.

Recovery by trailer is the recommended method for transporting the vehicle.

Always use qualified persons to perform recovery. Make sure the vehicle is secured correctly.

# Vehicle recovery

## TOWING THE VEHICLE ON FOUR WHEELS

### WARNINGS



Do not remove the Smart Key from the vehicle as this will lock the steering column.



To ensure that the steering column is unlocked, the vehicle battery must only be disconnected after the vehicle has been unlocked with the Smart Key.



If the engine cannot be run while the vehicle is being towed, there will be no power assistance for the steering or brakes. This will result in greater effort being required to steer or slow the vehicle and greatly increased stopping distance.

### CAUTIONS



Tow the vehicle only in a forward direction with four wheels on the ground. Towing in a reverse direction with two wheels on the ground will result in serious damage to the transmission.



The vehicle should only be towed for a maximum of 50 km (30 miles) at a maximum speed of 50 km/h (30 mph). Towing for a greater distance or at a higher speed may result in serious damage to the transmission.



Do not tow the vehicle if the gearbox cannot be set in neutral or the rear electronic differential has failed in the locked position.

Your vehicle has permanent four-wheel drive and is fitted with a steering lock. The following procedure must be carried out carefully to prevent damage to the vehicle:

1. Secure the towing attachment from the recovery vehicle to the front towing point.

2. With the parking brake applied, switch on the ignition.
3. Apply the foot brake and place the gear lever into neutral.
4. Switch off the ignition and leave the Smart Key in a secure place within the vehicle.
5. The ignition may be switched on, to allow the lamps and direction indicators to be operated.  
**Note:** *Leaving the ignition on for prolonged periods may drain the vehicle battery.*
6. Release the parking brake before towing the vehicle.

### CAUTION



Leaving the ignition switched on for extended periods will cause the battery to drain.

### After towing on four wheels

1. Apply the parking brake.
2. Switch on the ignition and apply the foot brake.
3. Place the auto selector lever in the Park position.
4. Switch off the ignition and remove the Smart Key from the vehicle.
5. Remove the towing attachment and fit the cover to the front towing point.

### WARNING



Use extreme caution when detaching towing equipment. Vehicle movement is possible which can result in serious injury.