

- ⚠** If the restraint is not correctly anchored, there is a significant risk of injury to the child in the event of a collision or emergency braking.

ISOFIX anchorage child seats can only be fitted to the outer seat positions on the second row of seats.

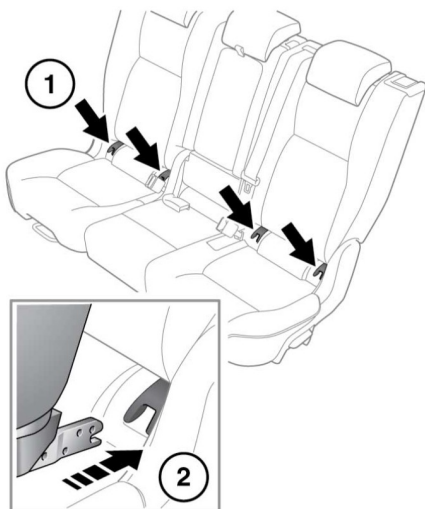

E163865

To install an ISOFIX child seat:

1. Locate the ISOFIX anchor bars and, if fitted, remove the covers.
2. Slide the child seat into position and attach the locking mechanism to the ISOFIX anchor bars.

If an upper tether is fitted to the child seat, see **40, INSTALLING TETHER ANCHORAGE CHILD RESTRAINTS**.

Test the security of the child restraint. To do this, attempt to pull the restraint away from the vehicle's seat and twist the restraint from side to side. Even if the restraint appears secure, you should still check the anchor points visually, to make sure they are correctly attached.

Note: Always make sure that if an upper tether is provided, it is fitted and tightened correctly.

INSTALLING TETHER ANCHORAGE CHILD RESTRAINTS

- ⚠** **WARNING:** child restraint anchorages are designed to withstand only those loads imposed by correctly fitted child restraints. Under no circumstances are they to be used for adult seat belts, harnesses or for attaching other items or equipment to the vehicle.

- ⚠** Always follow the child seat or restraint system manufacturer's instructions when fitting tether straps.

- ⚠** When fitting a child seat or restraint system, always pass the tether strap over the top of the seatback and beneath the head restraint.

- ⚠** If a child seat or restraint system is to be fitted to the centre seating position, the centre armrest must be in the stowed position (folded into the seat).

Your vehicle may be equipped with anchorage points on the back of the second row seats. These should be used to attach straps from child seats or restraint systems.

Note: A tether anchorage is provided for the centre seat position. Do not use this anchor position with an ISOFIX child seat.

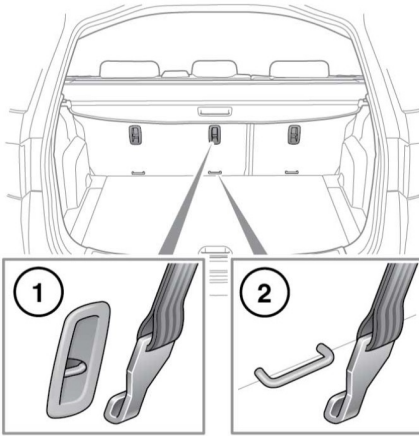

E163146

Australian vehicles only

For 5 and 7 seat vehicles fitted with sliding rear seats, the seats shall be adjusted to the foremost position prior to attaching the tether straps. The seats should then be returned to the rearmost position to aid fitment of the child seat.

Tether strap anchor point locations:

1. Fixed rear seats.
2. Sliding rear seats.

Install the tether straps as follows:

1. Install the child restraint securely in one of the rear seating positions.
2. Pass the tether strap over the seatback, beneath the head restraint and between the seatback and the loadspace cover.
3. Attach the tether strap hook to the tether anchor point on the back of the seat. Make sure the tether strap hook is facing the correct way, as illustrated.
4. Tighten the tether strap according to the manufacturer's instructions.

Note: For 5 seat vehicles fitted with sliding seats, the loadspace floor should be lifted and moved rearwards. This is to allow access to the tether anchor points. The loadspace floor should be replaced after attaching the tether straps.