





- | | |
|---|---|
| 1. Audio system and controls. | 15. Telephone and voice recognition controls. |
| 2. Touch screen. | 16. Steering wheel adjuster. |
| 3. Central locking, unlock. | 17. Horn. |
| 4. Central locking, lock. | 18. Cruise control. |
| 5. Parking aid switch. | 19. Electric parking brake. |
| 6. Hazard warning lamps. | 20. Terrain response. |
| 7. Engine START/STOP. | 21. Climate control. |
| 8. Lighting/direction indicator/trip computer. | 22. Intelligent stop/start. |
| 9. Audio controls. | 23. Stability control. |
| 10. Instrument panel, warning lamps and Message centre. | 24. CD eject. |
| 11. Message centre control. | 25. Hill descent control. |
| 12. Wiper/washer controls. | 26. Mirror adjuster/power fold mirror. |
| 13. Interior illumination control. | 27. Window controls. |
| 14. Heated steering wheel. | 28. Rear window isolator. |

Smart key

-  Press once to switch the approach lamps on. Press again to switch off.
-  Press to unlock and release the tailgate.
-  Press and hold for 3 seconds to activate/cancel the panic alarm.

Unlocking mode alternatives

 **Single-point entry.** Press once to unlock only the driver's door and the fuel filler flap. Press twice to unlock all doors, the fuel filler flap and the Luggage area.

Multi-point entry. Press once to unlock all doors, the fuel filler flap and the Luggage area.

To change the mode - with the vehicle unlocked, press and hold the lock and unlock buttons simultaneously for 3 seconds. The hazard warning lamps will flash to confirm the change.

Automatic relock

If the vehicle is unlocked and no door or tailgate is opened within 1 minute, it will automatically relock and arm the alarm.

Operating note

The Smart key may not be detected if placed in a metallic container, or behind a device with an LCD screen such as a smart phone, laptop (including when inside a laptop bag), games console, etc. Loose coins in the same pocket as the Smart key can also act as a shield. Keep the Smart key clear of such devices when attempting Keyless entry or Keyless starting.

Central door locking



1. Press to unlock all doors and the tailgate.
2. Press to lock all doors and the tailgate. This will not enable the alarm.

To unlock only the tailgate, press and hold both switches simultaneously for 3 seconds.

Emergency key release

Slide the side section up to remove. Remove the key blade and unfold it. Fully insert the key blade into the slot beneath the door lock cover embossed with the lock and key icons. Gently prise off the cover.

Insert the key into the exposed lock and unlock the vehicle.

If the security system was previously armed with the Smart key, when the door is unlocked, the alarm will sound. To disarm the alarm, press the unlock button on the Smart key, or press the **START/STOP** button with the Smart key inside the vehicle.

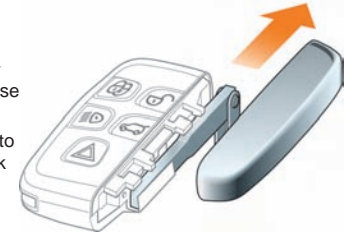

Operating note

If the Smart key fails to work, hold it flat against the underside of the steering column with the buttons facing downwards. Start the engine as normal. The Smart key can now be removed.

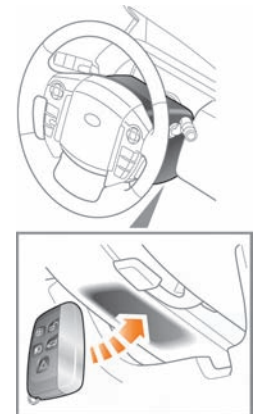

Operating note

If the vehicle is locked with the Smart key, the master unlocking switch will not release the locks. The door levers will still release locks and open doors.

Drive-away locking

If enabled, all apertures will automatically lock when the vehicle's speed exceeds 8 km/h (5 mph).

The feature can be turned on or off by a Land Rover Dealer.