

Seat adjustment

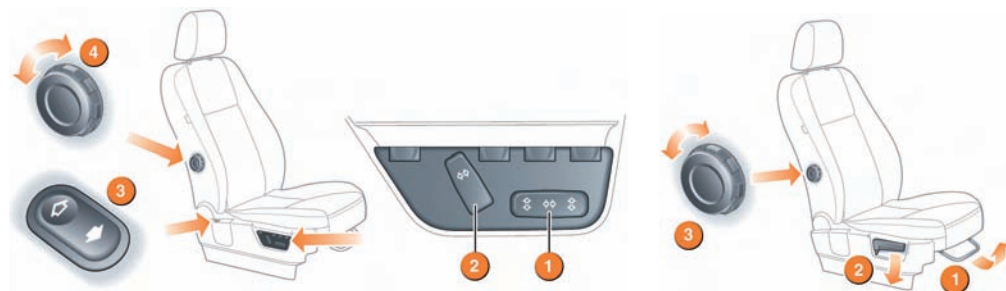

Power seats

1. Seat forwards and backwards, cushion height and cushion angle.
2. Seatback angle.
3. Lumbar support control (memory seat only).
4. Lumbar support manual adjuster.

Manual seats

1. Seat forwards and backwards.
2. Height adjustment.
3. Seatback angle.

Driving position memory

Positions for driver's seat and exterior mirrors, can be stored in vehicle's memory for future use.

1. On the side of the driver's seat, press the **MEM** button to activate the memory store function.
2. Within 5 seconds, press buttons 1, 2 or 3 to store the current driving position to the chosen number. An existing setting on that button will be over-written.

A stored memory position can now be recalled with a press of the appropriate button; 1, 2 or 3. The seat and mirrors will move to their preset positions.

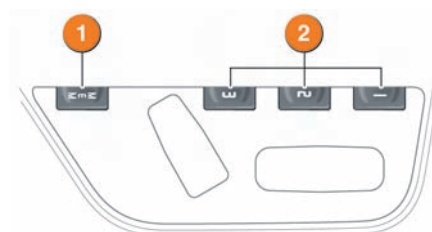

Operating note

Buttons 1, 2 or 3 must be pressed within 5 seconds after pressing the **MEM** button, otherwise the memory store function will cancel.

Windows and door mirrors See page 2, items 26 to 27.

Firmly press or lift the respective window switch and release it. Movement can be stopped by briefly operating the switch again.

When the rear window isolator switch is pressed, an indicator lamp illuminates in the switch.

Door mirrors

Press **L** or **R** to select a mirror. Use the mirror adjuster to set the mirror's position.

Power-folding door mirrors

Press **L** and **R** simultaneously to fold in. Press again to return the mirrors to the opened position.

Resonance with lowered windows

If a resonance/booming sound occurs when a rear window is open, lowering an adjacent front window about 25mm (1in) will eliminate the condition.

Reminder - Global closing

If any windows are left open when leaving the vehicle, press and hold the Smart key lock button to close them.

Steering wheel adjustment See page 2, item 16.

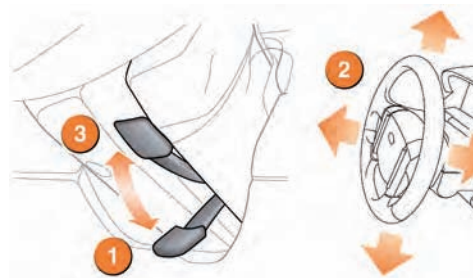

With the vehicle stationary

1. Unlock the lever.
2. Adjust the steering wheel to the desired position.
3. Move the lever back to the lock position.

Steering column electronic lock

The steering column lock is deactivated when the vehicle is unlocked. The steering wheel may need slight rotation to release the lock.

Seat belts and child safety



A warning indicator in the Instrument panel will illuminate if a front seat belt is unbuckled. This may be accompanied by an intermittent chime.

Child seats

It is the weight of a child, rather than age, that determines the type of seat required.

Refer to **Child seats** in the Owner's Handbook to determine the correct seat for your child.

Passenger airbag deactivation



The status indicator, in the overhead console, will be illuminated while the ignition is on and the switch is in the **OFF** position.



If a rearward-facing child restraint is fitted to the front passenger seat, the passenger airbag **MUST** be deactivated.

To deactivate, open the front passenger door and use the emergency key to turn the **PASS.AIRBAG** switch at the end of the facia to the **OFF** position.

When an adult, or an average size child over 12 years, is seated in the front passenger seat, make sure the **PASS.AIRBAG** switch is turned to the **ON** position.