

## WIPER OPERATION

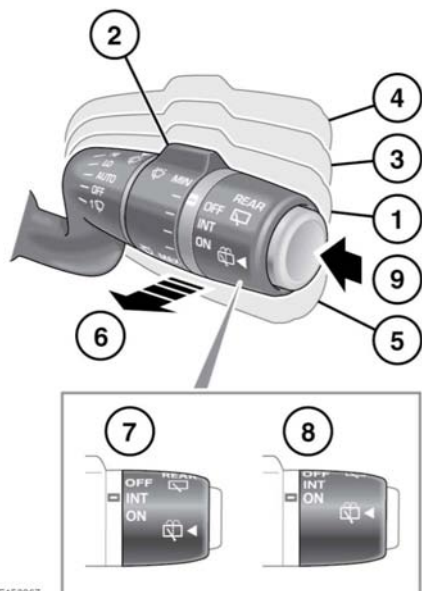

1. Automatic rain sensing mode - The front wipers will respond and adapt automatically to the ambient rain conditions, selecting the appropriate wiper frequency for the prevailing conditions. The sensitivity of the system can be adjusted by rotating the collar (2).
2. Rotate the collar to adjust the sensitivity of the automatic rain sensing mode when position (1) is selected. The higher the sensitivity position the more responsive the system will become. When automatic rain sensing mode is selected, or when sensitivity is increased, the system will perform a single wipe.
3. Low speed continuous wipe.
4. High speed continuous wipe.
5. Single wipe, or hold down for further continuous wipes.

6. Windscreen wash/wipe. Pull and release to operate the front washers and wipers. The wipers will operate for 2 further wipes after the stalk is released. After a few seconds, a drip wipe will clear any residual washer fluid from the windscreen. If more washer fluid is required, pull and hold the stalk position.

**Note:** The front wipers will not operate while the bonnet is open.

7. INT - Rear wiper intermittent operation. Wiper frequency will increase with vehicle speed.
8. ON - Rear wiper continuous operation.
9. Rear window wash/wipe. Press and release to operate the rear washer and wiper. The wiper will operate in a set cycle to minimise drips when the button is released. If more washer fluid is required, push and hold the button.

**Note:** When reverse gear is selected and the front wipers are operating, the rear wiper will activate.

**Note:** The rear wiper will not operate while the boot is open.



Drip wipe on the windscreen can be enabled/disabled by a Dealer/Authorised Repairer.



Rear wiper road speed related frequency can be enabled/disabled by a Dealer/Authorised Repairer.



Do not operate the windscreen wipers on a dry screen.



In freezing or very hot conditions, use the winter park position to allow the wiper blades to be lifted from the screen should they become stuck. See **60, WINTER PARK POSITION.**



Remove any snow, ice or frost from the screen, around the wiper arms and blades and the screen scuttle, before operating the wipers.



Make sure the wipers are switched off before entering a car wash. If the automatic rain sensing system operates during the car washing process, damage may occur to the wiper mechanism.

**Note:** If the wipers leave smears on the glass after the car has been washed, this may be due to wax or other residue. Should this occur, clean the glass with washer fluid. If smearing persists, clean the glass with the recommended Land Rover screen cleaning paste. See **258**, **LUBRICANTS AND FLUIDS**.

**Note:** The windscreen will no longer be wiped effectively and the automatic rain sensing function will degrade if the wipers become worn. Always replace worn or damaged wiper blades as soon as possible.

**Note:** If the wiper blades become stuck or jammed, an electronic cut-out will temporarily halt wiper operation. If this happens, switch off the wipers and vehicle ignition, when safe to do so. Clear any obstructions and free the wiper blades before attempting to switch on the ignition.

The winter park position will move the wipers to allow wiper blade replacement. See **210**, **WIPERS SERVICE POSITION**.

## SPEED-DEPENDENT MODE

### Front Wipers

If vehicle speed drops below 8 km/h (5 mph) with the wipers operating, the wipers will switch to the next lowest speed. When vehicle speed increases to over 8 km/h (5 mph), the original wiper speed setting is restored automatically.



This feature can be enabled/disabled by your Dealer/Authorised Repairer.

### Rear Wiper

The frequency of the rear wiper, when set to intermittent, increases with vehicle speed.



This feature can be enabled/disabled by your Dealer/Authorised Repairer.

## RAIN SENSOR

The rain sensor is mounted on the inside of the windscreen, behind the rear view mirror. The sensor is able to detect the presence and amount of water on the windscreen and automatically activate the windscreen wipers accordingly.

**Note:** Static droplets may not be detected on initial start-up. A single wipe should be used to clear the windscreen.

To activate the rain sensitive wipers, move the wiper stalk to the AUTO position (1). The behaviour of the system may be tailored to driver preference by rotating the collar (2).

**Note:** If the wiper stalk switch is turned to the AUTO position (1) the wipers will not operate if either front door is open.

**Note:** In dry and often sunny conditions, optical influences and dirt accumulation on the windscreen may result in the windscreen wipers activating inadvertently. To prevent this, it is recommended that under these conditions the wiper controls are returned to the OFF position.

## HEADLAMP WASHERS

If the headlamps are on, and there is sufficient liquid in the washer reservoir, operating the screen wash will also power-wash the headlamps.

# Wipers and washers

The headlamp power wash will operate on every fifth operation of the screen washer, provided the headlamps are still switched on and approximately 10 minutes have elapsed since the last headlamp wash.

Switching the headlamps or ignition off and back on again, will reset the cycle.

**Note:** *The headlamp washers are inhibited when the washer fluid reservoir level is low.*

## WINTER PARK POSITION

When the vehicle is parked, the wipers can be set to park in a higher position than normal. This allows the wiper blades to be lifted from the screen to limit the effects of freezing, and also to help clear snow. The 'Wipers winter park' option can be selected from the **Vehicle Set-Up** menu. See **46, INSTRUMENT PANEL MENU**.



Do not drive with the wipers in the Winter park position. The wipers should be returned to the normal park position before driving the vehicle.