

## AIR SUSPENSION SYSTEM

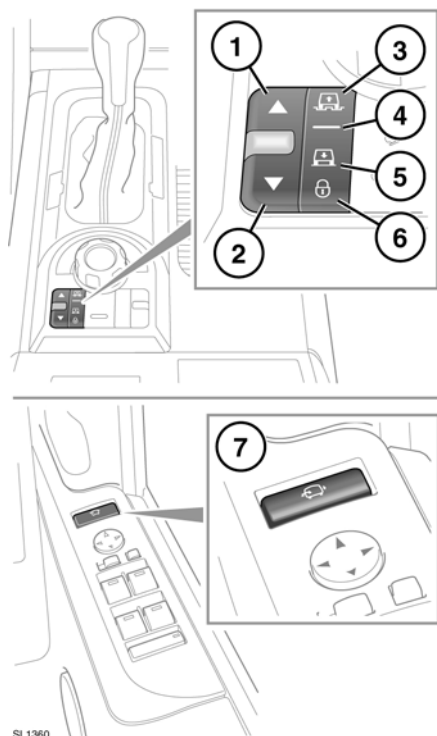

**WARNING:** Ensure that the vehicle is clear of people and obstacles before lowering the suspension. The difference between Off-road height and Access height is 3.7 in (95mm).

The air suspension system may be used to raise or lower the height of the vehicle, using the air suspension control switch.



3. Off-road height indicator. Off-road height is 2.2in (55mm) higher than normal height.
4. Normal height indicator.
5. Access height indicator. Access height is 1.6in (40mm) lower than normal height.
6. System lock indicator.
7. Driver's door panel switch. Access height can be selected directly with a single press.

**Note:** The system may raise or lower the vehicle automatically (e.g. if a Terrain Response program requires it, or if the vehicle is travelling at high speed).

Changes to the height of the vehicle must be made when all doors are closed and the engine is running. Remote operation does not require the engine to be running. See **REMOTE OPERATION, 92**. If a door is opened during a height change, the height change will be suspended. If the door is closed within 90 seconds, the height change will then complete. If the doors are not closed in time, the desired height should be reselected once the doors are closed. Driving off will return the vehicle to normal height.

**Note:** If the air suspension is used many times in succession, the speed of operation may slow.

## SELECTING OFF-ROAD HEIGHT

Press the raise switch **1** at any speed up to 24mph (40km/h). If vehicle speed exceeds 30mph (50km/h), a warning will appear in the message center and the system will return to normal height.

1. Raise switch. The arrow will illuminate when a height change is in progress.
2. Lower switch. The arrow will illuminate when a height change is in progress.

## EXTENDED OFF-ROAD HEIGHT

If grounded in severe off-road conditions, the system may automatically enter Extended mode. The off-road height indicator flashes and a message will be displayed in the message center. In extended mode, the suspension will raise above off-road height to assist in clearing the obstacle.

Once extended mode height has been achieved, the driver may request additional lifting if required. This is achieved by pressing and holding the raise switch for longer than 3 seconds while pressing the brake pedal.

To cancel extended mode, press the lower switch **2**.

Extended mode will automatically be cancelled if the vehicle speed remains greater than 3mph (5km/h) for 30 seconds.

**Note:** *Extended mode cannot be selected manually.*

## SELECTING ACCESS HEIGHT

To select access height from normal height, press the lower switch **2**. To select access height from Off-road height, press the switch once, then a second time while lowering is in progress. **ACCESS HEIGHT SELECTED** will be displayed in the message center.

If the vehicle speed is greater than 12mph (20km/h), the system will wait for the speed to decrease. If it does not fall below this speed within 1 minute, the height change will be cancelled.

Once the speed falls below 12mph (20km/h) the vehicle will be partly lowered. When the speed falls below 5mph (8km/h) within 1 minute, full access height will be reached.

**Note:** *Access height may be selected up to 40 seconds after the ignition is switched off, provided the driver's door has not been opened.*

When vehicle speed rises above 5mph (8km/h) for five seconds, the vehicle will return to the height access height was selected from.

## CRAWL MODE (LOCKED ACCESS HEIGHT)

When the vehicle is at Normal height and travelling less than 22mph (35km/h), or at Access height, press the lower switch for longer than 3 seconds to lock the vehicle at access height. The system lock indicator **6** will illuminate and **SUSPENSION LOCKED AT ACCESS HEIGHT** will be displayed in the message center.

The vehicle may then be driven slowly at access height, to assist with maneuvering in confined areas (e.g. multi-storey car parks).

To cancel crawl mode, press the raise switch for longer than 1 second. The system lock indicator will extinguish and if the vehicle is travelling faster than 6mph (10km/h) it will return to normal height.

Crawl mode will be cancelled automatically if the vehicle speed exceeds 24 mph (40 km/h).

## REMOTE OPERATION



**WARNING:** The Smart Key can be operated from inside or outside the vehicle. It is therefore important that it is kept out of the reach of children at all times.



**WARNING:** When operating the Smart Key from inside the vehicle, make sure that an adult checks for obstructions under the vehicle and supervises the raising or lowering process.



**CAUTION:** Care should be taken with all height changes when a trailer is attached to the vehicle.

The buttons on the Smart Key may be used to operate the air suspension system, allowing the vehicle to be raised or lowered remotely. This may be useful in attaching a trailer or loading the vehicle.

To change the suspension height using the Smart Key, the vehicle must be stationary, all the doors closed and the hazard warning lamps switched on.

To lower the vehicle, press and hold buttons **1** and **3** simultaneously.

If the starting height is above or below normal height, movement will cease when normal height is reached. Release the Smart Key buttons and press again to continue.

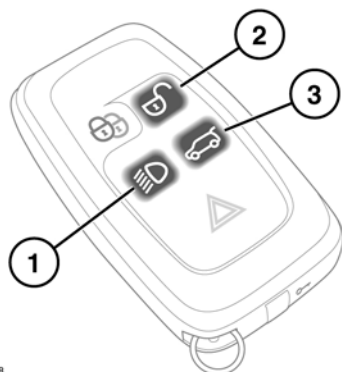

SL1478

To raise the vehicle, press and hold buttons **1** and **2** simultaneously