

## AUTOMATIC TRANSMISSION

The gear selector lever operates in a forward, back and sideways direction.

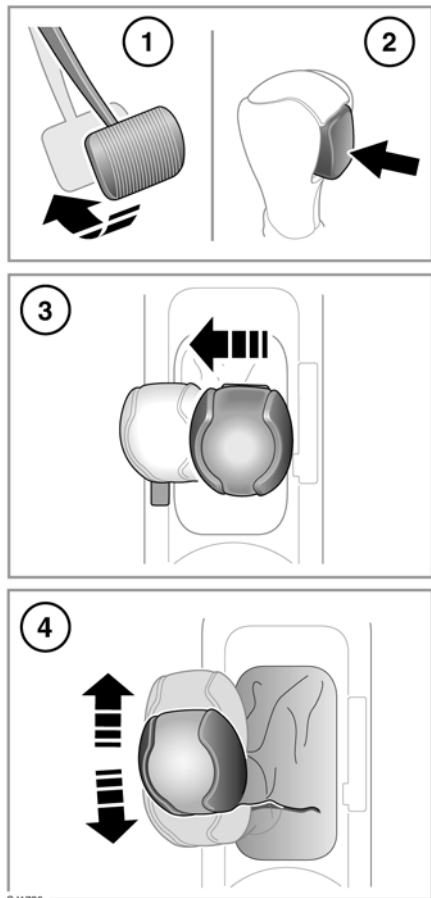

1. To select Drive (**D**) when the vehicle is stationary and engine is running, first apply the foot brake.
2. Press in the release button and move the lever to **D**.

**Note:** If pressure is applied to the selector before the foot brake is applied, the selected gear may not be available. In this situation, remove pressure from the selector, ensure that the foot brake is applied and select the required gear as described.

3. To select sport mode, move the lever to the left.  
**S** will appear in the instrument panel and the LED by the selector will illuminate.
4. CommandShift™ can be used when **S** is selected.  
Move the lever forward to move up a gear and back to move down gear. To return to the fully automatic sport mode, move the lever to **D** then back to **S**.
5. To return to drive mode move the selector back to the **D** position.

- ⚠ **CAUTION:** Do not allow the vehicle to remain stationary for a sustained period, with a gear selected and the engine running.
- ⚠ **CAUTION:** This vehicle must not be push or tow started.

## REVERSE GEAR

- ⚠ **CAUTION:** Never select Reverse (**R**) when the vehicle is in forward motion.
- Before selecting reverse gear, ensure the vehicle is stationary and the brakes are applied. Press in the release button and move the lever to **R**.

## NEUTRAL

Disconnects drive to the wheels. Use the parking brake while **N** is selected.

## DRIVE

 **CAUTION:** Never select a forward gear when the vehicle is in rearward motion.

Gear changing is fully automatic. Shift points are determined by accelerator pedal position and current road speed.

## SPORT MODE

The transmission will stay in the lower gears for longer, improving mid-range performance. To deselect Sport mode, move the selector back to **D**.

## PARK

Use when the vehicle is parked. The transmission will be locked.

 **WARNING:** Park (P) should be engaged and the parking brake applied when the vehicle is stationary. The vehicle can move unexpectedly with any other gear position selected, which may result in death or serious injury.

 **WARNING:** Always select P and switch off the ignition before leaving the vehicle.

 **CAUTION:** Never select Park (P) when the vehicle is in motion. Doing so may cause serious damage to the transmission.

## COMMANDSHIFT™

If CommandShift™ is selected in high range, 1st gear must be used for moving off from stationary. In low range, gears 1, 2 or 3 may be used. This may prove useful in certain off-road driving conditions.

To return to Sport mode after CommandShift has been selected, move the selector back to **D** then back to Sport mode.

The message, **TRANSMISSION COMMANDSHIFT SELECTED** will appear in the message center when the transmission is in CommandShift mode.

**Note:** In order to protect the engine, the transmission will automatically change up to prevent over-revving, or down if the engine is labouring.

**Note:** During sustained braking, if a downshift is made that would result in over-revving the engine, the downshift will be delayed until vehicle speed has reduced sufficiently.

## KICK-DOWN

Push the accelerator pedal fully down to achieve rapid acceleration in automatic mode. When the pedal is relaxed, normal gear changing will resume.

## TRANSMISSION FAULT

In the event that the transmission develops a fault, a warning message may be displayed in the message center and only limited gears may become available. You should seek qualified assistance immediately.

## HIGH/LOW RANGE CHANGING

The transmission switch allows selection of high or low range gears.

 **CAUTION:** Do not use auxiliary equipment, such as roller generators that are driven by only one or two wheels of the vehicle, as they will cause failure of the transmission.

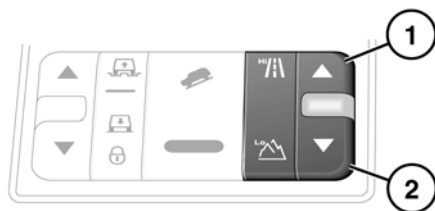

SL1442

### 1. High range.

**Hi** should be used for all normal road driving and also for off-road driving across dry, level terrain.

### 2. Low range.

**Lo** should only be used in situations where low speed maneuvering is necessary.

Also use **Lo** for more extreme off-road conditions. Do not attempt to use **Lo** for normal road driving.

With the vehicle stationary and the engine running, select **N**.

With the transmission switch, select the range required and release. The switch returns to the default position and range change status will be confirmed after several seconds.

## RANGE CHANGE INDICATORS

In high range, the **Hi** range switch indicator is illuminated.



In low range, the green warning lamp in the instrument pack and the **Lo** range switch indicator are illuminated.

While a range change is in progress, the range indicators will flash as follows:

### Hi to Lo change:

- The **Hi** indicator will be illuminated. The **Lo** range lamp and indicator flash during the change and then illuminate constantly.

- The **Hi** range indicator extinguishes when the change is complete.
- The message **LOW RANGE SELECTED** is briefly displayed in the message center.

### Lo to Hi change:

- The **Lo** range indicator will be illuminated. The **Hi** range indicator will flash during the change.
- The **Hi** range lamp illuminates constantly when the change is complete.
- The **Lo** range indicator and lamp extinguish when the change is complete.
- The message **HIGH RANGE SELECTED** is briefly displayed in the message center.

## RANGE CHANGING ON THE MOVE

The recommended method of changing range is with the vehicle stationary. For experienced off-road drivers, a range change on-the-move can be accomplished, as detailed below.

### Hi to Lo change:

- With the vehicle slowing down and travelling between 24mph (40km/h) and 2mph (3km/h), select **N**.
- Press transmission switch (2) and release it.
- Wait for the range change to be completed (this may take several seconds). Once complete, select **D** or **S**.

## CHANGING FROM LOW TO HIGH RANGE

With the vehicle travelling no faster than 38mph (60km/h), select **N**. Press the transmission switch (1) and release it.

Indication of the range change status is the same as for the stationary method.

Now select **D** or **S**.